

STATE OF ILLINOIS
DEPARTMENT OF TRANSPORTATION
DIVISION OF HIGHWAYS
PROPOSED
HIGHWAY PLANS

FAS ROUTE 836 (DUBOIS RD)
SECTION 11RS-3
SMART RESURFACING
WASHINGTON COUNTY

F.A.S. RTE.	SECTION	COUNTY	TOTAL SHEETS	SHEET NO.
836	11RS-3	WASHINGTON	9	1
		ILLINOIS	CONTRACT NO. 76J08	

FOR INDEX OF SHEETS, SEE SHEET NO. 2

TRAFFIC DATA
 FUNCTIONAL CLASSIFICATION
 MAJOR COLLECTOR
 2015 ADT = 850 (ESTIMATED)
 2020 ADT = 900 (ESTIMATED)
 SU = NO DATA AVAILABLE
 MU = NO DATA AVAILABLE



C-98-058-15

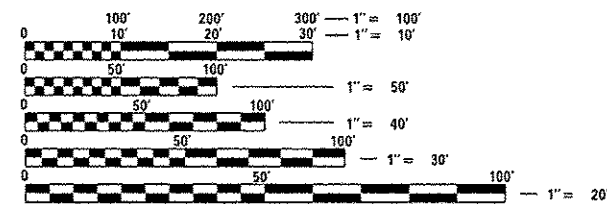

FULL SIZE PLANS HAVE BEEN PREPARED USING STANDARD ENGINEERING SCALES. REDUCED SIZED PLANS WILL NOT CONFORM TO STANDARD SCALES. IN MAKING MEASUREMENTS ON REDUCED PLANS, THE ABOVE SCALES MAY BE USED.

J.U.L.I.E.
 JOINT UTILITY LOCATION INFORMATION FOR EXCAVATION
 1-800-892-0123
 OR 811

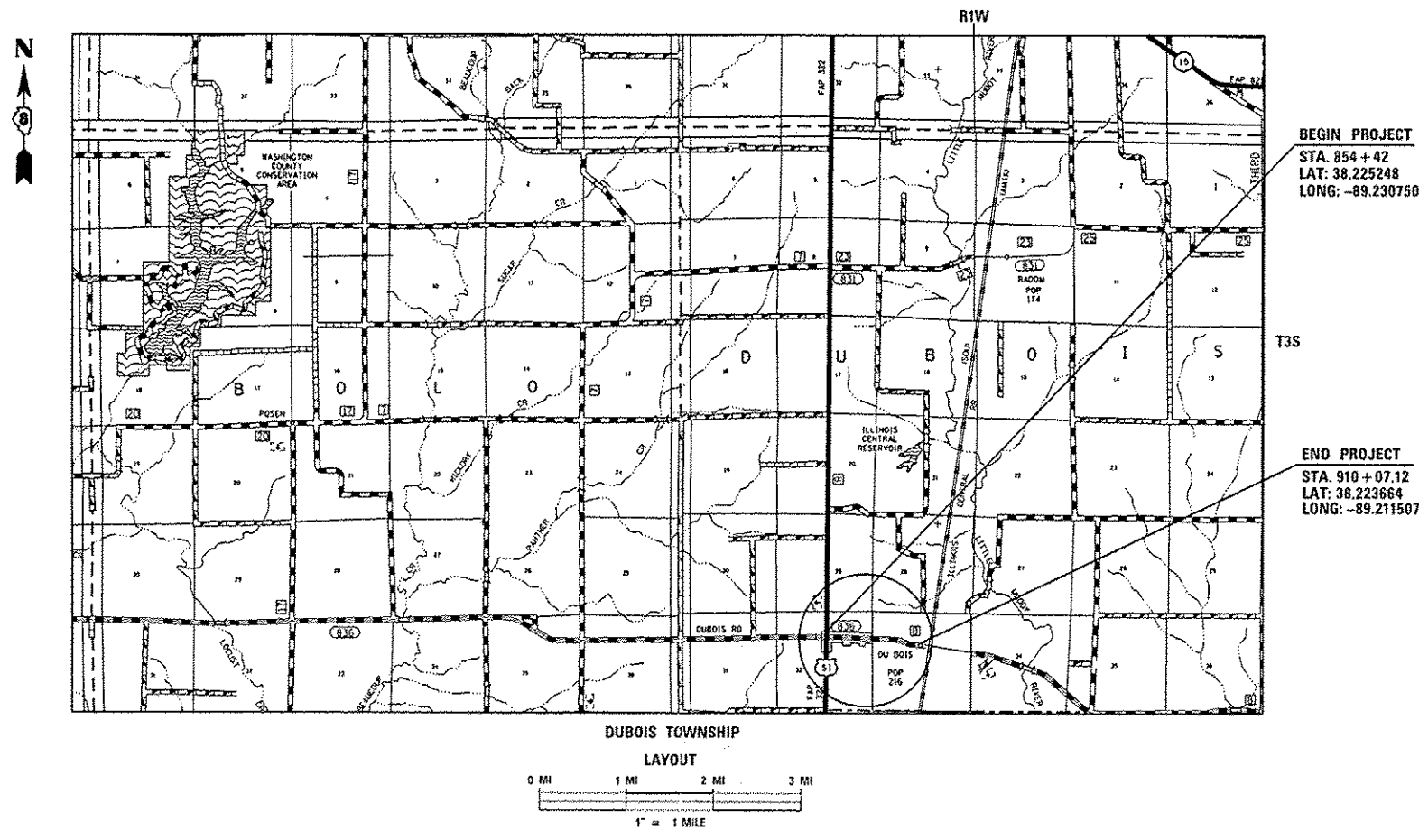

BEGIN PROJECT
 STA. 854 + 42
 LAT: 38.225248
 LONG: -89.230750

END PROJECT
 STA. 910 + 07.12
 LAT: 38.223664
 LONG: -89.211507

STATE OF ILLINOIS
 DEPARTMENT OF TRANSPORTATION
 DIVISION OF HIGHWAYS

SUBMITTED Nov. 16 2015

Jeffrey Z. K...
 DEPUTY DIRECTOR OF HIGHWAYS, REGION 5 ENGINEER

Jan 29 2016
Margaret M. Addis, PE
 acting ENGINEER OF DESIGN AND ENVIRONMENT

Jan 29 2016
Cher Coman, PE
 DIRECTOR OF HIGHWAYS, CHIEF ENGINEER

PROJECT ENGINEER: MIKE PRITCHETT (618) 346-3180
 DESIGNER: DIANA MURRAY (618) 346-3454

GROSS LENGTH = 5565.12 FT. = 1.05 MILE
 NET LENGTH = 5565.12 FT. = 1.05 MILE

CONTRACT NO. 76J08

**PRINTED BY THE AUTHORITY
 OF THE STATE OF ILLINOIS**

INDEX OF SHEETS

1. COVER
2. INDEX OF SHEETS, HIGHWAY STANDARDS, GENERAL NOTES & COMMITMENTS
3. SUMMARY OF QUANTITIES
4. LOCATION MAP
- 5-6. TYPICAL SECTIONS
7. SCHEDULE OF QUANTITIES
8. BEGIN AND END PROJECT DETAIL
9. PAVEMENT MARKING DETAIL

HIGHWAY STANDARDS

- 000001-06 STANDARD SYMBOLS, ABBREVIATIONS AND PATTERNS
- 001006 DECIMAL OF AN INCH AND OF A FOOT
- 701001-02 OFF-ROAD OPERATIONS, 2L, 2W, MORE THAN 15' (4.5M) AWAY
- 701006-05 OFF-ROAD OPERATIONS, 2L, 2W, 15' (4.5M) TO 24" (600MM) AWAY FROM PAVEMENT EDGE
- 701011-04 OFF-ROAD OPERATIONS, DAY ONLY
- 701301-04 LANE CLOSURE, 2L, 2W, SHORT TIME OPERATIONS
- 701306-03 LANE CLOSURE, 2L, 2W, SLOW MOVING OPERATIONS DAY ONLY, FOR SPEEDS ≥ 45 MPH
- 701311-03 LANE CLOSURE, 2L, 2W, MOVING OPERATIONS - DAY ONLY
- 701901-04 TRAFFIC CONTROL DEVICES
- 780001-05 TYPICAL PAVEMENT MARKINGS
- 781001-03 TYPICAL APPLICATIONS RAISED REFLECTIVE PAVEMENT MARKERS

GENERAL NOTES

1. ILLINOIS STATE LAW REQUIRES A 48-HOUR NOTICE BE GIVEN TO ALL UTILITIES WITHIN THE PROJECT LIMITS BEFORE DIGGING. FIELD MARKING OF FACILITIES MAY BE OBTAINED BY CONTACTING J.U.L.I.E. OR FOR NON-MEMBERS, THE UTILITY COMPANY DIRECTLY. AGENCIES KNOWN TO HAVE FACILITIES WITHIN THE PROJECT AREA ARE AS FOLLOWS:

UTILITY	ABOVE GROUND	BELOW GROUND
*AMEREN ILLINOIS - GAS & ELECTRIC	X	X
*CLEARWAVE COMMUNICATIONS - COMMUNICATIONS	X	X
*VILLAGE OF DUBOIS - WATER & SANITARY SEWER		X
*FRONTIER NORTH, INC. - COMMUNICATIONS	X	X
*WASHINGTON COUNTY WATER CO. - WATER		X

MEMBERS OF J.U.L.I.E. CALL TOLL FREE NUMBER (800) 892-0123 OR 811 AND ARE INDICATED BY *. NON-J.U.L.I.E. MEMBERS MUST BE NOTIFIED INDIVIDUALLY.

2. THE CONTRACTOR AND THE ENGINEER SHALL BE AWARE THAT LIMITED SURVEY WAS PERFORMED FOR THIS PROJECT. THE STATIONING AND TOPOGRAPHY SHOWN IN THE PLANS WERE CREATED USING MICROFILM, FIELD MEASUREMENTS AND SURVEY. ALL SHALL BE ASSUMED TO BE APPROXIMATE. THE CONTRACTOR SHALL VERIFY DIMENSIONS AND CONDITIONS IN THE FIELD PRIOR TO CONSTRUCTION AND ORDERING OF MATERIALS.
3. AN ESTIMATED QUANTITY OF 1216 TONS OF HOT-MIX ASPHALT SURFACE WILL BE REMOVED. THE SURFACE REMOVAL THICKNESS OF THE EXISTING HMA OVERLAY MAY VARY FROM THAT SHOWN ON THE PLANS.
4. THE THICKNESS OF THE HMA MIXTURE SHOWN ON THE PLANS IS THE NOMINAL THICKNESS. DEVIATIONS FROM THE NOMINAL THICKNESS WILL BE PERMITTED WHEN SUCH DEVIATIONS OCCUR DUE TO IRREGULARITIES IN THE EXISTING SURFACE OR BASE ON WHICH THE HMA MIXTURE IS PLACED.
5. ALL AREAS DISTURBED BY THE CONTRACTOR OUTSIDE THE PROPOSED CONSTRUCTION LIMITS SHALL BE SEEDED AT THE CONTRACTOR'S EXPENSE.
6. "ROAD CONSTRUCTION AHEAD" SIGNS SHALL BE PLACED AT THE BEGINNING OF THE PROJECT AND WILL BE INCLUDED IN THE COST OF THE ASSOCIATED TRAFFIC CONTROL PAY ITEMS. ALL CONSTRUCTION SIGNS SHALL BE 48" FLUORESCENT ORANGE.
7. NO OVERNIGHT LANE CLOSURES WILL BE ALLOWED.
8. THE CONTRACTOR SHOULD BE AWARE THERE ARE HORIZONTAL CURVES WITHIN THE PROJECT LIMITS THAT MAY BE SUPERELEVATED. THE CONTRACTOR SHALL VERIFY THE EXISTING SUPERELEVATION AND MATCH EXISTING CROSS-SLOPE. THESE CROSS-SLOPES MAY BE CONTRARY TO THE TYPICAL SECTIONS.
9. A QUANTITY OF AGGREGATE WEDGE SHOULDER, TYPE B HAS BEEN INCLUDED TO ELIMINATE EXISTING DROP-OFFS AT THE EDGE OF THE HMA SHOULDER.

10. THE SCHOOL CROSSING SIGNS AT 3RD STREET SHALL BE REMOVED. THE SIGN AND SIGN POSTS SHALL BE DELIVERED TO THE NASHVILLE YARD, LOCATED AT 9571 IDOT SHED ROAD. CONTACT PERSON: MARK GARD (618) 327-3914.
11. THE QUALITY CONTROL FOR PERFORMANCE ITEM AND QUANTITIES ARE AS FOLLOWS:
HMA SURFACE COURSE, MIX "C", N70 - 1216 TONS
12. SHORT TERM PAVEMENT MARKING SHALL BE APPLIED TO MILLED AND FINAL SURFACES. ONLY REMOVAL FROM THE FINAL SURFACE SHALL BE PAID FOR AS WORK ZONE PAVEMENT MARKING REMOVAL.

ROUTE	FAS 836
SECTION	IIRS-3
COUNTY	WASHINGTON
CONTRACT	76JOB

DESCRIPTION:	SMART - CONTRACT MAINTENANCE - DUBOIS ROAD FROM US 51 TO FRONT STREET IN DUBOIS
--------------	---

ADT (CONSTRUCTION YR):	850
MUX:	5
SUX:	5
20 YR. ESAL'S:	0.28

MIXTURE REQUIREMENTS

MIXTURE USE	SURFACE
AC/PG	PG 64-22
RAP % (MAX)	SEE SPECIAL PROVISION
DESIGN AIR VOIDS	4.0% @ Ndes=70
MIX COMPOSITION (GRADATION)	IL 9.5
FRICTION AGG	MIX "C"
QUALITY MGMT PROGRAM	OCP

PLAN QUANTITIES FOR HMA SURFACE COURSE ITEMS ARE CALCULATED USING A UNIT WEIGHT OF 112 LB/SO YD/IN (59.8 KG/SO M/25 MM THICKNESS).

COMMITMENTS

NONE

LEGEND

- ① EXISTING GRAVEL/CRUSHED STONE SURFACE COURSE, 6"
 - ② EXISTING BITUMINOUS SURFACE, 3 1/2" ±
 - ③ EXISTING CONCRETE SIDEWALK
 - ④ EXISTING BASE COURSE WIDENING, 8"
 - ⑤ EXISTING COMBINATION CONCRETE CURB AND GUTTER, TYPE B-6.24
 - ⑥ EXISTING LEVELING BINDER (MACHINE METHOD), TYPE 2, VARIES 3 1/2" TO 3/4"
 - ⑦ EXISTING AGGREGATE SHOULDERS
 - ⑧ PROPOSED BITUMINOUS MATERIALS (PRIME COAT)
 - ⑨ PROPOSED HOT-MIX ASPHALT SURFACE COURSE, MIX "C", N70, 1 1/2"
 - ⑩ PROPOSED AGGREGATE WEDGE SHOULDERS, TYPE B
 - ⑪ PROPOSED THERMOPLASTIC PAVEMENT MARKING, 4"
- HMA SURFACE TO BE REMOVED 1 1/2"

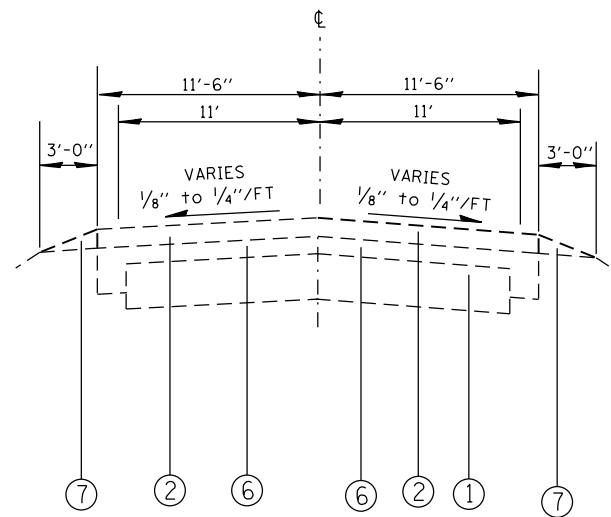

TYPICAL SECTION
STA. 854+42 TO STA. 897+97

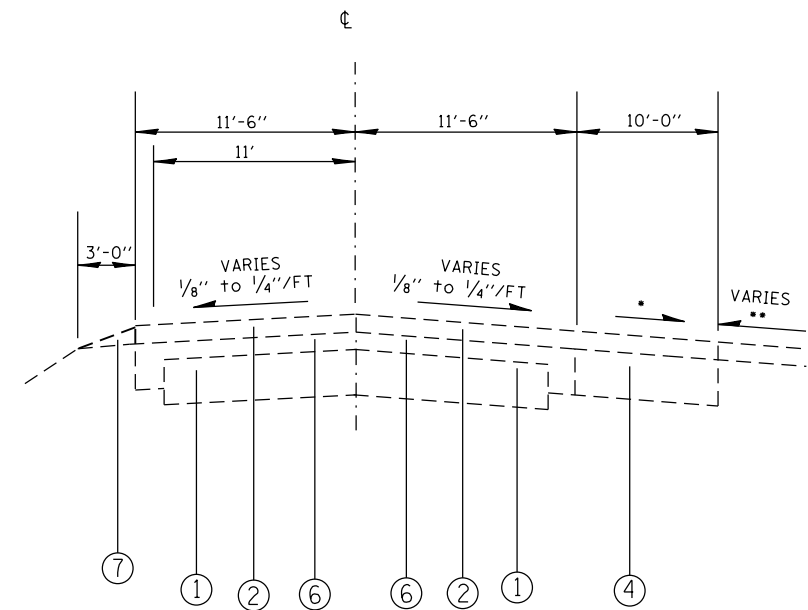

TYPICAL SECTION
STA. 897+97 TO STA. 900+25

- VARIES 1/4"/FT TO 3/4"/FT
- INTERSECTING BROADWAY ST. - DO NOT RESURFACE

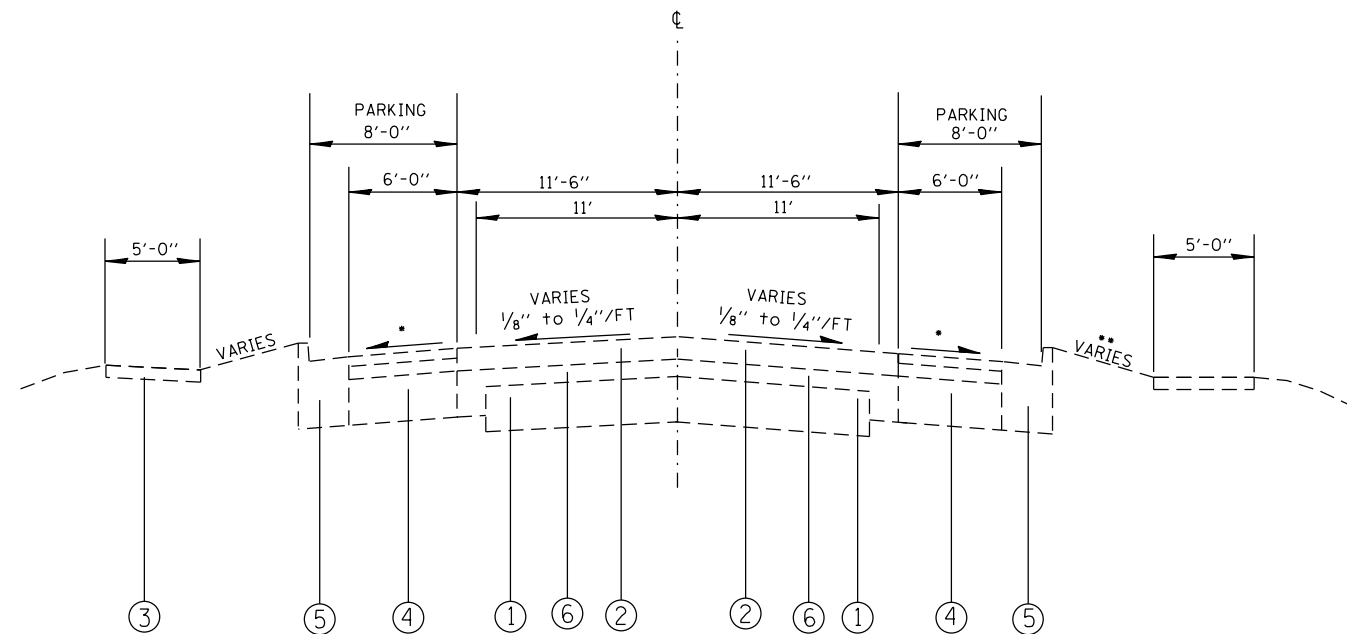

TYPICAL SECTION
STA. 900+25 TO STA. 907+30
STA. 907+30 TO STA. 909+35

- VARIES 1/4"/FT TO 3/4"/FT
- FROM 907+30 TO STA. 909+35 SIDEWALK IS DIRECTLY ADJACENT TO COMBINATION CURB AND GUTTER (RIGHT SIDE ONLY)

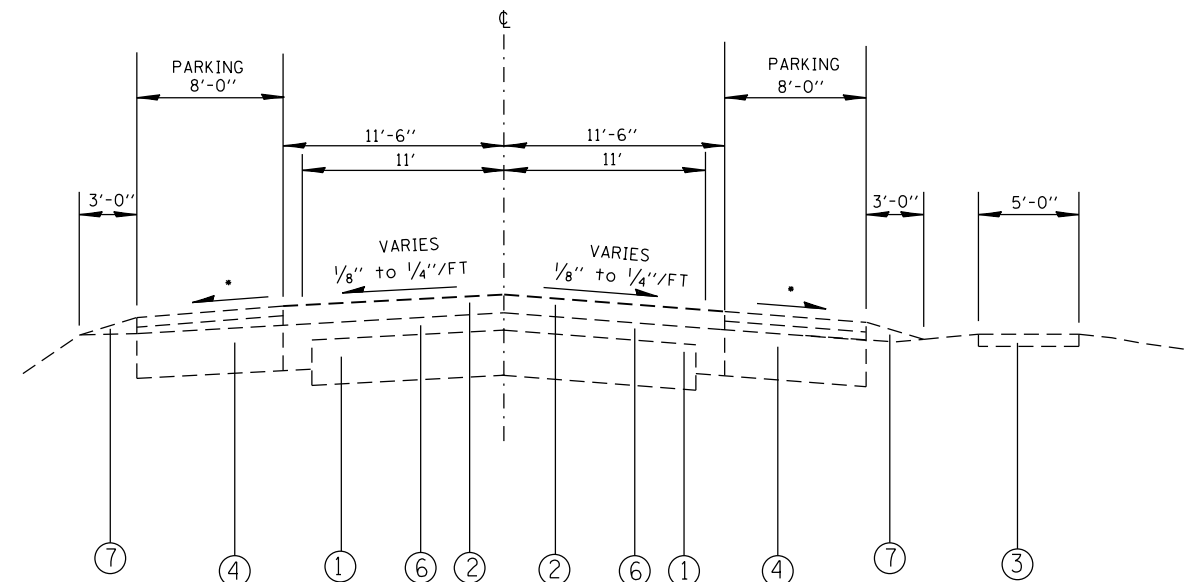

TYPICAL SECTION
STA. 909+35 TO STA. 910+07

- VARIES 1/4"/FT TO 3/4"/FT

FILE NAME =	USER NAME = MurrayDA	DESIGNED -	REVISED -	STATE OF ILLINOIS DEPARTMENT OF TRANSPORTATION	EXISTING TYPICAL SECTIONS			F.A.S. RTE.	SECTION	COUNTY	TOTAL SHEETS	SHEET NO.	
p:\11\084EBIDINTEG\Illinois.gov\PIWIDOT\Documents\IDOT Offices\District 8\Projects\0875\Drawings\EA\Drawings\0875-08-shr-plan.dwg					REVISED -				836	IIRS-3	WASHINGTON	9	5
PLOT SCALE = 100.0000' / in.					CHECKED -				CONTRACT NO. 76J08				
PLOT DATE = 12/3/2015					DATE -				FED. ROAD DIST. NO. - ILLINOIS FED. AID PROJECT				

LEGEND

- ① EXISTING GRAVEL/CRUSHED STONE SURFACE COURSE, 6"
- ② EXISTING BITUMINOUS SURFACE, 3 1/2" ±
- ③ EXISTING CONCRETE SIDEWALK
- ④ EXISTING BASE COURSE WIDENING, 8"
- ⑤ EXISTING COMBINATION CONCRETE CURB AND GUTTER, TYPE B-6.24
- ⑥ EXISTING LEVELING BINDER (MACHINE METHOD), TYPE 2, VARIES 3 1/2" TO 3/4"
- ⑦ EXISTING AGGREGATE SHOULDERS
- ⑧ PROPOSED BITUMINOUS MATERIALS (PRIME COAT)
- ⑨ PROPOSED HOT-MIX ASPHALT SURFACE COURSE, MIX "C", N70, 1 1/2"
- ⑩ PROPOSED AGGREGATE WEDGE SHOULDERS, TYPE B
- ⑪ PROPOSED THERMOPLASTIC PAVEMENT MARKING, 4"

HMA SURFACE TO BE REMOVED 1 1/2"

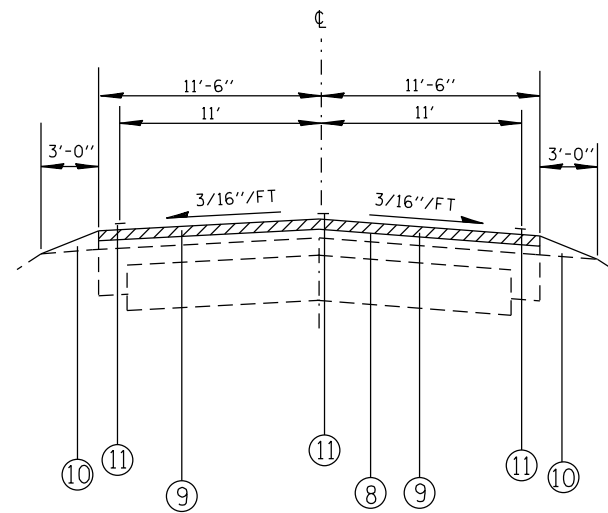

TYPICAL SECTION
STA. 854+42 TO STA. 897+97

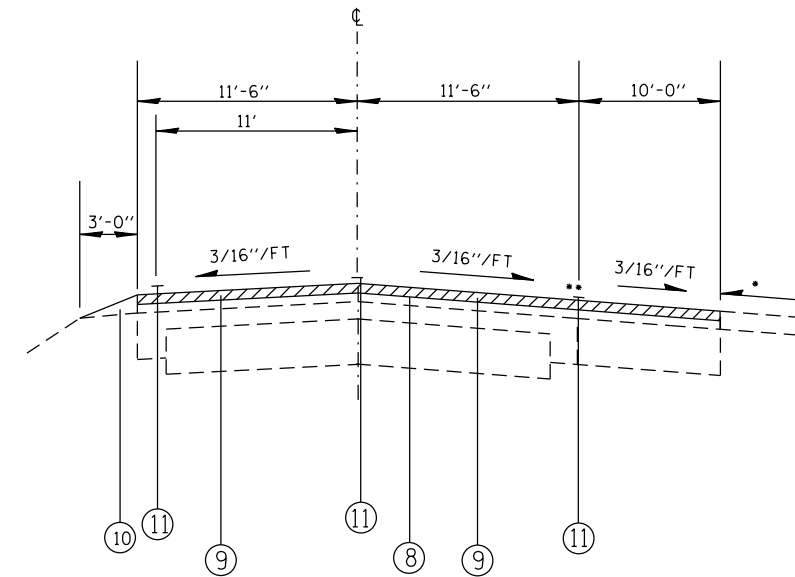

TYPICAL SECTION
STA. 897+97 TO STA. 900+25

- INTERSECTING BROADWAY ST. - DO NOT RESURFACE
- FROM STA. 898+97 TO 899+57 - EB ONLY - NO EDGELINE STRIPING

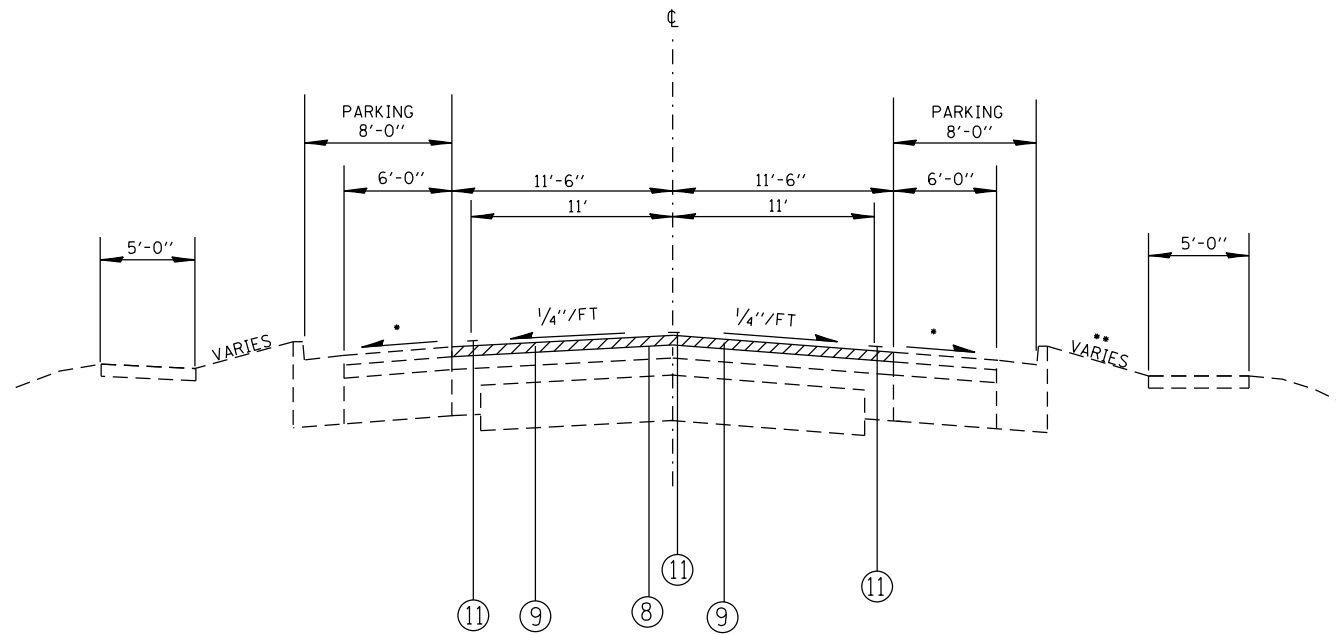

TYPICAL SECTION
STA. 900+25 TO STA. 907+30
STA. 907+30 TO STA. 909+35

- VARIES 1/4"/FT TO 3/4"/FT
- FROM 907+30 TO STA. 909+35 SIDEWALK IS DIRECTLY ADJACENT TO COMBINATION CURB AND GUTTER (RIGHT SIDE ONLY)

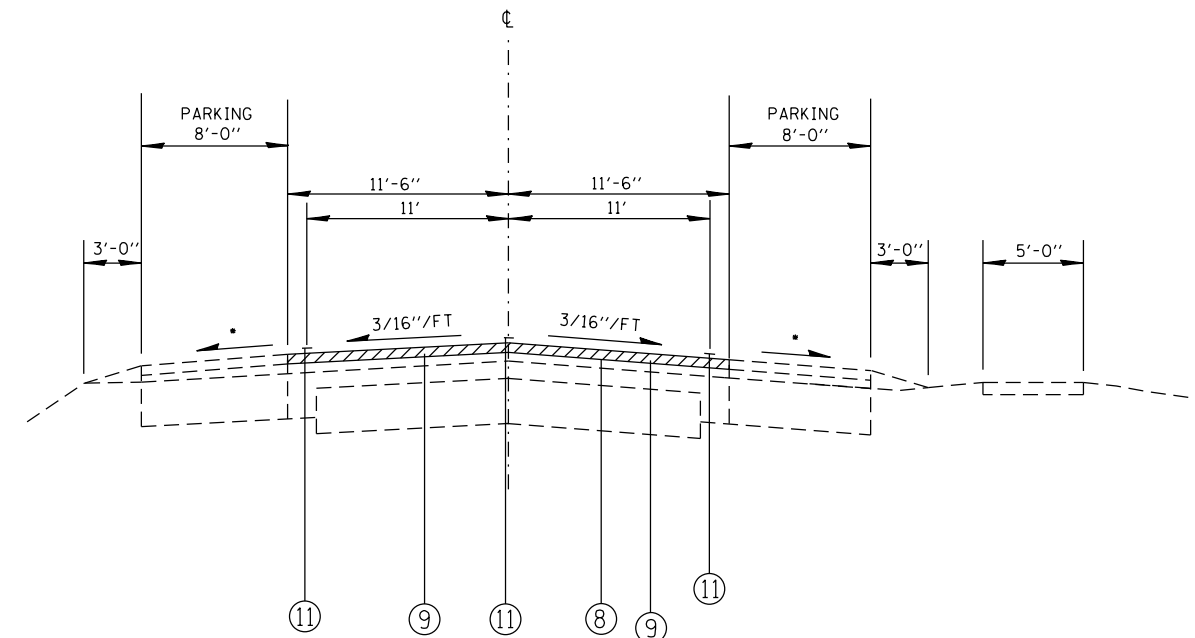

TYPICAL SECTION
STA. 909+35 TO STA. 910+07

- VARIES 1/4"/FT TO 3/4"/FT

FILE NAME =	USER NAME = MurrayDA	DESIGNED -	REVISED -
pw:\IL\084EB\INTEG\Illinois.gov\PIDOT\Documents\IDOT Offices\District 8\Projects\0876\DRAWING\DATA\EAD\Sheets\0876J08-sht-plan.dwg		CHECKED -	REVISED -
		DATE -	REVISED -

**STATE OF ILLINOIS
DEPARTMENT OF TRANSPORTATION**

PROPOSED TYPICAL SECTIONS

SCALE: _____ SHEET NO. ___ OF ___ SHEETS STA. _____ TO STA. _____

F.A.S. RTE.:	SECTION	COUNTY	TOTAL SHEETS	SHEET NO.
836	IIRS-3	WASHINGTON	9	6
CONTRACT NO. 76J08				
FED. ROAD DIST. NO. _ ILLINOIS FED. AID PROJECT				

RESURFACING SCHEDULE								
STATION to STATION			DIMENSIONS		HMA SURFACE REMOVAL 1 1/2"	BITUMINOUS MATERIAL (PRIME COAT)	HOT-MIX ASPHALT SURFACE COURSE, MIX "C" N70,	AGGREGATE WEDGE SHOULDER, TYPE B
			LTH	WTH				
			FT	FT	SQ YDS	POUND	TON	TON
MAINLINE								
854+42	-	897+97	4355	23	11131	5009	935.0	169.4
897+97	-	900+25	228	33	834	375	70.1	8.8
900+25	-	910+07	982	23	2510	1129	210.8	
TOTAL:					14475	6513	1216	178

TEMPORARY RAMP SCHEDULE				
DIR	LOCATION	LTH	WTH	AREA
		FT	FT	
EB	BEGINNING OF PROJECT	5	11.5	6
WB	BEGINNING OF PROJECT	5	11.5	6
SB	12TH STREET	5	50	28
SB	7TH STREET	5	70	39
WB	BROADWAY	5	150	83
NB	4TH STREET	5	40	22
SB	4TH STREET	5	50	28
NB	3RD STREET	5	45	25
SB	3RD STREET	5	40	22
NB	2ND STREET	5	35	19
SB	2ND STREET	5	40	22
NB	1ST STREET	5	55	31
SB	1ST STREET	5	45	25
NB	FRONT STREET	5	65	36
SB	FRONT STREET	5	45	25
EB	END OF PROJECT	5	11.5	6
WB	END OF PROJECT	5	11.5	6
TOTAL				429

SIGN SCHEDULE		
DIR	LOCATION	REMOVE SIGN PANEL TYPE 1 S1-1 (36" X 36")
		SQ FT
EB	3RD STREET	9
WB	3RD STREET	9
TOTAL		18

PAVEMENT MARKING SCHEDULE																		
STATION TO STATION			LENGTH	NO PASSING ZONE	RAISED REFLECTIVE PAVEMENT MARKER REMOVAL	AMBER RAISED REFLECTIVE PAVEMENT MARKERS	SHORT TERM PAVEMENT MARKING	TEMPORARY PAVEMENT MARKING					WORK ZONE PAVEMENT MARKING REMOVAL	THERMOPLASTIC PAVEMENT MARKING				
								4" SOLID YELLOW	4" SKIP-DASH YELLOW	4" SOLID WHITE	24" SOLID WHITE	LETTERS & SYMBOLS		4" SOLID YELLOW	4" SKIP-DASH YELLOW	4" SOLID WHITE	24" SOLID WHITE	LETTERS & SYMBOLS
			FOOT		EACH	EACH	FOOT	FOOT	FOOT	FOOT	SQ FT	SQ FT	FOOT	FOOT	FOOT	FOOT	SQ FT	
854+42	-	897+97	4356		54	54	792		1089	8711		3399		1089	8711			
897+97	-	898+97	100		1	1	18		25	200		78		25	200			
898+97	-	899+57	60		1	1	11		15	60		27		15	60			
899+57	-	900+25	68		1	1	12		17	135		53		17	135			
900+25	-	904+98	473		6	6	86		118	946		369		118	946			
904+98	-	910+07	509	EB	6	6	93	509	127	1018		567	509	127	1018			
RR CROSSING									23	61.2		107				23	61.2	
SUBTOTAL					69	69	1012	509	1391	11070	23	61.2	4600	509	1391	11070	23	61.2
TOTAL					69	69	1012		12970		23	61.2	4600		12970		23	61.2

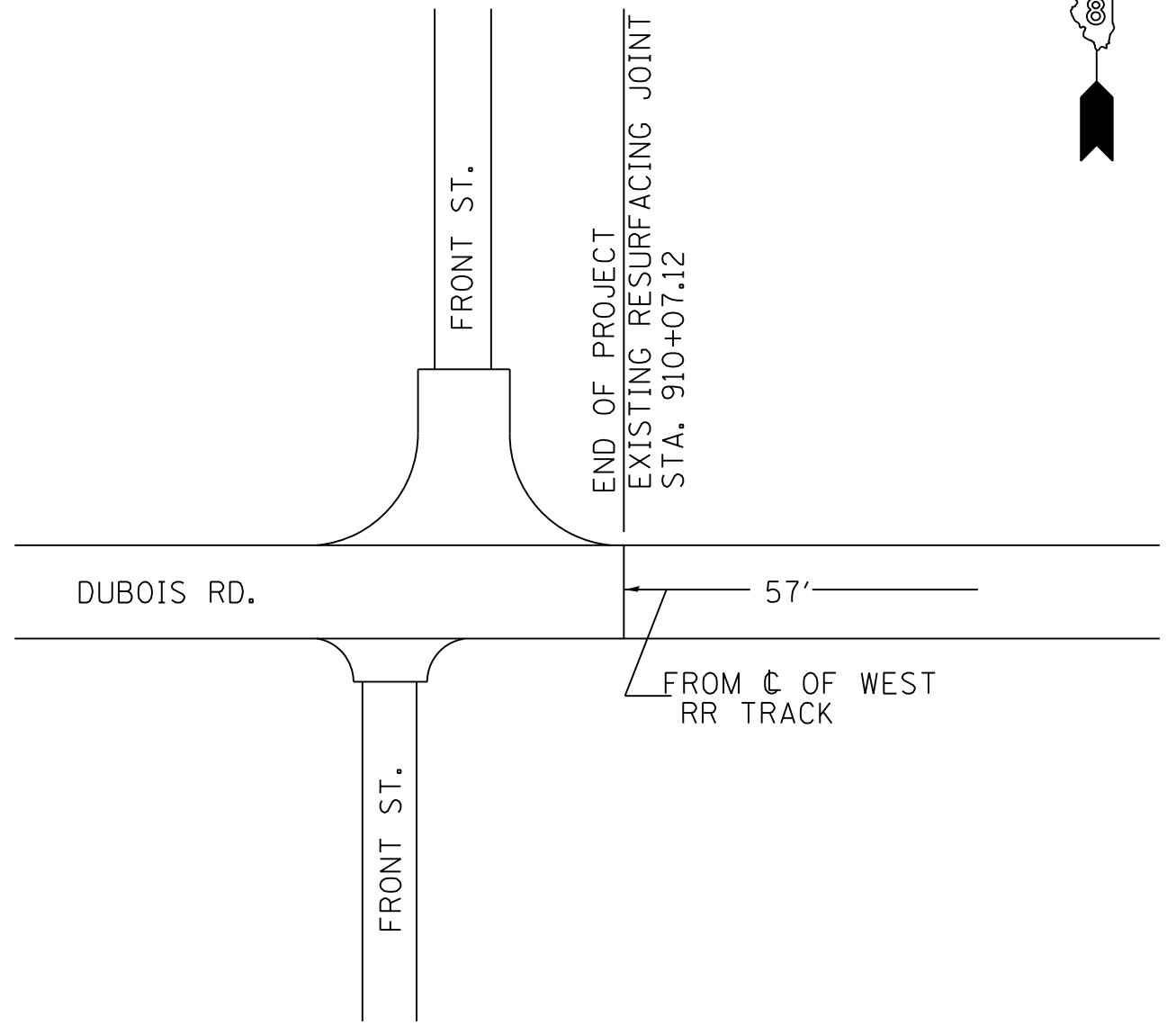
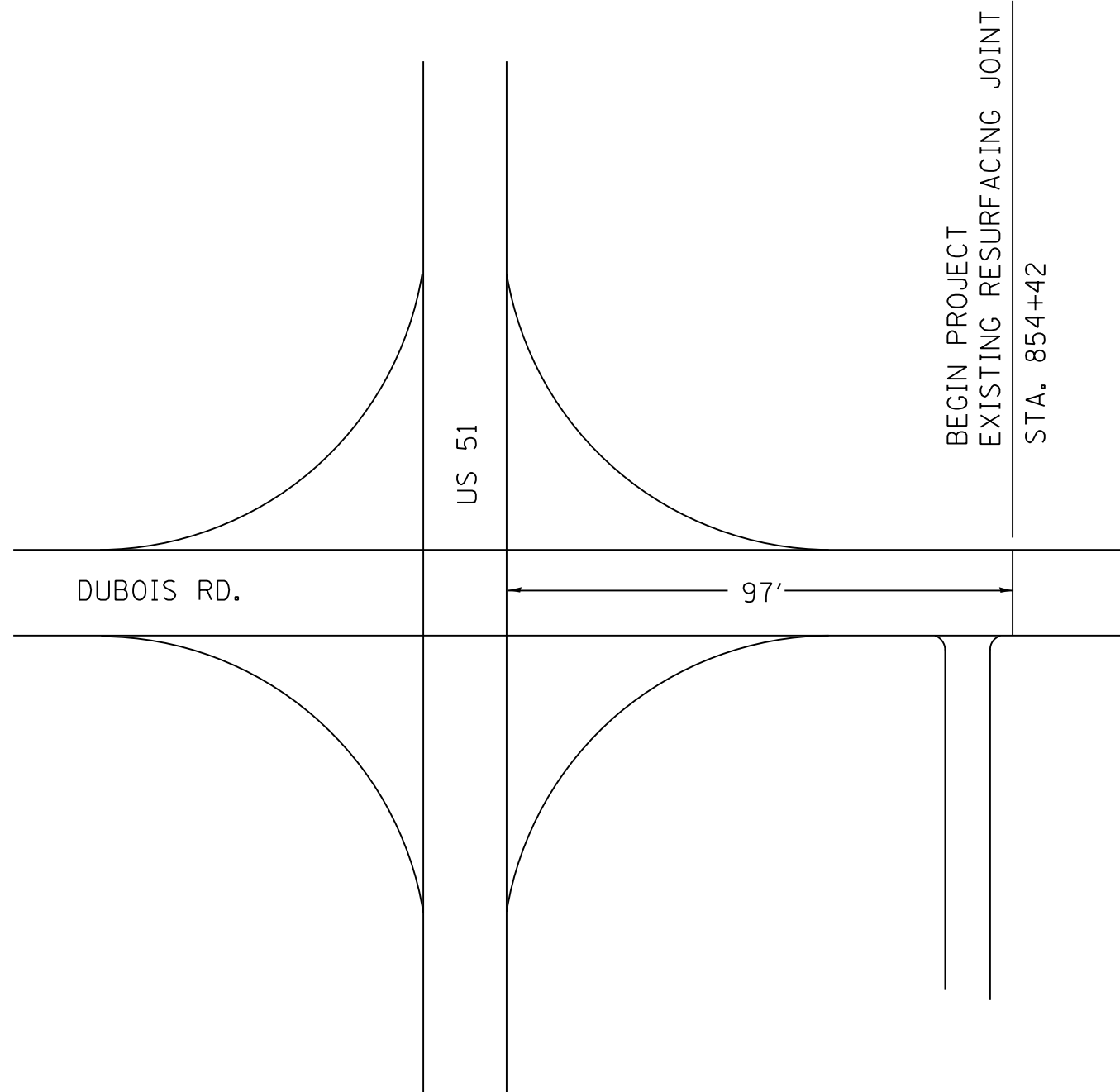

FILE NAME =	USER NAME = MurrayDA	DESIGNED -	REVISED -
p:\11\084EBIDINTEG.illinois.gov\PWIDOT\Documents\DOT Offices\District 8\Projects\0875.DRAWING\DATA\EA0sheets\0875-sht-plan.dwg		CHECKED -	REVISED -
		DATE -	REVISED -

**STATE OF ILLINOIS
DEPARTMENT OF TRANSPORTATION**

BEGIN AND END PROJECT DETAIL			
SCALE: _____	SHEET NO. ___ OF ___ SHEETS	STA. _____ TO STA. _____	

F.A.S. RTE.	SECTION	COUNTY	TOTAL SHEETS	SHEET NO.
836	IIRS-3	WASHINGTON	9	8
FED. ROAD DIST. NO. _ ILLINOIS FED. AID PROJECT				

CONTRACT NO. 76J08

