

DOWNSTREAM PAVED CHANNEL TRANSITION PLAN

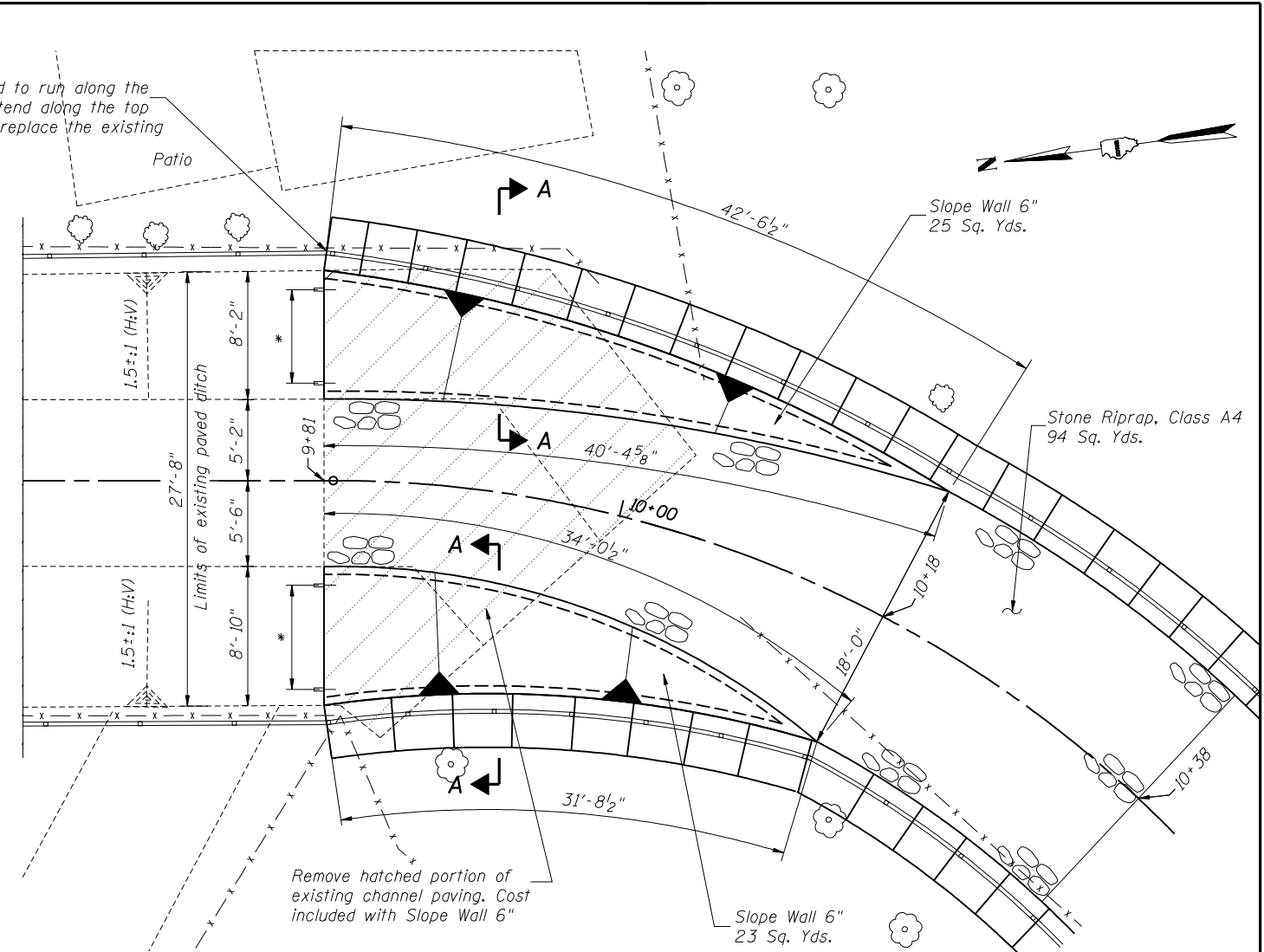

UPSTREAM PAVED CHANNEL TRANSITION PLAN

* Drill and epoxy grout #4 d(E) bars (1'-6" long) @ 2'-0" cts. into existing paved ditch per Article 584 of the IDOT Std. Spec's. Cost included with Slope Wall 6".

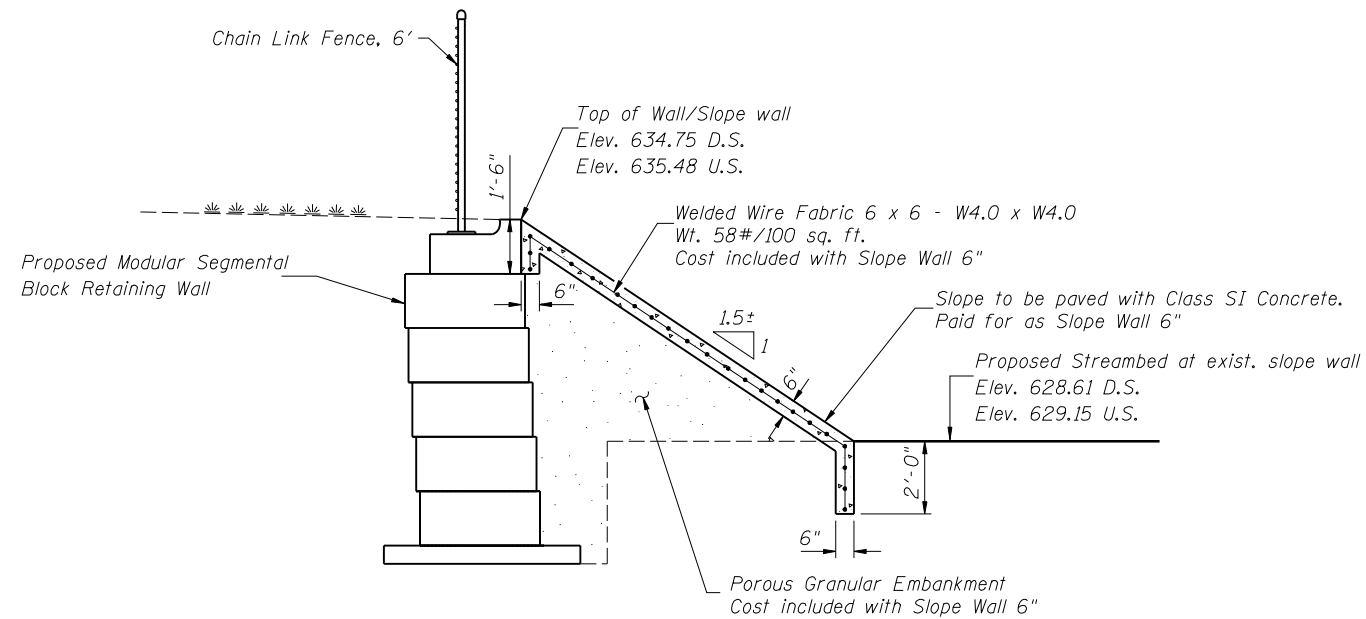

SECTION A-A

BILL OF MATERIAL

Material	Sq Yd	Quantity
Slope Wall 6"	Sq Yd	92
Stone Riprap, Class A4	Sq Yd	198

O:\Dwt\Proj\p\Projects\Crystal Creek\JF\Paved Channel Transition Details.dgn

11:58:09 AM

1/29/2010

Designed By TMM Checked By JUF
Drawn By JUF Checked By RLP