

- ① PROP. HMA SURFACE REMOVAL, 2 1/4"
- PROP. HMA SURFACE COURSE, MIX "D", N70, 1 1/2"
- PROP. POLY. LEVELING BINDER (MACHINE METHOD), IL-4.75, N50, 3/4"

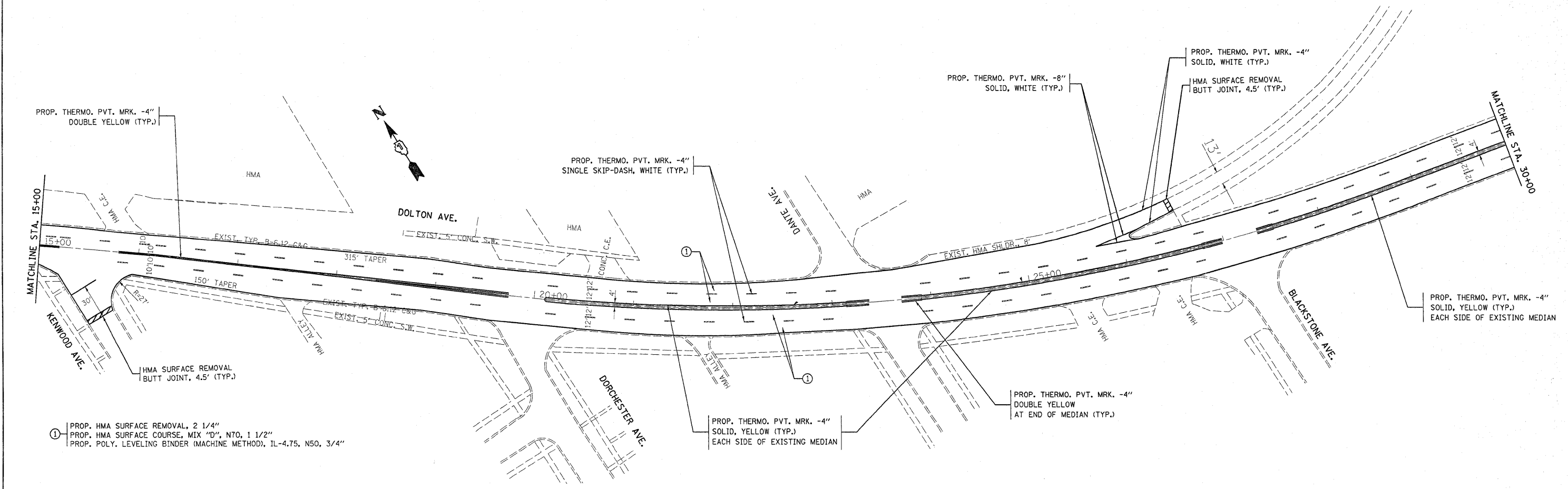

- ① PROP. HMA SURFACE REMOVAL, 2 1/4"
- PROP. HMA SURFACE COURSE, MIX "D", N70, 1 1/2"
- PROP. POLY. LEVELING BINDER (MACHINE METHOD), IL-4.75, N50, 3/4"

FILE NAME =	USER NAME = paraynoal	DESIGNED -	REVISED -	STATE OF ILLINOIS DEPARTMENT OF TRANSPORTATION	DOLTON AVE. 142nd ST. TO I-94 (BISHOP FORD EXPY.)	F.A. RTE.	SECTION	COUNTY	TOTAL SHEETS	SHEET NO.	
c:\pwwork\p\dot\paraynoal\d0146030\0183689-sht-plan.dgn	PLOT SCALE = 50.0000' / IN.	DRAWN -	REVISED -			3596	0307 RS-5	COOK	18	5	
PLOT DATE = 12/17/2009	DATE -	CHECKED -	REVISED -			SCALE: 1"=50'		SHEET NO. OF SHEETS		STA. 0+00 TO STA. 30+00	
						ILLINOIS FED. AID PROJECT		CONTRACT NO. 60H96			