

- *SIDESTREETS:
- RESURFACING LIMITS ARE TO RADIUS RETURNS WITH 4.5' BUTT JOINTS
- PROPOSED HMA SURFACE REMOVAL, 2 1/4"
- PROPOSED POLYMERIZED LEVELING BINDER (MACHINE METHOD), IL-4.75, N50, 3/4"
- PROPOSED HMA SURFACE COURSE, MIX "D", N70, 1 1/2"

NOTE:
FOR RAISED REFLECTIVE PAVEMENT MARKERS, REFER TO TYPICAL APPLICATIONS RAISED REFLECTIVE PAVEMENT MARKERS (SNOW PLOW RESISTANT) AND DISTRICT TYPICAL PAVEMENT MARKINGS

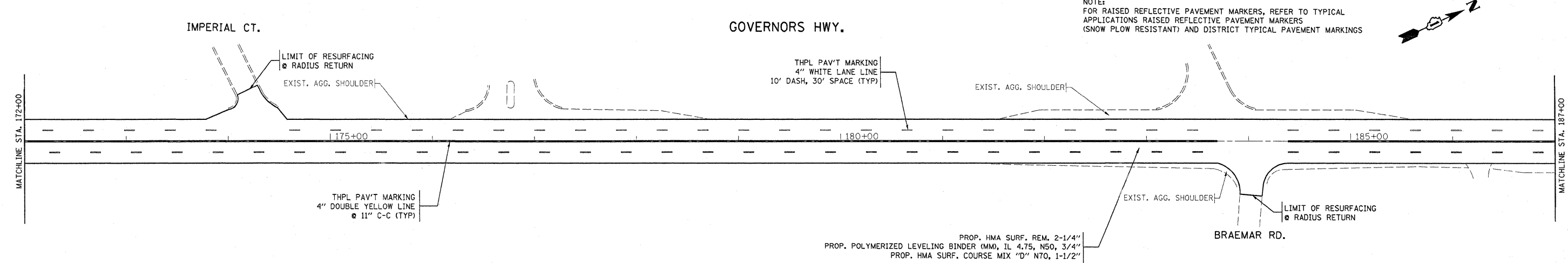

FILE NAME = c:\pwork\pwork\pwork\aqueelff\0145733\0183709-sht-plan.dgn	USER NAME = aqueelff	DESIGNED - FFA 7-20-09	REVISED -	STATE OF ILLINOIS DEPARTMENT OF TRANSPORTATION	ROADWAY AND PAVEMENT MARKING PLAN GOVERNORS HWY. (CRAWFORD AVE. - 175th ST.)			F.A.U. RTE. 2820	SECTION 44 RS-6	COUNTY COOK	TOTAL SHEETS 34	SHEET NO. 14
	PLOT SCALE = 50.0000' / IN.	CHECKED -	REVISED -					SCALE: 1"=50'	SHEET NO.	OF	SHEETS	STA.
PLOT DATE = 12/8/2009	DATE -	REVISED -	REVISED -									