

PORTLAND CONCRETE CEMENT REMOVAL (VARIABLE DEPTH) 6' WIDTH ALONG EDGES  
(SEE TYPICAL SECTIONS)  
POLYMERIZED HOT-MIX ASPHALT SURFACE COURSE, MIX "F", N90, 1 3/4"  
POLYMERIZED LEVELING BINDER (MACHINE METHDD), IL-4.75, N50, 3/4"

**LEGEND:**

- 1 THERMOPLASTIC PAVEMENT MARKING - LINE 4" (YELLOW SOLID LINE)
- 2 THERMOPLASTIC PAVEMENT MARKING - LINE 4" (WHITE LANE LINE - 10' DASH, 30' SKIP) WITH RAISED REFLECTIVE PAVEMENT MARKERS (2 ONE-WAY CRYSTAL MARKER) (80' C-C)
- 3 THERMOPLASTIC PAVEMENT MARKING - LINE 4" (YELLOW LANE LINE - 10' DASH, 30' SKIP)
- 4 THERMOPLASTIC PAVEMENT MARKING - LINE 6" (WHITE SOLID LINE)
- 5 THERMOPLASTIC PAVEMENT MARKING - LINE 6" (WHITE LANE LINE - 2' DASH, 6' SKIP)
- 6 THERMOPLASTIC PAVEMENT MARKING - LINE 8" (WHITE SOLID LINE)
- 7 THERMOPLASTIC PAVEMENT MARKING - LINE 12" (WHITE DIAGONAL LINE)
- 8 THERMOPLASTIC PAVEMENT MARKING - LINE 24" (WHITE STOP LINE)
- 9 THERMOPLASTIC PAVEMENT MARKING - LETTERS AND SYMBOLS (TYP.)
- 10 RAISED REFLECTIVE PAVEMENT MARKERS (TWO-WAY AMBER MARKER) (40' C-C)
- 11 RAISED REFLECTIVE PAVEMENT MARKERS (ONE-WAY CRYSTAL MARKER) (40' C-C)
- 12 THERMOPLASTIC PAVEMENT MARKING - LINE 12" (YELLOW DIAGONAL LINE)

PORTLAND CEMENT CONCRETE SURFACE REMOVAL - BUTT JOINT

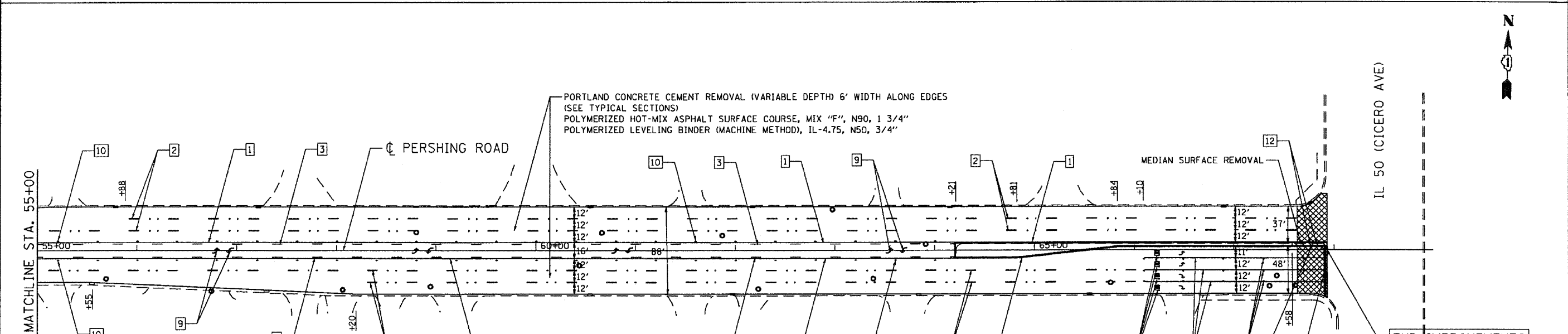

PORTLAND CONCRETE CEMENT REMOVAL (VARIABLE DEPTH) 6' WIDTH ALONG EDGES  
(SEE TYPICAL SECTIONS)  
POLYMERIZED HOT-MIX ASPHALT SURFACE COURSE, MIX "F", N90, 1 3/4"  
POLYMERIZED LEVELING BINDER (MACHINE METHOD), IL-4.75, N50, 3/4"

**LEGEND:**

- 1 THERMOPLASTIC PAVEMENT MARKING - LINE 4" (YELLOW SOLID LINE)
- 2 THERMOPLASTIC PAVEMENT MARKING - LINE 4" (WHITE LANE LINE - 10' DASH, 30' SKIP) WITH RAISED REFLECTIVE PAVEMENT MARKERS (2 ONE-WAY CRYSTAL MARKER) (80' C-C)
- 3 THERMOPLASTIC PAVEMENT MARKING - LINE 4" (YELLOW LANE LINE - 10' DASH, 30' SKIP)
- 4 THERMOPLASTIC PAVEMENT MARKING - LINE 6" (WHITE SOLID LINE)
- 5 THERMOPLASTIC PAVEMENT MARKING - LINE 6" (WHITE LANE LINE - 2' DASH, 6' SKIP)
- 6 THERMOPLASTIC PAVEMENT MARKING - LINE 8" (WHITE SOLID LINE)
- 7 THERMOPLASTIC PAVEMENT MARKING - LINE 12" (WHITE DIAGONAL LINE)
- 8 THERMOPLASTIC PAVEMENT MARKING - LINE 24" (WHITE STOP LINE)
- 9 THERMOPLASTIC PAVEMENT MARKING - LETTERS AND SYMBOLS (TYP.)
- 10 RAISED REFLECTIVE PAVEMENT MARKERS (TWO-WAY AMBER MARKER) (40' C-C)
- 11 RAISED REFLECTIVE PAVEMENT MARKERS (ONE-WAY CRYSTAL MARKER) (40' C-C)
- 12 THERMOPLASTIC PAVEMENT MARKING - LINE 12" (YELLOW DIAGONAL LINE)

PORTLAND CEMENT CONCRETE SURFACE REMOVAL - BUTT JOINT

END IMPROVEMENTS  
STA. 67+93  
MATCH EXISTING  
PAVEMENT MARKINGS

FILE NAME: c:\p\proj\3386\3386\_31\design\pershing\pershing.dwg

**Ciorba Group, Inc.**  
CONSULTING ENGINEERS  
5507 North Cumberland Avenue, Suite 402  
Chicago, Illinois 60658  
Tel. 773.775.4009 Fax 773.775.4014

USER NAME = wlaneaster	DESIGNED - MWR	REVISED -
	DRAWN - MWR	REVISED -
PLOT SCALE = 100.0000' / IN.	CHECKED - SNS	REVISED -
PLOT DATE = 12/4/2009	DATE = 7/8/2009	REVISED -

**STATE OF ILLINOIS  
DEPARTMENT OF TRANSPORTATION**

**PERSHING ROAD  
CENTRAL AVENUE TO IL 50 (CICERO AVENUE)  
PROPOSED ROADWAY AND PAVEMENT MARKING PLAN**

SCALE: 1"=50' SHEET NO. OF SHEETS STA. TO STA.

F.A.I. RTE.	SECTION	COUNTY	TOTAL SHEETS	SHEET NO.
1477	0811 RS	COOK	28	6
CONTRACT NO. 60H99			FED. ROAD DIST. NO. 1 ILLINOIS FED. AID PROJECT	