

DATE	
BY	
FINAL SURVEY	
NO. E. BOOK	
NO.	
SURVEYED	
TEMPLATE	
AREAS CHECKED	

DATE	
BY	
ORIGINAL SURVEY	
NOTE BOOK	
NO.	
SURVEYED	
TEMPLATE	
AREAS CHECKED	

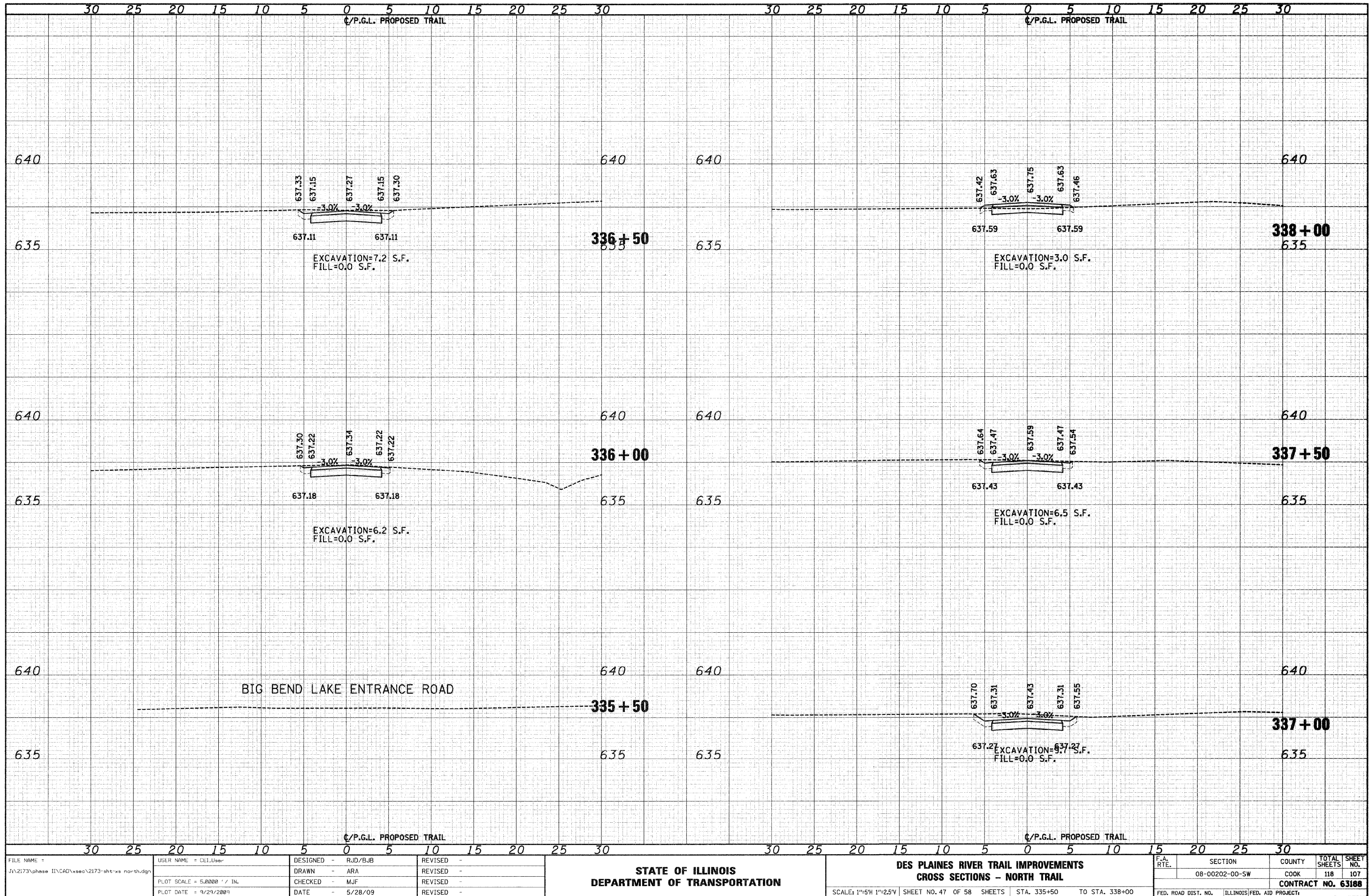

FILE NAME = J:\2173\phase II\CAD\sec\2173-sht-ns north.dgn

USER NAME = CEI\User
 PLOT SCALE = 5.0000' / IN.
 PLOT DATE = 9/29/2009

DESIGNED -	RJD/BJB	REVISED -	
DRAWN -	ARA	REVISED -	
CHECKED -	MJF	REVISED -	
DATE -	5/28/09	REVISED -	

**STATE OF ILLINOIS
DEPARTMENT OF TRANSPORTATION**

**DES PLAINES RIVER TRAIL IMPROVEMENTS
CROSS SECTIONS - NORTH TRAIL**

SCALE: 1"=5'H 1"=2.5'V SHEET NO. 47 OF 58 SHEETS STA. 335+50 TO STA. 338+00

F.A. RTE.	SECTION	COUNTY	TOTAL SHEETS
	08-00202-00-SW	COOK	118
FED. ROAD DIST. NO. [ILLINOIS] FED. AID PROJECT:			SHEET NO. 107
			CONTRACT NO. 63188