

SECTION 2, TOWNSHIP 37, RANGE 12
SECTION 11, TOWNSHIP 37, RANGE 12

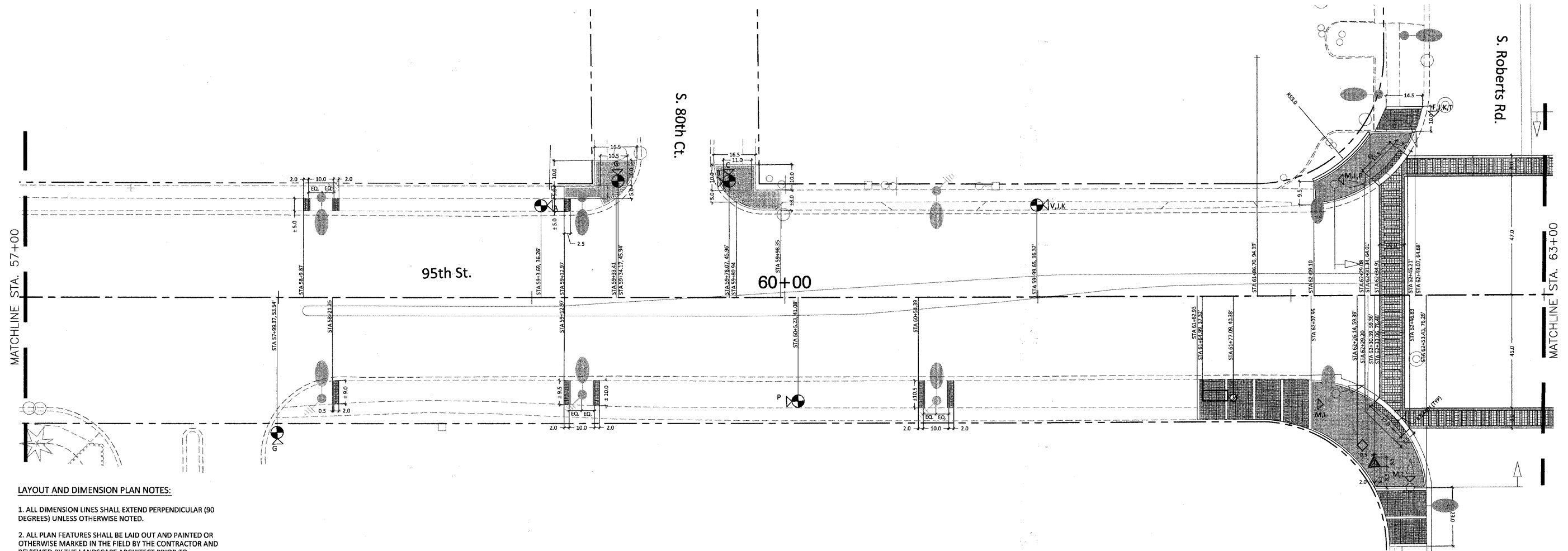

LAYOUT AND DIMENSION PLAN NOTES:

1. ALL DIMENSION LINES SHALL EXTEND PERPENDICULAR (90 DEGREES) UNLESS OTHERWISE NOTED.
2. ALL PLAN FEATURES SHALL BE LAID OUT AND PAINTED OR OTHERWISE MARKED IN THE FIELD BY THE CONTRACTOR AND REVIEWED BY THE LANDSCAPE ARCHITECT PRIOR TO CONSTRUCTION.
3. UNLESS OTHERWISE NOTED, ALL ANGLES ARE 90 DEGREES OR 45 DEGREES.
4. ALL CURB DIMENSIONS ARE GIVEN TO THE BACK OF CURB.
5. ALL EXPANSION AND CONTROL JOINTS SHALL BE LOCATED AS SHOWN IN THE DRAWINGS.
6. ALL CONCRETE PLANTER CURBS AT LIGHTPOLE FOUNDATIONS TO BE ADJUSTED PER FIELD CONDITIONS. THIS IS TO ENSURE THE PLANTER BED IS CENTERED ON EXISTING LIGHTPOLE.
7. ALL DIMENSIONS TO TRANSIT SHELTERS ARE APPROXIMATE. ALL SHELTERS TO BE LOCATED IN FIELD BY THE CONTRACTOR BEFORE REMOVAL AND FOR FUTURE REFERENCE IN REINSTALLATION.

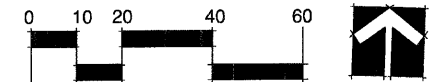

FILE NAME = pti_dimension plan - IDOT P42

USER NAME =	DESIGNED — BCL	REVISED — 10/30/2009
	CHECKED — KLG	REVISED — 11/30/09
PLOT SCALE = 1"=20'	DRAWN — BCL/RJA	REVISED — 12/17/2009
PLOT DATE = 8/21/09	CHECKED — KLG/LMV	REVISED — 12/30/2009

STATE OF ILLINOIS
DEPARTMENT OF TRANSPORTATION

DIMENSION PLAN

SCALE: 1"=20' SHEET NO. 42 OF 62 SHEETS STA. 57+00 TO STA. 63+00

F.A.P. RTE.	SECTION	COUNTY	TOTAL SHEETS	SHEET NO.
29	09-00058-00-LS	COOK	62	42
CONTRACT NO. 63321				
FED. ROAD DIST. NO. 1 ILLINOIS FED. AID PROJECT ARA-9003(343)				

PLANNING
RESOURCES INC.
402 New Liberty Drive
Itasca, Illinois 60143
Tel: 630.456.1700