

F.A.U. RTE.	SECTION	COUNTY	TOTAL SHEETS	SHEET NO.
1392	09-00172-00-PK	DUPAGE	18	1

CONTRACT NO. 63382

- INDEX OF SHEETS**
- 1 COVER SHEET AND INDEX OF SHEETS
  - 2 GENERAL NOTES, HIGHWAY STANDARDS, AND SUMMARY OF QUANTITIES
  - 3-4 TYPICAL SECTIONS
  - 5-8 IMPROVEMENT PLANS
  - 9 TC-10 TRAFFIC CONTROL AND PROTECTION FOR SIDE ROADS, INTERSECTIONS AND DRIVEWAYS
  - 10 TC-13 DISTRICT ONE TYPICAL PAVEMENT MARKINGS
  - 11 PARKING PAVEMENT MARKING DETAILS AND LIGHTING DETAILS
  - 12-18 CROSS SECTIONS

STATE OF ILLINOIS  
DEPARTMENT OF TRANSPORTATION  
DIVISION OF HIGHWAYS  
**PLANS FOR PROPOSED  
FEDERAL AID HIGHWAY PROJECT**

**FAU ROUTE 1392 (FIRST STREET)  
MYRTLE AVENUE TO CLARA PLACE  
ON-STREET PARKING CONSTRUCTION  
SECTION 09-00172-00-PK  
PROJECT ARA-9003(412)  
DUPAGE COUNTY  
JOB NO. C-91-795-09**



DESIGN DESIGNATION:  
LOCAL ROAD

ADT:  
FIRST STREET (WEST AVENUE TO YORK ROAD) 1,800 (2008) 2,000 (2030)  
FIRST STREET (YORK ROAD TO BERTEAU AVENUE) 2,000 (2008) 3,000 (2030)

FIRST STREET  
POSTED SPEED = 25 MPH  
DESIGN SPEED = 25 MPH

PROJECT IS LOCATED IN THE CITY OF ELMHURST

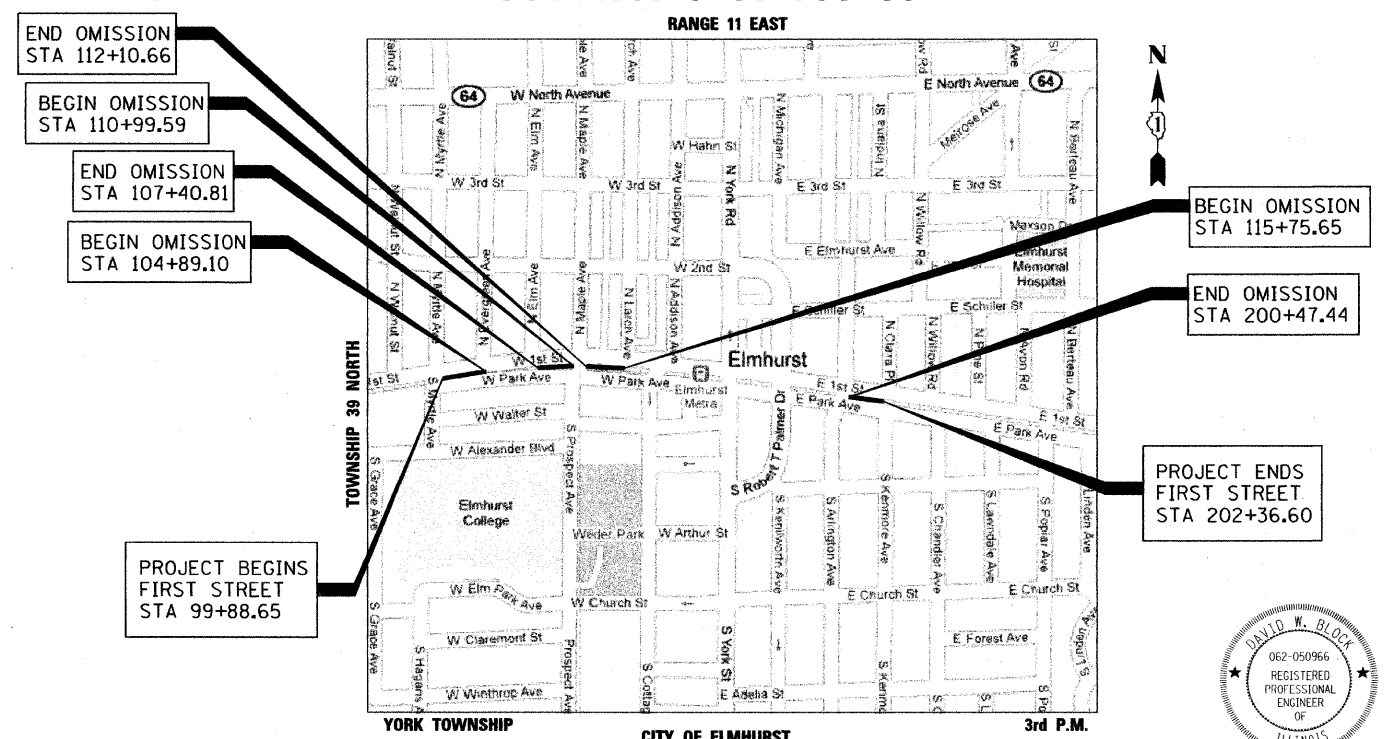

**LOCATION MAP**  
NOT TO SCALE

**PROJECT LENGTH**  
FIRST STREET IMPROVEMENT (GROSS) = 3,782 FT (0.72 MILES)  
FIRST STREET IMPROVEMENT (NET) = 1,413.38 FT (0.27 MILES)

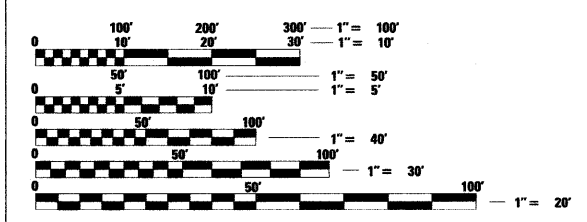

FULL SIZE PLANS HAVE BEEN PREPARED USING STANDARD ENGINEERING SCALES. REDUCED SIZED PLANS WILL NOT CONFORM TO STANDARD SCALES. IN MAKING MEASUREMENTS ON REDUCED PLANS, THE ABOVE SCALES MAY BE USED.

**J.U.L.I.E.**  
JOINT UTILITY LOCATION INFORMATION FOR EXCAVATION  
1-800-992-0123 OR 811

**CONTRACT NO. 63382**

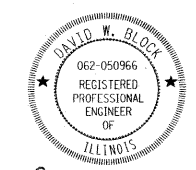

*David W. Block* 11-30-09  
DAVID W. BLOCK, P.E.  
NO. 062-050966  
EXP. DATE 11/30/11

STATE OF ILLINOIS  
DEPARTMENT OF TRANSPORTATION  
DIVISION OF HIGHWAYS

APPROVED *Nov. 30, 2009*  
*Michael J. Hughes*  
CITY OF ELMHURST, DIRECTOR OF PUBLIC WORKS

PASSED *DECEMBER 3, 2009*  
*C. Hest*  
DISTRICT ENGINEER OF LOCAL ROADS & STREETS

RELEASING FOR BID  
BASED ON LIMITED  
REVIEW *DECEMBER 10, 2009*  
*Diana M. O'Keefe*  
DEPUTY DIRECTOR OF HIGHWAYS, REGION 1 ENGINEER

**PRINTED BY THE AUTHORITY  
OF THE STATE OF ILLINOIS**

IDOT FEDERAL AID DESIGN ENGINEER  
MARILYN SOLOMON 847/705-4407

1061 PERIMETER DRIVE, SUITE 1025  
SCHAMBURG, ILLINOIS 60173  
(847) 605-9800

