

F.A.U. RTE.	SECTION	COUNTY	TOTAL SHEETS	SHEET NO.
1392	09-00172-00-PK	DUPAGE	18	1

CONTRACT NO. 63382

- INDEX OF SHEETS**
- 1 COVER SHEET AND INDEX OF SHEETS
  - 2 GENERAL NOTES, HIGHWAY STANDARDS, AND SUMMARY OF QUANTITIES
  - 3-4 TYPICAL SECTIONS
  - 5-8 IMPROVEMENT PLANS
  - 9 TC-10 TRAFFIC CONTROL AND PROTECTION FOR SIDE ROADS, INTERSECTIONS AND DRIVEWAYS
  - 10 TC-13 DISTRICT ONE TYPICAL PAVEMENT MARKINGS
  - 11 PARKING PAVEMENT MARKING DETAILS AND LIGHTING DETAILS
  - 12-18 CROSS SECTIONS

STATE OF ILLINOIS  
DEPARTMENT OF TRANSPORTATION  
DIVISION OF HIGHWAYS  
**PLANS FOR PROPOSED  
FEDERAL AID HIGHWAY PROJECT**

**FAU ROUTE 1392 (FIRST STREET)  
MYRTLE AVENUE TO CLARA PLACE  
ON-STREET PARKING CONSTRUCTION  
SECTION 09-00172-00-PK  
PROJECT ARA-9003(412)  
DUPAGE COUNTY  
JOB NO. C-91-795-09**



DESIGN DESIGNATION:  
LOCAL ROAD

ADT:  
FIRST STREET (WEST AVENUE TO YORK ROAD) 1,800 (2008) 2,000 (2030)  
FIRST STREET (YORK ROAD TO BERTEAU AVENUE) 2,000 (2008) 3,000 (2030)

FIRST STREET  
POSTED SPEED = 25 MPH  
DESIGN SPEED = 25 MPH

PROJECT IS LOCATED IN  
THE CITY OF ELMHURST

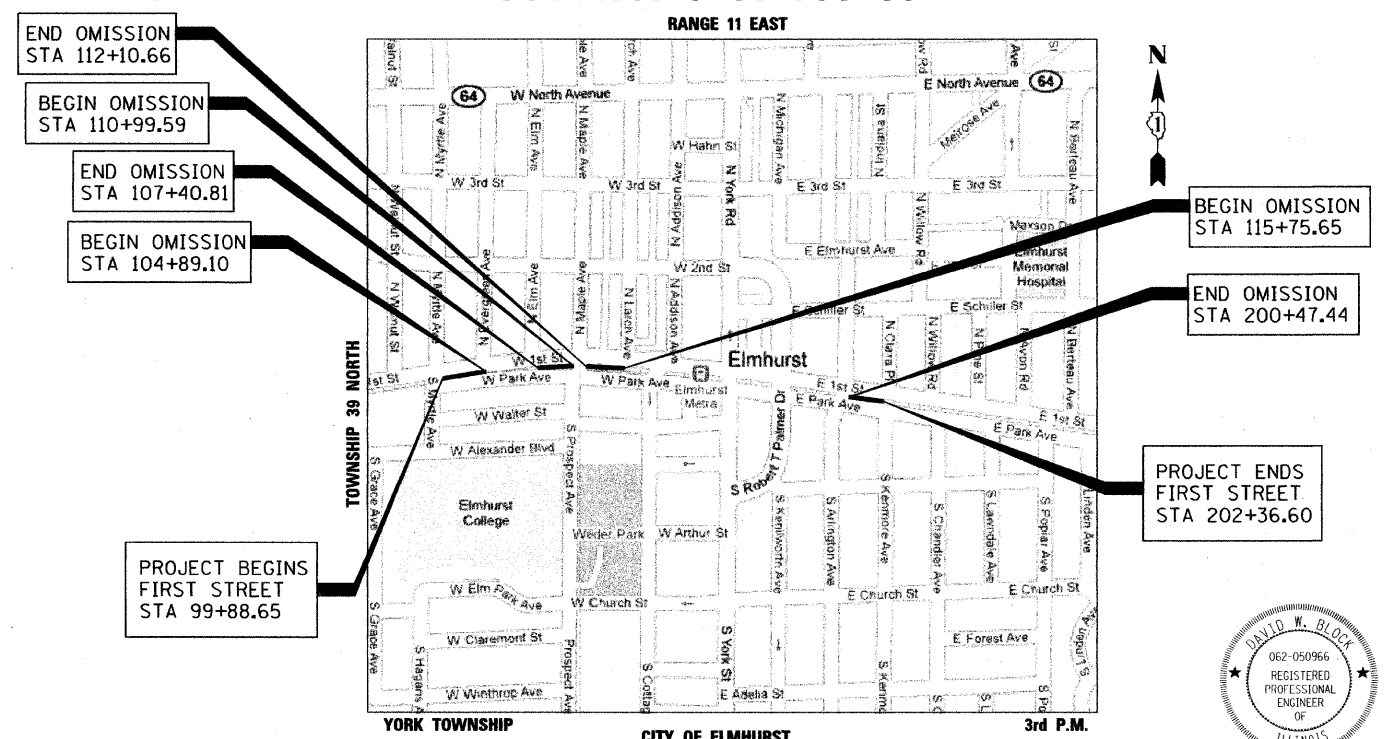

**LOCATION MAP**  
NOT TO SCALE

**PROJECT LENGTH**  
FIRST STREET IMPROVEMENT (GROSS) = 3,782 FT (0.72 MILES)  
FIRST STREET IMPROVEMENT (NET) = 1,413.38 FT (0.27 MILES)

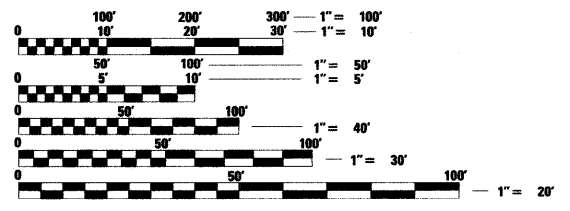

FULL SIZE PLANS HAVE BEEN PREPARED USING STANDARD ENGINEERING SCALES. REDUCED SIZED PLANS WILL NOT CONFORM TO STANDARD SCALES. IN MAKING MEASUREMENTS ON REDUCED PLANS, THE ABOVE SCALES MAY BE USED.

**J.U.L.I.E.**  
JOINT UTILITY LOCATION INFORMATION FOR EXCAVATION  
1-800-992-0123 OR 811

**CONTRACT NO. 63382**

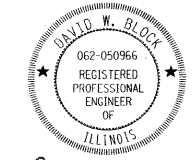

*David W. Block* 11-30-09  
DAVID W. BLOCK, P.E.  
NO. 062-050966  
EXP. DATE 11/30/11

STATE OF ILLINOIS  
DEPARTMENT OF TRANSPORTATION  
DIVISION OF HIGHWAYS

APPROVED *Nov. 30, 2009*  
*Michael J. Hughes*  
CITY OF ELMHURST, DIRECTOR OF PUBLIC WORKS

PASSED *DECEMBER 3, 2009*  
*C. Hest*  
DISTRICT ENGINEER OF LOCAL ROADS & STREETS

RELEASING FOR BID  
BASED ON LIMITED  
REVIEW *DECEMBER 10, 2009*  
*Diana M. O'Keefe*  
DEPUTY DIRECTOR OF HIGHWAYS, REGION 1 ENGINEER

**PRINTED BY THE AUTHORITY  
OF THE STATE OF ILLINOIS**

I.D.O.T. FEDERAL AID DESIGN ENGINEER  
MARILYN SOLOMON 847/705-4407

1061 PERIMETER DRIVE, SUITE 1025  
SCHALMERSBURG, ILLINOIS 60173  
(847) 605-9800



**GENERAL NOTES**

- ALL REFERENCES TO "STANDARD SPECIFICATIONS" IN THESE GENERAL NOTES SHALL BE INTERPRETED TO MEAN "STANDARD SPECIFICATIONS FOR ROAD AND BRIDGE CONSTRUCTION" ADOPTED BY THE ILLINOIS DEPARTMENT OF TRANSPORTATION, JANUARY 1, 2007.
- ALL REFERENCES TO "ENGINEER" SHALL BE INTERPRETED TO MEAN THE RESIDENT ENGINEER.
- PRIOR TO COMMENCEMENT OF CONSTRUCTION, THE CONTRACTOR SHALL VERIFY ALL DIMENSIONS AND CONDITIONS AFFECTING THE WORK WITH THE ACTUAL CONDITIONS AT THE JOB SITE. IN ADDITION, THE CONTRACTOR MUST VERIFY THE ENGINEER'S LINE AND GRADE STAKES. IF THERE ARE DISCREPANCIES FROM WHAT IS SHOWN ON THE CONSTRUCTION PLANS, HE MUST IMMEDIATELY REPORT SAME TO THE ENGINEER BEFORE DOING ANY WORK, OTHERWISE THE CONTRACTOR ASSUMES FULL RESPONSIBILITY. IN THE EVENT OF DISAGREEMENT BETWEEN THE CONSTRUCTION PLANS, STANDARD SPECIFICATIONS AND/OR SPECIAL DETAILS, THE CONTRACTOR SHALL SECURE WRITTEN INSTRUCTIONS FROM THE ENGINEER PRIOR TO PROCEEDING WITH ANY PART OF THE WORK AFFECTED BY OMISSIONS OR DISCREPANCIES. FAILING TO SECURE SUCH INSTRUCTIONS, THE CONTRACTOR WILL BE CONSIDERED TO HAVE PROCEEDED AT HIS OWN RISK AND EXPENSE IN THE EVENT OF ANY DOUBT OR QUESTION ARISING WITH RESPECT TO THE TRUE MEANING OF THE CONSTRUCTION PLANS OR SPECIFICATIONS, THE DECISION OF THE ENGINEER SHALL BE FINAL AND CONCLUSIVE.
- IT IS THE CONTRACTOR'S RESPONSIBILITY TO ASCERTAIN EXISTING FIELD CONDITIONS PRIOR TO BIDDING ON THE PROJECT.
- BEFORE STARTING ANY EXCAVATION, THE CONTRACTOR SHALL CALL "JULIE" (JOINT UTILITY LOCATION INFORMATION FOR EXCAVATION) AT 8-1-1, KANDICE WITH UNION PACIFIC RAILROAD UTILITIES AT (312) 496-4738, THE FIBER OPTICS HOTLINE AT (800) 336-9193 AND THE CITY OF ELMHURST AT 630-530-3777 FOR FIELD LOCATIONS OF BURIED UTILITIES (48 HOURS NOTIFICATION IS REQUIRED).
- THE CONTRACTOR WILL NOT BE ALLOWED TO SET UP A YARD OR FIELD OFFICE ON STATE OR CITY PROPERTY OR RAILROAD PROPERTY WITHOUT WRITTEN PERMISSION FROM THE DEPARTMENT OR CITY.
- THE CONTRACTOR WILL NOT BE ALLOWED TO SET UP A YARD, FIELD OFFICE, OR STOCK PILE MATERIALS ON UNION PACIFIC PROPERTY, WITHOUT WRITTEN PERMISSION.

**UTILITY NOTES**

- THE CONTRACTOR SHALL BE RESPONSIBLE FOR CONTACTING THE OWNERS OF ALL UTILITIES PRIOR TO CONSTRUCTION TO DETERMINE THE LOCATION OF ALL UTILITY EQUIPMENT. THE CONTRACTOR SHALL COOPERATE WITH ALL UTILITY OWNERS IN ACCORDANCE WITH THE STANDARD SPECIFICATIONS IF UTILITY RELOCATION, ADJUSTMENT, OR PROTECTION IS NECESSARY.
- THE LOCATION OF EXISTING DRAINAGE STRUCTURES, STORM SEWERS, WATER MAINS, SANITARY SEWERS, AND ANY OTHER PUBLIC UTILITIES AS SHOWN ON THE PLANS IS APPROXIMATE AND THEIR EXACT LOCATION IS TO BE DETERMINED IN THE FIELD BY THE CONTRACTOR. THIS WORK SHALL BE CONSIDERED AS INCLUDED IN THE UNIT BID PRICES OF THE CONTRACT, AND NO ADDITIONAL COMPENSATION WILL BE ALLOWED.
- THE CONTRACTOR SHALL BE RESPONSIBLE FOR THE PROTECTION OF ALL UNDERGROUND AND SURFACE UTILITIES EVEN IF NOT SHOWN ON THE PLANS. ALL UTILITY PROPERTY DAMAGED DURING CONSTRUCTION SHALL BE REPAIRED OR REPLACED TO THE SATISFACTION OF THE OWNER AT THE CONTRACTOR'S EXPENSE.
- ALL UTILITY OWNERS SHALL BE NOTIFIED AT LEAST 3 DAYS PRIOR TO THE START OF CONSTRUCTION.
- THE CONTRACTOR SHALL USE ALL NECESSARY PRECAUTIONS AND PROTECTION MEASURES REQUIRED TO MAINTAIN EXISTING UTILITIES, SEWERS, AND APPURTENANCES THAT MUST BE KEPT IN OPERATION.
- THE CONTRACTOR SHALL PROVIDE ACCESS TO ALL WATER SYSTEM VALVES, VALVE VAULTS, AND SANITARY SEWER MANHOLES TO THE CITY FOR EMERGENCY OPERATIONS. THE LOCATIONS OF ALL WATER AND SANITARY FACILITIES SHALL BE MARKED AND READILY VISIBLE AT ALL TIMES.

7. ALL LOOSE MATERIAL DEPOSITED IN THE FLOWLINE OF DRAINAGE STRUCTURES, WHICH OBSTRUCTS THE NATURAL FLOW OF WATER SHALL BE REMOVED AT THE CLOSE OF EACH WORKING DAY. PRIOR TO ACCEPTANCE OF THE IMPROVEMENT, ALL DRAINAGE STRUCTURES SHALL BE FREE OF DIRT AND DEBRIS. THIS WORK WILL NOT BE PAID FOR SEPARATELY, BUT SHALL BE CONSIDERED AS INCLUDED IN THE UNIT BID PRICES OF THE CONTRACT.

**SIGNING AND STRIPING**

- SEE IDOT STANDARD DETAIL 780001, DISTRICT ONE DETAIL TC-13 AND PLAN SHEETS FOR PAVEMENT MARKING DETAILS.
- THE CONTRACTOR SHALL TEMPORARILY RESET ALL SIGNS THAT INTERFERE WITH CONSTRUCTION OPERATIONS. ALL SUCH SIGNS MUST BE MAINTAINED STRAIGHT AND CLEAN FOR THE DURATION OF THE TEMPORARY SETTING AND MUST BE RE-ERECTED AT A TEMPORARY LOCATION IN A WORKMANLIKE MANNER AND BE VISIBLE TO THE TRAFFIC FOR WHICH IT IS INTENDED. THIS WORK WILL NOT BE PAID FOR SEPARATELY, BUT SHALL BE INCLUDED IN THE UNIT BID PRICES OF THE CONTRACT.

**TRAFFIC CONTROL**

- SEE TRAFFIC CONTROL HIGHWAY STANDARDS CONCERNING TRAFFIC CONTROL AND PROTECTION.
- THE CONTRACTOR SHALL SCHEDULE CONSTRUCTION ACTIVITIES SO THAT THERE ARE ALWAYS TWO LANES OF TRAFFIC OPEN AT THE END OF EACH DAY. DETOURS WILL ONLY BE ALLOWED UPON SUBMITTAL OF A DETOUR PLAN AND APPROVED BY THE ENGINEER. THIS WORK WILL NOT BE PAID FOR SEPARATELY BUT SHALL BE INCLUDED IN THE COST OF TRAFFIC CONTROL STANDARD PAY ITEMS.

NOTE: BOXED ITEMS ARE INCLUDED IN THE COST OF THE CONTRACT.

**HIGHWAY STANDARDS**

STD. NO.	DESCRIPTION		
000001-05	STANDARD SYMBOLS, ABBREVIATIONS AND PATTERNS	720001-01	SIGN PANEL MOUNTING DETAILS
602001-01	CATCH BASIN, TYPE A	720006-02	SIGN PANEL ERECTION DETAILS
602301-02	INLET, TYPE A	720011-01	METAL POSTS FOR SIGNS, MARKERS & DELINEATORS
602401-02	MANHOLE, TYPE A	729001-01	APPLICATION OF TYPES A & B METAL POSTS (FOR SIGNS AND MARKERS)
602601-02	PRECAST REINFORCED CONCRETE FLAT TOP SLAB	780001-02	TYPICAL PAVEMENT MARKINGS
604001-03	FRAME AND LID, TYPE 1		
604051-03	FRAME AND GRATE, TYPE 11		
606001-04	CONCRETE CURB TYPE B AND COMBINATION CONCRETE CURB AND GUTTER		
664001-02	CHAIN LINK FENCE		
701301-03	LANE CLOSURE, 2L, 2W, SHORT TIME OPERATIONS		
701311-03	LANE CLOSURE, 2L, 2W, MOVING OPERATIONS-DAY ONLY		
701501-05	URBAN LANE CLOSURE, 2L, 2W, UNDIVIDED		
701701-06	URBAN LANE CLOSURE, MULTILANE INTERSECTION		
701801-04	LANE CLOSURE MULTILANE 1W OR 2W CROSSWALK OR SIDEWALK CLOSURE		
701901-01	TRAFFIC CONTROL DEVICES		

SUMMARY OF QUANTITIES				1000-2A ROADWAY 100% ARRA
* CODE NO	PAY ITEM	UNIT	QUANTITY	
20101100	TREE TRUNK PROTECTION	EACH	1	1
20200100	EARTH EXCAVATION	CU YD	1,790	1,790
20201200	REMOVAL AND DISPOSAL OF UNSUITABLE MATERIAL	CU YD	5	5
20700420	POROUS GRANULAR EMBANKMENT, SUBGRADE	CU YD	5	5
20800150	TRENCH BACKFILL	CU YD	122	122
21101625	TOPSOIL FURNISH AND PLACE, 6"	SO YD	1,388	1,388
25000400	NITROGEN FERTILIZER NUTRIENT	POUND	18	18
25000500	PHOSPHORUS FERTILIZER NUTRIENT	POUND	18	18
25000600	POTASSIUM FERTILIZER NUTRIENT	POUND	18	18
25200110	SODDING, SALT TOLERANT	SO YD	1,388	1,388
25200200	SUPPLEMENTAL WATERING	UNIT	33	33
35300305	PORTLAND CEMENT CONCRETE BASE COURSE 8 1/4"	SO YD	42	42
35501308	HOT-MIX ASPHALT BASE COURSE, 6"	SO YD	402	402
40600100	BITUMINOUS MATERIALS (PRIME COAT)	GALLON	210	210
40600300	AGGREGATE (PRIME COAT)	TON	0.1	0.1
40603080	HOT-MIX ASPHALT BINDER COURSE, IL-19.0, N50	TON	208	208
40603310	HOT-MIX ASPHALT SURFACE COURSE, MIX "C", N50	TON	166	166
42001300	PROTECTIVE COAT	SO YD	35	35
44000100	PAVEMENT REMOVAL	SO YD	383	383
44000500	COMBINATION CURB AND GUTTER REMOVAL	FOOT	782	782
550A0340	STORM SEWERS, CLASS A, TYPE 2 12"	FOOT	258	258
55100500	STORM SEWER REMOVAL 12"	FOOT	10	10
60200105	CATCH BASINS, TYPE A, 4'-DIAMETER, TYPE 1 FRAME, OPEN LID	EACH	2	2
60201105	CATCH BASINS, TYPE A, 4'-DIAMETER, TYPE 11 FRAME AND GRATE	EACH	1	1
60218400	MANHOLES, TYPE A, 4'-DIAMETER, TYPE 1 FRAME, CLOSED LID	EACH	1	1
60234200	INLETS, TYPE A, TYPE 1 FRAME, OPEN LID	EACH	1	1
60260100	INLETS TO BE ADJUSTED	EACH	1	1
60266600	VALVE BOXES TO BE ADJUSTED	EACH	1	1
60500060	REMOVING INLETS	EACH	1	1
60603800	COMBINATION CONCRETE CURB AND GUTTER, TYPE B-6.12	FOOT	2,018	2,018
63200310	GUARDRAIL REMOVAL	FOOT	372	372
66400205	CHAIN LINK FENCE, 5'	FOOT	1,408	1,408
66900205	SPECIAL WASTE DISPOSAL	CU YD	1,614	1,614
66900450	SPECIAL WASTE PLANS AND REPORT	L SUM	1	1
66900530	SOIL DISPOSAL ANALYSIS	EACH	4	4
67100100	MOBILIZATION	L SUM	1	1
70102620	TRAFFIC CONTROL AND PROTECTION, STANDARD 701501	L SUM	1	1
70102635	TRAFFIC CONTROL AND PROTECTION, STANDARD 701701	L SUM	1	1
72000100	SIGN PANEL - TYPE 1	SO FT	13	13
72400500	RELOCATE SIGN PANEL ASSEMBLY - TYPE A	EACH	10	10
72400710	RELOCATE SIGN PANEL - TYPE 1	SO FT	2	2
72900100	METAL POST - TYPE A	FOOT	132	132
72900200	METAL POST - TYPE B	FOOT	26	26
78001100	PAINT PAVEMENT MARKING - LETTERS AND SYMBOLS	SO FT	23	23
78001110	PAINT PAVEMENT MARKING - LINE 4"	FOOT	867	867
78300100	PAVEMENT MARKING REMOVAL	SO FT	10	10
81900200	TRENCH AND BACKFILL FOR ELECTRICAL WORK	FOOT	3	3
84400105	RELOCATE EXISTING LIGHTING UNIT	EACH	2	2
X0325713	GROUND ROD	EACH	2	2
Z0001050	AGGREGATE SUBGRADE 12"	SO YD	1,953	1,953
Z0013798	CONSTRUCTION LAYOUT	L SUM	1	1
Z0048665	RAILROAD PROTECTIVE LIABILITY INSURANCE	L SUM	1	1
X0021880	SHRUB REMOVAL	EACH	2	2
XX002208	6" DIAMETER PIPE BOLLARD, CONCRETE FILLED	EACH	4	4
XX003287	ELECTRIC CABLE IN TRENCH, 1/2 No. 6, 600V, (EPR-Type RHW)	FOOT	18	18

\* SPECIALTY ITEM

**EARTHWORK SCHEDULE**

	REM AND DISP OF UNSUITABLE MATERIAL (CU YD)	EARTH EXCAVATION (CROSS SECTIONS) (CU YD)	STORM SEWER EXCAVATION (CU YD)	SPECIAL WASTE (REUSABLE ON-SITE) (CU YD)	SPECIAL WASTE (NOT REUSABLE ON-SITE) (CU YD)	TOTAL SUITABLE EXCAVATION (CU YD)	EXCAVATION TO BE USED IN EMBANKMENT ADJ FOR 15% SHRINKAGE) (CU YD)	FILL (CROSS SECTIONS) (CU YD)	EARTHWORK BALANCE WASTE (+) OR SHORTAGE (-) (CU YD)	SPECIAL WASTE DISPOSAL (CU YD)
MYRTLE AVE TO EVERGREEN AVE STA. 99+88.65 TO STA. 104+89.10	0	330	50	0	190	190	162	0	162	190
ELM AVE TO MAPLE AVE STA. 107+40.81 TO STA. 110+99.59	5	967	115	0	1,082	0	0	0	0	1,082
MAPLE AVE TO LARCH AVE STA. 112+10.66 TO STA. 115+75.65	0	194	0	194	0	194	165	2	163	192
HAVEN AVE TO CLARA PL STA. 200+47.44 TO STA. 202+33.60	0	299	0	150	0	299	254	0	254	150
<b>TOTAL</b>	<b>5</b>	<b>1,790</b>	<b>165</b>	<b>344</b>	<b>1,272</b>	<b>683</b>	<b>581</b>	<b>2</b>	<b>579</b>	<b>1,614</b>

NOTE: ANY SPECIAL WASTE (REUSABLE ON-SITE) THAT IS NOT REUSED ON-SITE SHALL BE DISPOSED OF AS SPECIAL WASTE.

FILENAME =	USER NAME = ESNeubauer	DESIGNED - ESN	REVISED -
g:\h\10003\roads\sheds\ad off\100-102-GenNotes.dwg	PLOT DATE = 12/8/2009 1:08:26 PM	DRAWN - AJP	REVISED -
		CHECKED - DWB	REVISED -
		DATE - 12-09-09	REVISED -

**STATE OF ILLINOIS  
DEPARTMENT OF TRANSPORTATION**

**FIRST STREET ON-STREET PARKING CONSTRUCTION  
GENERAL NOTES, HIGHWAY STANDARDS,  
AND SUMMARY OF QUANTITIES**

SCALE:	SHEET NO. 1 OF 1 SHEETS	STA. TO STA.	F.A.U RTE.	SECTION	COUNTY	TOTAL SHEETS	SHEET NO.
			1392	09-00172-00-PK	DUPAGE	18	2
			FED. ROAD DIST. NO. ILLINOIS FED. AID PROJECT		CONTRACT NO. 63382		

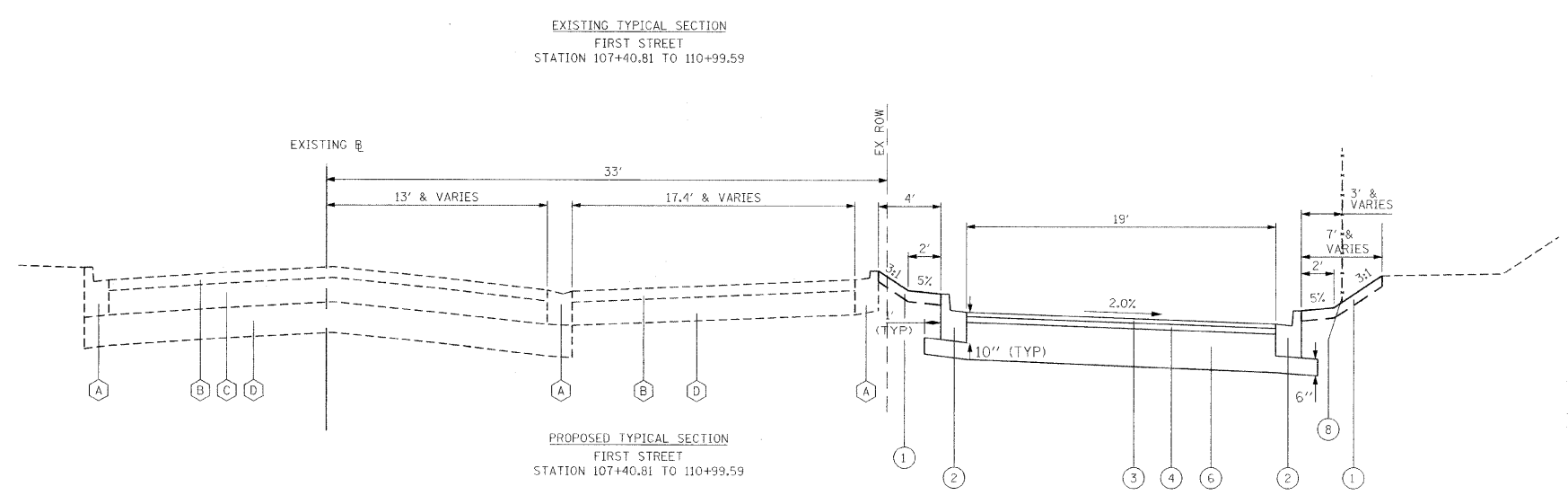
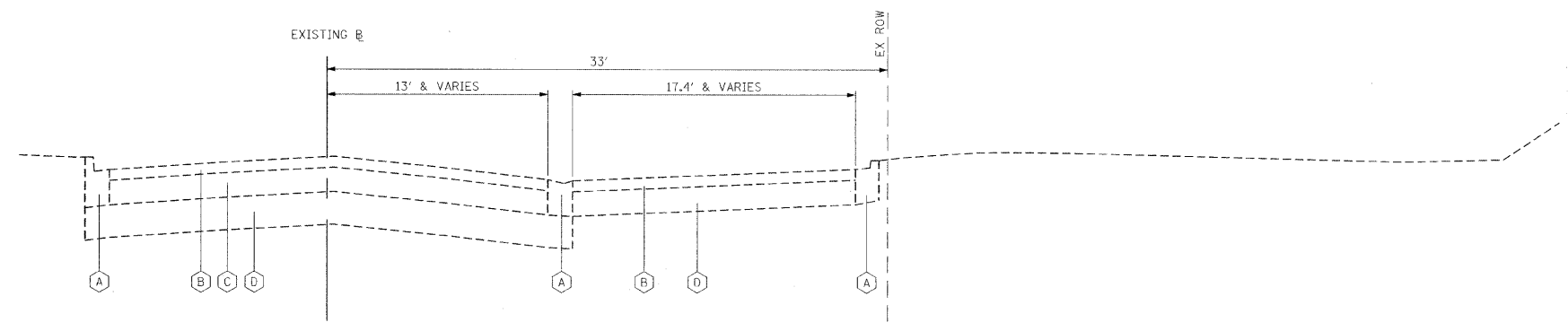
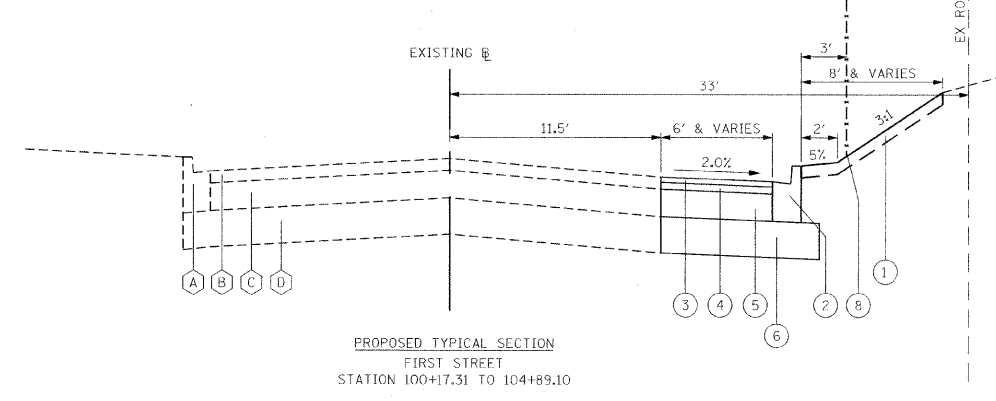
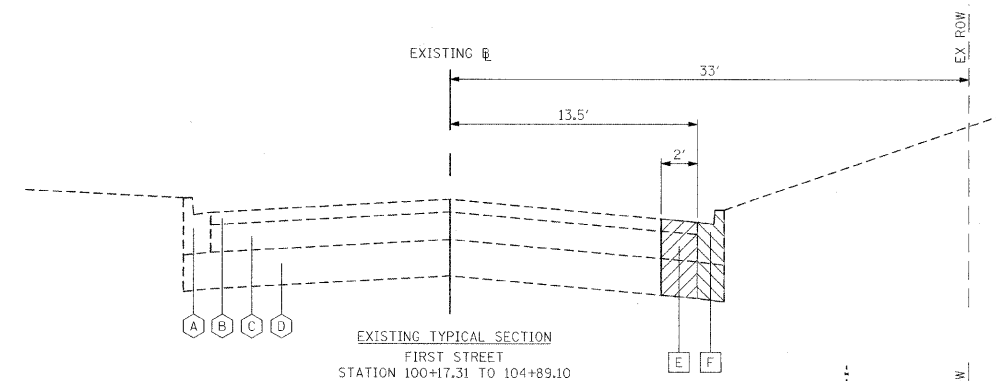

**EXISTING LEGEND**

- (A) CURB AND GUTTER, TYPE B-6.12
- (B) HOT-MIX ASPHALT SURFACE AND BINDER COURSES, DEPTH 4"
- (C) HOT-MIX ASPHALT BASE COURSE, 6"
- (D) AGGREGATE SUBBASE TYPE B, 12"
- (E) PAVEMENT REMOVAL
- (F) COMBINATION CURB AND GUTTER REMOVAL
- (G) GUARDRAIL REMOVAL

**PROPOSED LEGEND**

- (1) TOPSOIL FURNISH AND PLACE, 6" AND SODDING, SALT TOLERANT
- (2) COMBINATION CONCRETE CURB AND GUTTER, TYPE B-6.12
- (3) HOT-MIX ASPHALT SURFACE COURSE, MIX "C", N50, 1 3/4"
- (4) HOT-MIX ASPHALT BINDER COURSE, IL-19.0, N50, 2 1/4"
- (5) HOT-MIX ASPHALT BASE COURSE, 6"
- (6) AGGREGATE SUBGRADE, 12"
- (7) PCC BASE COURSE, 8 1/4"
- (8) CHAIN LINK FENCE, 5'
- (9) NO. 5 X 30" TIE BARS (EPOXY COATED) AT 30" O.C. (INCLUDED IN COST OF COMBINATION CONCRETE CURB AND GUTTER)

**PROJECT BENCHMARKS**

- TBM "C"  
MARK CUT IN NE CORNER OF TRAFFIC SIGNAL CONTROLLER AT THE SW CORNER OF PALMER DRIVE AND SCHILLER STREET  
EL=683.78
- TBM "1"  
BRASS DISK ON BRIDGE HEADWALL AT THE SE CORNER OF PALMER DRIVE AND FIRST STREET  
EL=684.91

**HOT-MIX ASPHALT MIXTURE REQUIREMENTS**

THE FOLLOWING MIXTURE REQUIREMENTS ARE APPLICABLE FOR THIS PROJECT

MIX TYPE	AIR VOIDS
HMA BIND CSE, IL-19.0, N50, 2 1/4"	4% @ 50 GYR
HMA SURFACE, MIX "C", N50 (IL-9.5mm), 1 3/4"	4% @ 50 GYR
HMA BASE CSE, 6" (HMA BINDER, IL-19.0mm, N50)	4% @ 50 GYR

- NOTE:
1. THE UNIT WEIGHT USED TO CALCULATE ALL HOT-MIX ASPHALT SURFACE MIXTURE QUANTITIES IS 112 LBS/SY/IN.
  2. THE "AC TYPE" FOR POLYMERIZED HMA MIXES SHALL BE "SBS/SBR PG70-22" AND FOR NON-POLYMERIZED HMA THE "AC TYPE" SHALL BE "PG64-22" UNLESS MODIFIED BY DISTRICT ONE SPECIAL PROVISIONS.
  3. FOR "PERCENT OF RAP" SEE DISTRICT ONE SPECIAL PROVISIONS.

FILENAME = g:\12\1003\wood\sheet\ad office\10-103-TypSections.dwg	USER NAME = ESNeubauer	DESIGNED - ESN	REVISED -
PLOT DATE = 12/9/2009 2:40:52 PM	DRAWN - AJP	CHECKED - DWB	REVISED -
	DATE - 12-09-09		REVISED -

**STATE OF ILLINOIS  
DEPARTMENT OF TRANSPORTATION**

**FIRST STREET ON-STREET PARKING CONSTRUCTION  
TYPICAL SECTIONS**

SCALE: NONE SHEET NO. 1 OF 2 SHEETS STA. TO STA.

F.A.I. RTE.	SECTION	COUNTY	TOTAL SHEETS	SHEET NO.
1392	09-00172-00-PK	DUPAGE	18	3
CONTRACT NO. 63382				
FED. ROAD DIST. NO. ILLINOIS FED. AID PROJECT				

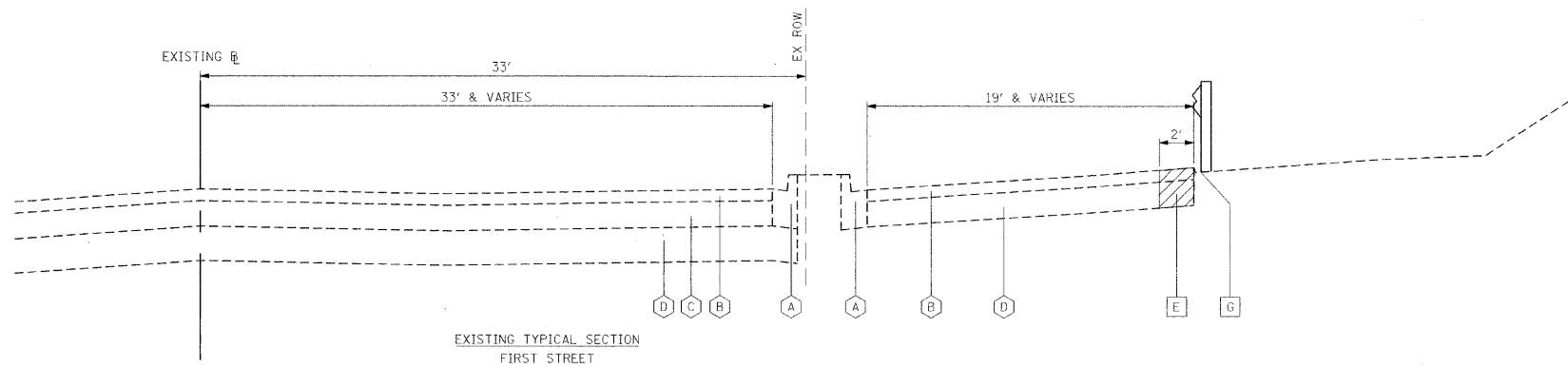

EXISTING TYPICAL SECTION  
FIRST STREET  
STATION 112+10.66 TO 115+75.65

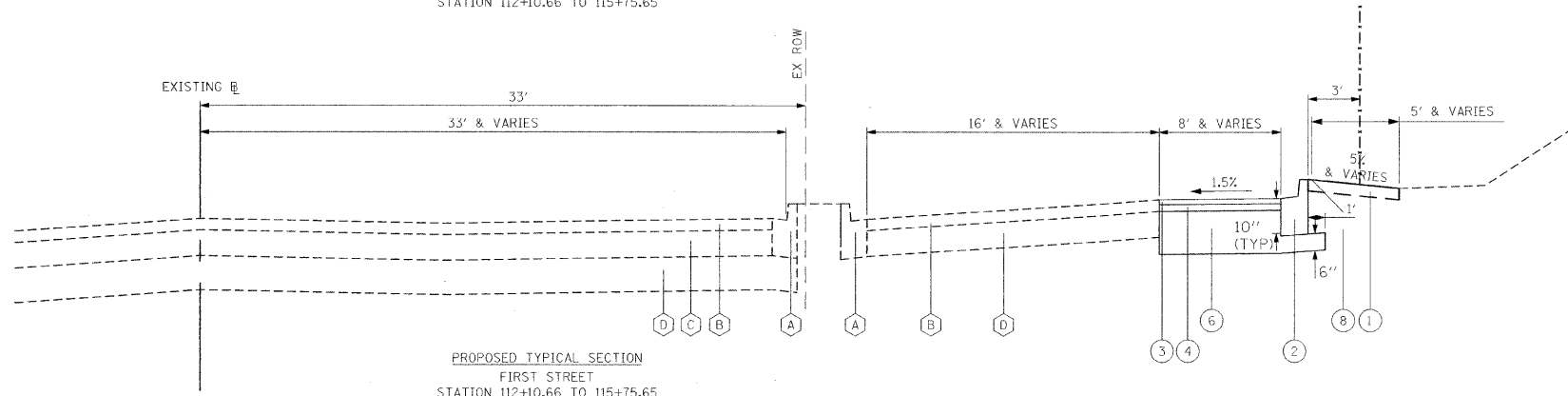

PROPOSED TYPICAL SECTION  
FIRST STREET  
STATION 112+10.66 TO 115+75.65

EXISTING LEGEND

- (A) CURB AND GUTTER, TYPE B-6.12
- (B) HOT-MIX ASPHALT SURFACE AND BINDER COURSES, DEPTH 4"
- (C) HOT-MIX ASPHALT BASE COURSE, 6"
- (D) AGGREGATE SUBBASE TYPE B, 12"
- (E) PAVEMENT REMOVAL
- (F) COMBINATION CURB AND GUTTER REMOVAL
- (G) GUARDRAIL REMOVAL

PROPOSED LEGEND

- (1) TOPSOIL FURNISH AND PLACE, 6" AND SODDING, SALT TOLERANT
- (2) COMBINATION CONCRETE CURB AND GUTTER, TYPE B-6.12
- (3) HOT-MIX ASPHALT SURFACE COURSE, MIX "C", N50, 1 3/4"
- (4) HOT-MIX ASPHALT BINDER COURSE, IL-19.0, N50, 2 1/4"
- (5) HOT-MIX ASPHALT BASE COURSE, 6"
- (6) AGGREGATE SUBGRADE, 12"
- (7) PCC BASE COURSE, 8 1/4"
- (8) CHAIN LINK FENCE, 5'
- (9) NO. 5 X 30" TIE BARS (EPOXY COATED) AT 30" O.C. (INCLUDED IN COST OF COMBINATION CONCRETE CURB AND GUTTER)

SEE SHEET 3 FOR HOT-MIX ASPHALT MIXTURE REQUIREMENTS

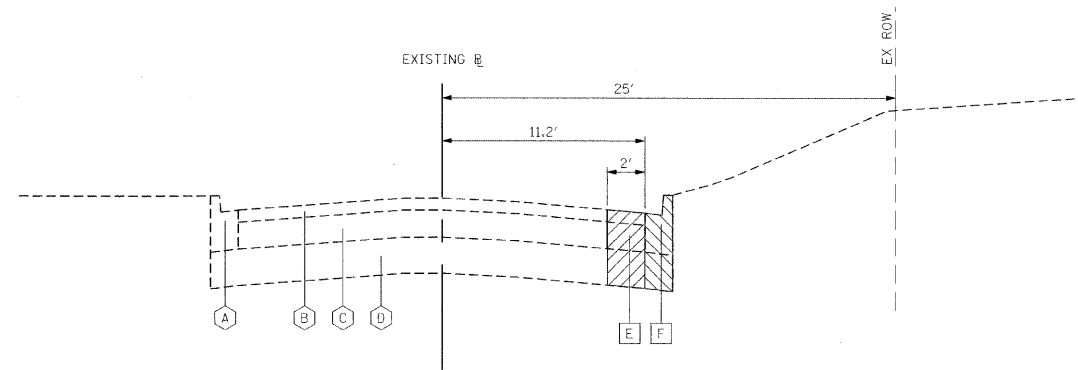

EXISTING TYPICAL SECTION  
FIRST STREET  
STATION 200+47.44 TO 201+25.00  
STATION 201+75.00 TO 202+36.60

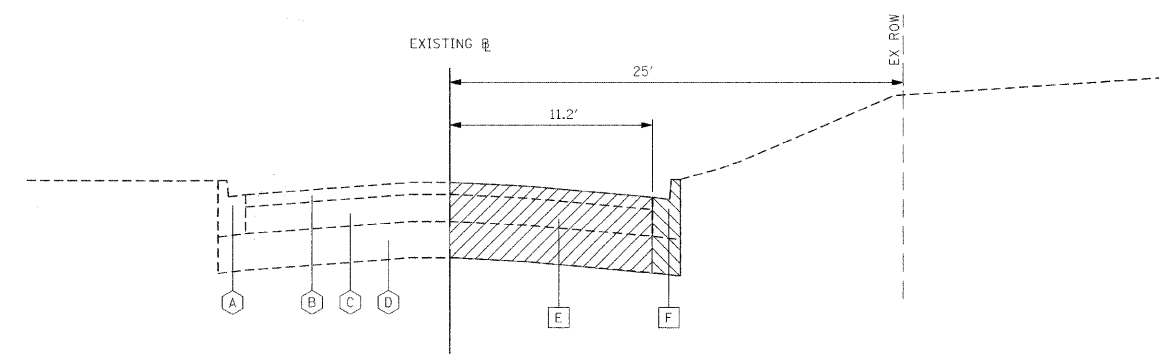

EXISTING TYPICAL SECTION  
FIRST STREET  
STATION 201+25.00 TO 201+75.00

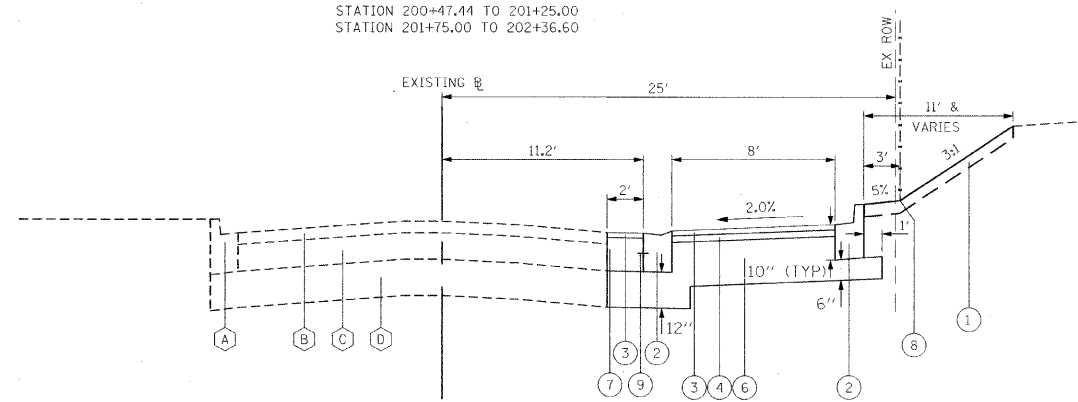

PROPOSED TYPICAL SECTION  
FIRST STREET  
STATION 200+47.44 TO 201+25.00  
STATION 201+75.00 TO 202+36.60

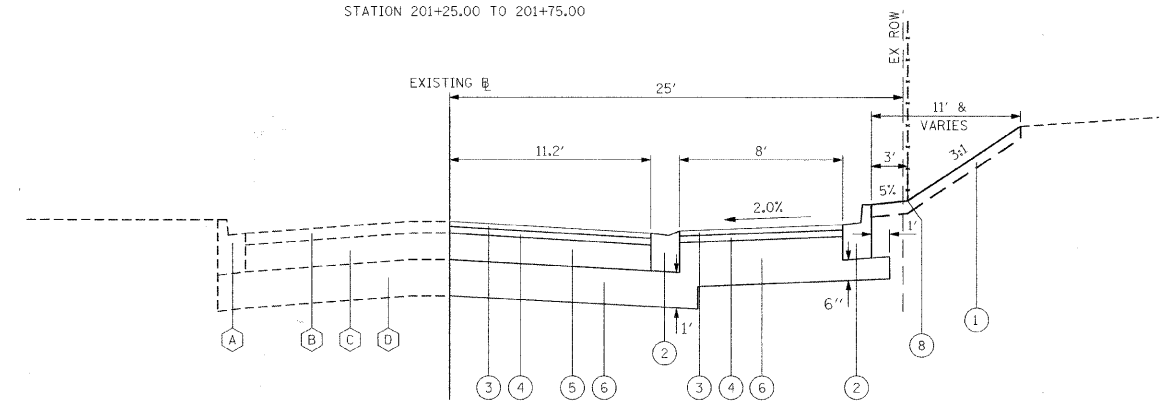

PROPOSED TYPICAL SECTION  
FIRST STREET  
STATION 201+25.00 TO 201+75.00

FILENAME =	USER NAME = ESNeubauer	DESIGNED - ESN	REVISED -
g:\ch\1000\roadsheets\od of 1\16-103\1p\sect\dt	PLOT DATE = 12/8/2009 1:00:29 PM	DRAWN - AJP	REVISED -
		CHECKED - DWB	REVISED -
		DATE - 12-09-09	REVISED -

STATE OF ILLINOIS  
DEPARTMENT OF TRANSPORTATION

FIRST STREET ON-STREET PARKING CONSTRUCTION  
TYPICAL SECTIONS

SCALE: NONE SHEET NO. 2 OF 2 SHEETS STA. TO STA.

F.A.U. RTE.	SECTION	COUNTY	TOTAL SHEETS	SHEET NO.
1392	09-00172-00-PK	DUPAGE	18	4
FED. ROAD DIST. NO. [ILLINOIS] FED. AID PROJECT			CONTRACT NO. 63382	

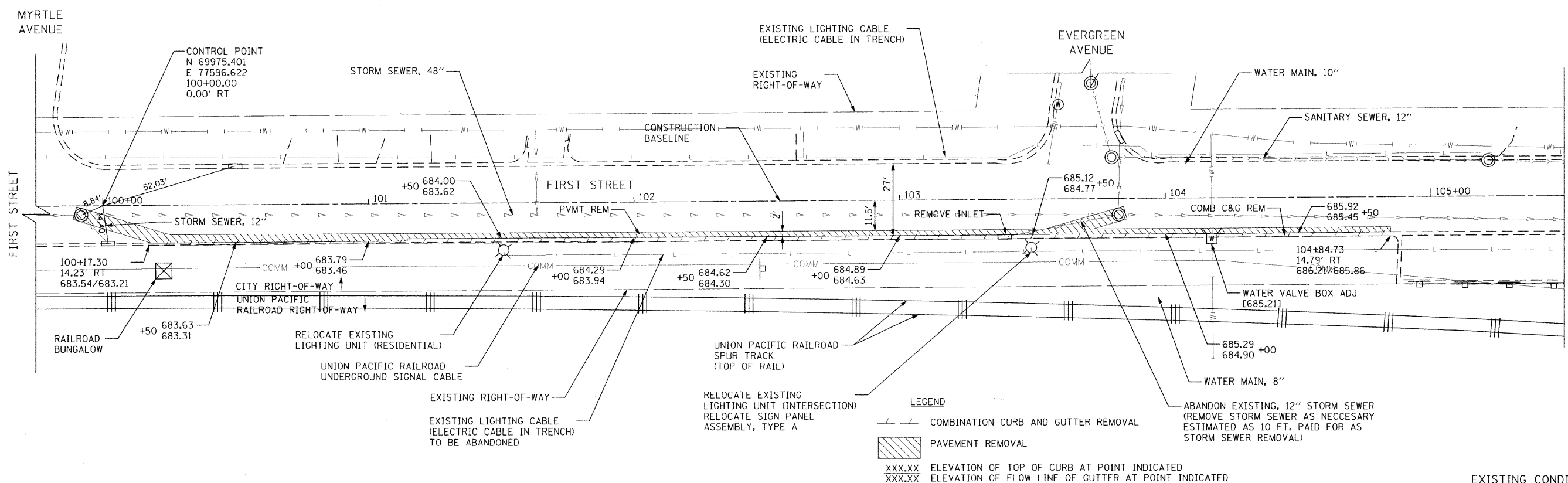

**SIGNING LEGEND**  
 RE = RELOCATE SIGN PANEL ASSEMBLY, TYPE A  
 DG = FURNISH AND INSTALL POLE, DIG METHOD

- NOTES:**
1. THE COST FOR ALL SPLICING SHALL BE INCLUDED IN THE COST OF ELECTRIC CABLE IN TRENCH, 1/C NO. 6 600V (EPR-TYPE RHW) CABLING.
  2. THE CONTRACTOR SHALL VERIFY THE EXISTING LIGHTING CABLE SIZE AND INSULATION TYPE AND ADJUST THE PROPOSED CABLING TO MATCH THE EXISTING CABLE. THE DIFFERENCE IN COST OF THE REVISED CABLE SIZE/INSULATION TYPE WILL BE ADDED OR DEDUCTED FROM THE CONTRACT.

ELECTRIC CABLE IN TRENCH, 2-1/C NO. 6 600V (EPR-TYPE RHW)-4.5' SPLICE TO EXISTING LIGHTING CIRCUIT TRENCH AND BACKFILL FOR ELECTRICAL WORK-1.5' TOPSOIL FURNISH AND PLACE, 6"-0.25 SY SODDING, SALT TOLERANT-0.25 SY

**DRAINAGE STRUCTURES**

STRUCTURE	STATION	OFFSET	RIM	INVERT
1 - EXISTING MH	99+91.86	3.45' RT	684.50	677.21 (SE), 665.51 (E/W)
2 - CB TY A, 4' DIA., TYPE 1 F, OPEN LID	100+37.11	17.40' RT	683.13	677.63 (NW)
3 - CB TY A, 4' DIA., TYPE 11 F&G	103+39.64	17.40' RT	684.64	679.14 (NE)
4 - EXISTING MH	103+82.45	6.11' RT	685.65	678.75 (SW), 665.67 (E/W)

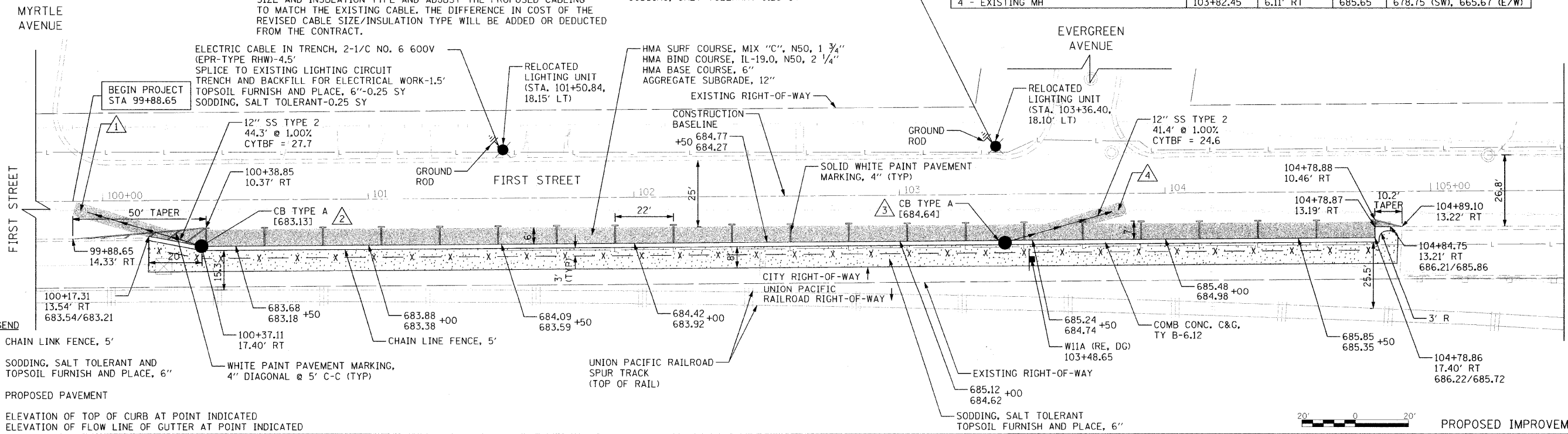

**LEGEND**  
 X - CHAIN LINK FENCE, 5'  
 SODDING, SALT TOLERANT AND TOPSOIL FURNISH AND PLACE, 6"  
 PROPOSED PAVEMENT  
 ELEVATION OF TOP OF CURB AT POINT INDICATED  
 ELEVATION OF FLOW LINE OF GUTTER AT POINT INDICATED

FILENAME = g:\d\19883\roadsheets\od of fce\19-28\First\arill.dwg	USER NAME = ESNeubauer	DESIGNED - ESN	REVISED -
PLOT DATE = 12/8/2009 1:00:31 PM	DRAWN - AJP	CHECKED - DWB	REVISED -
	DATE - 12-09-09		REVISED -

**STATE OF ILLINOIS  
 DEPARTMENT OF TRANSPORTATION**

**FIRST STREET ON-STREET PARKING CONSTRUCTION  
 IMPROVEMENT PLAN  
 MYRTLE AVE TO EVERGREEN AVE**  
 SCALE: 1"=20' SHEET NO. 1 OF 4 SHEETS STA. 99+88.65 TO STA. 104+89.10

F.A.U. R.T.E. 1392	SECTION 09-00172-00-PK	COUNTY DUPAGE	TOTAL SHEETS 18	SHEET NO. 5
CONTRACT NO. 63382				
FED. ROAD DIST. NO. [ILLINOIS] FED. AID PROJECT				

**NOTE:**

- ALL OVERHEAD SIGN POLES TO BE REMOVED AND SALVAGED SHALL BE DELIVERED TO THE CITY GARAGE LOCATED AT 985 SOUTH RIVERSIDE DRIVE, ELMHURST, IL. THE COST FOR THIS WORK WILL BE INCLUDED IN THE COST OF THE CONTRACT.
- REMOVE AND SALVAGE SIGN PANEL ASSEMBLY WILL BE PAID FOR AS RELOCATE SIGN PANEL ASSEMBLY, TYPE A. SALVAGED SIGN PANELS SHALL BE DELIVERED TO THE CITY GARAGE LOCATED AT 985 SOUTH RIVERSIDE DRIVE, ELMHURST, IL. THE COST FOR THIS WORK WILL BE INCLUDED IN THE COST OF THE ITEM.

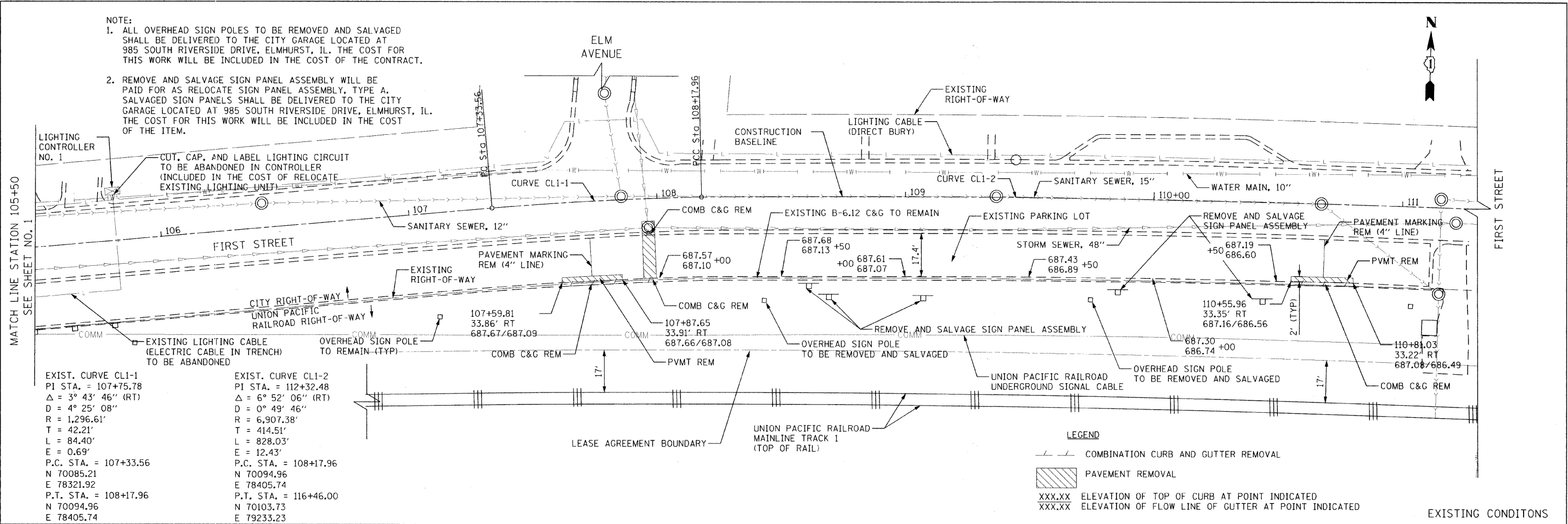

EXIST. CURVE CL1-1	EXIST. CURVE CL1-2
PI STA. = 107+75.78	PI STA. = 112+32.48
Δ = 3° 43' 46" (RT)	Δ = 6° 52' 06" (RT)
D = 4° 25' 08"	D = 0° 49' 46"
R = 1,296.61'	R = 6,907.38'
T = 42.21'	T = 414.51'
L = 84.40'	L = 828.03'
E = 0.69'	E = 12.43'
P.C. STA. = 107+33.56	P.C. STA. = 108+17.96
N 70085.21	N 70094.96
E 78321.92	E 78405.74
P.T. STA. = 108+17.96	P.T. STA. = 116+46.00
N 70094.96	N 70103.73
E 78405.74	E 79233.23

**LEGEND**

- COMBINATION CURB AND GUTTER REMOVAL
- ▨ PAVEMENT REMOVAL
- XXX.XX ELEVATION OF TOP OF CURB AT POINT INDICATED
- XXX.XX ELEVATION OF FLOW LINE OF GUTTER AT POINT INDICATED

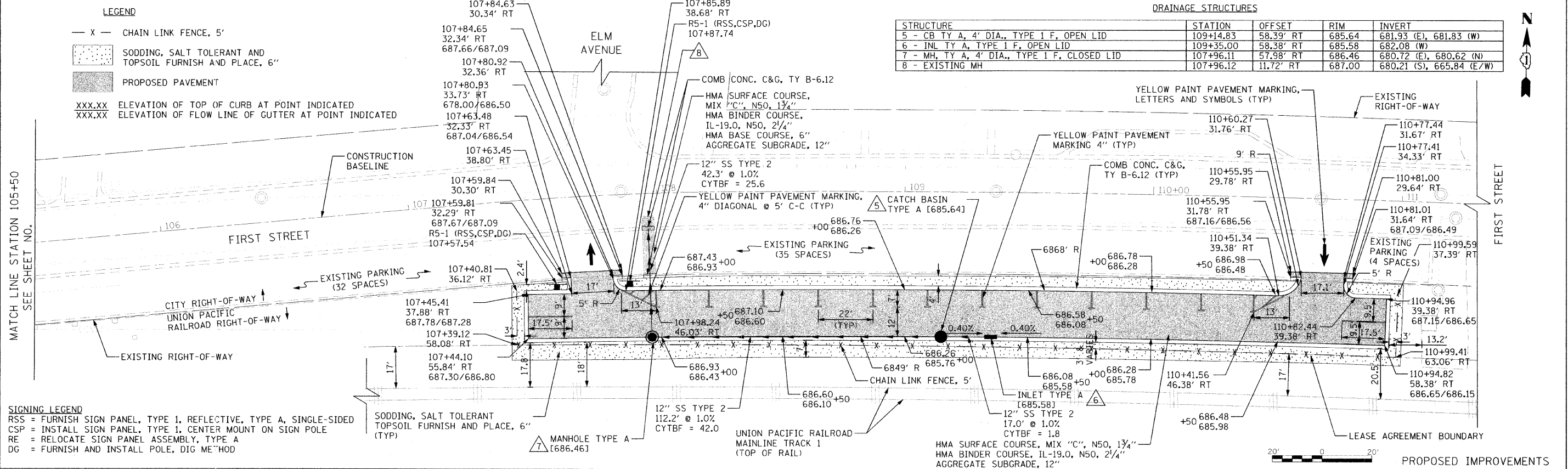

**LEGEND**

- X CHAIN LINK FENCE, 5'
- ▨ SODDING, SALT TOLERANT AND TOPSOIL FURNISH AND PLACE, 6"
- ▨ PROPOSED PAVEMENT
- XXX.XX ELEVATION OF TOP OF CURB AT POINT INDICATED
- XXX.XX ELEVATION OF FLOW LINE OF GUTTER AT POINT INDICATED

**DRAINAGE STRUCTURES**

STRUCTURE	STATION	OFFSET	RIM	INVERT
5 - CB TY A, 4' DIA., TYPE 1 F, OPEN LID	109+14.83	58.39' RT	685.64	681.93 (E), 681.83 (W)
6 - INL TY A, TYPE 1 F, OPEN LID	109+35.00	58.38' RT	685.58	682.08 (W)
7 - MH, TY A, 4' DIA., TYPE 1 F, CLOSED LID	107+96.11	57.98' RT	686.46	680.72 (E), 680.62 (N)
8 - EXISTING MH	107+96.12	11.72' RT	687.00	680.21 (S), 665.84 (E/W)

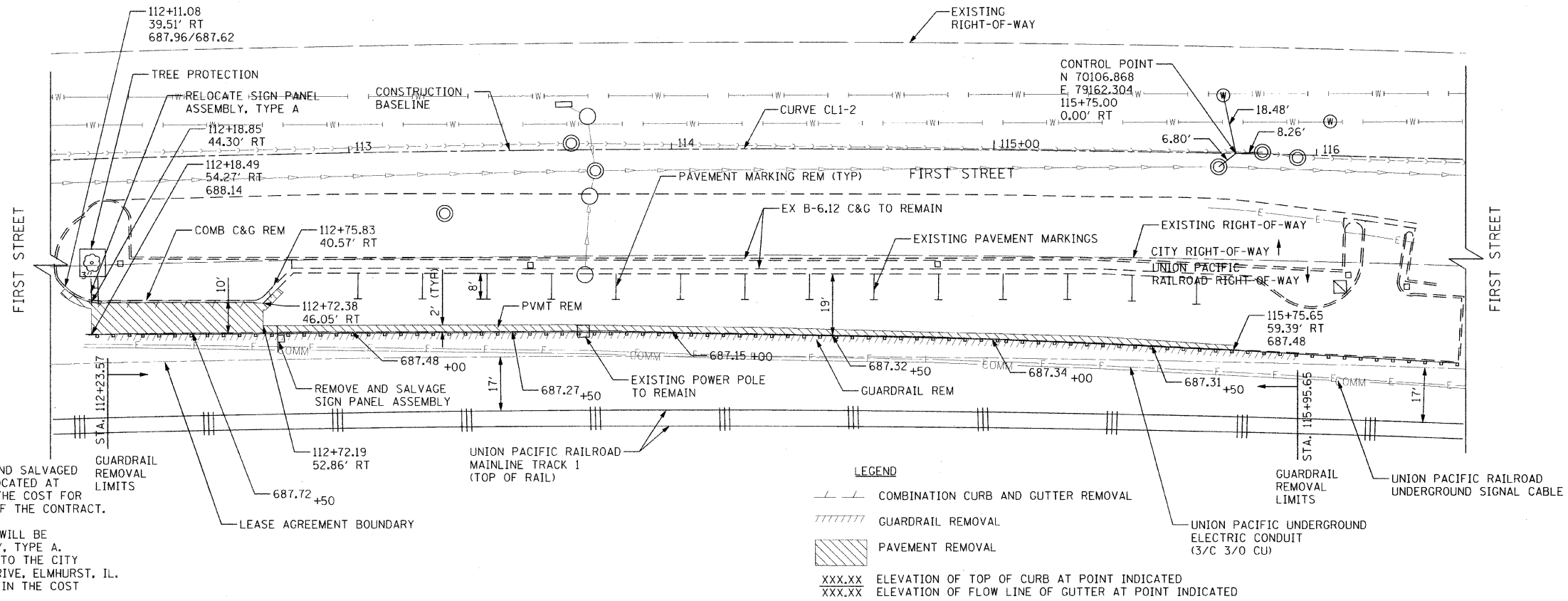

- NOTE:
1. ALL OVERHEAD SIGN POLES TO BE REMOVED AND SALVAGED SHALL BE DELIVERED TO THE CITY GARAGE LOCATED AT 985 SOUTH RIVERSIDE DRIVE, ELMHURST, IL. THE COST FOR THIS WORK WILL BE INCLUDED IN THE COST OF THE CONTRACT.
  2. REMOVE AND SALVAGE SIGN PANEL ASSEMBLY WILL BE PAID FOR AS RELOCATE SIGN PANEL ASSEMBLY, TYPE A. SALVAGED SIGN PANELS SHALL BE DELIVERED TO THE CITY GARAGE LOCATED AT 985 SOUTH RIVERSIDE DRIVE, ELMHURST, IL. THE COST FOR THIS WORK WILL BE INCLUDED IN THE COST OF THE ITEM.
  3. SEE SHEET 6 FOR CURVE CL1-2 DATA.

**LEGEND**

- COMBINATION CURB AND GUTTER REMOVAL
- GUARDRAIL REMOVAL
- PAVEMENT REMOVAL
- XXX.XX ELEVATION OF TOP OF CURB AT POINT INDICATED
- XXX.XX ELEVATION OF FLOW LINE OF GUTTER AT POINT INDICATED

EXISTING CONDITIONS

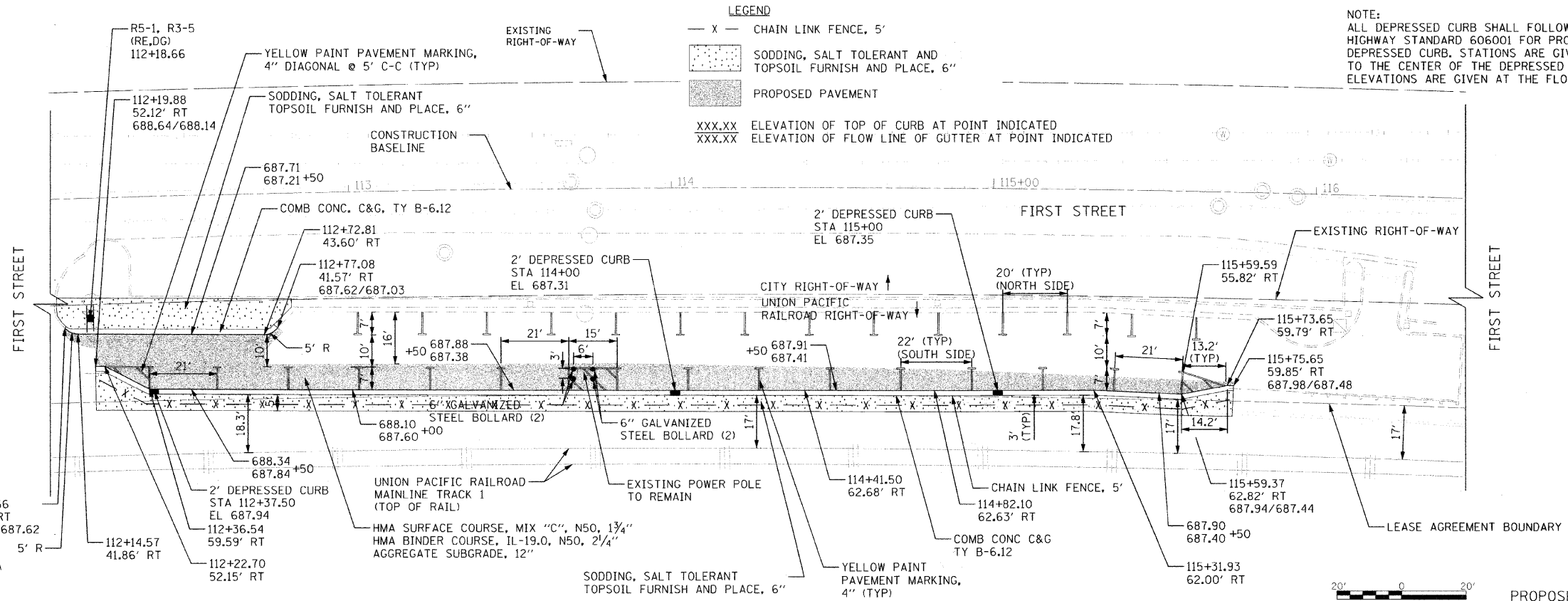

**LEGEND**

- CHAIN LINK FENCE, 5'
- SODDING, SALT TOLERANT AND TOPSOIL FURNISH AND PLACE, 6"
- PROPOSED PAVEMENT
- XXX.XX ELEVATION OF TOP OF CURB AT POINT INDICATED
- XXX.XX ELEVATION OF FLOW LINE OF GUTTER AT POINT INDICATED

- NOTE:
- ALL DEPRESSED CURB SHALL FOLLOW HIGHWAY STANDARD 606001 FOR PROPOSED DEPRESSED CURB. STATIONS ARE GIVEN TO THE CENTER OF THE DEPRESSED CURB. ELEVATIONS ARE GIVEN AT THE FLOWLINE.

**SIGNING LEGEND**  
 RE = RELOCATE SIGN PANEL ASSEMBLY, TYPE A  
 DG = FURNISH AND INSTALL POLE, DIG METHOD

PROPOSED IMPROVEMENTS

FILENAME =	USER NAME = ESNreubauer	DESIGNED - ESN	REVISED -	<b>STATE OF ILLINOIS DEPARTMENT OF TRANSPORTATION</b>	<b>FIRST STREET ON-STREET PARKING CONSTRUCTION IMPROVEMENT PLAN MAPLE AVE TO LARCH AVE</b>	F.A.U. RTE.	SECTION	COUNTY	TOTAL SHEETS	SHEET NO.	
g:\d\1003\roads\stds\of\ice\pp\203\first\plan\3.sht	PLOT DATE = 12/8/2009 1:09:38 PM	DRAWN - AJP	REVISED -			1392	09-00172-00-PK	DUPAGE	18	7	
		CHECKED - DWB	REVISED -			CONTRACT NO. 63382					
		DATE - 12-09-09	REVISED -			FED. ROAD DIST. NO. [ILLINOIS] FED. AID PROJECT					

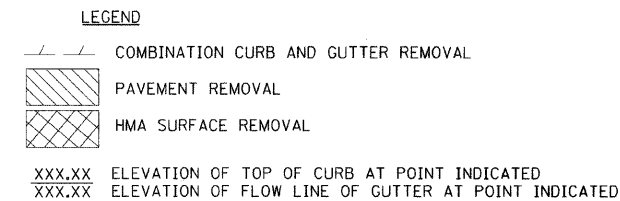
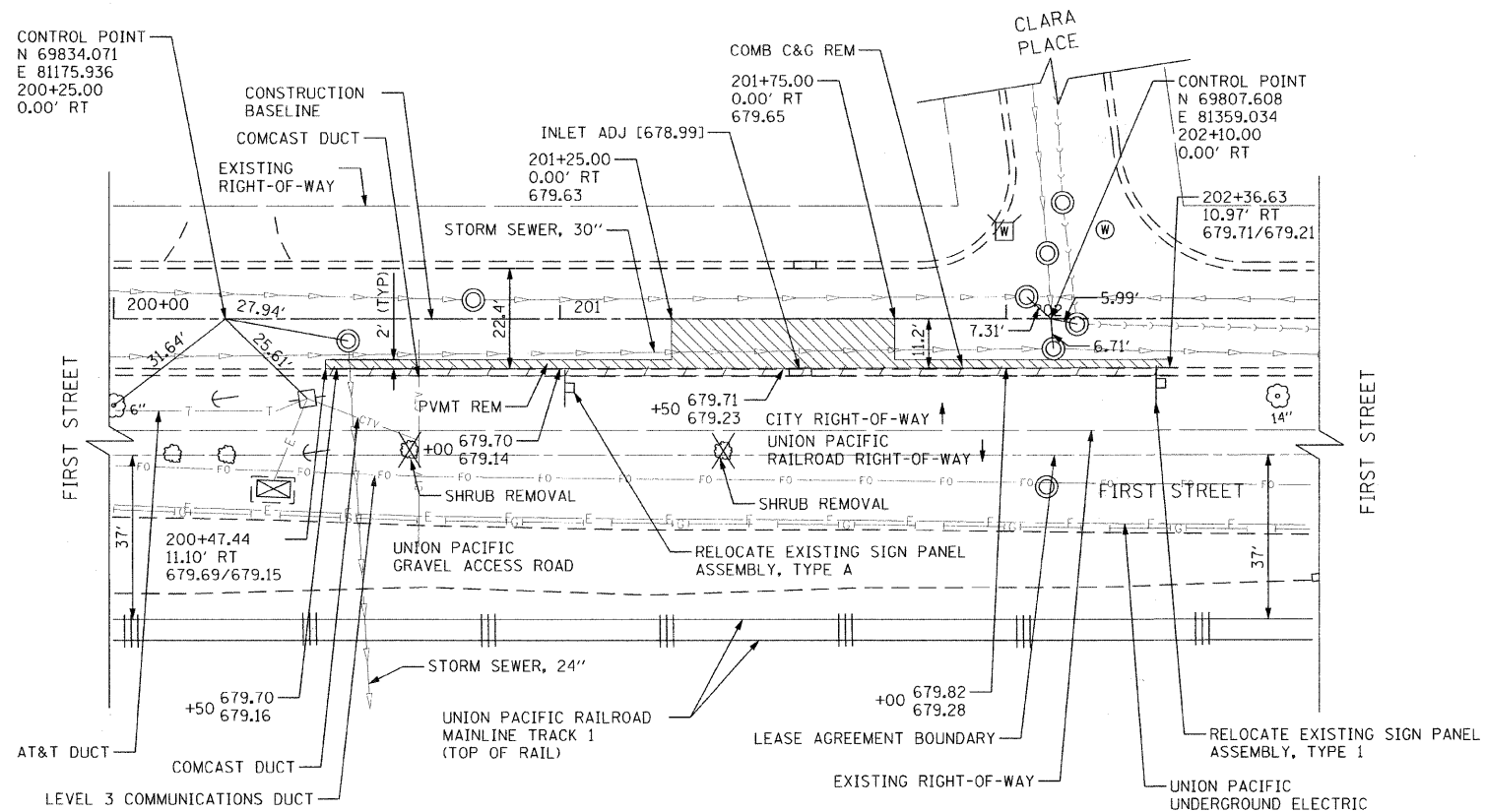

EXISTING CONDITIONS

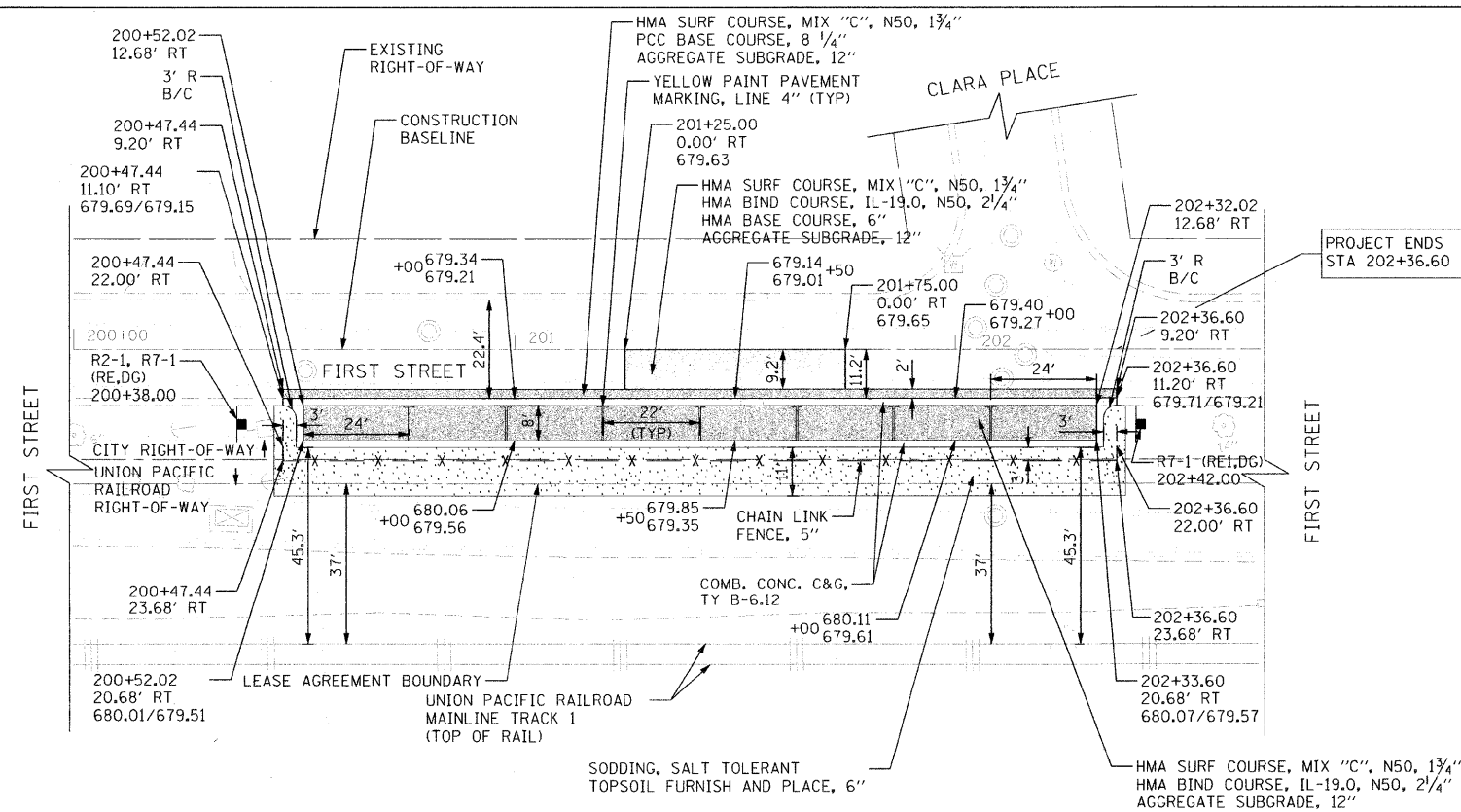
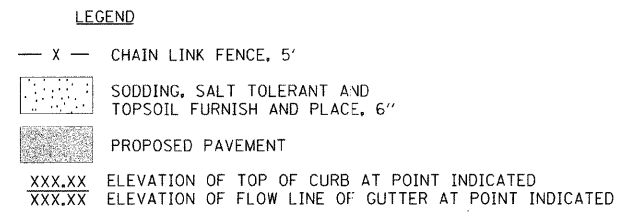

**SIGNING LEGEND**  
 RE = RELOCATE SIGN PANEL ASSEMBLY, TYPE A  
 RE1 = RELOCATE SIGN PANEL, TYPE 1  
 DG = FURNISH AND INSTALL POLE, DIG METHOD

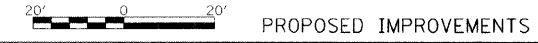

FILENAME = ghd\p\0803\roadsheets\cd of\sta\VP-281\firstplan1.dwg	USER NAME = ESNeubauer	DESIGNED - ESN	REVISED -	<b>STATE OF ILLINOIS DEPARTMENT OF TRANSPORTATION</b>	<b>FIRST STREET ON-STREET PARKING CONSTRUCTION IMPROVEMENT PLAN HAVEN AVE TO CLARA PL</b>	F.A.U. RTE. 1392	SECTION 09-00172-00-PK	COUNTY DUPAGE	TOTAL SHEETS 18	SHEET NO. 8		
	PLOT DATE = 12/8/2009 1:08:41 PM	DRAWN - AJP	REVISED -			SCALE: 1"=20'	SHEET NO. 4 OF 4 SHEETS	STA. 200+47.44 TO STA. 202+33.60	CONTRACT NO. 63382			
		CHECKED - DWB	REVISED -			FED. ROAD DIST. NO. [ILLINOIS] FED. AID PROJECT						
		DATE - 12-09-09	REVISED -									



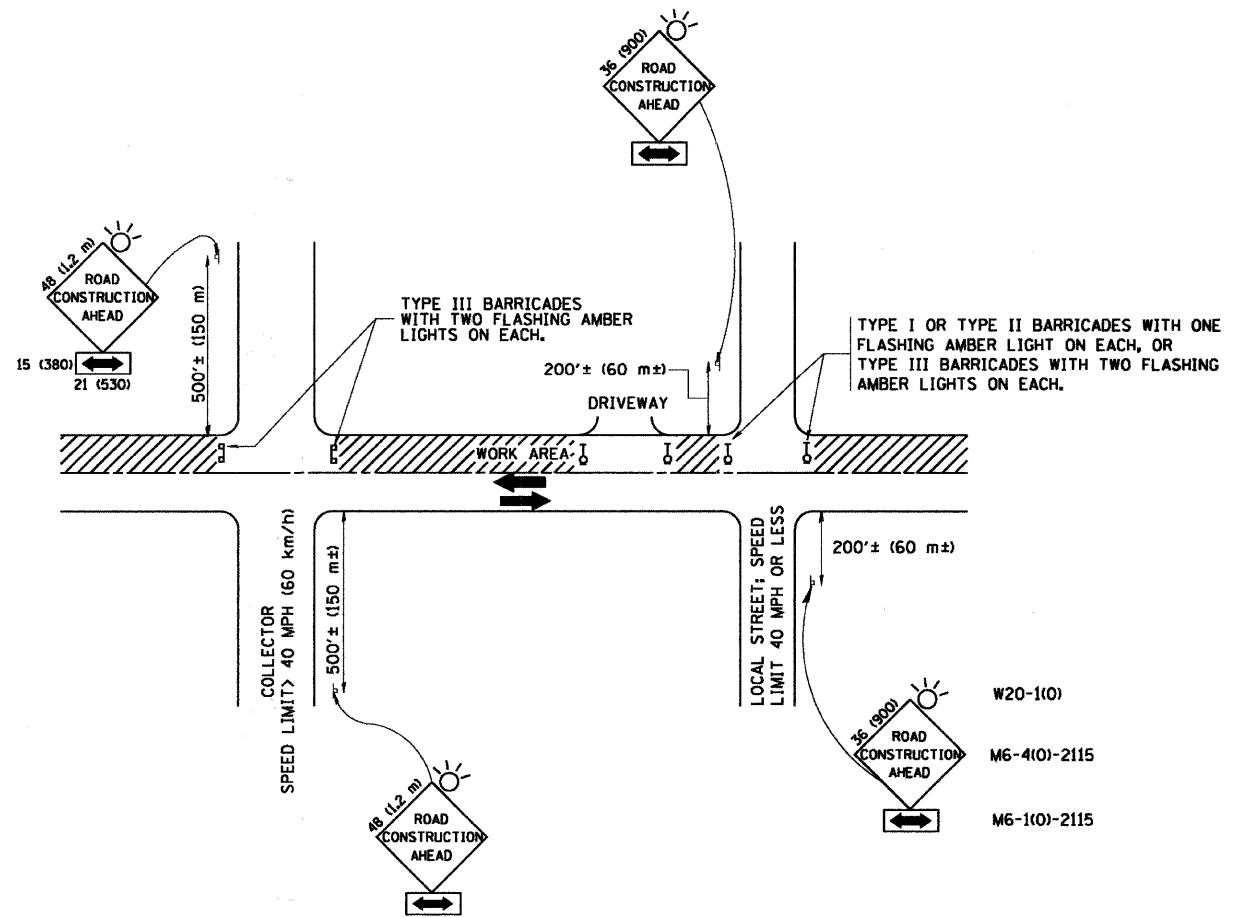

TRAFFIC CONTROL AND PROTECTION FOR SIDE ROADS, INTERSECTIONS, AND DRIVEWAYS

NOTES:

A. FOR NO LANE RESTRICTION ON THE SIDE ROAD OR DRIVEWAYS

1. SIDE ROAD WITH A SPEED LIMIT OF 40 MPH (60 km/h) OR LESS AS SHOWN ON THE DRAWING AND AS DIRECTED BY THE ENGINEER:
  - a) ONE ROAD CONSTRUCTION AHEAD SIGN 36 x 36 (900x900) WITH A FLASHER AND FLAG MOUNTED ON IT APPROXIMATELY 200' (60 m) IN ADVANCE OF THE MAIN ROUTE.
  - b) THE CLOSED PORTION OF THE MAIN ROUTE SHALL BE PROTECTED BY BLOCKING WITH TYPE I, TYPE II OR TYPE III BARRICADES, 1/3 OF THE CROSS SECTION OF THE CLOSED PORTION.
2. SIDE ROAD WITH A SPEED LIMIT GREATER THAN 40 MPH (60 km/h) AS SHOWN ON THE DRAWING AND AS DIRECTED BY THE ENGINEER:
  - a) ONE ROAD CONSTRUCTION AHEAD SIGN 48 x 48 (1.2 m x 1.2 m) WITH A FLASHER MOUNTED ON IT APPROXIMATELY 500' (150 m) IN ADVANCE OF THE MAIN ROUTE.
  - b) THE CLOSED PORTION OF THE MAIN ROUTE SHALL BE PROTECTED BY BLOCKING WITH TYPE III BARRICADES, 1/2 OF THE CROSS SECTION OF THE CLOSED PORTION.
3. WHEN THE SIDE ROAD LIES BETWEEN THE BEGINNING OF THE MAINLINE SIGNING AND THE WORK ZONE, A SINGLE HEADED ARROW (M6-1) SHALL BE USED IN LIEU OF THE DOUBLE HEADED ARROW (M6-4).

B. FOR A LANE CLOSURE ON A SIDE ROAD OR DRIVEWAY:

USE APPLICABLE PORTIONS OF THE TYPICAL APPLICATION OF TRAFFIC CONTROL DEVICES (STD. 70150L, STD. 701606 OR THE APPROPRIATE STANDARD). THE SPACING OF SIGNS AND BARRICADES SHALL BE ADJUSTED FOR FIELD CONDITIONS AS DIRECTED BY THE ENGINEER. THE DIRECTIONAL ARROW SHALL BE COVERED OR REMOVED WHEN NO LONGER CONSISTENT WITH THE SIDE ROAD LANE CLOSURE.

C. ADVANCE WARNING SIGNS ARE TO BE OMITTED ON DRIVEWAY UNLESS OTHERWISE NOTED.

D. THE TRAFFIC CONTROL AND PROTECTION FOR SIDE ROADS, INTERSECTIONS, AND DRIVEWAYS SHALL BE INCIDENTAL TO THE COST OF SPECIFIED TRAFFIC CONTROL STANDARDS OR ITEMS.

All dimensions are in millimeters (inches) unless otherwise shown.

FILE NAME = W:\d1stetd\22x34\to18.dgn	USER NAME = gegl1anobt	DESIGNED - LHA	REVISED - J. OBERLE 10-18-95
		DRAWN -	REVISED - A. HOUSEH 03-06-96
	PLOT SCALE = 50.000' / 1".	CHECKED -	REVISED - A. HOUSEH 10-15-96
	PLOT DATE = 1/4/2008	DATE - 06-89	REVISED - T. RAMMACHER 01-06-00

STATE OF ILLINOIS  
DEPARTMENT OF TRANSPORTATION

TRAFFIC CONTROL AND PROTECTION FOR  
SIDE ROADS, INTERSECTIONS, AND DRIVEWAYS

SCALE: NONE SHEET NO. 1 OF 1 SHEETS STA. TO STA.

F.A. RTE.	SECTION	COUNTY	TOTAL SHEETS	SHEET NO.
1392	09-00172-00-PK	DUPAGE	18	9
TC-10			CONTRACT NO. 63382	
FED. ROAD DIST. NO. 1 ILLINOIS FED. AID PROJECT				

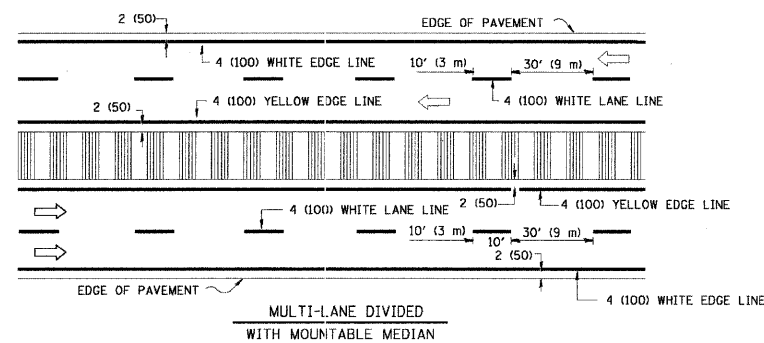
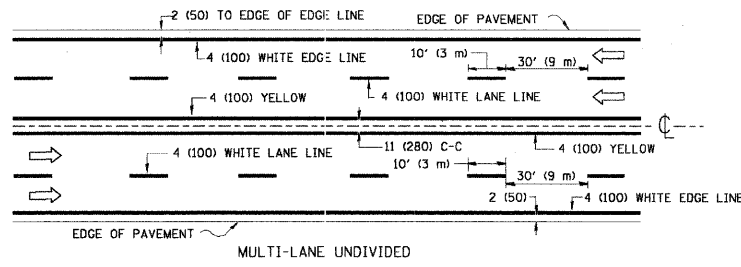
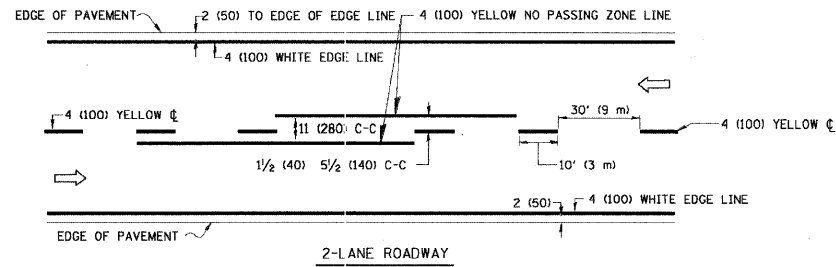

NOTE: MEDIANS WITH BARRIER CURB DO NOT REQUIRE AN EDGE LINE

TYPICAL LANE AND EDGE LINE MARKING

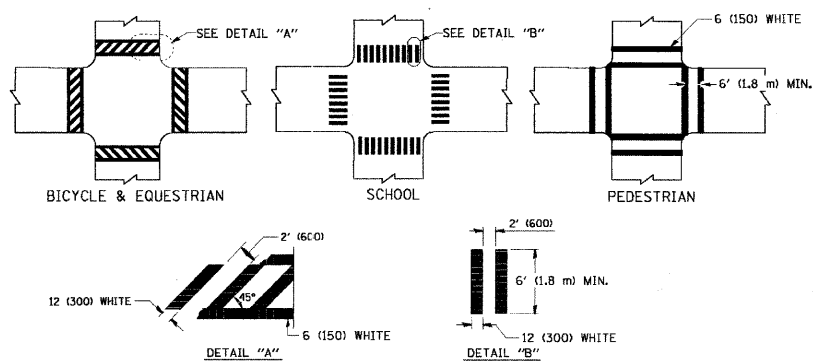

TYPICAL CROSSWALK MARKING

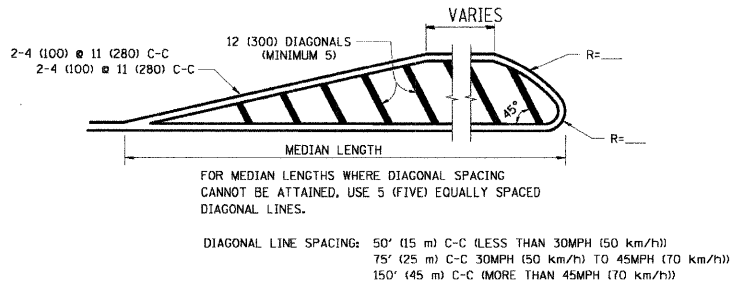
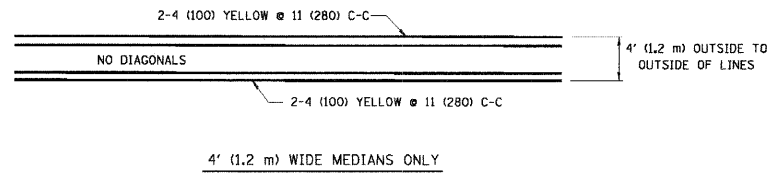

MEDIANS OVER 4' (1.2 m) WIDE

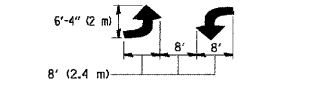
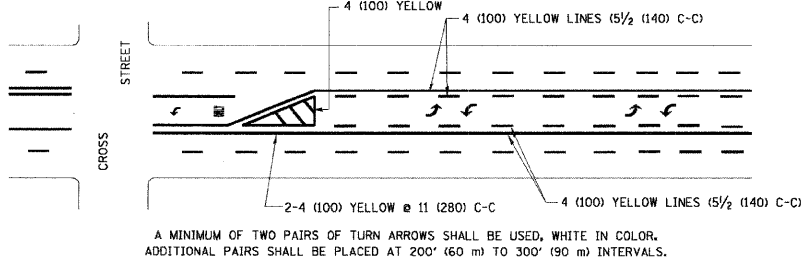

TYPICAL PAINTED MEDIAN MARKING

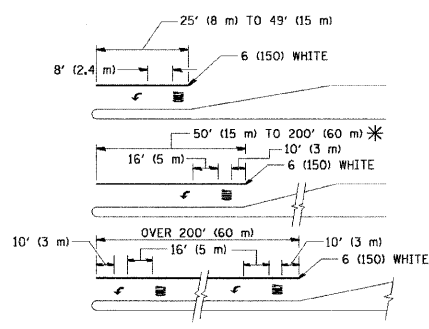

FULL SIZE LETTERS 8' (2.4 m) AND ARROWS SHALL BE USED.  
\* AREA = 15.6 SQ. FT. (1.5 m<sup>2</sup>) ONLY AREA = 20.8 SQ. FT. (1.9 m<sup>2</sup>)

\* TURN LANES IN EXCESS OF 400' (120 m) IN LENGTH MAY HAVE AN ADDITIONAL SET OF ARROW - "ONLY" INSTALLED MIDWAY BETWEEN THE OTHER TWO SETS OF ARROW - "ONLY".

TYPICAL LEFT (OR RIGHT) TURN LANE

TYPICAL TURN LANE MARKING

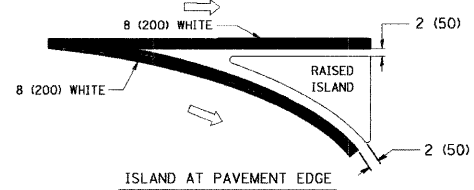
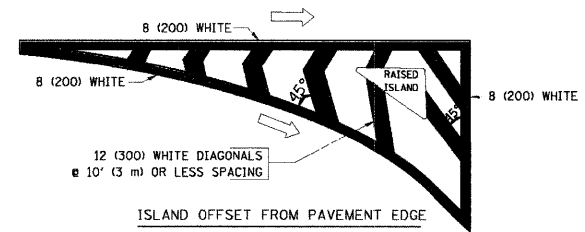

TYPICAL ISLAND MARKING

TYPE OF MARKING	WIDTH OF LINE	PATTERN	COLOR	SPACING / REMARKS
CENTERLINE ON 2 LANE PAVEMENT	4 (100)	SKIP-DASH	YELLOW	10' (3 m) LINE WITH 30' (9 m) SPACE
CENTERLINE ON MULTI-LANE UNDIVIDED PAVEMENT	2 @ 4 (100)	SOLID	YELLOW	11 (280) C-C
NO PASSING ZONE LINES: FOR ONE DIRECTION FOR BOTH DIRECTIONS	4 (100) 2 @ 4 (100)	SOLID SOLID	YELLOW YELLOW	5/2 (140) C-C FROM SKIP-DASH CENTERLINE 11 (280) C-C OMIT SKIP-DASH CENTERLINE BETWEEN
LANE LINES	4 (100) 5 (125) ON FREEWAYS	SKIP-DASH SKIP-DASH	WHITE WHITE	10' (3 m) LINE WITH 30' (9 m) SPACE
DOTTED LINES (EXTENSIONS OF CENTER, LANE OR TURN LANE MARKINGS)	SAME AS LINE BEING EXTENDED	SKIP-DASH	SAME AS LINE BEING EXTENDED	2' (600) LINE WITH 6' (1.8 m) SPACE
EDGE LINES	4 (100)	SOLID	YELLOW-LEFT WHITE-RIGHT	OUTLINE MOUNTABLE MEDIANS IN YELLOW; EDGE LINES ARE NOT USED NEXT TO BARRIER CURB
TURN LANE MARKINGS	6 (150) LINE; FULL SIZE LETTERS & SYMBOLS (8' (2.4m))	SOLID	WHITE	SEE TYPICAL TURN LANE MARKING DETAIL
TWO WAY LEFT TURN MARKING	2 @ 4 (100) EACH DIRECTION 8' (2.4m) LEFT ARROW	SKIP-DASH AND SOLID IN PAIRS	YELLOW WHITE	10' (3 m) LINE WITH 30' (9 m) SPACE FOR SKIP-DASH; 5/2 (140) C-C BETWEEN SOLID LINE AND SKIP-DASH LINE SEE TYPICAL TWO-WAY LEFT TURN MARKING DETAIL
CROSSWALK LINES (PEDESTRIAN) A. DIAGONALS (BIKE & EQUESTRIAN) B. LONGITUDINAL BARS (SCHOOL)	2 @ 6 (150) 12 (300) @ 45° 12 (300) @ 90°	SOLID SOLID SOLID	WHITE WHITE WHITE	NOT LESS THAN 6' (1.8 m) APART 2' (600) APART 2' (600) APART SEE TYPICAL CROSSWALK MARKING DETAILS.
STOP LINES	24 (600)	SOLID	WHITE	PLACE 4' (1.2 m) IN ADVANCE OF AND PARALLEL TO CROSSWALK, IF PRESENT. OTHERWISE, PLACE AT DESIRED STOPPING POINT, PARALLEL TO CROSSROAD CENTERLINE, WHERE POSSIBLE
PAINTED MEDIANS	2 @ 4 (100) WITH 12 (300) DIAGONALS @ 45° NO DIAGONALS USED FOR 4' (1.2 m) WIDE MEDIANS	SOLID	YELLOW; TWO WAY TRAFFIC WHITE; ONE WAY TRAFFIC	11 (280) C-C FOR THE DOUBLE LINE SEE TYPICAL PAINTED MEDIAN MARKING.
GORE MARKING AND CHANNELIZING LINES	8 (200) WITH 12 (300) DIAGONALS @ 45°	SOLID	WHITE	DIAGONALS: 15' (4.5 m) C-C (LESS THAN 30MPH (50 km/h)) 20' (6 m) C-C (30MPH (50 km/h) TO 45MPH (70 km/h)) 30' (9 m) C-C (OVER 45MPH (70 km/h))
RAILROAD CROSSING	24 (600) TRANSVERSE LINES; "RR" IS 6' (1.8 m) LETTERS; 16 (400) LINE FOR "X"	SOLID	WHITE	SEE STATE STANDARD 780001 AREA OF: "RR"=3.6 SQ. FT. (0.33 m <sup>2</sup> ) EACH "X"=54.0 SQ. FT. (5.0 m <sup>2</sup> )
SHOULDER DIAGONALS	12 (300) @ 45°	SOLID	WHITE - RIGHT YELLOW - LEFT	50' (15 m) C-C (LESS THAN 30MPH (50 km/h)) 75' (25 m) C-C (30 MPH (50 km/h) TO 45MPH (70 km/h)) 150' (45 m) C-C (OVER 45MPH (70 km/h))

FOR FURTHER DETAILS ON PAVEMENT MARKING REFER TO STANDARD SPECIFICATIONS FOR ROAD AND BRIDGE CONSTRUCTION AND STATE STANDARD 780001.

All dimensions are in inches (millimeters) unless otherwise shown.

FILE NAME =	USER NAME = drvakosgn	DESIGNED - EVERS	REVISED -T, RAMMACHER 10-27-94
as:\pwork\p\dot\drvakosgn\d0188315\ts3.dgn		DRAWN -	REVISED -C, JUICIUS 09-09-09
	PLOT SCALE = 50,000' / IN.	CHECKED -	REVISED -
	PLOT DATE = 9/9/2009	DATE - 03-19-90	REVISED -

STATE OF ILLINOIS  
DEPARTMENT OF TRANSPORTATION

DISTRICT ONE			
TYPICAL PAVEMENT MARKINGS			
SCALE: NONE	SHEET NO. 1 OF 1 SHEETS	STA. TO STA.	

F.A. RTE.	SECTION	COUNTY	TOTAL SHEETS	SHEET NO.
1392	09-00172-00-PK	DUPAGE	18	10
TC-13			CONTRACT NO. 63382	
FED. ROAD DIST. NO. 1 [ILLINOIS] FED. AID PROJECT				

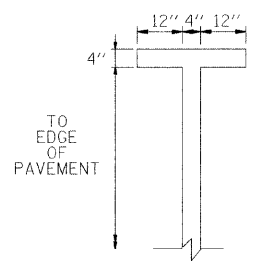

**PARKING STALL MARKING DETAILS**

NOTE: PARKING STALL PAVEMENT MARKING SHALL BE WHITE PAINT ALONG FIRST STREET AND YELLOW PAINT WITHIN ALL OFF STREET PARKING LOTS.

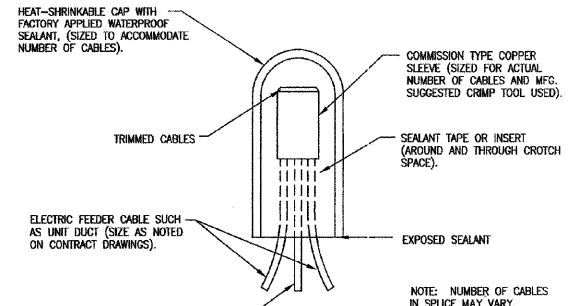

**SPlicing ELECTRIC CABLE**  
NOT TO SCALE

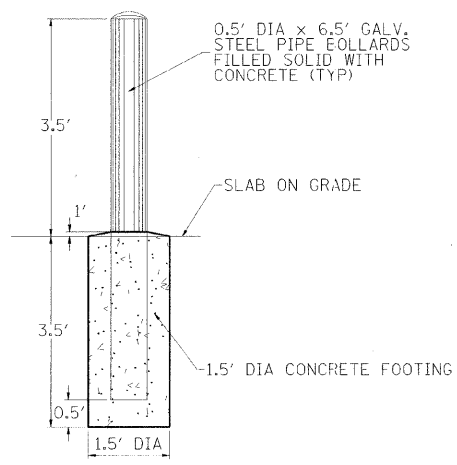

**6" DIAMETER PIPE BOLLARD, CONCRETE FILLED**

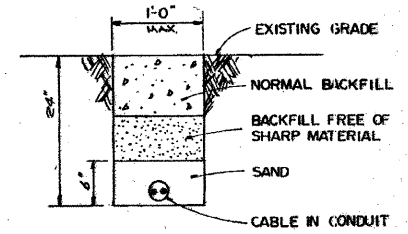

**INSTALLATION OF DIRECT BURIAL CABLE IN CONDUIT**

**ROADWAY LIGHTING NOTES:**

ROADWAY LIGHTING REQUIREMENTS FOR THIS PROJECT SHALL COMPLY WITH ALL IDOT STANDARD SPECIFICATIONS FOR ROAD AND BRIDGE CONSTRUCTION (LATEST EDITION), IDOT AND RECURRING SPECIAL PROVISIONS, CONTRACT SPECIAL PROVISIONS AND THE AMERICAN NATIONAL STANDARD PRACTICE FOR ROADWAY LIGHTING, ANSI/TIES RP-8.

RELOCATED LIGHTING UNIT LOCATIONS SHALL BE PLACED 3' BEHIND EXISTING BACK OF CURB TO CONFORM WITH EXISTING LIGHTING LAYOUT. IT SHALL BE THE CONTRACTOR'S RESPONSIBILITY TO MARK THE PROPOSED LOCATIONS OF ALL LIGHT POLES AND UTILITY LOCATIONS FOR EXAMINATION AND CONFIRMATION WITH THE RESIDENT ENGINEER, PRIOR TO AUGERING.

A GROUND ROD SHALL BE PROVIDED FOR EACH CONCRETE FOUNDATION, GROUNDING CONNECTIONS MADE TO THE FOUNDATION SHALL BE EXOTHERMICALLY WELDED, AS SPECIFIED IN THE PLAN DETAILS.

THE CONTRACTOR SHALL MAKE SPECIAL NOTE OF THE SPECIFIED REQUIREMENTS FOR BURIED WARNING TAPE, SPECIFIED AS PART OF "TRENCH AND BACKFILL FOR ELECTRICAL WORK." THE INSTALLATION OF THE TAPE SHALL BE INSPECTED BY THE ENGINEER PRIOR TO BACKFILLING OR DURING PLOWING OPERATIONS, AS APPLICABLE.

LIGHTING RELOCATION AND POWER RECONNECTION SHALL TAKE PLACE ON ONE DAY, PROVIDING UN-INTERRUPTED SERVICE WITHIN THE PROJECT LIMITS.

RESIDENTIAL AND INTERSECTION LIGHT POLES MUST BE EMBEDDED TO A DEPTH OF FIVE (5) FEET.

GROUND RODS WILL BE REQUIRED AT EACH RELOCATED LIGHTING UNIT.

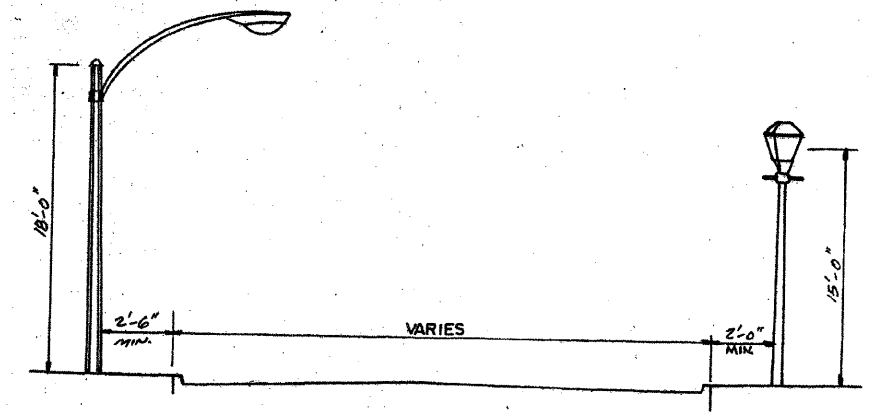

**TYPICAL CROSS SECTION**

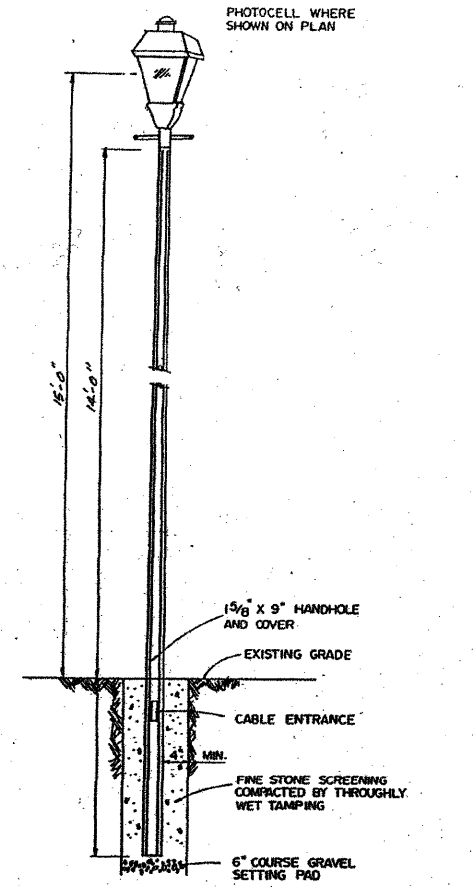

**TYPICAL CONCRETE POLE AND FOUNDATION DETAILS FOR RESIDENTIAL STREET LIGHT**

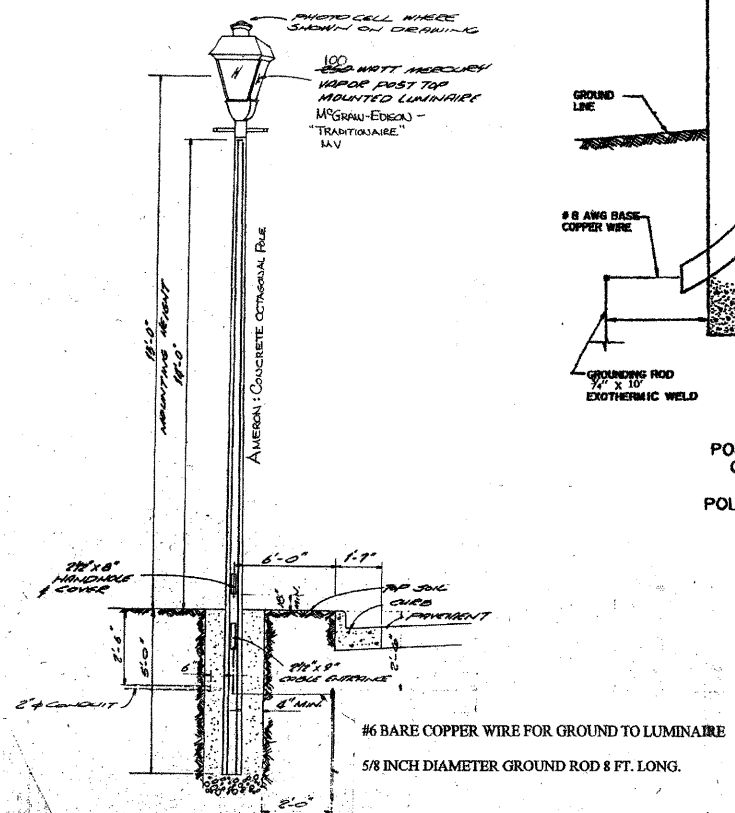

**CONCRETE POLE FOR POST TOP LUMINAIRE FOR RESIDENTIAL STREET LIGHT**

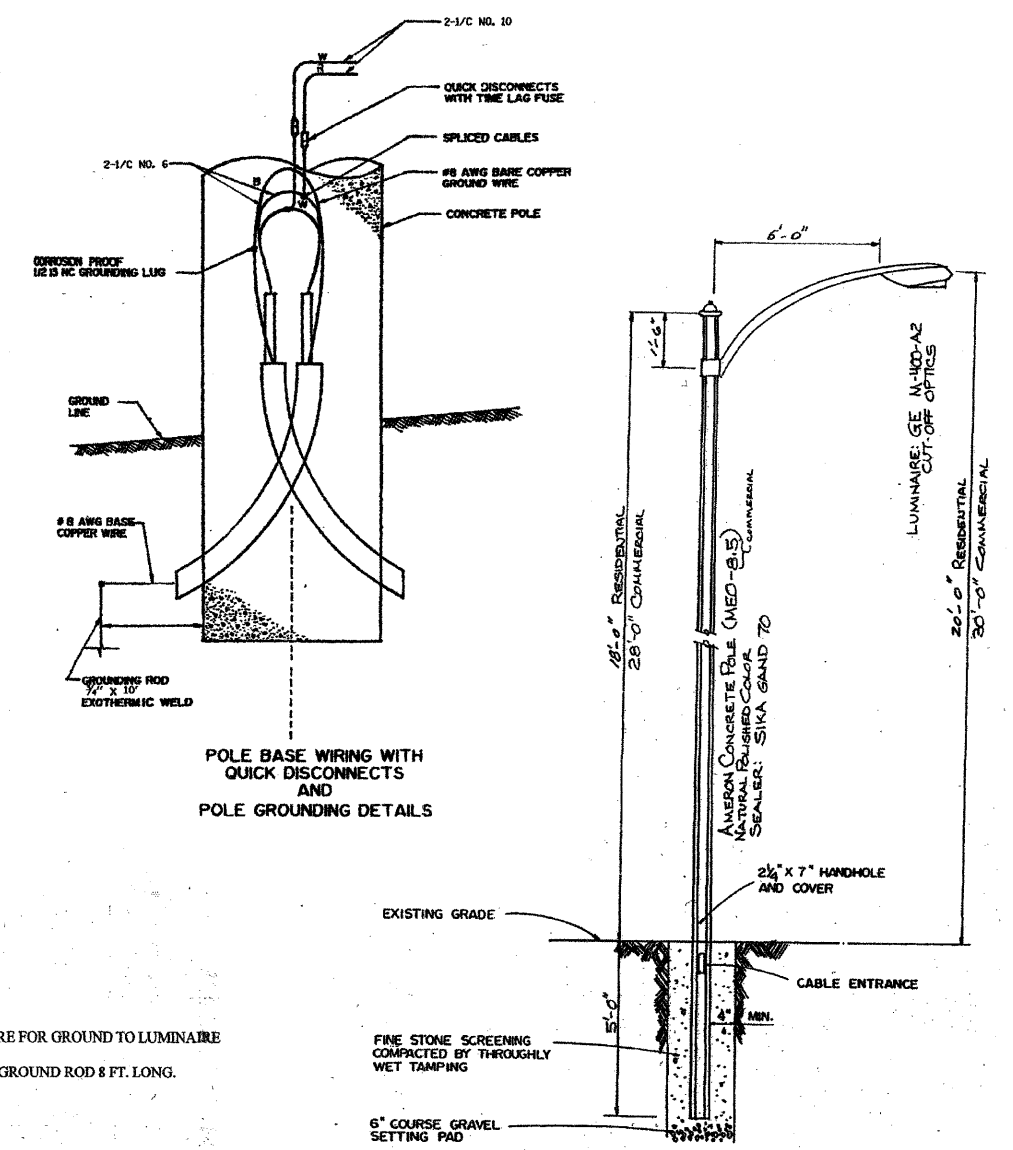

**CONCRETE POLE AND FOUNDATION DETAILS FOR INTERSECTION STREET LIGHT**

FILENAME = g:\d\0000\road\details\of\1010-584-Details.dwt	USER NAME = ESN:bouber	DESIGNED - ESN	REVISED -	<b>STATE OF ILLINOIS DEPARTMENT OF TRANSPORTATION</b>	<b>FIRST STREET ON-STREET PARKING CONSTRUCTION PARKING PAVEMENT MARKING DETAILS, PIPE BOLLARD DETAIL, LIGHTING NOTES AND LIGHTING DETAILS</b>	F.A.U. R.T.E. = 1392	SECTION = 09-00172-00-PK	COUNTY = DUPAGE	TOTAL SHEETS = 18	SHEET NO. = 11		
PLOT DATE = 12/8/2009 1:09:10 PM	DRAWN - AJP	CHECKED - DWB	REVISED -			SCALE: SHEET NO. 1 OF 1 SHEETS	STA. TO STA.	CONTRACT NO. 63382				
DATE = 12-09-09	REVISED -	REVISED -	REVISED -			FED. ROAD DIST. NO. (ILLINOIS) FED. AID PROJECT						

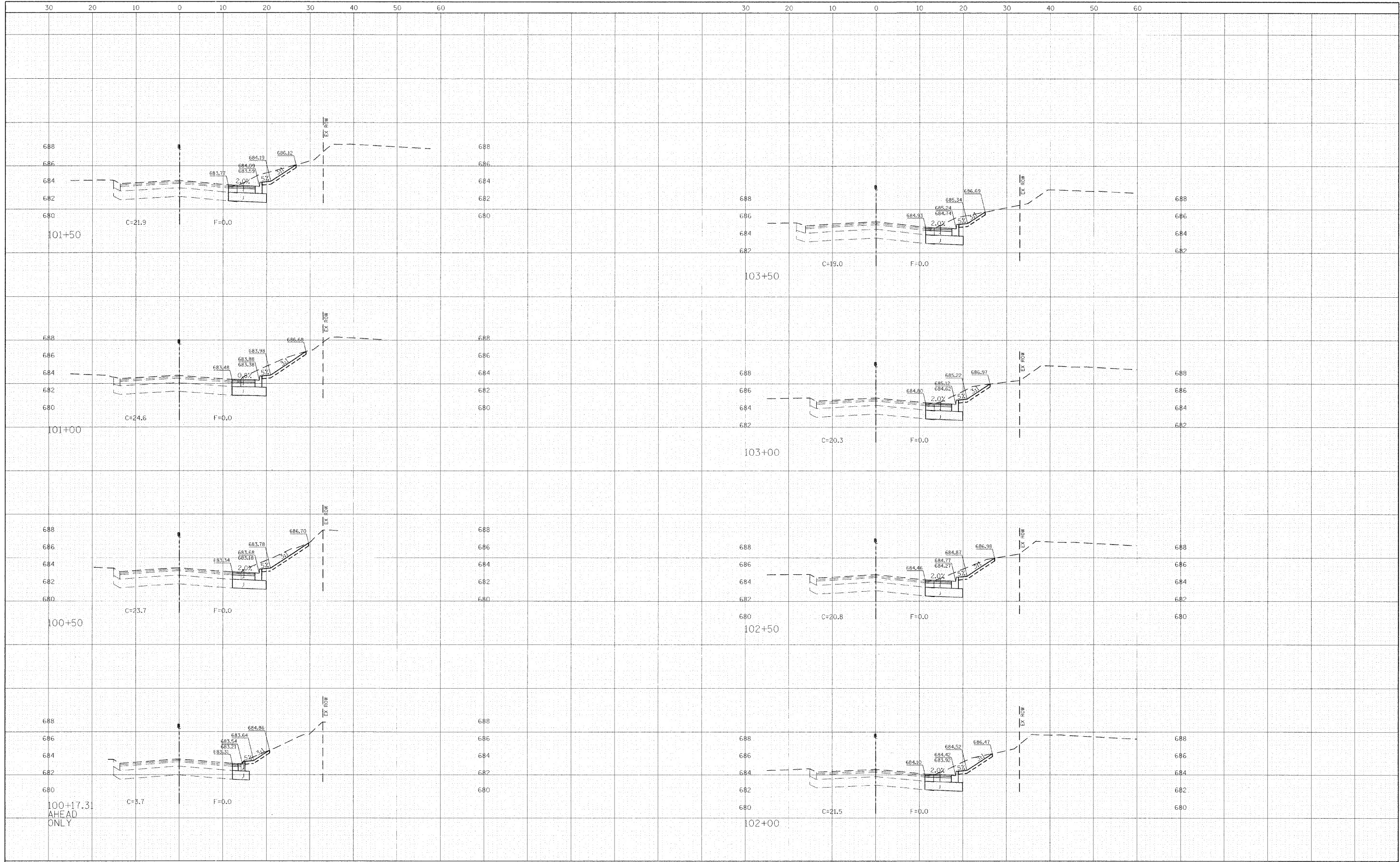

FILENAME = g:\civ\1083\road\sheet\cd\office\KS-08\FirstSt.dwg	USER NAME = ESNeubauer	DESIGNED - ESN	REVISED -
	PLOT DATE = 12/8/2009 1:07:17 PM	DRAWN - KB	REVISED -
		CHECKED - DWB	REVISED -
		DATE - 12-09-09	REVISED -

**STATE OF ILLINOIS  
DEPARTMENT OF TRANSPORTATION**

**FIRST STREET ON-STREET PARKING CONSTRUCTION  
CROSS SECTIONS MYRTLE AVE TO EVERGREEN AVE**

SCALE: 1:10 H, 1:5 V SHEET NO. 1 OF 7 SHEETS STA. 100+17 TO STA. 103+50

F.A.U. RTE. 1392	SECTION 09-00172-00-PK	COUNTY DUPAGE	TOTAL SHEETS 18	SHEET NO. 12
FED. ROAD DIST. NO. [ILLINOIS] FED. AID PROJECT		CONTRACT NO. 63382		

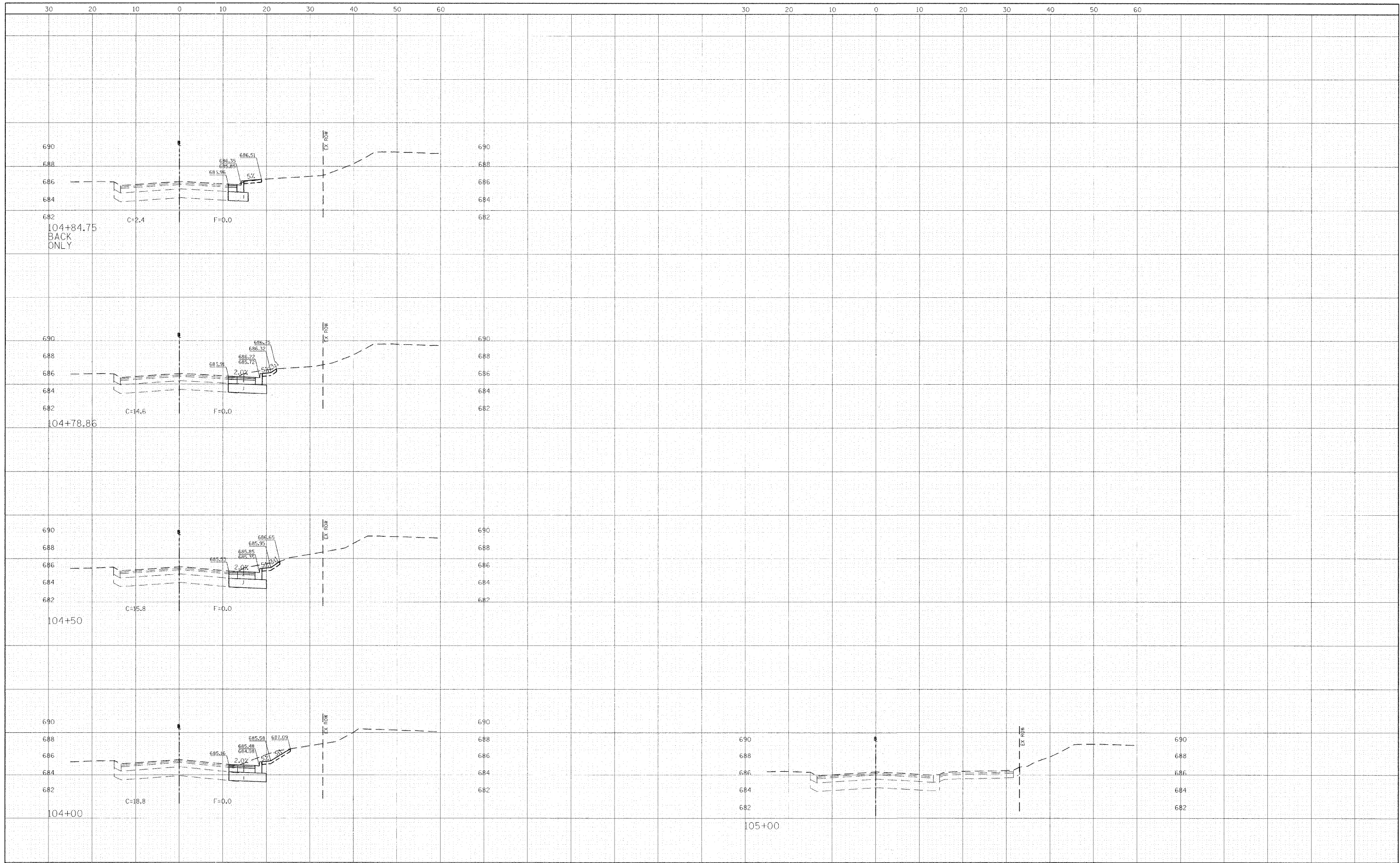

FILENAME = g:\ch29\0203\road\sheet\cd\office\ES-081-FirstSt.dwg	USER NAME = ESNeubauer	DESIGNED - ESN	REVISED -	<b>STATE OF ILLINOIS DEPARTMENT OF TRANSPORTATION</b>	<b>FIRST STREET ON-STREET PARKING CONSTRUCTION CROSS SECTIONS MYRTLE AVE TO EVERGREEN AVE</b>	F.A.U. RTE. 1392	SECTION 09-00172-00-PK	COUNTY DUPAGE	TOTAL SHEETS 18	SHEET NO. 13	
PLOT DATE = 12/9/2009 1:07:29 PM						CHECKED - DWB	REVISED -	CONTRACT NO. 63382			
DATE - 12-09-09						REVISED -	SCALE: 1:10 H, 1:5 V   SHEET NO. 2 OF 7 SHEETS   STA. 104+00 TO STA. 105+00				
								FED. ROAD DIST. NO. [ILLINOIS] FED. AID PROJECT			

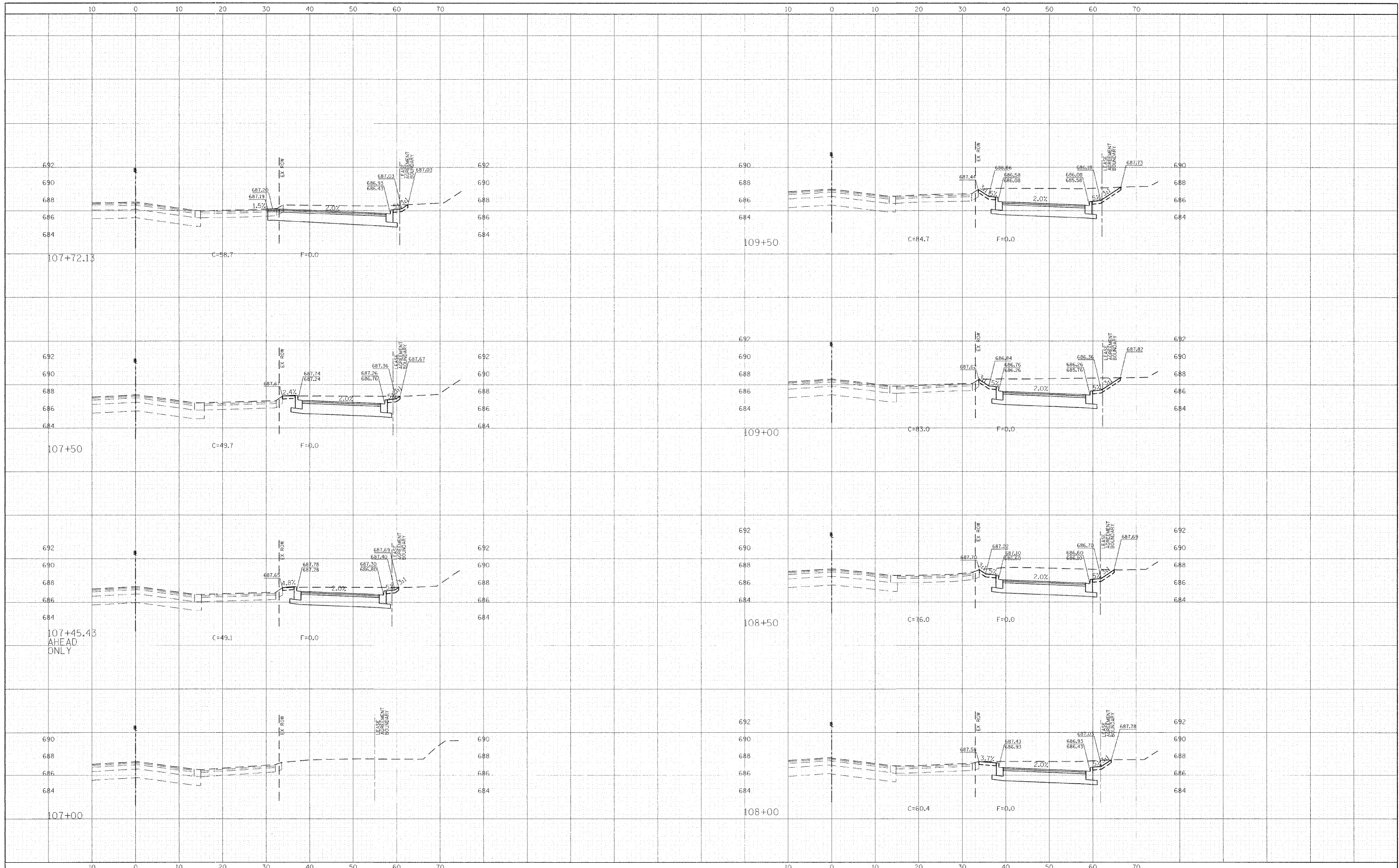

FILENAME = g:\d\1003\road\sheet\cd of Trce\109-001-First\109-001.sht	USER NAME = ESNeubauer	DESIGNED - ESN	REVISED -
PLOT DATE = 12/8/2009 1:07:43 PM		DRAWN - KB	REVISED -
		CHECKED - DWB	REVISED -
		DATE - 12-09-09	REVISED -

**STATE OF ILLINOIS  
DEPARTMENT OF TRANSPORTATION**

**FIRST STREET ON-STREET PARKING CONSTRUCTION  
CROSS SECTIONS ELM AVE TO MAPLE AVE**

SCALE: 1:10 H, 1:5 V SHEET NO. 3 OF 7 SHEETS STA. 107+00 TO STA. 109+50

F.A.U. RTE. 1392	SECTION 09-00172-00-PK	COUNTY DUPAGE	TOTAL SHEETS 18	SHEET NO. 14
CONTRACT NO. 63382				
FED. ROAD DIST. NO. ILLINOIS FED. AID PROJECT				

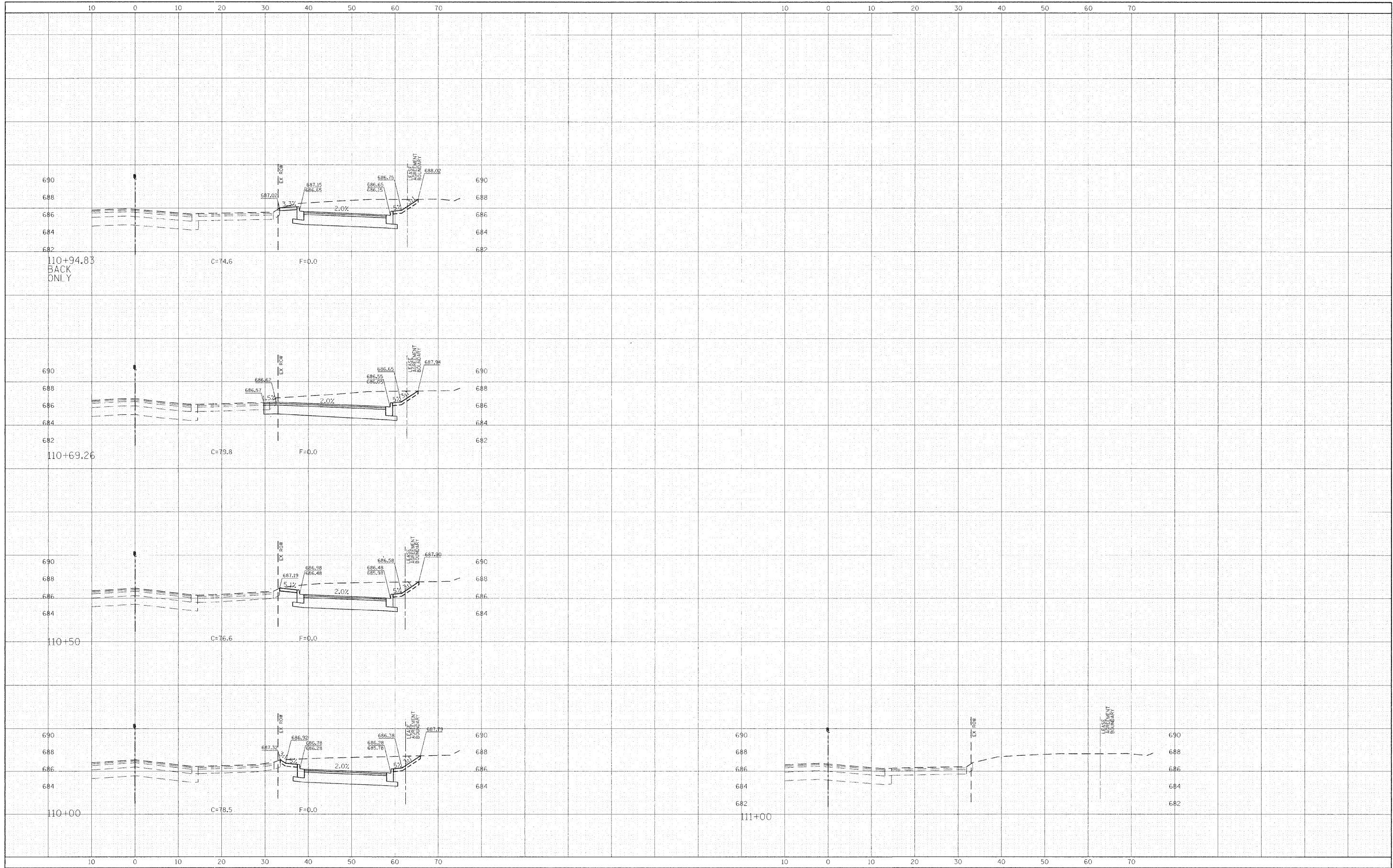

FILENAME = g:\d\1003\road\sheet\cd of\1003\1003-081-FirstSt.dwg

USER NAME = ESNeubauer  
 PLOT DATE = 12/8/2009 1:07:50 PM

DESIGNED - ESN  
 DRAWN - KB  
 CHECKED - DWB  
 DATE - 12-09-09

REVISED -  
 REVISED -  
 REVISED -  
 REVISED -

**STATE OF ILLINOIS  
 DEPARTMENT OF TRANSPORTATION**

**FIRST STREET ON-STREET PARKING CONSTRUCTION  
 CROSS SECTIONS ELM AVE TO MAPLE AVE**

SCALE: 1:10 H, 1:5 V | SHEET NO. 4 OF 7 SHEETS | STA. 110+00 TO STA. 111+00

F.A.U. RTE.	SECTION	COUNTY	TOTAL SHEETS	SHEET NO.
1392	09-00172-00-PK	DUPAGE	18	15
FED. ROAD DIST. NO. [ILLINOIS] FED. AID PROJECT				CONTRACT NO. 63382

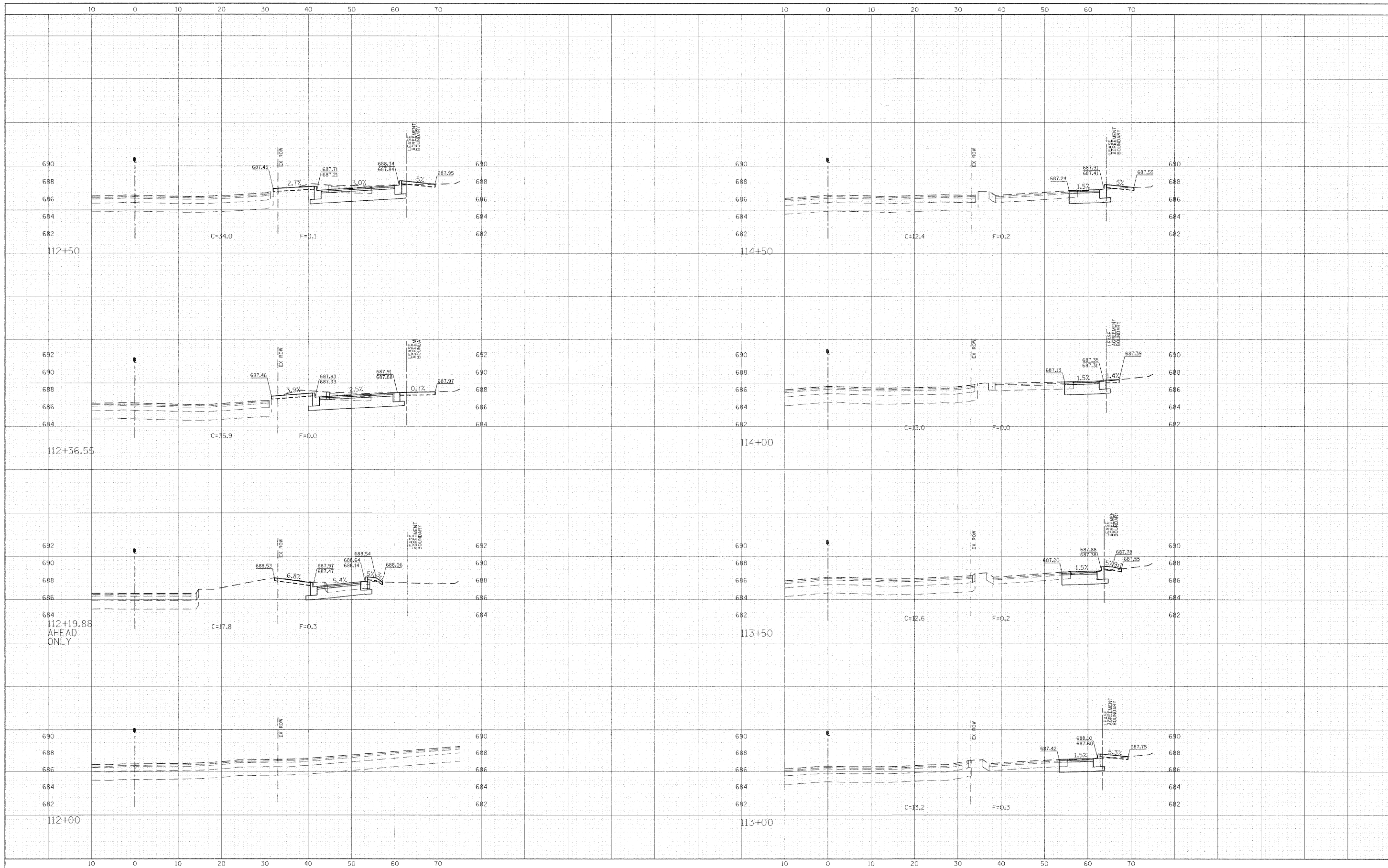

FILENAME - <small>g:\112\112\road\sheet\cd\office\12-09-09\112-00-13.ctb</small>	USER NAME - ESNeubauer PLOT DATE = 12/8/2009 1:10:14 PM	DESIGNED - ESN DRAWN - KB CHECKED - DWB DATE - 12-09-09	REVISED - REVISED - REVISED - REVISED -	<b>STATE OF ILLINOIS DEPARTMENT OF TRANSPORTATION</b>	<b>FIRST STREET ON-STREET PARKING CONSTRUCTION CROSS SECTIONS MAPLE AVE TO LARCH AVE</b>	F.A.U. RTE. 1392 SECTION 09-00172-00-PK COUNTY DUPAGE TOTAL SHEETS 18 SHEET NO. 16	CONTRACT NO. 63382 ILLINOIS FED. AID PROJECT
---	--	--	--	---	--	--	---

SCALE: 1:10 H, 1:5 V | SHEET NO. 5 OF 7 SHEETS | STA. 112+00 TO STA. 114+50



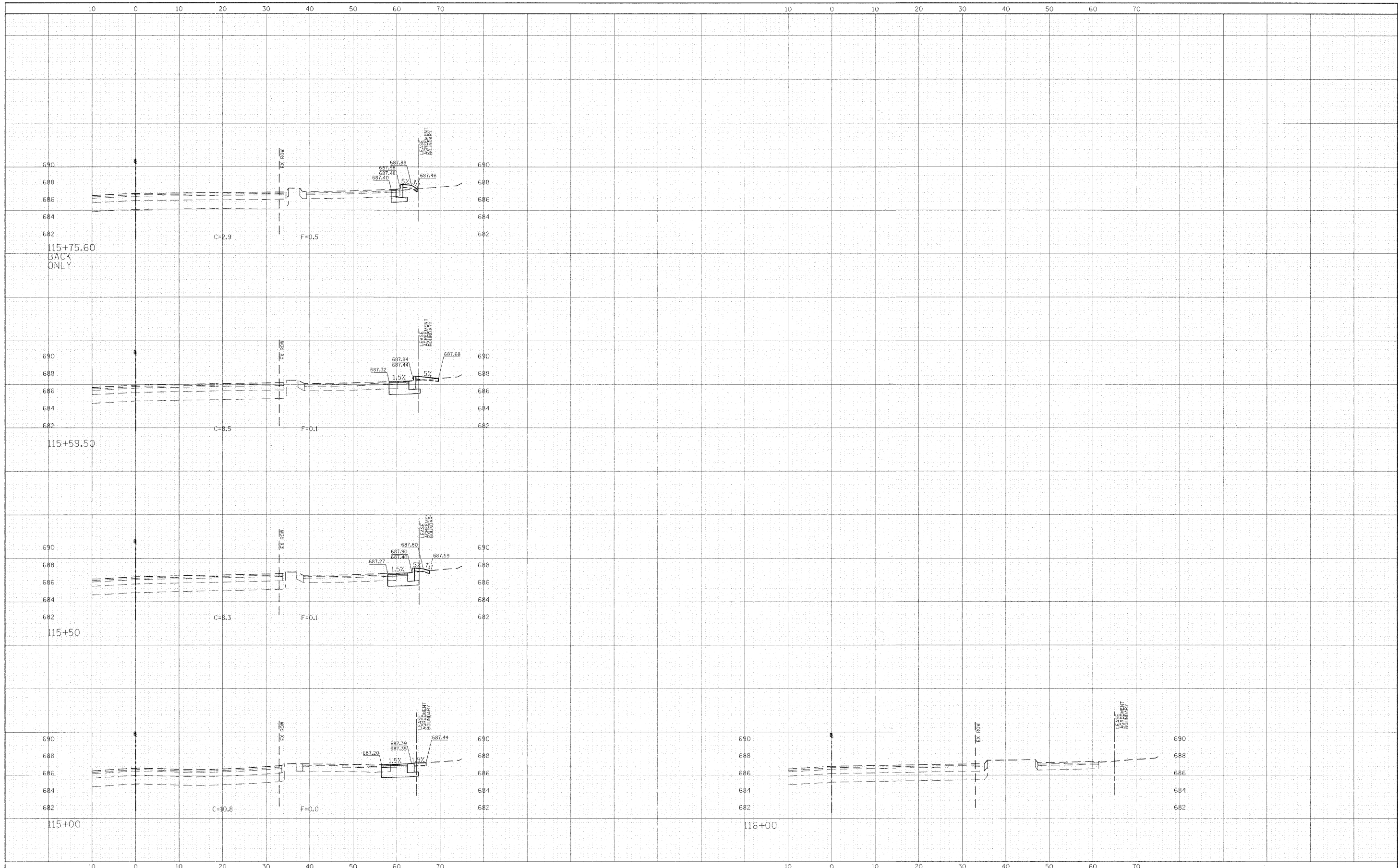

FILENAME = g:\ch29\083\road\sheet\cd of fca\15-081-FirstSt.dwg  
 USER NAME = ESNeubauer  
 PLOT DATE = 12/9/2009 1:10:27 PM

DESIGNED - ESN  
 DRAWN - KB  
 CHECKED - DWB  
 DATE - 12-09-09

REVISED -  
 REVISED -  
 REVISED -  
 REVISED -

**STATE OF ILLINOIS  
 DEPARTMENT OF TRANSPORTATION**

**FIRST STREET ON-STREET PARKING CONSTRUCTION  
 CROSS SECTIONS MAPLE AVE TO LARCH AVE**

SCALE: 1:10 H, 1:5 V | SHEET NO. 6 OF 7 SHEETS | STA. 115+00 TO STA. 116+00

F.A.U. RTE.	SECTION	COUNTY	TOTAL SHEETS	SHEET NO.
1392	09-00172-00-PK	DUPAGE	18	17
FED. ROAD DIST. NO. ILLINOIS FED. AID PROJECT			CONTRACT NO. 63382	

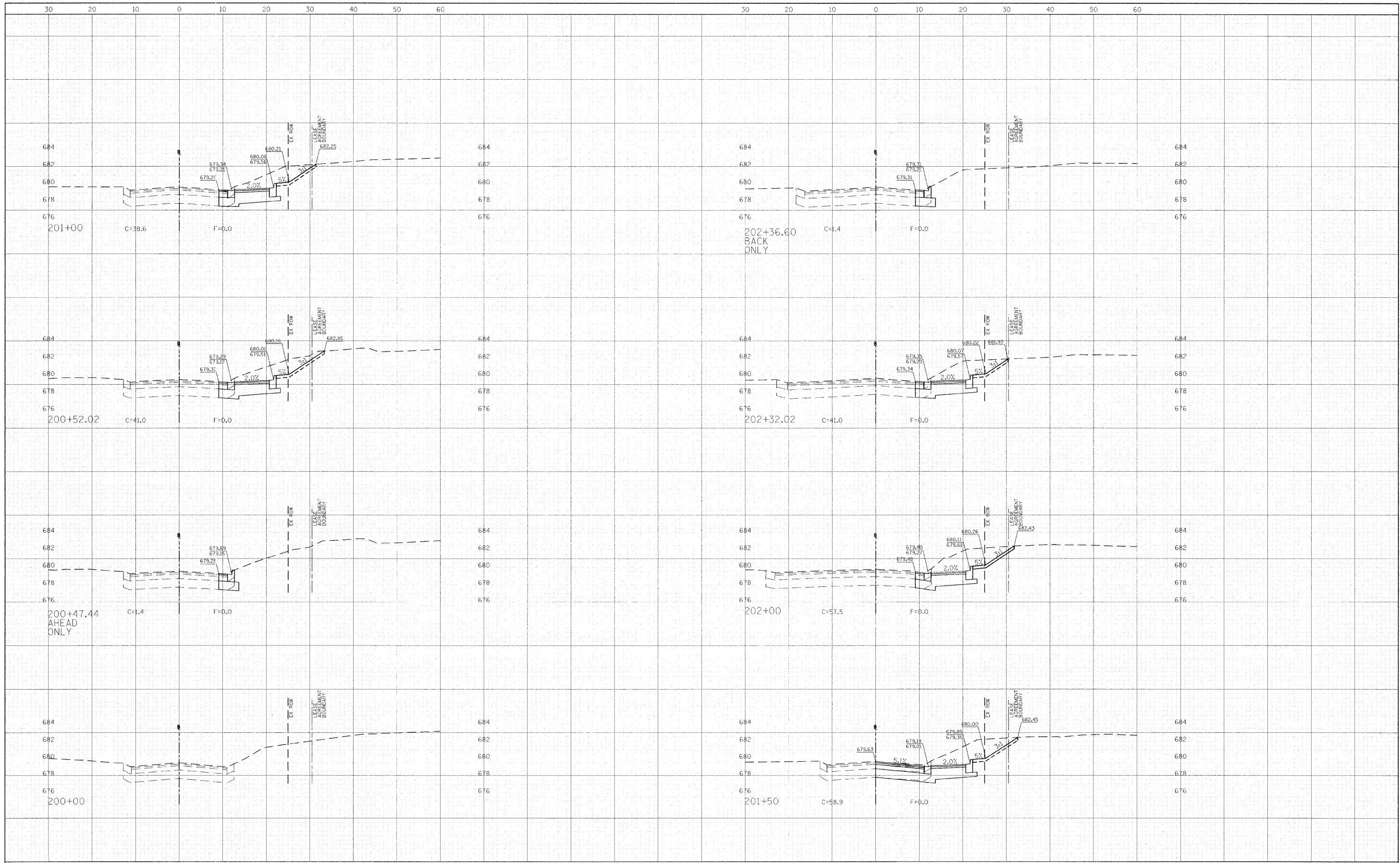

FILENAME = g:\ch29\0863\road\sheet\cd\office\US-081-First\cd\4.dwg	USER NAME = ESNeubauer	DESIGNED - ESN	REVISED -
PLOT DATE = 12/8/2009 1:10:41 PM		DRAWN - KB	REVISED -
		CHECKED - DWB	REVISED -
		DATE - 12-09-09	REVISED -

**STATE OF ILLINOIS  
DEPARTMENT OF TRANSPORTATION**

**FIRST STREET ON-STREET PARKING CONSTRUCTION  
CROSS SECTIONS HAVEN AVE TO CLARA AVE**

SCALE: 1:10 H, 1:5 V SHEET NO. 7 OF 7 SHEETS STA. 200+00 TO STA. 202+36.60

F.A.U. RTE. 1392	SECTION 09-00172-00-PK	COUNTY DUPAGE	TOTAL SHEETS 18	SHEET NO. 18
FED. ROAD DIST. NO. ILLINOIS		FED. AID PROJECT		
CONTRACT NO. 63382				