

SECTION 36, TOWNSHIP 36, RANGE 12
SECTION 31, TOWNSHIP 36, RANGE 13

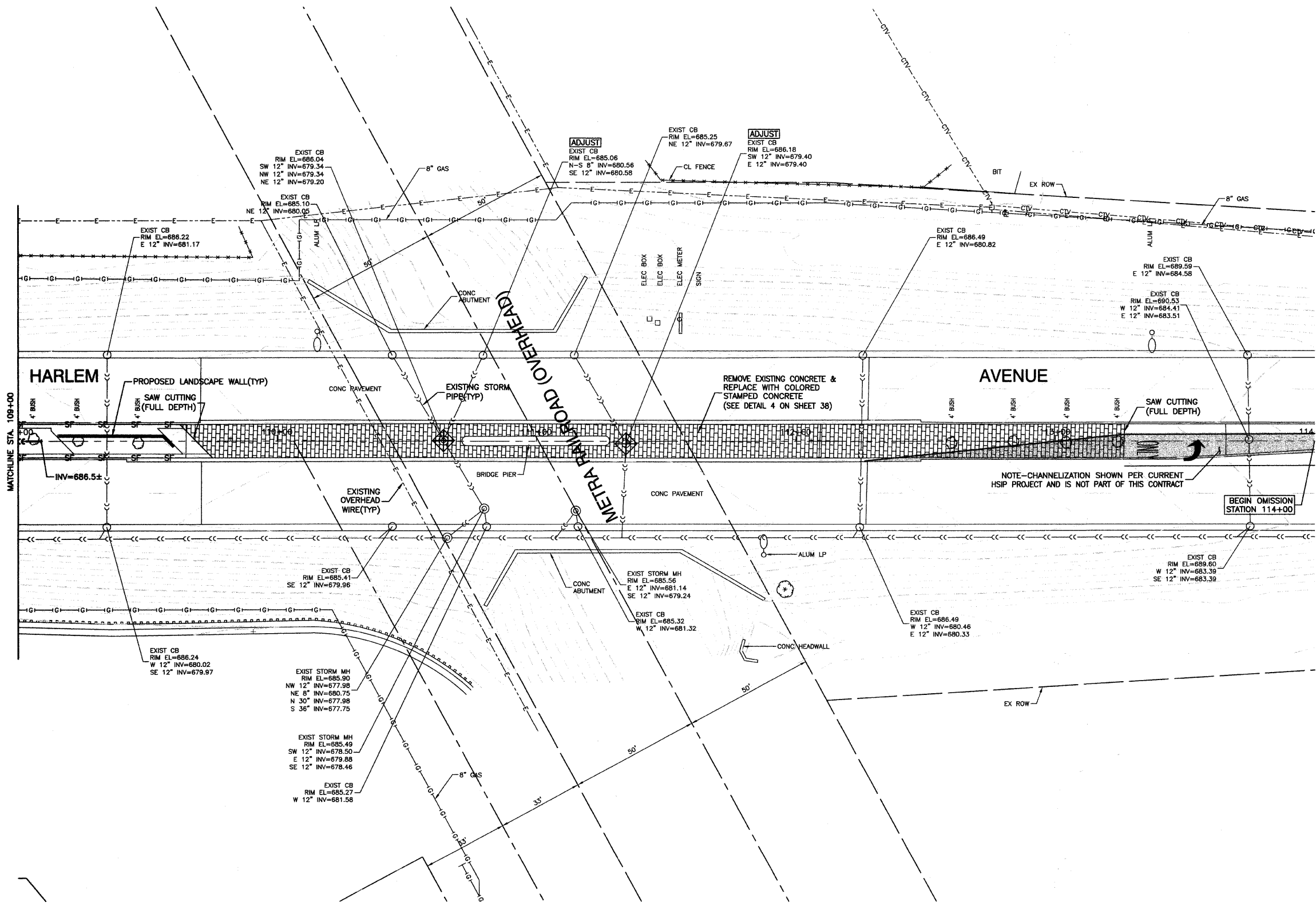
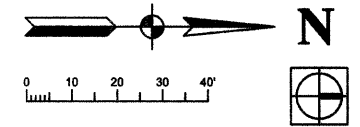

LEGEND

- SF— PERIMETER EROSION BARRIER
- ◆ INLET FILTER

NOTES:
PROPOSED PLANTINGS NOT SHOWN FOR CLARITY.
SEE LANDSCAPING PLANS.

BENCH MARK: 172
SQUARE CUT ON W. FACE OF CONC BASE OF ALP, 2ND POLE
S. OF I-80 EXIT RAMP TO NORTHBOUND HARLEM AVENUE
ELEVATION=704.09

FILE NAME = 09493-PLAN-01 - 013	USER NAME =	DESIGNED — SDG	REVISED —	STATE OF ILLINOIS DEPARTMENT OF TRANSPORTATION	HARLEM AVENUE BEAUTIFICATION - STREETSCAPING DRAINAGE AND EROSION CONTROL PLAN		F.A.P. RTE.	SECTION	COUNTY	TOTAL SHEETS	SHEET NO.
	PLOT SCALE =	CHECKED — JSP	REVISED —		SCALE: 1"=20'	348	09-00108-00-LS	COOK	38	18	
PLOT DATE = 11-30-09	DRAWN — PS	REVISED —		SHEET NO. 18 OF 38 SHEETS	STA.	TO STA.	CONTRACT NO. 63412				
	CHECKED — AG	REVISED —					FED. ROAD DIST. NO. 1 ILLINOIS FED. AID PROJECT ARA-00D1(809)				