

EXISTING TOPOGRAPHY

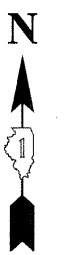

PROPOSED IMPROVEMENT

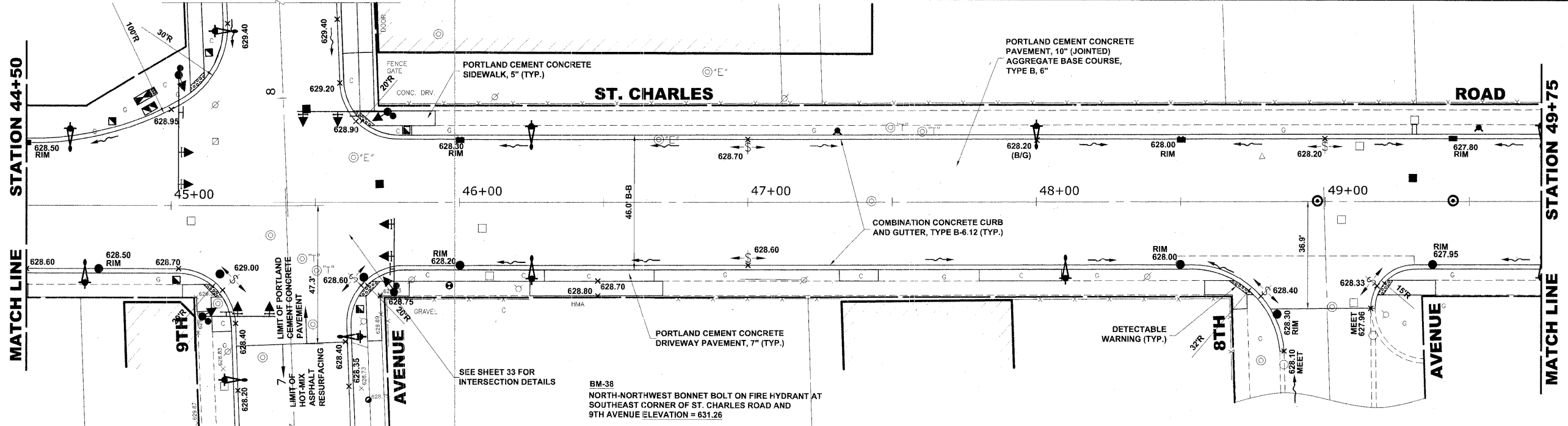
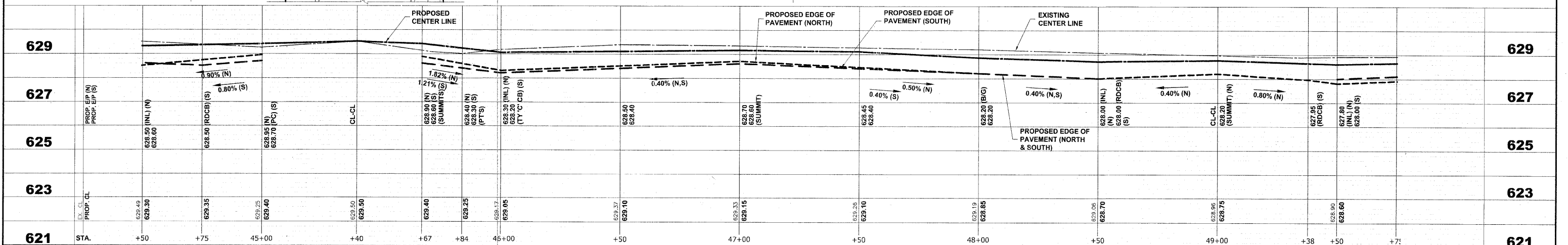

HANCOCK ENGINEERING
 Civil Engineers
 Municipal Consultants
 Established 1911

USER NAME -	DESIGNED - MK/SBC	REVISED -
PLOT SCALE -	DRAWN - MK/LEV	REVISED -
PLOT DATE -	CHECKED - SBC/JG/MV	REVISED -
	DATE - 11-30-09	REVISED -

STATE OF ILLINOIS DEPARTMENT OF TRANSPORTATION

ST. CHARLES ROAD PLAN AND PROFILE
 SCALE: 1"=20'H./2'V. SHEET NO. 9 OF 11 SHEETS STA. 44+50 TO STA. 49+75

F.A.U. RTE. 1397	SECTION 09-00129-00-PV	COUNTY COOK	TOTAL SHEETS 103	SHEET NO. 29
CONTRACT NO. 63428			AID PROJECT M-9003 (267)	
(BOOK NOS. 1579, 1583, 1589) E.H.E. PROJECT NO. 565-08-29001				

Drawing file: W:\Projects\565082900 - St. Charles Rd\St. Charles Road.dwg Dec. 07, 2009 - 10:17am