

EXISTING TOPOGRAPHY

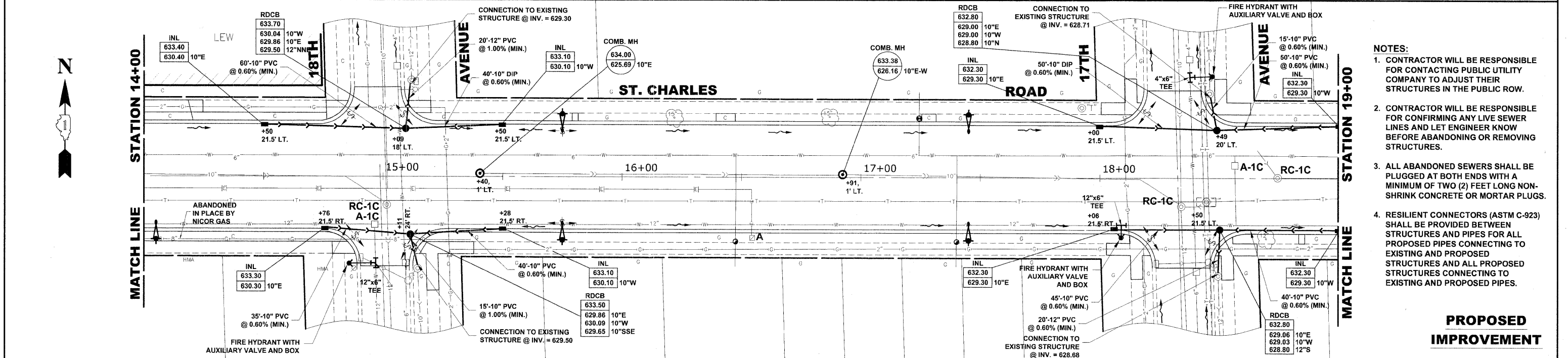

- NOTES:**
1. CONTRACTOR WILL BE RESPONSIBLE FOR CONTACTING PUBLIC UTILITY COMPANY TO ADJUST THEIR STRUCTURES IN THE PUBLIC ROW.
 2. CONTRACTOR WILL BE RESPONSIBLE FOR CONFIRMING ANY LIVE SEWER LINES AND LET ENGINEER KNOW BEFORE ABANDONING OR REMOVING STRUCTURES.
 3. ALL ABANDONED SEWERS SHALL BE PLUGGED AT BOTH ENDS WITH A MINIMUM OF TWO (2) FEET LONG NON-SHRINK CONCRETE OR MORTAR PLUGS.
 4. RESILIENT CONNECTORS (ASTM C-923) SHALL BE PROVIDED BETWEEN STRUCTURES AND PIPES FOR ALL PROPOSED PIPES CONNECTING TO EXISTING AND PROPOSED STRUCTURES AND ALL PROPOSED STRUCTURES CONNECTING TO EXISTING AND PROPOSED PIPES.

PROPOSED IMPROVEMENT

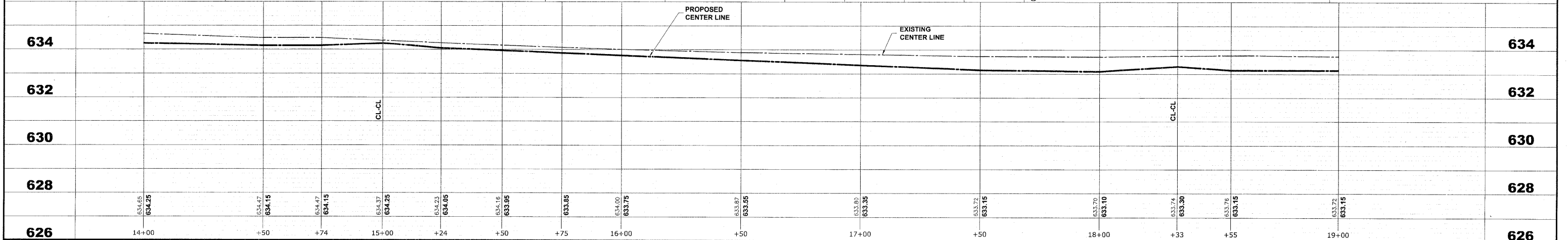

HANCOCK ENGINEERING
 Civil Engineers
 Municipal Consultants
 Established 1911

USER NAME --	DESIGNED -- MK/SBC	REVISED --
PLOT SCALE --	DRAWN -- MK/LEV	REVISED --
PLOT DATE --	CHECKED -- SBC/JGMV	REVISED --
	DATE -- 11-30-09	REVISED --

STATE OF ILLINOIS DEPARTMENT OF TRANSPORTATION

ST. CHARLES ROAD UTILITIES PLAN AND PROFILE
 SCALE: 1"=20'H/2'V. SHEET NO. 3 OF 11 SHEETS STA. 14+00 TO STA. 19+00

F.A.U. RTE. 1397	SECTION 09-00129-00-PV	COUNTY COOK	TOTAL SHEETS 103	SHEET NO. 38
CONTRACT NO. 63428				
FED. ROAD DIST. NO. 1 ILLINOIS FED. AID PROJECT M-9003 (267)				
(BOOK NOS. 1579, 1583, 1589) E.H.E PROJECT NO. 565-08-29001				

Drawing file: W:\Projects\565082900 - St. Charles Rd\St. Charles Rd.dwg Dec. 07, 2009 - 3:41 pm