

EXISTING TOPOGRAPHY

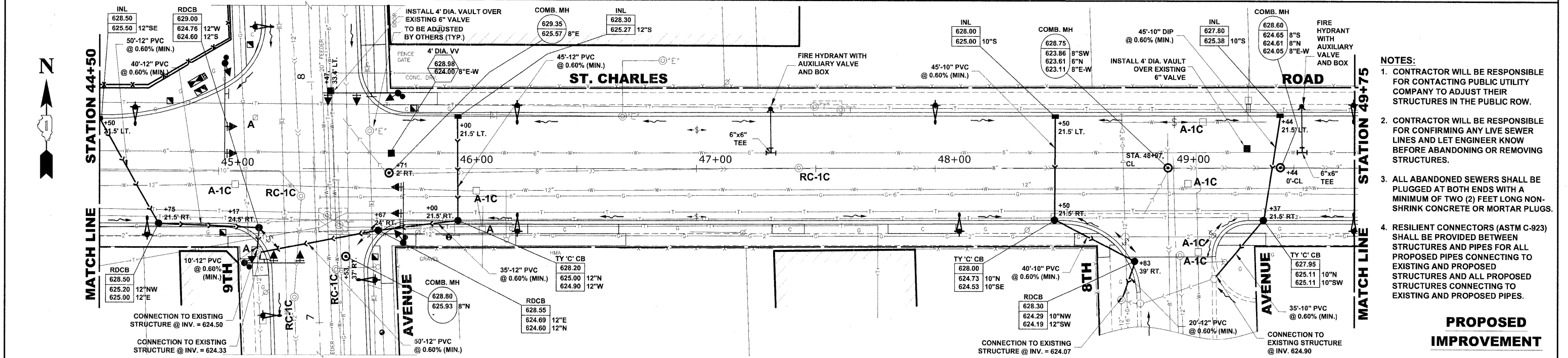

- NOTES:**
1. CONTRACTOR WILL BE RESPONSIBLE FOR CONTACTING PUBLIC UTILITY COMPANY TO ADJUST THEIR STRUCTURES IN THE PUBLIC ROW.
 2. CONTRACTOR WILL BE RESPONSIBLE FOR CONFIRMING ANY LIVE SEWER LINES AND LET ENGINEER KNOW BEFORE ABANDONING OR REMOVING STRUCTURES.
 3. ALL ABANDONED SEWERS SHALL BE PLUGGED AT BOTH ENDS WITH A MINIMUM OF TWO (2) FEET LONG NON-SHRINK CONCRETE OR MORTAR PLUGS.
 4. RESILIENT CONNECTORS (ASTM C-923) SHALL BE PROVIDED BETWEEN STRUCTURES AND PIPES FOR ALL PROPOSED PIPES CONNECTING TO EXISTING AND PROPOSED STRUCTURES AND ALL PROPOSED STRUCTURES CONNECTING TO EXISTING AND PROPOSED PIPES.

PROPOSED IMPROVEMENT

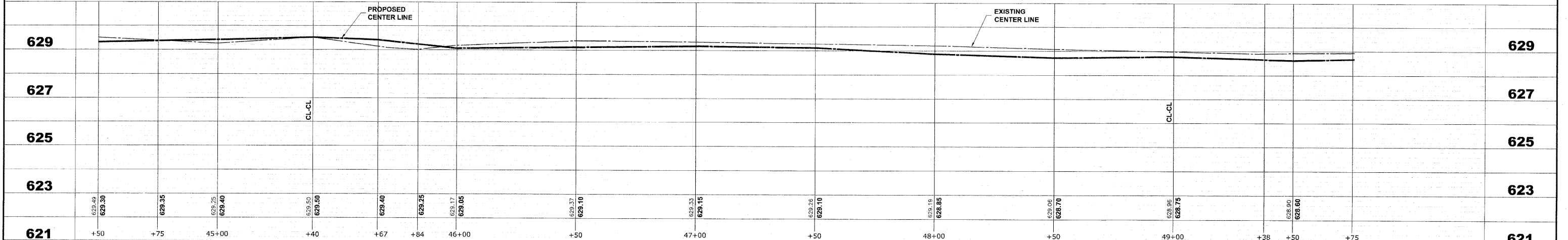

HANCOCK ENGINEERING
 Civil Engineers
 Municipal Consultants
 Established 1911

USER NAME	DESIGNED - MK/SBC	REVISED -
PLOT SCALE	DRAWN - MK/LEV	REVISED -
PLOT DATE	CHECKED - SBC/JG/MV	REVISED -
	DATE - 11-30-09	REVISED -

**STATE OF ILLINOIS
 DEPARTMENT OF TRANSPORTATION**

**ST. CHARLES ROAD
 UTILITIES PLAN AND PROFILE**
 SCALE: 1"=20'H./2'V. SHEET NO. 9 OF 11 SHEETS STA. 44+50 TO STA. 49+75

F.A.U. RTE.	SECTION	COUNTY	TOTAL SHEETS	SHEET NO.
1397	09-00129-00-PV	COOK	103	44
CONTRACT NO. 63428				
FED. ROAD DIST. NO. 1 ILLINOIS FED. AID PROJECT M-9003 (267)				
(BOOK NOS. 1579, 1583, 1589) E.H.E. PROJECT NO. 565-08-29001				

Drawing file: \\Projects\565082900 - St. Charles Road\St. Charles Road.dwg Dec: 07, 2009 - 5:43pm