

EXISTING TOPOGRAPHY

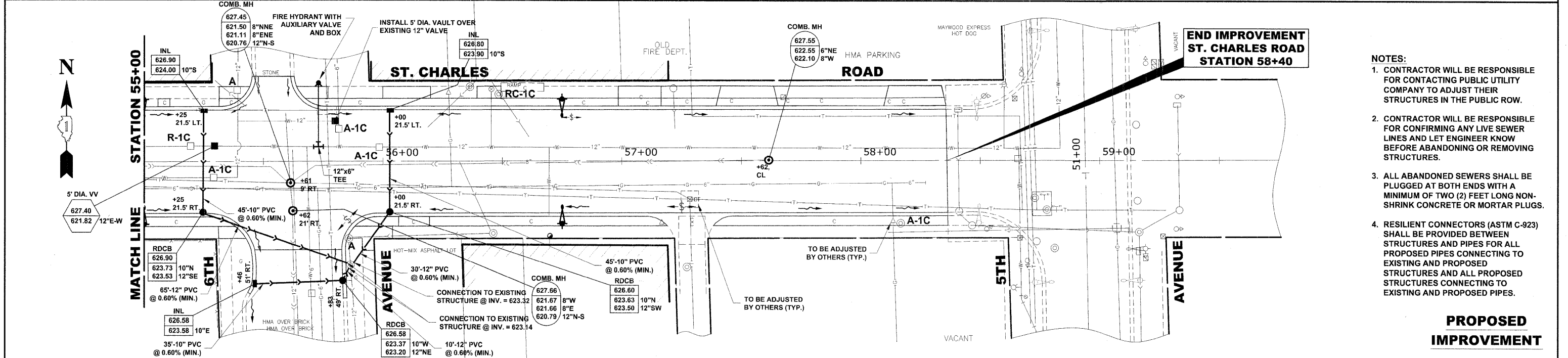

- NOTES:**
1. CONTRACTOR WILL BE RESPONSIBLE FOR CONTACTING PUBLIC UTILITY COMPANY TO ADJUST THEIR STRUCTURES IN THE PUBLIC ROW.
 2. CONTRACTOR WILL BE RESPONSIBLE FOR CONFIRMING ANY LIVE SEWER LINES AND LET ENGINEER KNOW BEFORE ABANDONING OR REMOVING STRUCTURES.
 3. ALL ABANDONED SEWERS SHALL BE PLUGGED AT BOTH ENDS WITH A MINIMUM OF TWO (2) FEET LONG NON-SHRINK CONCRETE OR MORTAR PLUGS.
 4. RESILIENT CONNECTORS (ASTM C-923) SHALL BE PROVIDED BETWEEN STRUCTURES AND PIPES FOR ALL PROPOSED PIPES CONNECTING TO EXISTING AND PROPOSED STRUCTURES AND ALL PROPOSED STRUCTURES CONNECTING TO EXISTING AND PROPOSED PIPES.

PROPOSED IMPROVEMENT

		PROPOSED CENTER LINE		EXISTING CENTER LINE										
627							627							
625							625							
623							623							
621							621							
619	55+00	+25	+62	+76	56+00	+50	57+00	+25	+50	58+00	+40	+56	59+00	619

HANCOCK ENGINEERING
 Civil Engineers
 Municipal Consultants
 Established 1911

USER NAME	DESIGNED - MK/SBC	REVISED -
PLOT SCALE	DRAWN - MK/LEV	REVISED -
PLOT DATE	CHECKED - SBC/JG/MV	REVISED -
	DATE - 11-30-09	REVISED -

**STATE OF ILLINOIS
DEPARTMENT OF TRANSPORTATION**

**ST. CHARLES ROAD
UTILITIES PLAN AND PROFILE**

SCALE: 1"=20'H./2'V. SHEET NO. 11 OF 11 SHEETS STA. 55+00 TO STA. 58+40

F.A.U. RTE. 1397	SECTION 09-00129-00-PV	COUNTY COOK	TOTAL SHEETS 103	SHEET NO. 46
CONTRACT NO. 63428			FED. ROAD DIST. NO. 1 ILLINOIS	
FED. AID PROJECT M-9003 (267)			E.H.E. PROJECT NO. 565-08-29001	

Drawing File: W:\Projects\565082900 - St. Charles Rd\St. Charles Rd\St. Charles Road.dwg Dec 07, 2009 5:43pm