

**NOTES:**

1. SETUP TRAFFIC CONTROL AND PROTECTION ACCORDING TO STANDARD 701431. SEE STANDARD FOR ADDITIONAL SIGNS AND DEVICES. SHIFT EB TRAFFIC ONTO THE INSIDE AND PART OF THE OUTSIDE WB LANES AND SHIFT WB TRAFFIC ONTO PART OF THE OUTSIDE WB LANE AND THE SHOULDER CONSTRUCTED IN STAGE 1.
2. REMOVE PAVEMENT, TEMPORARY PAVEMENT, GUARDRAIL, CURB & GUTTER, AND CATCH BASIN AS SHOWN ON PLANS. CONSTRUCT PAVEMENT WIDENING, SHOULDER, DITCH GRADING, AND PIPE CULVERT EXTENSIONS.
3. REMOVE SOUTH SECTION OF EXISTING CULVERT; REFER TO STRUCTURAL PLANS.
4. CONSTRUCT NEW BOX CULVERT, AND END SECTION.
5. CONSTRUCT CLASS B PATCHES, PAVEMENT WIDENING, SHOULDER, ACROSS ROAD CULVERT EXTENSIONS, END SECTIONS, & DITCH GRADING.

# STAGE 4

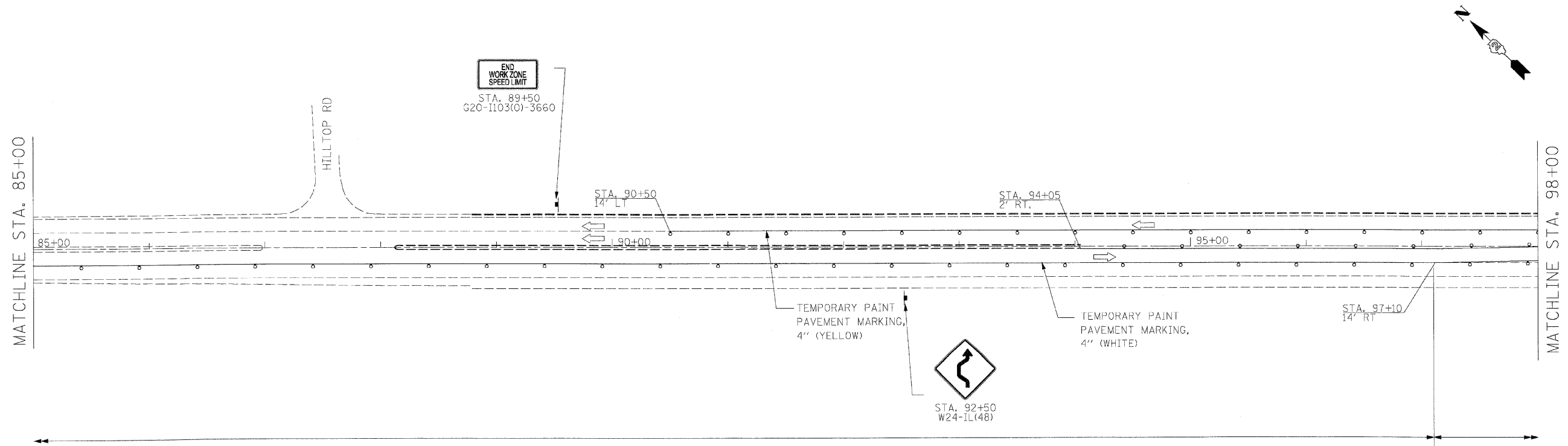
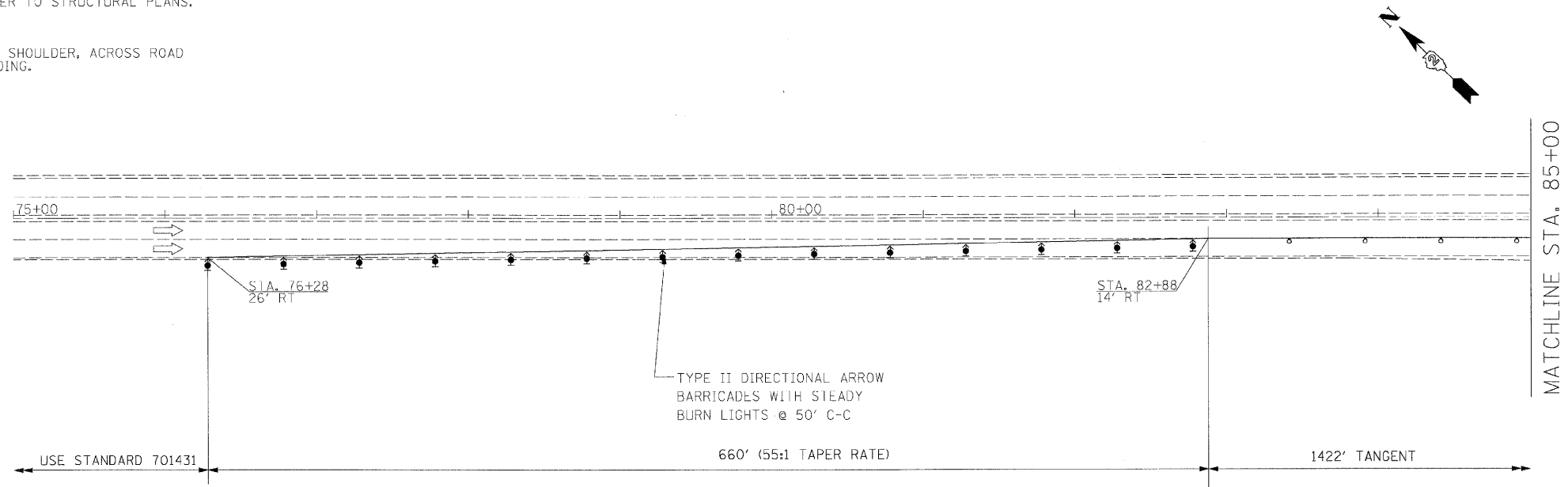

FILE NAME = G:\ENGR\06-6790-13_TASK7\Civ\Sh\1\01164C68	USER NAME = #USER# SHT0010_PROP_stage4.dgn	DESIGNED - KAC	REVISED -	<b>STATE OF ILLINOIS DEPARTMENT OF TRANSPORTATION</b>	<b>STAGING PLANS (STAGE 4)</b>		F.A.P. RTE. 301	SECTION 43T & M	COUNTY Jo Davless	TOTAL SHEETS 80	SHEET NO. 28	
	PLOT SCALE = #SCALE#	CHECKED - KAC	REVISED -		SCALE: 1" = 50'	SHEET NO. 28 OF 80 SHEETS	STA. 99+27 TO STA. 114+33	CONTRACT NO. 64C68				
	PLOT DATE = 12/1/2009	DATE - 11/13/2009	REVISED -		ILLINOIS FED. AID PROJECT							