

| F.A.P. RTE. | SECTION | COUNTY    | TOTAL SHEETS | SHEET NO. |
|-------------|---------|-----------|--------------|-----------|
| 301         | 43T&M   | JoDaviess | 80           | 34        |

| STA.  | TO STA. |
|-------|---------|
| 99+27 | 114+33  |

FED. ROAD DIST. NO. ILLINOIS FED. AID PROJECT

**STORM STRUCTURE REMOVAL**

① REMOVE HEADWALL  
STA 104+69.3  
37.7' R

**NOTE**

1. A PROPOSED PERMANENT EASEMENT SHALL BE LOCATED 1 FOOT SOUTH OF THE OUTSIDE EDGE OF THE EASTBOUND 8-FOOT BITUMINOUS SHOULDER FROM STA. 99+27 TO STA. 114+33. THIS IS REQUIRED FOR THE MAINTENANCE OF THE PROPOSED WIDENING OF EASTBOUND U.S. 20 TO ACCOMMODATE THE ADDITIONAL LEFT-TURN LANE OF CAMILLUS DRIVE.  
2. FROM STA. 99+00 TO STA. 110+45.20 THE BASE LINE IS LOCATED ALONG THE U.S. 20 CENTERLINE. FROM STA. 110+45.20 TO STA. 115+00.00 THE BASE LINE IS LOCATED 13.9 FEET SOUTHWEST AND PARALLEL TO THE U.S. 20 CENTERLINE.

**LEGEND**

- X REMOVAL ITEM
- ⊗ MEDIAN REMOVAL (SPECIAL)

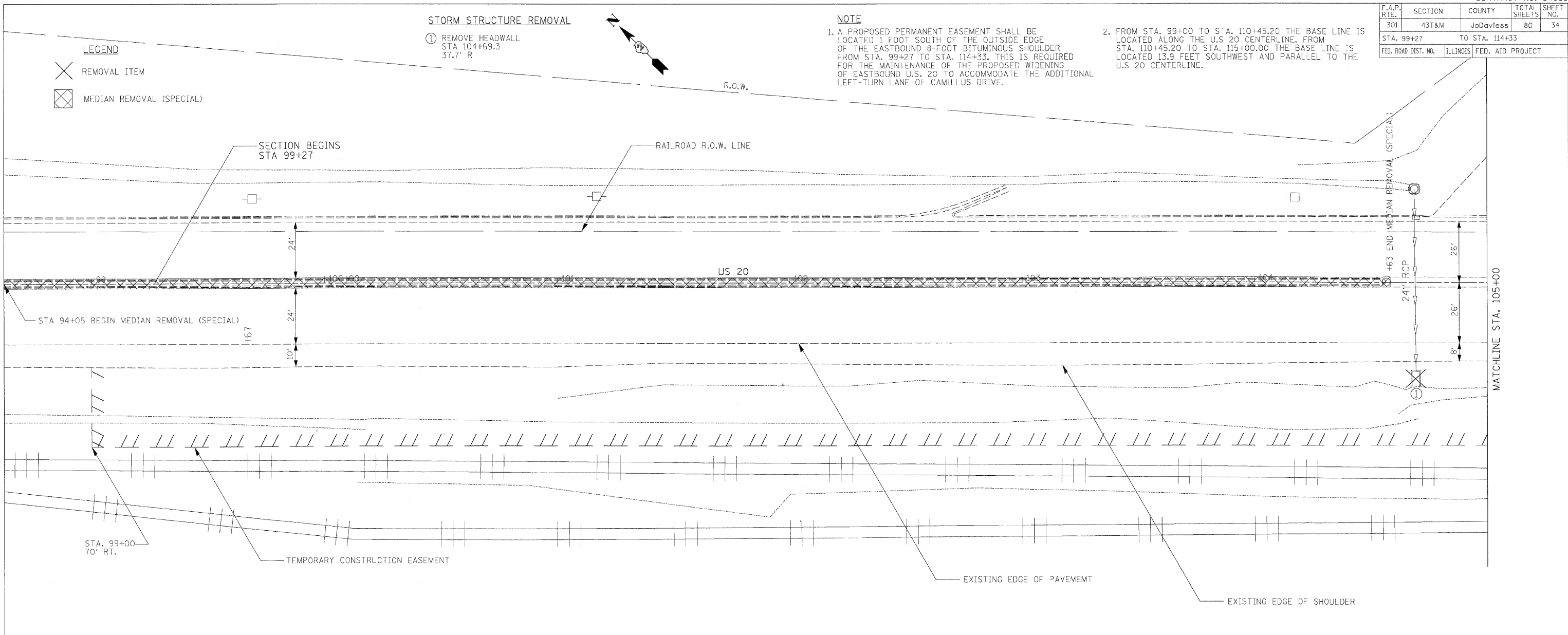

PLAN

| DATE | BY |
|------|----|
|      |    |

SUPERVISED  
PLOTTED  
CHECKED  
BY: [NAME]  
DATE: [DATE]  
NOTE BOOK NO. [NO.]  
DRAWING FILE NAME: [NAME]

PROFILE

| DATE | BY |
|------|----|
|      |    |

SUPERVISED  
PLOTTED  
CHECKED  
BY: [NAME]  
DATE: [DATE]  
NOTE BOOK NO. [NO.]  
DRAWING FILE NAME: [NAME]

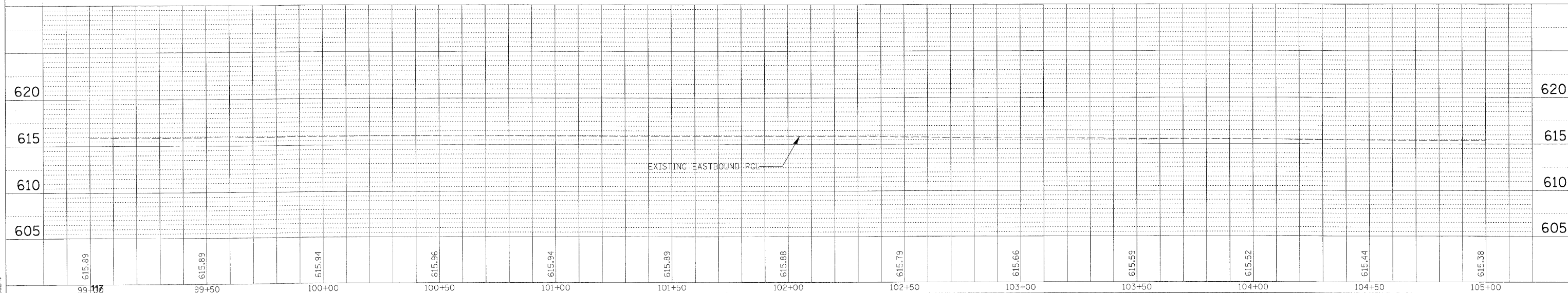

PLOT DATE = 12/1/2009  
FILE NAME = G:\EXCHG\67790-13\_1\ASK7\CAMILLUS\01101\64C68\SH101\existing.dwg  
PLOT SCALE = #SCALE#  
USER NAME = #USER#

|                      |                   |           |
|----------------------|-------------------|-----------|
| USER NAME = #USER#   | DESIGNED KAC      | REVISED - |
| PLT SCALE = #SCALE#  | DRAWN BY: CKL/TMF | REVISED - |
| PLT DATE = 12/1/2009 | CHECKED BY: KAC   | REVISED - |
|                      | DATE: 11/13/2009  | REVISED - |

**STATE OF ILLINOIS  
DEPARTMENT OF TRANSPORTATION**

US-20 /CAMILLUS DRIVE  
EXISTING PLAN & PROFILE  
SCALE: 1" = 20'  
SHEET NO. 34 OF 80 SHEETS  
STA. 99+27 TO STA. 114+33

| F.A.P. RTE. | SECTION | COUNTY    | TOTAL SHEETS | SHEET NO. |
|-------------|---------|-----------|--------------|-----------|
| 301         | 43T&M   | JODAVIESS | 80           | 34        |

FED. ROAD DIST. NO. ILLINOIS FED. AID PROJECT