

DATE: _____
 BY: _____
 SURVEYED _____
 ALIGNED _____
 RT. OF WAY CHECKED _____
 NO. _____
 PLAN

DATE: _____
 BY: _____
 SURVEYED _____
 GRADES CHECKED _____
 B.M. NOTED _____
 NO. _____
 PROFILE

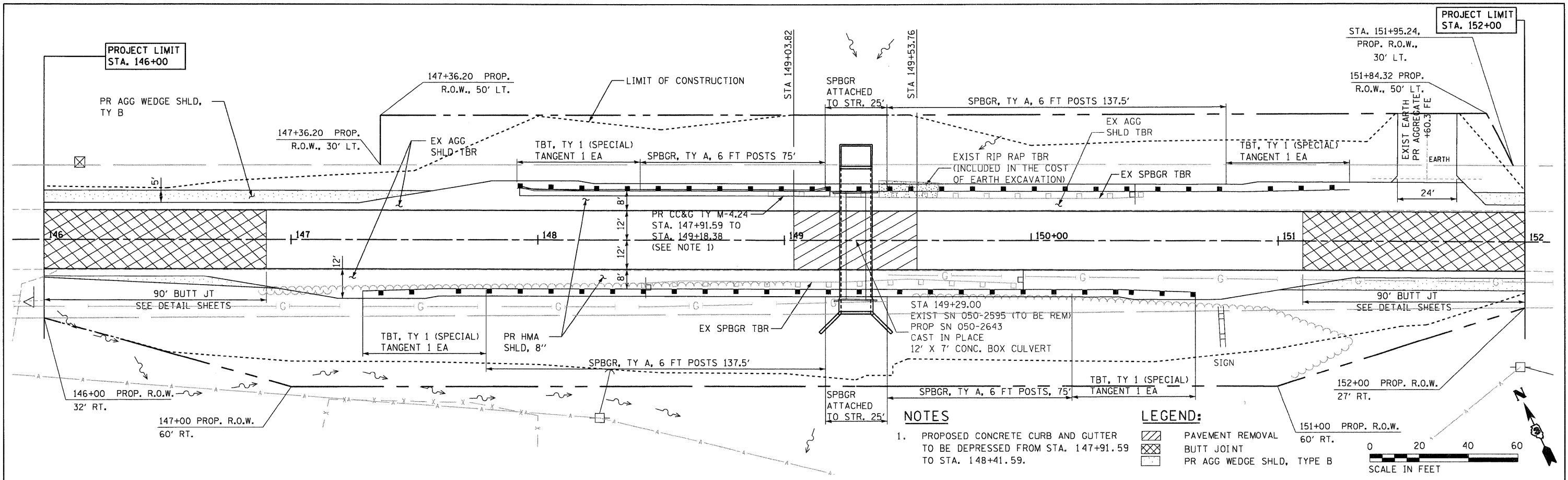

NOTES
 1. PROPOSED CONCRETE CURB AND GUTTER TO BE DEPRESSED FROM STA. 147+91.59 TO STA. 148+41.59.

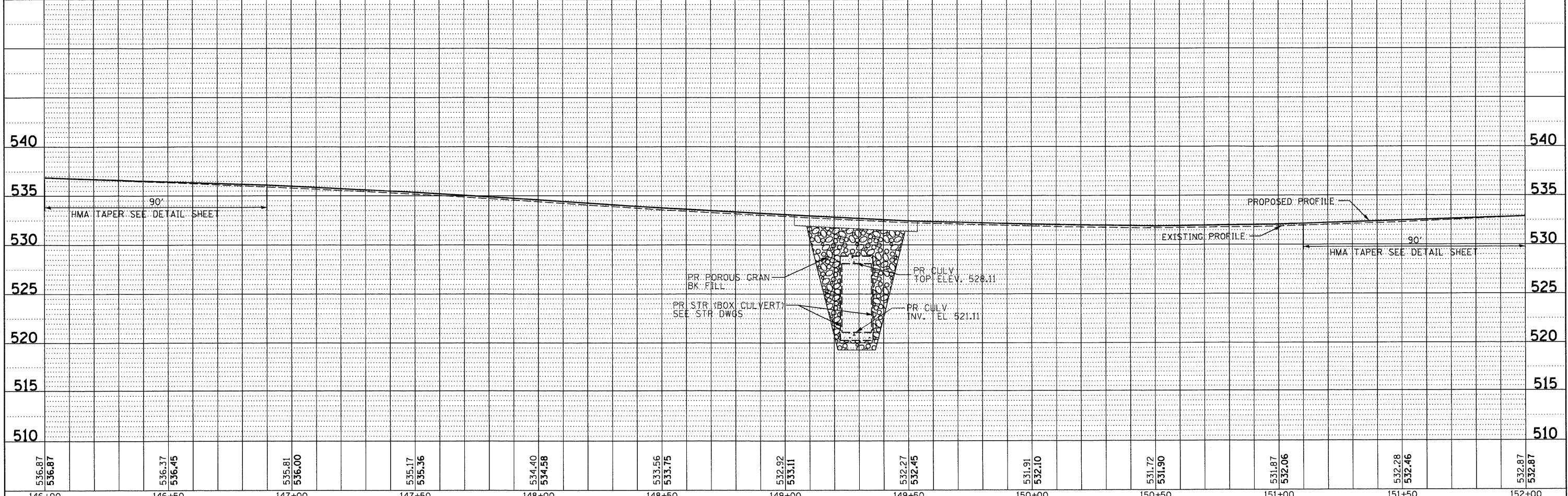
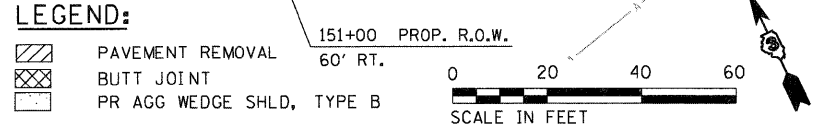

536.87	536.87	536.37	536.45	535.81	536.00	535.17	535.36	534.40	534.58	533.56	533.75	532.92	533.11	532.27	532.45	531.91	532.10	531.72	531.90	531.87	532.06	532.28	532.46	532.87	532.87
146+00	146+50	147+00	147+50	148+00	148+50	149+00	149+50	150+00	150+50	151+00	151+50	152+00													

**STATE OF ILLINOIS
 DEPARTMENT OF TRANSPORTATION**

PLAN AND PROFILE

FILE NAME =	USER NAME = #USER#	DESIGNED DB/CW	REVISED -
#FILE#		DRAWN DB/NS	REVISED -
	PLOT SCALE = #SCALE#	CHECKED AS	REVISED -
	PLOT DATE = #DATE#	DATE DECEMBER 09, 2009	REVISED -

SCALE: 1" = 20'	SHEET NO. 9 OF 25 SHEETS	STA. 146+00 TO STA. 152+00
-----------------	--------------------------	----------------------------

F.A.P. RTE. 623	SECTION (H)-1	COUNTY LASALLE	TOTAL SHEETS 25	SHEET NO. 9
CONTRACT NO. 66914				
FED. ROAD DIST. NO. [ILLINOIS] FED. AID PROJECT				