

FINAL SURVEY BY DATE  
 SURVEYED BY DATE  
 PLOTTED BY DATE  
 NOTE BOOK NO.  
 AREAS CHECKED  
 AREAS CHECKED

ORIGINAL SURVEY BY DATE  
 SURVEYED BY DATE  
 PLOTTED BY DATE  
 NOTE BOOK NO.  
 AREAS CHECKED  
 AREAS CHECKED

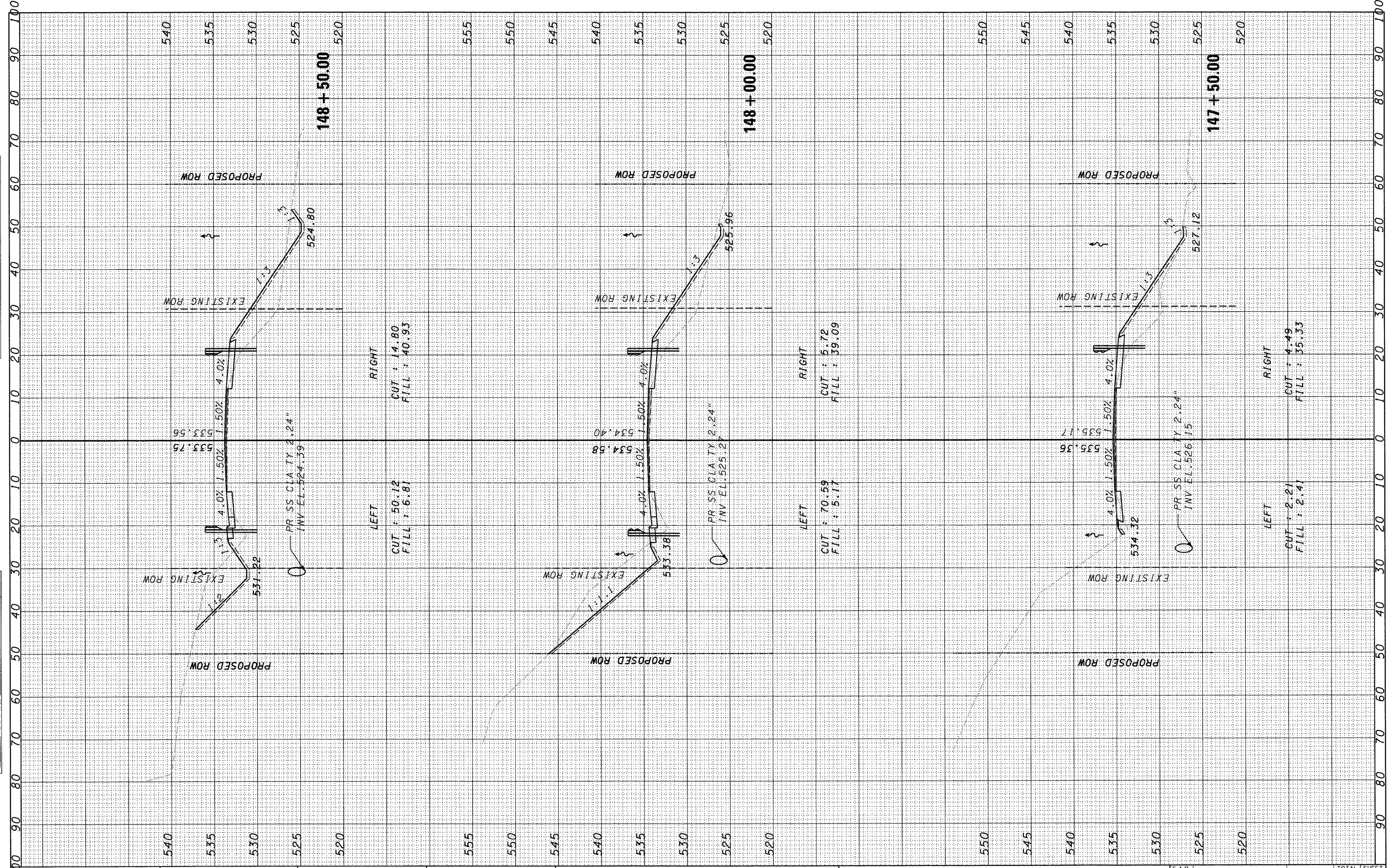

FILE NAME =  
 #FILE#

USER NAME = #USER#  
 DESIGNED - CW/DB  
 DRAWN - DB  
 CHECKED - AS  
 DATE - DECEMBER 09, 2009

REVISED -  
 REVISED -  
 REVISED -  
 REVISED -

**STATE OF ILLINOIS  
 DEPARTMENT OF TRANSPORTATION**

**CROSS SECTION**

SCALE: 1" = 20'  
 SHEET NO. 22 OF 25 SHEETS  
 STA. 147+50.00 TO STA. 148+50.00

F.A.P. RTE. 623	SECTION (HI)-1	COUNTY LASALLE	TOTAL SHEETS 25	SHEET NO. 22
FED. ROAD DIST. NO.		ILLINOIS FED. AID PROJECT		
CONTRACT NO. 66914				