

FOR INDEX OF SHEETS, SEE SHEET NO. 2

STATE OF ILLINOIS
DEPARTMENT OF TRANSPORTATION
DIVISION OF HIGHWAYS
PROPOSED HIGHWAY PLANS

FAS ROUTE 2400 (US 150)
SECTION 106RS-2; 107RS-4; 108RS-3

PAVEMENT PRESERVATION
KNOX COUNTY
C-94-060-05

F.A.S. RTE.	SECTION	COUNTY	TOTAL SHEETS	SHEET NO.
2400	106RS-2; 107RS-4; 108RS-3	KNOX	29	1
		ILLINOIS	CONTRACT NO. 68472	

D-94-054-05

HIGHWAY STANDARDS

406201-01 635006-03 701311-03
442201-03 701201-03 701336-05
482006-03 701301-03 701901-01
631006-07 701306-02 781001-03

DISTRICT CADD STANDARDS

406101 635001
440001 667101
630101 780001

PROJECT DESCRIPTION

WORK ON THIS PROJECT CONSISTS OF PATCHING, MILLING AND RESURFACING ON US 150 FROM I-74 TO THE PEORIA COUNTY LINE; INCLUDING TRAFFIC BARRIER TERMINAL REPLACEMENTS AND OTHER COLLATERAL WORK.

TRAFFIC INFORMATION

ADT = 1950 (2007)
MU = 6.67%
SU = 5.13%

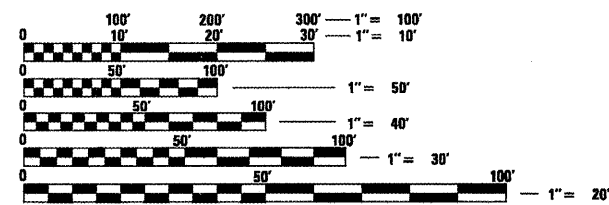

FULL SIZE PLANS HAVE BEEN PREPARED USING STANDARD ENGINEERING SCALES. REDUCED SIZED PLANS WILL NOT CONFORM TO STANDARD SCALES. IN MAKING MEASUREMENTS ON REDUCED PLANS, THE ABOVE SCALES MAY BE USED.

J.U.L.I.E.
JOINT UTILITY LOCATION INFORMATION FOR EXCAVATION
1-800-892-0123
OR 811

PROJECT ENGINEER: CHRISTOPHER MAUSHARD 309.671.3453
PROJECT MANAGER: MIKE MOHAMED 309.671.3462
CATALOG NO. 033054-00D
CONTRACT NO. 68472

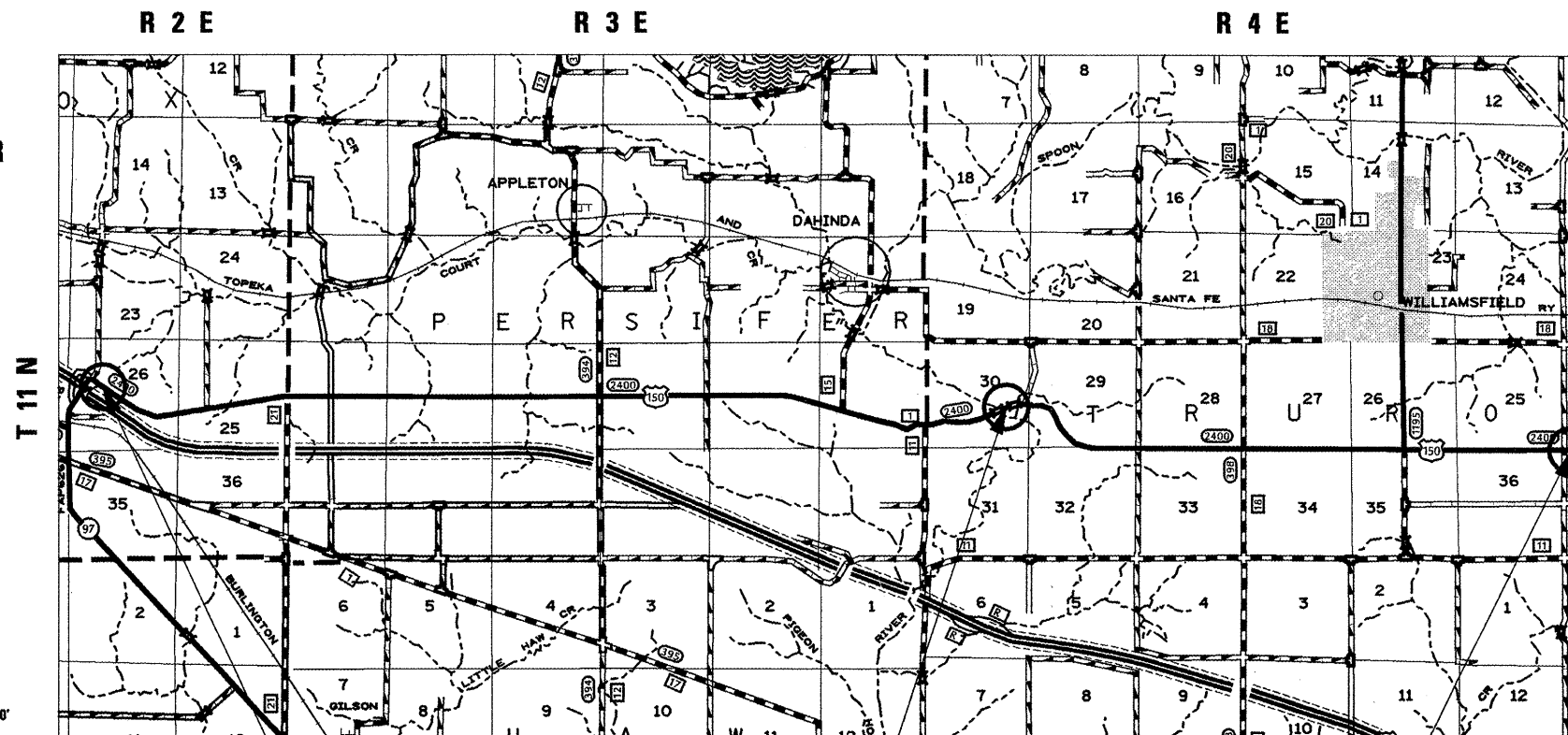

PROJECT BEGINS STA. 52+03.09

PROJECT ENDS STA. 755+19.00

OMISSION: SN 048-0031 & SN 048-0084
SEE LINE DIAGRAM FOR STATIONS
AND STATION EQUATIONS

GROSS LENGTH = 74,636.19 FT. = 14.136 MILES
NET LENGTH = 73,887.21 FT. = 13.994 MILES

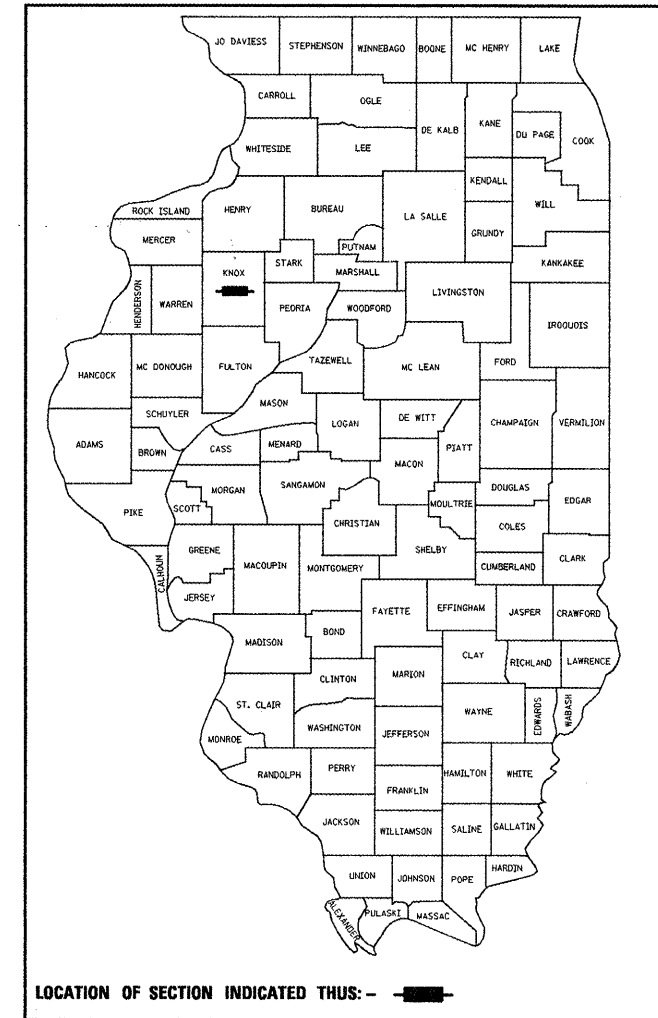

STATE OF ILLINOIS
DEPARTMENT OF TRANSPORTATION
DIVISION OF HIGHWAYS

SUBMITTED 12/16/10

[Signature]
DEPUTY DIRECTOR OF HIGHWAYS, REGION ENGINEER

January 29, 2010
[Signature]
ENGINEER OF DESIGN AND ENVIRONMENT

January 29, 2010
[Signature]
DIRECTOR OF HIGHWAYS, CHIEF ENGINEER

PRINTED BY THE AUTHORITY
OF THE STATE OF ILLINOIS