

NOTES
 Notification signs shall be posted where shown indicating maximum width ahead of 11'-0" for stage construction on IL. 117. Changeable Message Boards shall be placed facing SB traffic exiting Eureka and NB traffic exiting Goodfield one week prior to work start date for public safety and awareness.

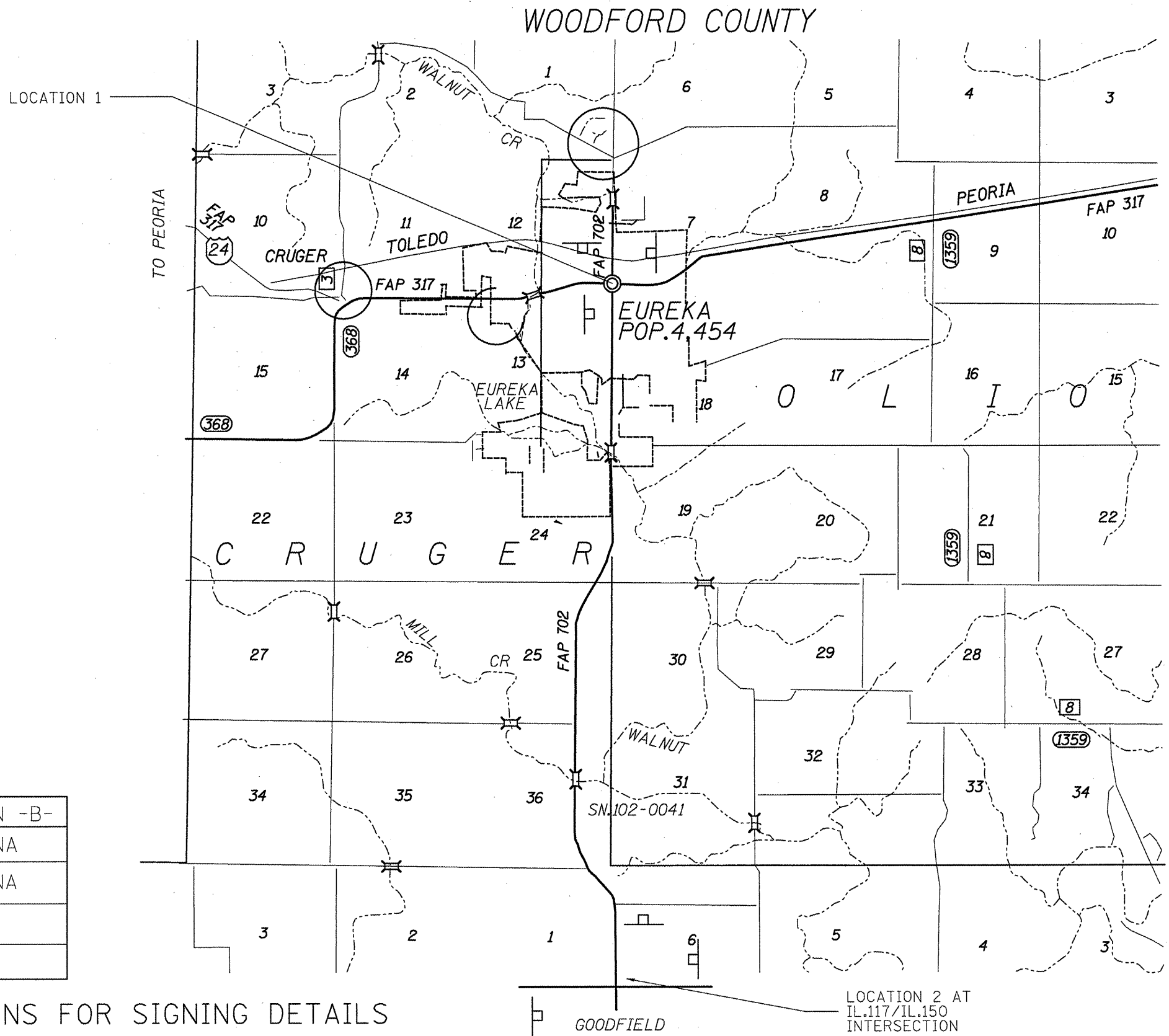

SN. 102-0041 SIGNING

	SIGN -A-	SIGN -B-
LOCATION 1	3 EA.	NA
LOCATION 2	3 EA.	NA
LOCATION 3		
LOCATION 4		

SEE SPECIAL PROVISIONS FOR SIGNING DETAILS

CONTRACTOR PROVIDED SIGN -A-

MAX. WIDTH
11'-0"
XX MILES

IL. 117

FILE NAME =	USER NAME = #USER#	DESIGNED - CEJ	REVISED -	STATE OF ILLINOIS DEPARTMENT OF TRANSPORTATION	WIDTH RESTRICTION SIGNING			F.A.P. RTE.	SECTION	COUNTY	TOTAL SHEETS	SHEET NO.	
#FILE#		DRAWN - CEJ	REVISED -		SCALE:	SHEET NO. OF SHEETS	STA.	TO STA.	702	(114BR-11)	WOODFORD	23	7
		CHECKED -	REVISED -						MISC. BRIDGE REPAIRS				
		DATE - 08/04/2009	REVISED -						FED. ROAD DIST. NO. 4	ILLINOIS	FED. AID PROJECT		

SN. 102-0041 IL.117 ovr
MILL CR. S. of US24

CONTRACT NO. 68928