

- HMA SURF REM BUTT JOINT (SEE DESIGN DETAILS)
- MILLING TRANS 3/4" - 5" (SEE DESIGN DETAILS)

STATION EQUATION:
 C.T.R. 126 STATION 116+83.10 =
 TANGENT STATION 18+00.00 C.H. 16

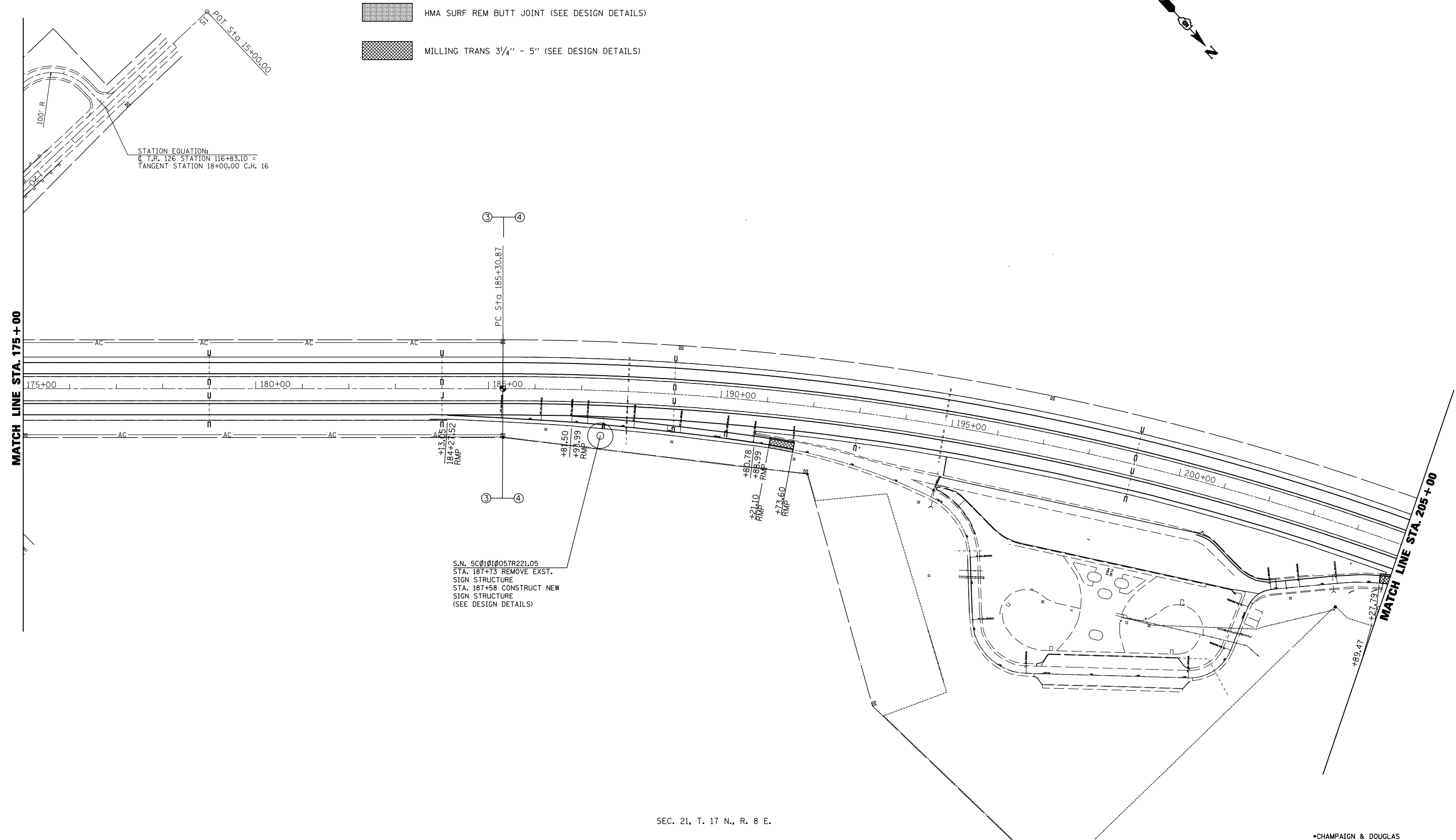

S.N. 5C01010057R221.05
 STA. 187+73 REMOVE EXST.
 SIGN STRUCTURE
 STA. 187+58 CONSTRUCT NEW
 SIGN STRUCTURE
 (SEE DESIGN DETAILS)

FILE NAME =	USER NAME = shererjm	DESIGNED - JMS	REVISED -
ct:\pw\work\PWIDOT\SHERERJM\d0134546\d570251-shr-plan_100.dgn		DRAWN - JMS	REVISED -
	PLOT SCALE = 200.0000' / IN.	CHECKED -	REVISED -
	PLOT DATE = 12/15/2009	DATE - 110309	REVISED -

**STATE OF ILLINOIS
 DEPARTMENT OF TRANSPORTATION**

PLAN VIEW
 SCALE: 1" = 100' SHEET NO. 17 OF 22 SHEETS STA. 175+00.00 TO STA. 205+00.00

F.A.I. RTE.	SECTION	COUNTY	TOTAL SHEETS	SHEET NO.
57	(21-28,21-10-29,10-30)RS-1	*	115	61
CONTRACT NO. 70251			ILLINOIS FED. AID PROJECT	