

STATE OF ILLINOIS
DEPARTMENT OF TRANSPORTATION
DIVISION OF HIGHWAYS

**PROPOSED
HIGHWAY PLANS**

F.A.S. ROUTE 2466 (US 150)
SECTION (9,10,11)RS-3

MCLEAN COUNTY

C-95-044-06

COLD MILLING RESURFACING (3P)
WOODFORD CO. LINE TO N OF I-74 AT BLOOMINGTON

F.A.S. RTE.	SECTION	COUNTY	TOTAL SHEETS	SHEET NO.
2466	19,10,11RS-3	McLean	47	1
ILLINOIS CONTRACT NO. 70523				

D-95-043-06

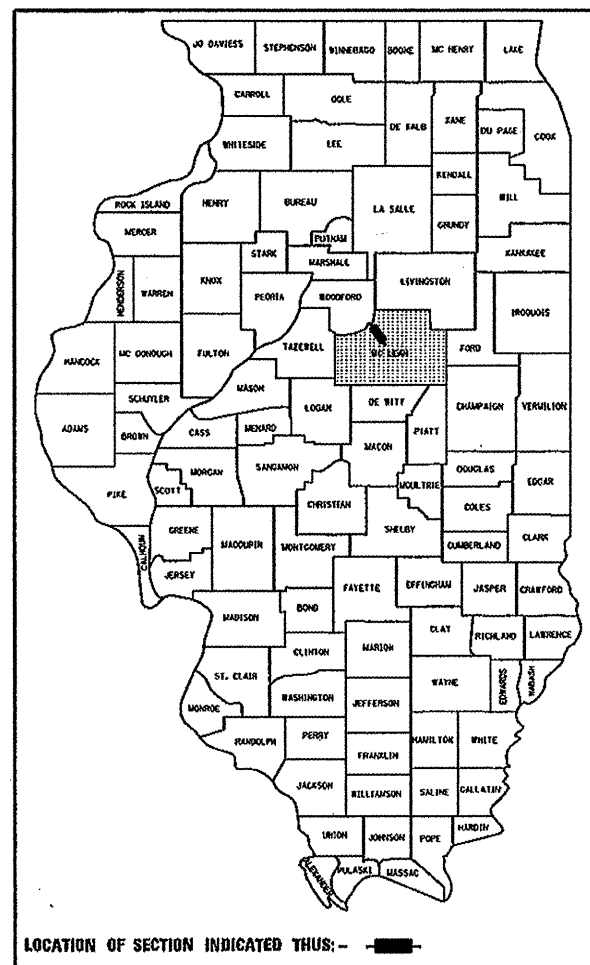

LOCATION OF SECTION INDICATED THUS: - ■ -

FOR INDEX OF SHEETS, SEE SHEET NO. 2
FOR SUMMARY OF QUANTITIES, SEE SHEET NO. 3

STRUCTURE INFORMATION

SN	SCOPE OF WORK
057-2035	ALL STRUCTURES
057-2036	RECEIVE 2 1/4" HMA INLAY
057-8046	
057-8047	
057-8048	
057-8049	
057-8300	

CURRENT ADT:
4300 (2009)

DESIGN DESIGNATION
RURAL MAJOR COLLECTOR

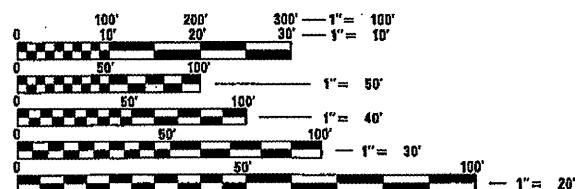

FULL SIZE PLANS HAVE BEEN PREPARED USING STANDARD ENGINEERING SCALES. REDUCED SIZED PLANS WILL NOT CONFORM TO STANDARD SCALES. IN MAKING MEASUREMENTS ON REDUCED PLANS, THE ABOVE SCALES MAY BE USED.

J.U.L.I.E.
JOINT UTILITY LOCATION INFORMATION FOR EXCAVATION
1-800-892-0123 WHITE OAK TOWNSHIP
OR 811 DRY GROVE TOWNSHIP

PROJECT ENGINEER: KEVIN TRAPP
PROJECT MANAGER: RUSTIN KEYS
DESIGNER: MATTHEW MURPHY

CONTRACT NO. 70523

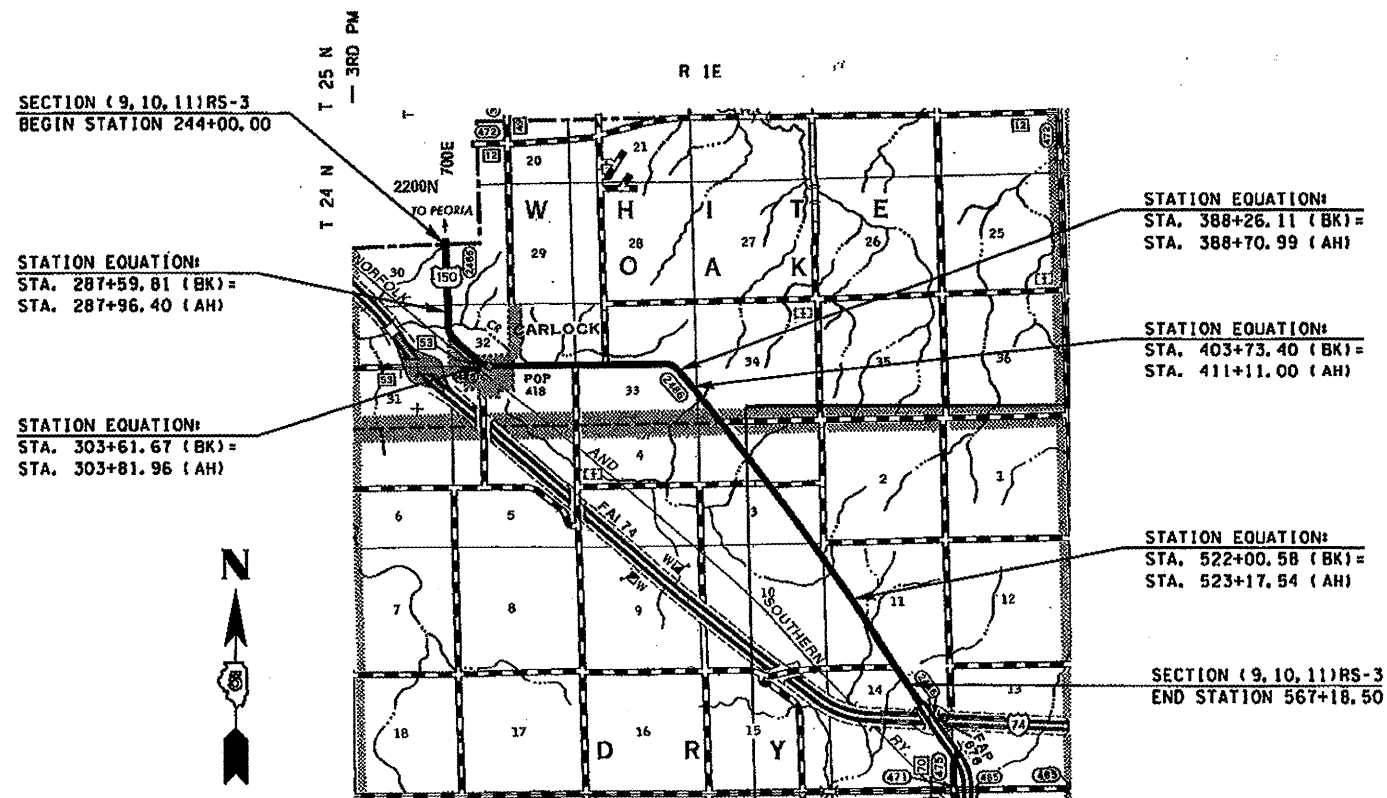

GROSS & NET LENGTH = 31,362.18 FT. = 5.940 MILES

STATE OF ILLINOIS
DEPARTMENT OF TRANSPORTATION
DIVISION OF HIGHWAYS

SUBMITTED 12/4 20 09

Walter E. O'Connell
DEPUTY DIRECTOR OF HIGHWAYS, REGION ENGINEER

Scott E. Stolt, P.E.
ENGINEER OF DESIGN AND ENVIRONMENT

Christine M. Reed
DIRECTOR OF HIGHWAYS, CHIEF ENGINEER

PRINTED BY THE AUTHORITY
OF THE STATE OF ILLINOIS