

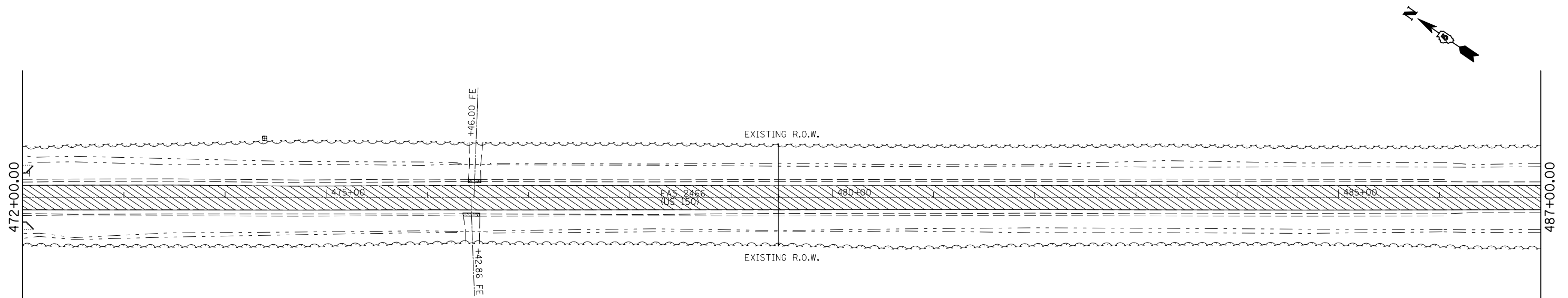

EXIST. CURVE 33
 PI STA. = 465+87.30
 Δ = 3° 19' 38" (RT)
 D = 0° 27' 40"
 R = 12,424.01'
 T = 360.84'
 L = 721.48'
 E = 5.24'
 e = -----
 T.R. = -----
 S.E. RUN = -----
 P.C. STA. = 462+26.46
 P.T. STA. = 469+47.93

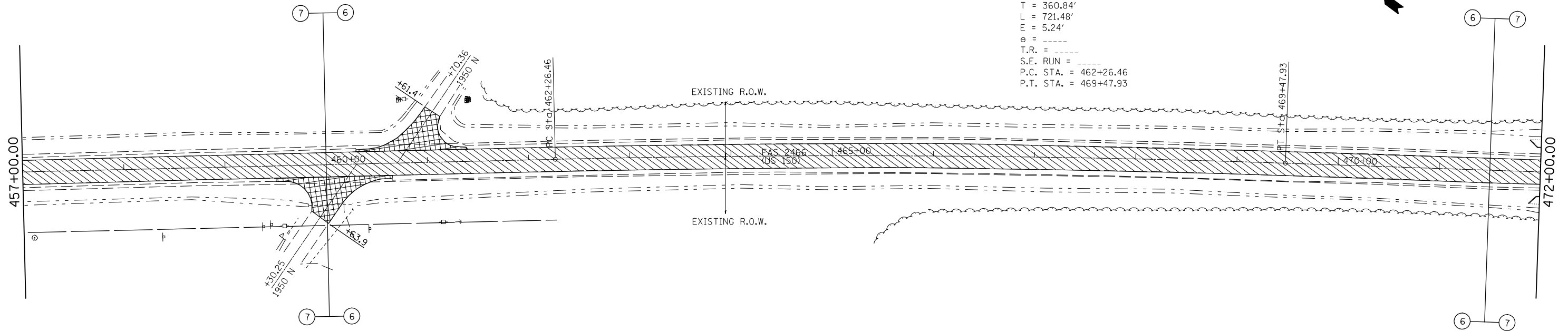

-  HMA SURFACE REMOVAL, 1 1/2"
-  HMA SURFACE REMOVAL, 2 1/4"
-  HMA SURFACE REMOVAL, BUTT JOINT
-  AGGREGATE SHOULDER STONE

FILE NAME =	USER NAME = bowerml	DESIGNED -	REVISED -
et:\pw\work\PWIDOT\BOWERML\d0115438\057023-sht-dblplan-50scale.dgn		DRAWN -	REVISED -
PLOT SCALE = 100.0000' / IN.		CHECKED -	REVISED -
PLOT DATE = 12/4/2009		DATE -	REVISED -

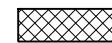
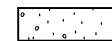
**STATE OF ILLINOIS
 DEPARTMENT OF TRANSPORTATION**

US 150 Plan Sheet

SCALE: 100' = 1" SHEET NO. OF SHEETS STA. TO STA.

F.A.S. RTE.	SECTION	COUNTY	TOTAL SHEETS	SHEET NO.
2466	(9,10,11)RS-3	McLean	47	30
CONTRACT NO. 70523			ILLINOIS FED. AID PROJECT	