

Match Line Sta. 56+00.00

Match Line Sta. 71+00.00

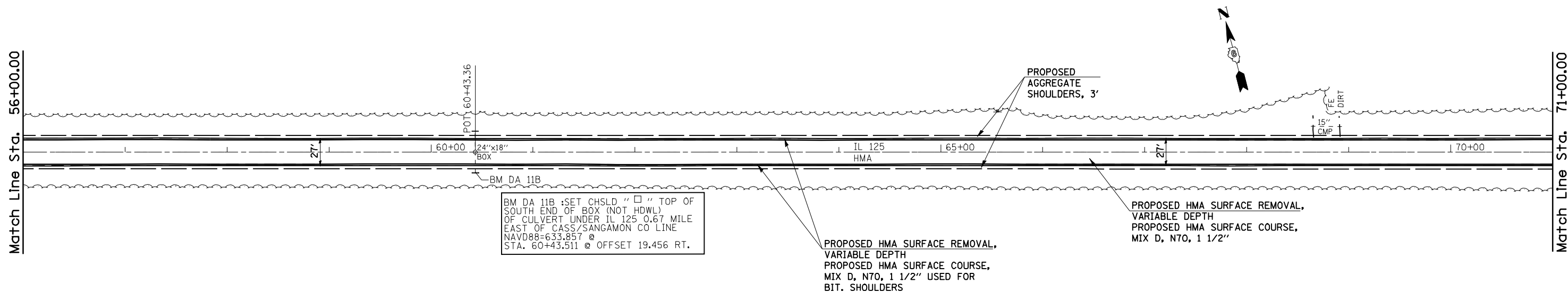

BM DA 11B :SET CHSLD " □ " TOP OF SOUTH END OF BOX (NOT HDWL) OF CULVERT UNDER IL 125 0.67 MILE EAST OF CASS/SANGAMON CO LINE NAVD88=633.857 @ STA. 60+43.511 @ OFFSET 19.456 RT.

PROPOSED HMA SURFACE REMOVAL, VARIABLE DEPTH PROPOSED HMA SURFACE COURSE, MIX D, N70, 1 1/2" USED FOR BIT. SHOULDERS

PROPOSED HMA SURFACE REMOVAL, VARIABLE DEPTH PROPOSED HMA SURFACE COURSE, MIX D, N70, 1 1/2"

Match Line Sta. 71+00.00

Match Line Sta. 86+00.00

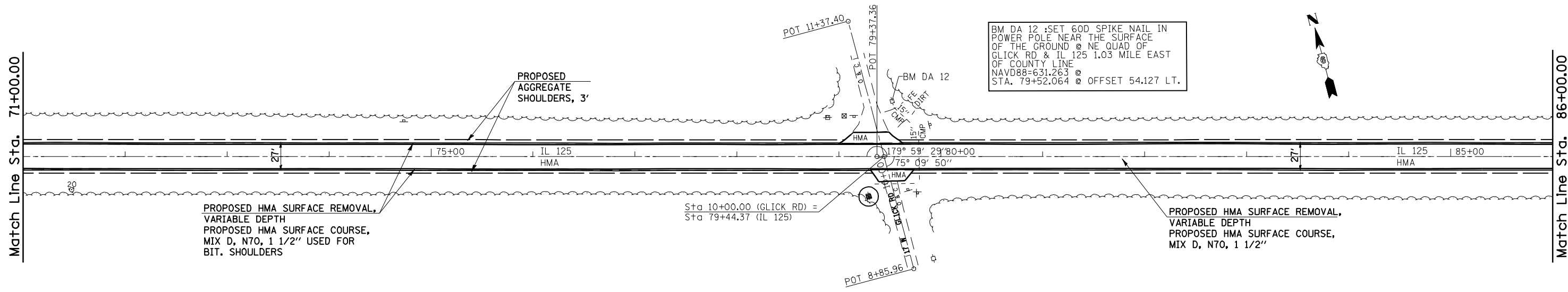

BM DA 12 :SET 60D SPIKE NAIL IN POWER POLE NEAR THE SURFACE OF THE GROUND @ NE QUAD OF GLICK RD & IL 125 1.03 MILE EAST OF COUNTY LINE NAVD88=631.263 @ STA. 79+52.064 @ OFFSET 54.127 LT.

PROPOSED HMA SURFACE REMOVAL, VARIABLE DEPTH PROPOSED HMA SURFACE COURSE, MIX D, N70, 1 1/2" USED FOR BIT. SHOULDERS

Sta 10+00.00 (GLICK RD) = Sta 79+44.37 (IL 125)

PROPOSED HMA SURFACE REMOVAL, VARIABLE DEPTH PROPOSED HMA SURFACE COURSE, MIX D, N70, 1 1/2"

\* CASS, SANGAMON

FILE NAME =	USER NAME = coxte	DESIGNED -	REVISED -
es:\pwwork\pwwid\COXTE\dmab4394\d672c99-shr-plen-DBL50.dgn		DRAWN - RTS	REVISED -
PLOT SCALE = 100.0000' / IN.		CHECKED -	REVISED -
PLOT DATE = Dec-18-2009 04:48:23PM		DATE - 11-09-09	REVISED -

**STATE OF ILLINOIS  
DEPARTMENT OF TRANSPORTATION**

**PLAN SHEETS - 50 SCALE**  
SCALE: 50 SHEET NO. 3 OF SHEETS STA. 56+00 TO STA. 86+00

F.A.P. RTE.	SECTION	COUNTY	TOTAL SHEETS	SHEET NO.
67	105(RS-6) 106(RS-4)	*	88	22
CONTRACT NO. 72C49				
FED. ROAD DIST. NO. ILLINOIS FED. AID PROJECT				