

LEGEND

ALL STA./OFFSETS ARE OFF OF FAP 67 (IL 125) ALIGNMENT

- (I1) 161+16.76, 24.00' LT (I10) 161+37.52, 30.20' LT
- (I2) 161+16.76, 28.00' LT (I11) 161+34.74, 26.58' LT
- (I3) 161+32.69, 42.88' LT (PM1) 160+77.78, 18.00' LT
- (I4) 161+36.55, 43.91' LT (PM2) 161+33.35, 79.31' LT
- (I5) 161+41.84, 24.00' LT (PM3) 161+49.65, 18.00' LT
- (I6) 161+20.42, 26.58' LT (R1) 161+20.42, 28.00' LT
- (I7) 161+19.46, 29.04' LT (R2) 161+33.41, 40.14' LT
- (I8) 161+31.83, 40.59' LT (R3) 161+35.34, 29.00' LT
- (I9) 161+35.00, 39.68' LT

2CC:
85' - 500'
Ø = 9.0'

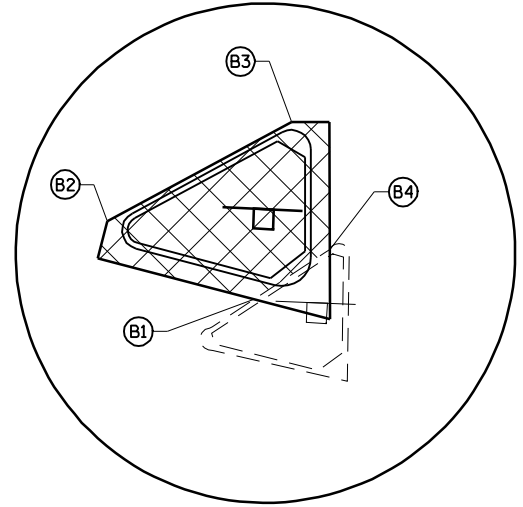
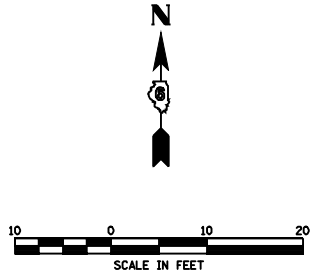

BITUMINOUS PAVEMENT REMOVAL

- (B1) 161+32.88, 24.00' LT (B4) 161+39.77, 31.81' LT
 - (B2) 161+16.76, 28.00' LT
 - (B3) 161+32.69, 42.88' LT
- BITUMINOUS REMOVAL
(274.82 SQ FT)

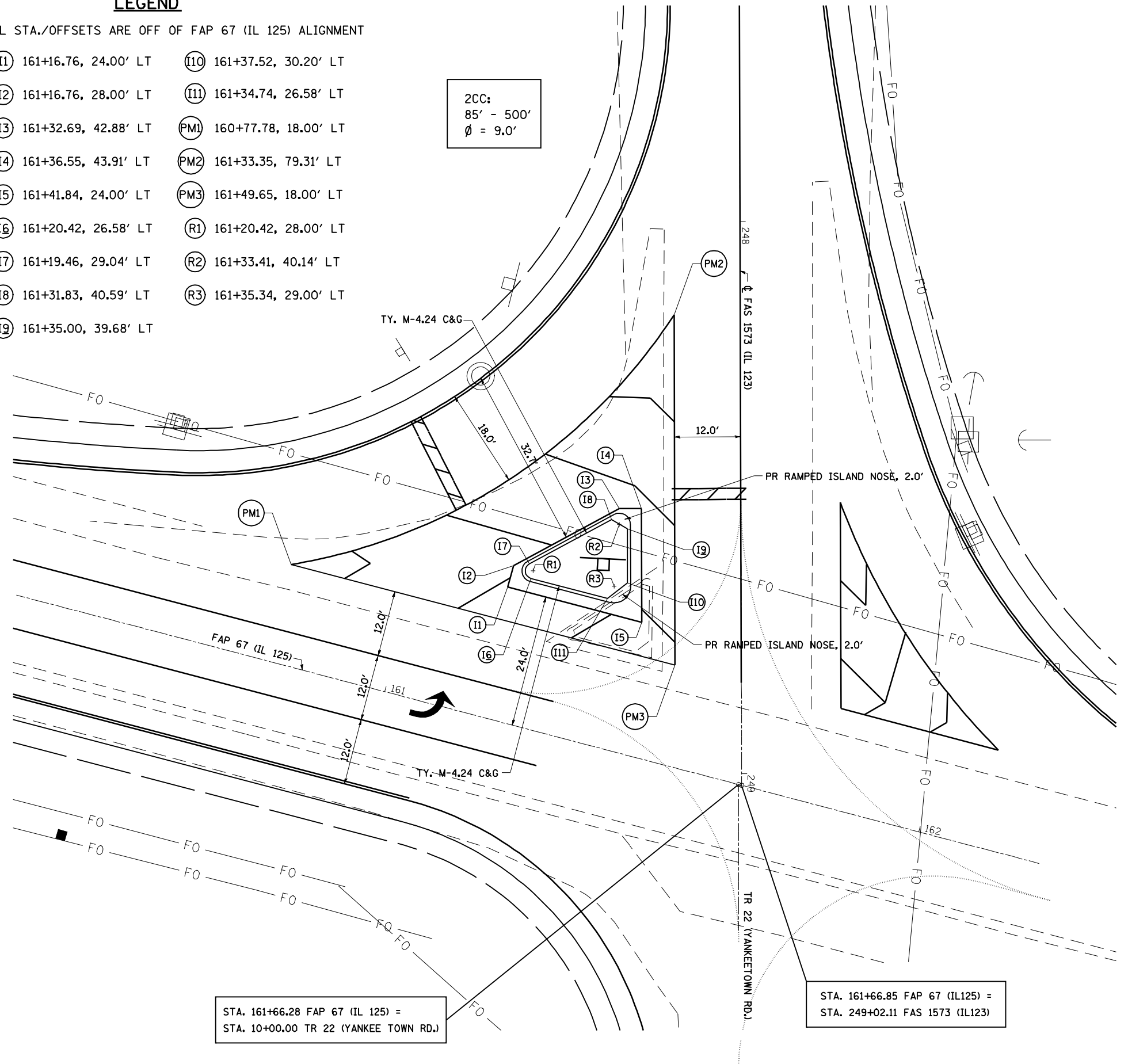

STA. 161+66.28 FAP 67 (IL 125) =
STA. 10+00.00 TR 22 (YANKEE TOWN RD.)

STA. 161+66.85 FAP 67 (IL125) =
STA. 249+02.11 FAS 1573 (IL123)

FILE NAME =	USER NAME = coxte	DESIGNED -	REVISED -	STATE OF ILLINOIS DEPARTMENT OF TRANSPORTATION	ISLAND DETAIL FAP 67 (IL 125) & FAS 1573 (IL 123)			F.A.P. RTE.	SECTION	COUNTY	TOTAL SHEETS	SHEET NO.
et:\pwork\PWIDOT\COXTE\dms22819\067209-ah1s1\nddetail.dgn		DRAWN -	REVISED -		67	105(RS-6) 106(RS-4)	*	88	51			
PLOT SCALE = 20.0000' / IN.		CHECKED -	REVISED -		CONTRACT NO. 72C49			ILLINOIS FED. AID PROJECT				
PLOT DATE = Dec-18-2009 04:49:39PM		DATE -	REVISED -		SCALE: 1" = 10'	SHEET NO.	OF SHEETS	STA.	TO STA.			