

F.A.P. RTE.	SECTION	COUNTY	TOTAL SHEETS	SHEET NO.
828	(106, 107)RS-2	CLAY	9	1
		ILLINOIS	CONTRACT NO. 74371	

STATE OF ILLINOIS  
DEPARTMENT OF TRANSPORTATION  
DIVISION OF HIGHWAYS

# PROPOSED HIGHWAY PLANS

FAP ROUTE 828  
SECTION (106, 107)RS-2

HMA RESURFACING  
CLAY COUNTY

C-97-056-09

FOR INDEX OF SHEETS, SEE SHEET NO. 2

D-97-027-09

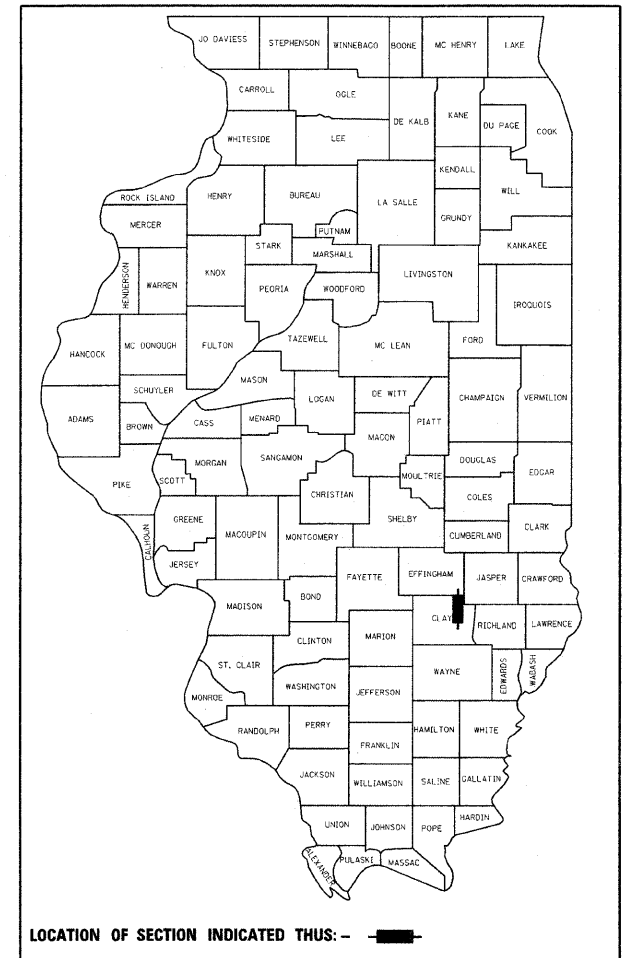

**BRIDGE OMISSIONS**

- 1236 + 70 TO 1238 + 11
- 1247 + 37 TO 1248 + 88
- 1296 + 07 TO 1300 + 27
- 1337 + 64 TO 1345 + 14

2008 ADT = 1200

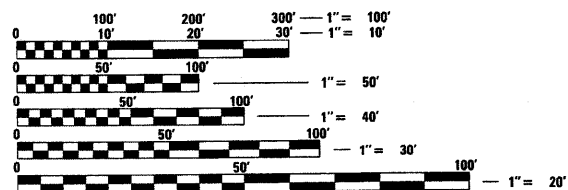

FULL SIZE PLANS HAVE BEEN PREPARED USING STANDARD ENGINEERING SCALES. REDUCED SIZED PLANS WILL NOT CONFORM TO STANDARD SCALES. IN MAKING MEASUREMENTS ON REDUCED PLANS, THE ABOVE SCALES MAY BE USED.

J.U.L.I.E.  
JOINT UTILITY LOCATION INFORMATION FOR EXCAVATION  
1-800-892-0123  
OR 811

PROJECT ENGINEER: MARK DAUGHERTY  
PROJECT MANAGER: SOLOMON DZAKUMA

CONTRACT NO. 74371

BEGIN PROJECT  
STA 707+50

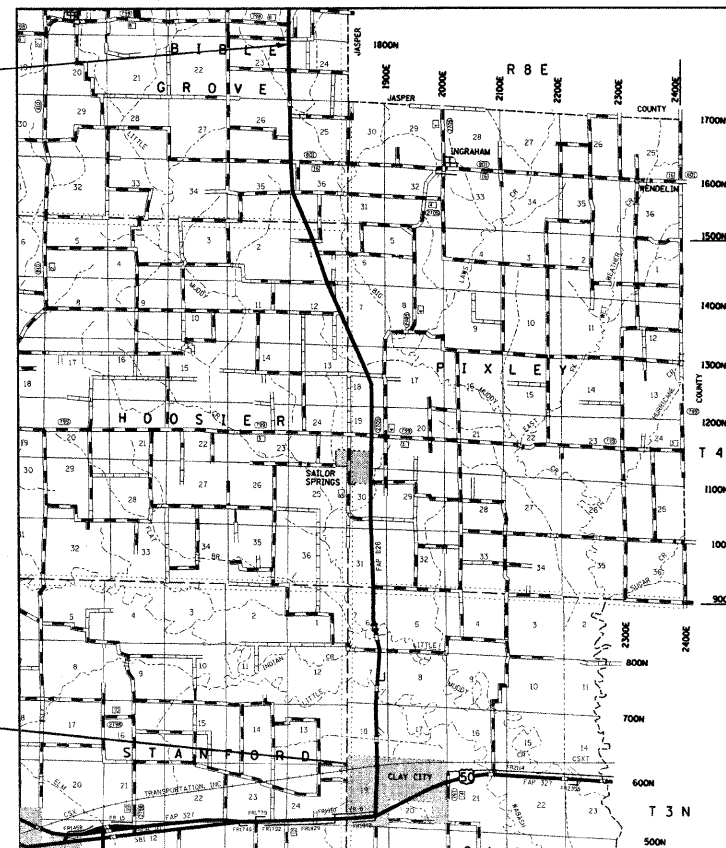

END PROJECT  
STA 1365+05

GROSS LENGTH = 65,755 FT. = 12.454 MILE  
NET LENGTH = 64,293 FT. = 12.177 MILE

STATE OF ILLINOIS  
DEPARTMENT OF TRANSPORTATION  
DIVISION OF HIGHWAYS

SUBMITTED December 7, 2009

*Raymond L. Viskochil*  
DEPUTY DIRECTOR OF HIGHWAYS, REGION ENGINEER

January 29, 2010  
*Scott E. Still, P.E.*  
ENGINEER OF DESIGN AND ENVIRONMENT

January 29, 2010  
*Christine M. Reed*  
DIRECTOR OF HIGHWAYS, CHIEF ENGINEER

PRINTED BY THE AUTHORITY  
OF THE STATE OF ILLINOIS

GENERAL NOTES

THIS SECTION SHALL BE CONSTRUCTED IN ACCORDANCE WITH THE PLANS; THE "STANDARD SPECIFICATIONS FOR ROAD AND BRIDGE CONSTRUCTION", ADOPTED JANUARY 1, 2007; THE "SUPPLEMENTAL SPECIFICATIONS AND RECURRING SPECIAL PROVISIONS", ADOPTED JANUARY 1, 2010, AND THE SPECIAL PROVISIONS INCLUDED IN THIS PROPOSAL.

THE WORK INCLUDED IN THIS SECTION CONSISTS OF MILLING AND OVERLAYING THE EXISTING PAVEMENT WITH HOT-MIX ASPHALT, AND PLACEMENT OF AGGREGATE SHOULDERS. THE WORK ALSO INCLUDES PATCHING AND PAVEMENT MARKING AND ANY OTHER WORK NECESSARY TO COMPLETE THE SECTION. THE SECTION STARTS JUST SOUTH OF BIBLE GROVE ROAD AND ENDS AT THE NORTH CORPORATE LIMITS OF CLAY CITY ON THE DIETERICH-CLAY CITY BLACKTOP IN CLAY COUNTY.

THE ROADWAY CENTERLINE IN THE VICINITY OF THE PROPOSED WIDENING DEVIATES FROM THE SURVEY CENTERLINE FOR A DISTANCE OF 400 FEET. THE CENTERLINE JOINT IN THE PROPOSED OVERLAY SHALL FOLLOW THE SURVEYED CENTERLINE WHICH IS DELINEATED BY NAILS AT 25 FOOT SPACES.

PAVEMENT MARKING SHALL BE APPLIED IN ACCORDANCE WITH SECTION 780 OF THE STANDARD SPECIFICATIONS. SHORT TERM PAVEMENT MARKING SHALL BE APPLIED TO THE MILLED SURFACE, BITUMINOUS MATERIALS (PRIME COAT), AND HOT-MIX ASPHALT LEVEL BINDER, HOT-MIX ASPHALT SURFACE COURSE AS SPECIFIED IN SECTION 703 OF THE STANDARD SPECIFICATIONS. TEMPORARY TAPE SHALL BE USED ON THE SURFACE COURSE AND PAINT SHALL BE USED ON MILLED SURFACES.

THE TOTAL QUANTITY OF PAINT PAVEMENT MARKING - LINE 4" CONSISTS OF 22,558 FEET OF YELLOW AND 131,510 FEET OF WHITE.

THE CONTRACTOR SHALL PROVIDE INTERNET ACCESS TO THE HOT-MIX ASPHALT PLANT QUALITY CONTROL LAB SO THAT HOT-MIX ASPHALT PLANT REPORTS CAN BE E-MAILED TO THE DISTRICT HEADQUARTERS. THIS WORK SHALL BE INCLUDED IN THE COST OF ALL HOT-MIX ASPHALT ITEMS.

BASE COURSE WIDENING SHALL INCLUDE ALL EXCAVATION FOR CONSTRUCTION OF THE WIDENING.

THE CONTRACTOR SHALL USE EITHER RC-70 OR AN EMULSIFIED POLYMER PRIME SS-1HP FOR THE PAY ITEM BITUMINOUS MATERIALS (PRIME COAT).

AGGREGATE FOR AGGREGATE SHOULDERS SHALL BE CRUSHED STONE, CRUSHED CONCRETE OR RAP.

THE PAY ITEM TEMPORARY RAMP HAS BEEN INCLUDED FOR THE CONSTRUCTION OF TEMPORARY RAMPS IN ACCORDANCE WITH ARTICLE 406.08 OF THE STANDARD SPECIFICATIONS. THE CONTRACT UNIT PRICE PER SQUARE YARD FOR TEMPORARY RAMP SHALL INCLUDE BOTH THE INSTALLATION AND THE REMOVAL OF THE RAMPS.

THE FOLLOWING RATES OF APPLICATION HAVE BEEN USED IN CALCULATING PLAN QUANTITIES:

HOT MIX ASPHALT	112 LBS/SQ YD/IN
BITUMINOUS MATERIALS PRIME COAT	0.10 GALLONS/SQ YD
AGGREGATE PRIME COAT	2.00 LBS/SQ YD
GRANULAR MATERIAL	2.05 TONS/CU YD

THE FOLLOWING MIXTURE REQUIREMENTS ARE APPLICABLE TO THIS PROJECT:

APPLICATION	AC/PG	DESIGN AIR VOIDS	MIXTURE COMPOSITION	FRICTION AGGREGATE
LEVELING BINDER	PG 64-22	4.0% @ N=70	IL - 9.5	N/A
SURFACE COURSE	PG 64-22	4.0% @ N=70	IL - 9.5	MIXTURE C
INCIDENTAL SURFACE	PG 64-22	4.0% @ N=50	IL - 9.5	MIXTURE C
PAVEMENT PATCHING	PG 64-22	4.0% @ N=70	IL - 19.0	N/A

INDEX OF SHEETS

1	COVER SHEET
2	INDEX OF SHEETS & GENERAL NOTES
3	SUMMARY OF QUANTITIES
4	TYPICAL SECTIONS
5	SURVEY TIES
6	SCHEDULE OF QUANTITIES & DETAILS
7-8	ENTRANCE SCHEDULE & DETAILS
9	LOCATION MAP

THE FOLLOWING STANDARDS ARE A PART OF THESE PLANS AND ARE INCLUDED AFTER SHEET NO. 9:

STD. NO.	DESCRIPTION
406201-01	MAILBOX TURNOUT
442201-03	CLASS C AND D PATCHES
701006-03	OFF-RD OPERATIONS, 2L, 2W, 15' TO 24" FROM PAVEMENT EDGE
701011-02	OFF-RD MOVING OPERATIONS, 2L, 2W, DAY ONLY
701201-03	LANE CLOSURE, 2L, 2W, DAY ONLY, FOR SPEEDS >= 45
701301-03	LANE CLOSURE, 2L, 2W, SHORT TIME OPERATIONS
701306-02	LANE CLOSURE, 2L, 2W, SLOW MOVING OPERATIONS DAY ONLY, FOR SPEEDS >= 45 MPH
701311-03	LANE CLOSURE 2L, 2W, MOVING OPERATIONS - DAY ONLY
701336-05	LANE CLOSURE, 2L, 2W, WORK AREAS IN SERIES, FOR SPEEDS >= 45
701901-01	TRAFFIC CONTROL DEVICES
780001-02	TYPICAL PAVEMENT MARKINGS
781001-03	TYPICAL APPLICATIONS RAISED REFLECTIVE PAVEMENT MARKERS

FILE NAME =	USER NAME = teasleyck	DESIGNED -	REVISED -	<b>STATE OF ILLINOIS DEPARTMENT OF TRANSPORTATION</b>	<b>GENERAL NOTES &amp; INDEX OF SHEETS</b>				F.A.P. RTE.	SECTION	COUNTY	TOTAL SHEETS	SHEET NO.
es:\pwork\pwidth\teasleyck\0123186\077	371-sht-gennotedgn	DRAWN -	REVISED -		828	(106,107)RS-2	Clay	9	2				
	PLOT SCALE = 50,0000 ' / IN.	CHECKED -	REVISED -		CONTRACT NO. 74371								
	PLOT DATE = 12/2/2009	DATE -	REVISED -		SCALE:	SHEET NO.	OF SHEETS	STA.	TO STA.	ILLINOIS FED. AID PROJECT			

SUMMARY OF QUANTITIES			100% STATE	CONSTRUCTION TYPE CODE	
CODE NO	ITEM	UNIT	TOTAL QUANTITIES	1000	-----
35600716	HOT-MIX ASPHALT BASE COURSE WIDENING, 10"	SQ YD	67	67	
40200800	AGGREGATE SURFACE COURSE, TYPE B	TON	283	283	
40600100	BITUMINOUS MATERIALS (PRIME COAT)	GALLON	15716	15716	
40600300	AGGREGATE (PRIME COAT)	TON	314	314	
40600635	LEVELING BINDER (MACHINE METHOD), N70	TON	6537	6537	
40600895	CONSTRUCTING TEST STRIP	EACH	1	1	
40600982	HOT-MIX ASPHALT SURFACE REMOVAL - BUTT JOINT	SQ YD	990	990	
40600990	TEMPORARY RAMP	SQ YD	122	122	
40603315	HOT-MIX ASPHALT SURFACE COURSE, MIX "C", N70	TON	13201	13201	
40800050	INCIDENTAL HOT-MIX ASPHALT SURFACING	TON	153	153	
44000151	HOT-MIX ASPHALT SURFACE REMOVAL, 1/2"	SQ YD	154457	154457	
44000155	HOT-MIX ASPHALT SURFACE REMOVAL, 1 1/2"	SQ YD	1518	1518	
44000198	HOT-MIX ASPHALT SURFACE REMOVAL, VARIABLE DEPTH	SQ YD	196	196	
44201803	CLASS D PATCHES, TYPE II, 13 INCH	SQ YD	87	87	
44201807	CLASS D PATCHES, TYPE III, 13 INCH	SQ YD	64	64	
44201809	CLASS D PATCHES, TYPE IV, 13 INCH	SQ YD	77	77	
48101200	AGGREGATE SHOULDERS, TYPE B	TON	14500	14500	
63200310	GUARDRAIL REMOVAL	FOOT	102	102	
66700205	PERMANENT SURVEY MARKERS, TYPE I	EACH	4	4	
67000500	ENGINEER'S FIELD OFFICE, TYPE B	CAL MO	4	4	
67100100	MOBILIZATION	L SUM	1	1	
70100450	TRAFFIC CONTROL AND PROTECTION, STANDARD 701201	L SUM	1	1	
70100460	TRAFFIC CONTROL AND PROTECTION, STANDARD 701306	L SUM	1	1	
70100600	TRAFFIC CONTROL AND PROTECTION, STANDARD 701336	L SUM	1	1	
70300100	SHORT-TERM PAVEMENT MARKING	FOOT	19284	19284	
70300220	TEMPORARY PAVEMENT MARKING - LINE 4"	FOOT	154068	154068	
70301000	WORK ZONE PAVEMENT MARKING REMOVAL	SQ FT	2143	2143	
* 78001110	PAINT PAVEMENT MARKING - LINE 4"	FOOT	154068	154068	
* 78100100	RAISED REFLECTIVE PAVEMENT MARKER	EACH	805	805	

\*Specialty Items

FILE NAME =	USER NAME = teasleyck	DESIGNED -	REVISED -	<b>STATE OF ILLINOIS DEPARTMENT OF TRANSPORTATION</b>	<b>SUMMARY OF QUANTITIES</b>	F.A.P. RTE.	SECTION	COUNTY	TOTAL SHEETS	SHEET NO.	
c:\p\work\PIWIDOT\TEASLEYCK\02123166\074371-shr-soq.dgn		DRAWN -	REVISED -			828	(106,107)RS-2	CLAY	9	3	
PLOT SCALE = 50,0000 "/ IN.		CHECKED -	REVISED -			CONTRACT NO. 74371					
PLOT DATE = 12/2/2009		DATE -	REVISED -			ILLINOIS FED. AID PROJECT					
					SCALE:	SHEET NO. OF SHEETS STA.		TO STA.			

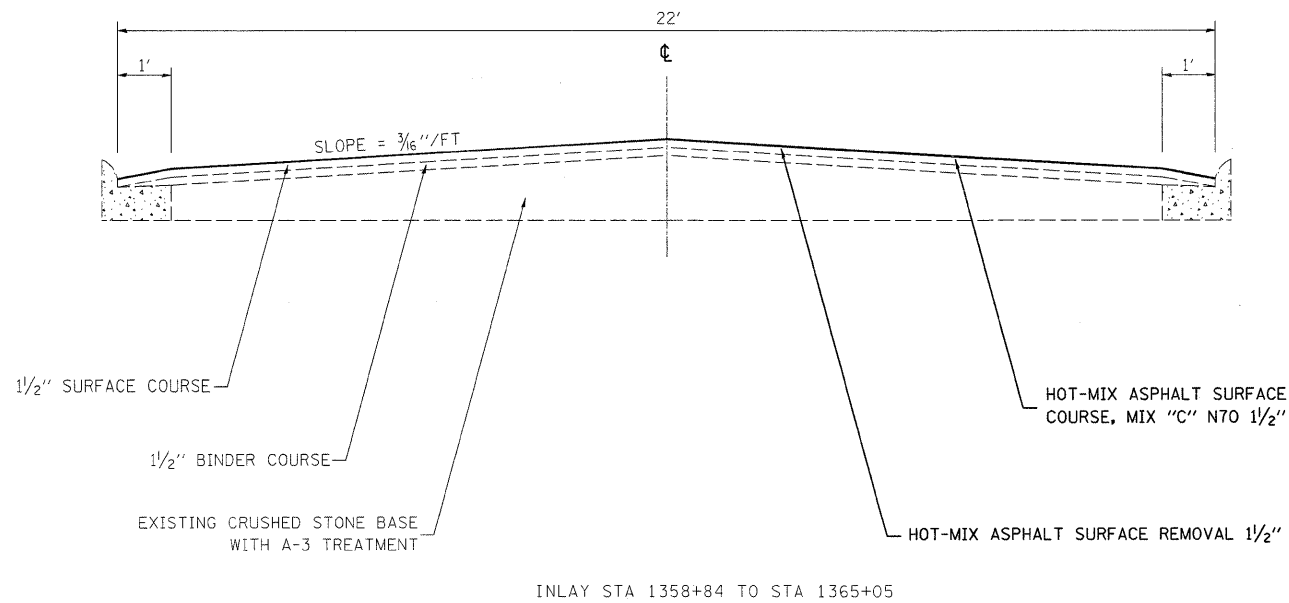
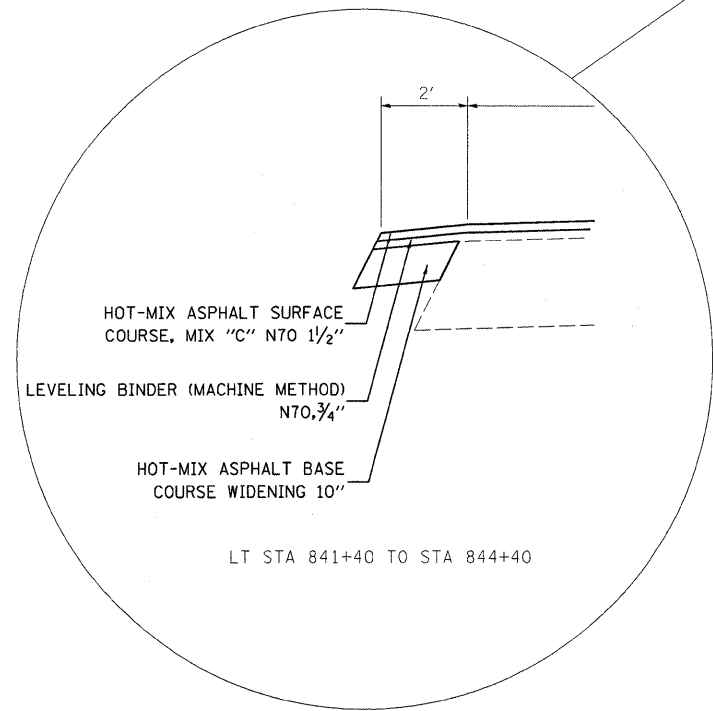
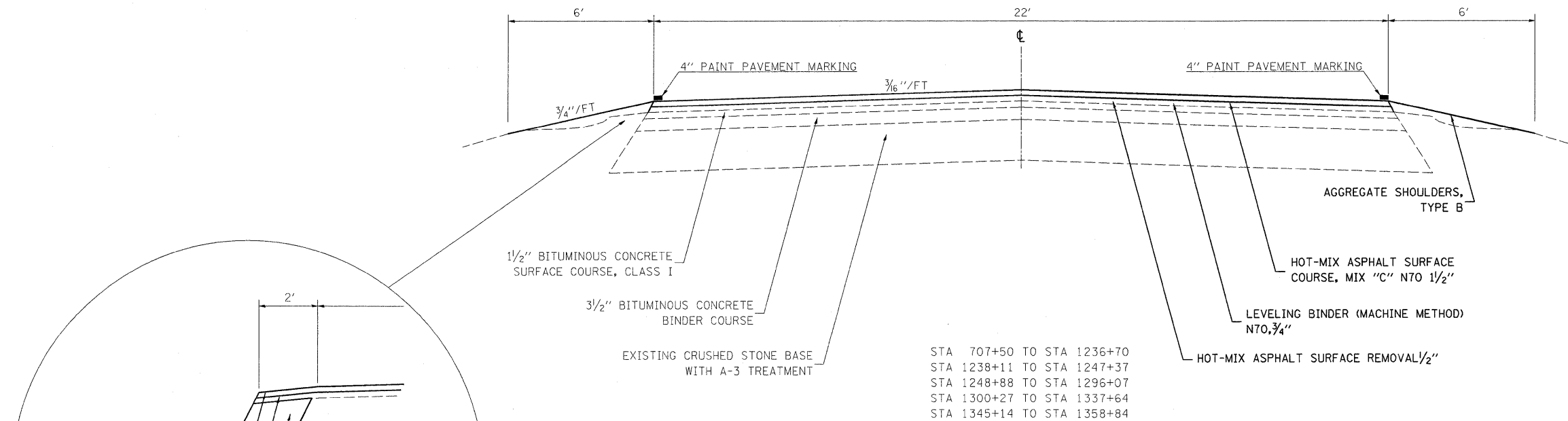

FILE NAME =

USER NAME = teasleyck

DESIGNED -

REVISED -

STATE OF ILLINOIS  
DEPARTMENT OF TRANSPORTATION

TYPICALS

F.A.P. RTE.	SECTION	COUNTY	TOTAL SHEETS	SHEET NO.
828	(106.107)RS-2	Clay	9	4
CONTRACT NO. 74371				

61\pwork\PIWIDOT\TEASLEYCK\d0123166\07

74371-sht-typical.dgn

DRAWN -

REVISED -

SCALE: SHEET NO. OF SHEETS STA. TO STA.

ILLINOIS FED. AID PROJECT

ILLINOIS FED. AID PROJECT

PERMANENT SURVEY MARKERS

STATION	DESCRIPTION
827+48.98	POT
832+70.40	PC
855+97.26	PT
857+91.47	POT

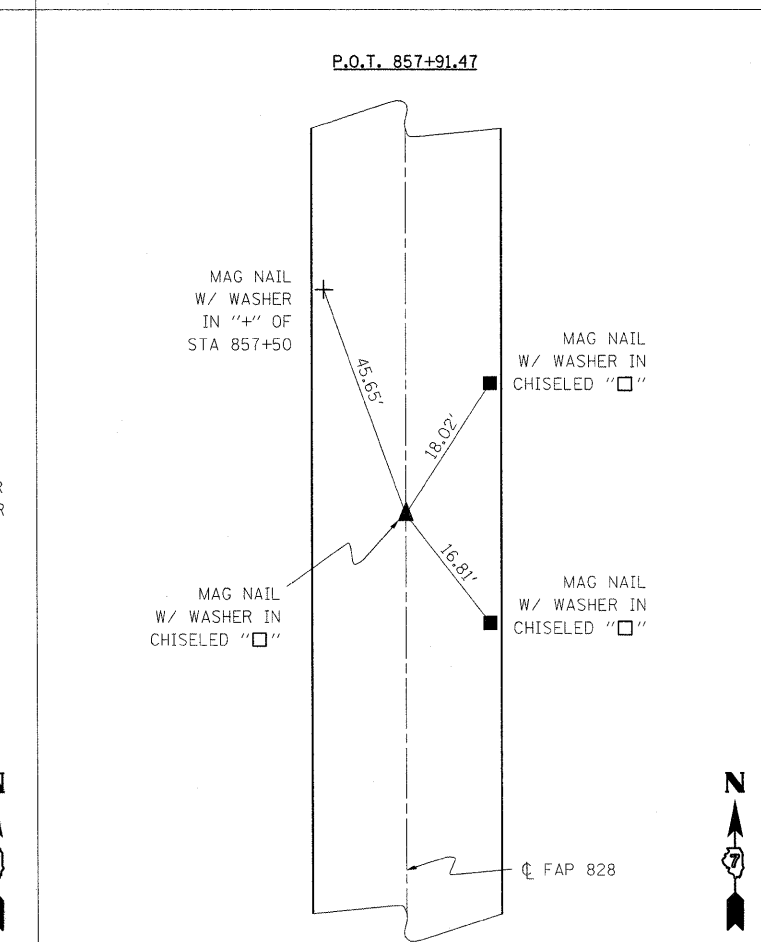
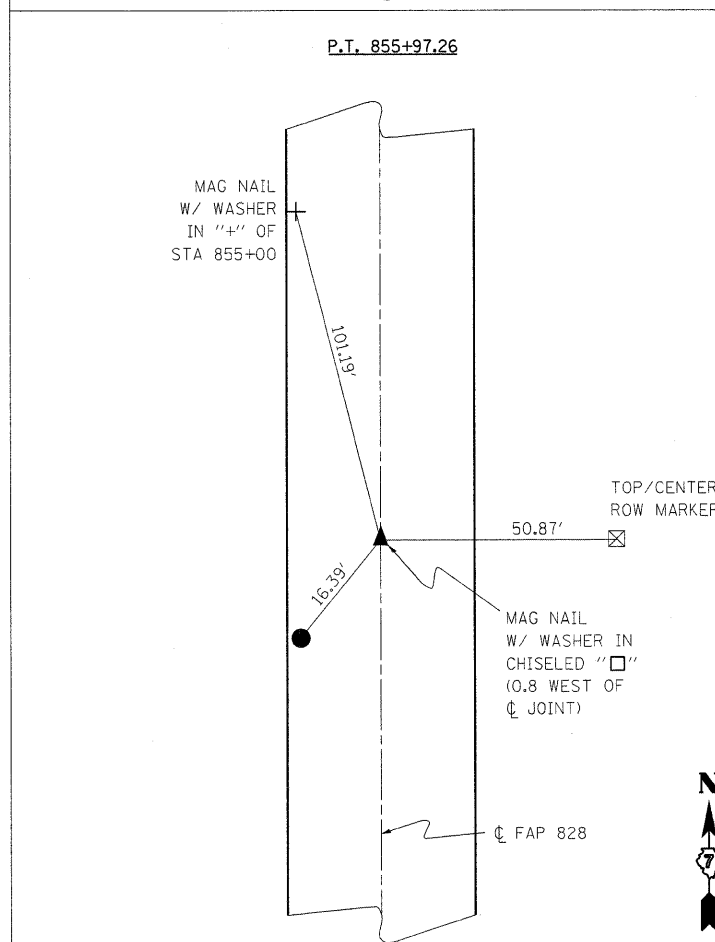
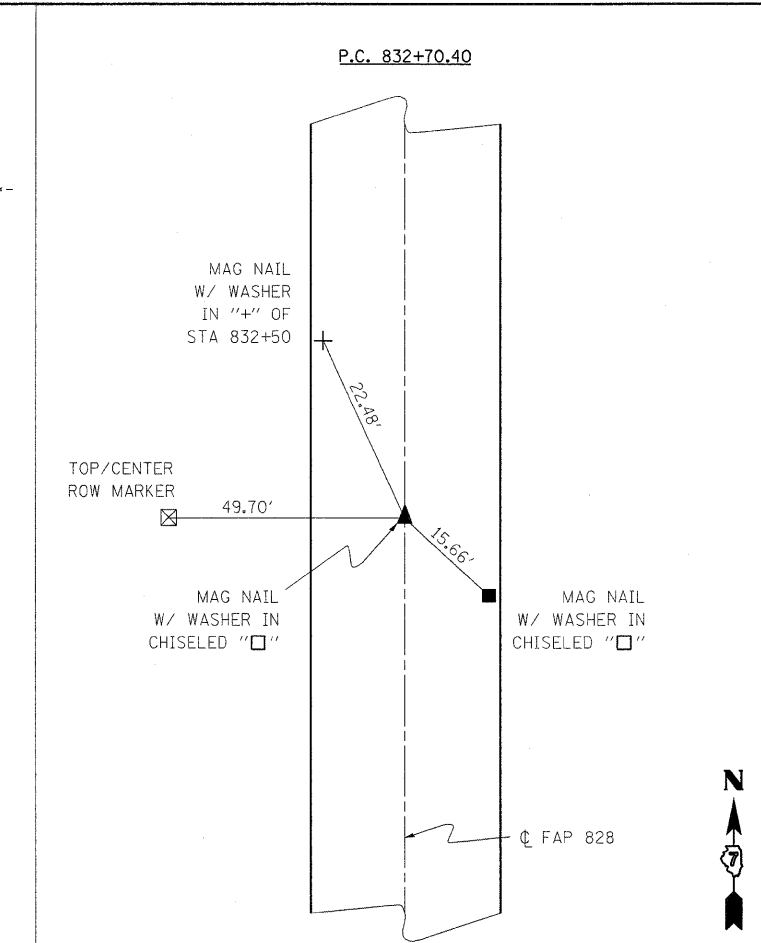
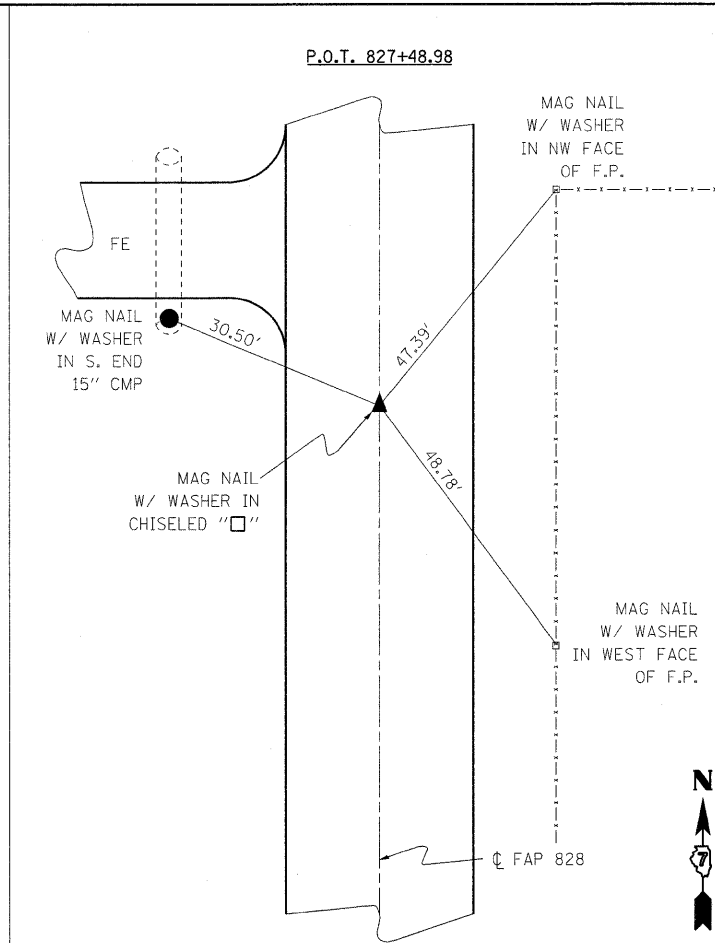

FILE NAME =	USER NAME = teasleyck	DESIGNED -	REVISED -
ca\pwwork\PWIDOT\TEASLEYCK\d8123166\1774371-sht-ties.dgn		DRAWN -	REVISED -
PLOT SCALE = 50.0000' / IN.		CHECKED -	REVISED -
PLOT DATE = 12/2/2009		DATE -	REVISED -

STATE OF ILLINOIS  
DEPARTMENT OF TRANSPORTATION

SURVEY TIES			
SCALE:	SHEET NO.	OF SHEETS	STA. TO STA.

F.A.P. RTE.	SECTION	COUNTY	TOTAL SHEETS	SHEET NO.
828	(106.107)RS-2	Clay	9	5
CONTRACT NO. 74371				





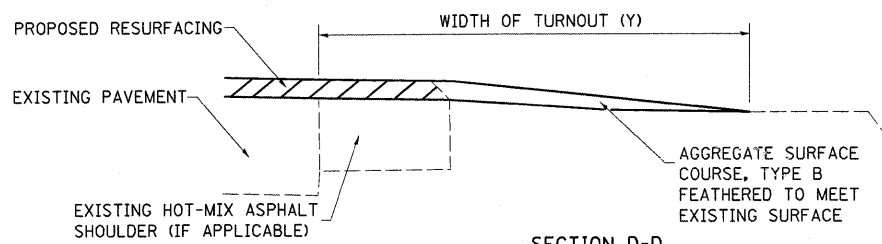
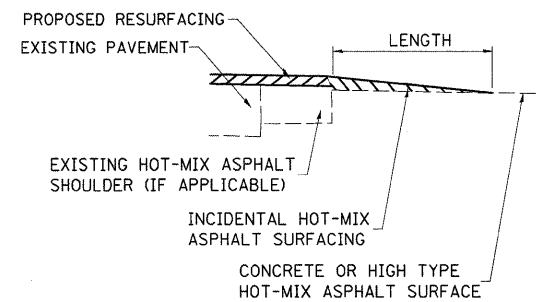
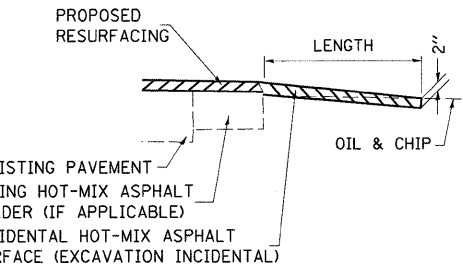
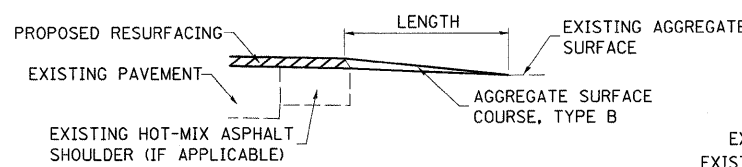
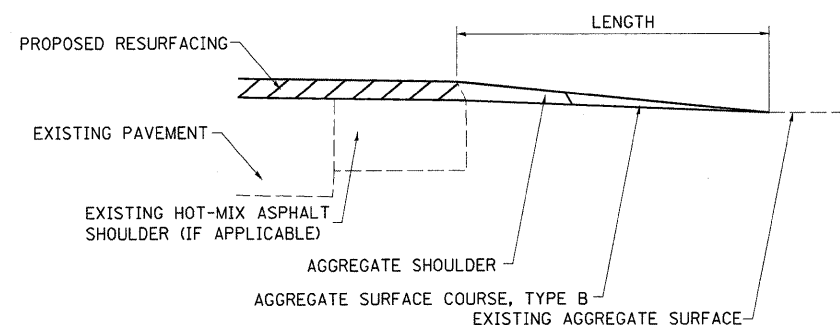
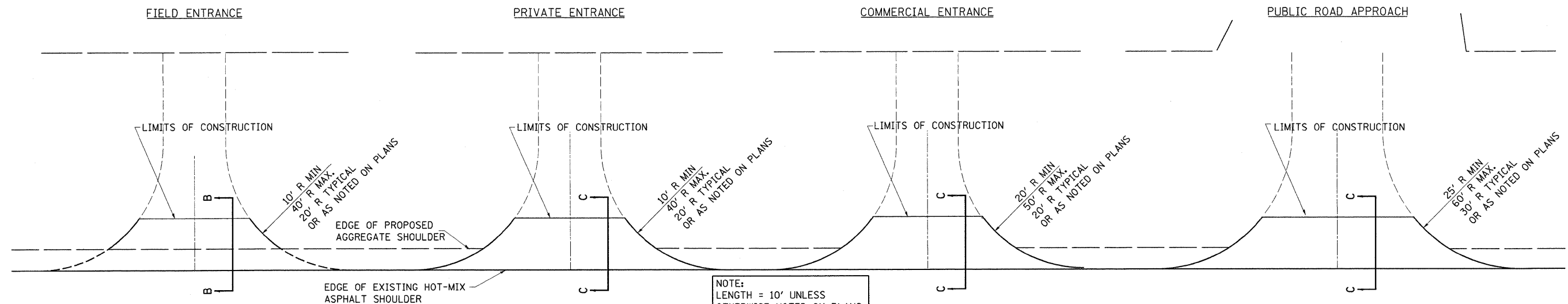

**TYPICAL SECTION AT MAILBOX TURNOUT**  
NOTE: SEE STANDARD 406201 FOR MAILBOX TURNOUT DETAILS

**NOTES**

THE COST OF THE ASPHALT MATERIALS, AND AGGREGATE (PRIME COAT) FOR ENTRANCES AND PUBLIC ROADS AND APPROACHES SHALL BE INCLUDED IN THE PAY ITEM INCIDENTAL HOT-MIX ASPHALT SURFACING.

THE COST OF EXCAVATION IS INCLUDED IN THE PAY ITEM INCIDENTAL HOT-MIX ASPHALT SURFACING.

IF THERE IS NOT EXISTING HOT-MIX ASPHALT SHOULDER THEN THE ENTRANCE TAPER STARTS AT THE EDGE OF EXISTING PAVEMENT.

THE COST OF THE BITUMINOUS MATERIALS AND AGGREGATE (PRIME COAT) FOR ENTRANCES AND PUBLIC ROAD APPROACHES SHALL BE INCLUDED IN THE PAY ITEM INCIDENTAL HOT-MIX ASPHALT SURFACING.

NOTE: STATIONS ARE GIVEN AS MILE POST READINGS, LT SIDE IS ON WEST, RT SIDE IS ON EAST, MILEAGE INCREASES TO NORTH

SIDE	STATION	TYPE	INCIDENTAL HOT-MIX ASPHALT SURFACING		SIDE	STATION	TYPE	INCIDENTAL HOT-MIX ASPHALT SURFACING		SIDE	STATION	TYPE	INCIDENTAL HOT-MIX ASPHALT SURFACING		SIDE	STATION	TYPE	INCIDENTAL HOT-MIX ASPHALT SURFACING	
			TON	TON				TON	TON				TON	TON				TON	TON
LT	10.61	PE		4.1	RT	11.59	FE		2.7	LT	12.62	PE		2.5					
RT	10.61	FE		2.4	LT	11.64	FE		2.6	LT	12.71	PRA	5.5						
RT	10.68	PRA	3.2		RT	11.74	FE		2.3	RT	12.71	PRA	4.8						
LT	10.68	PRA	6		RT	11.84	FE		2.6	LT	13.1	FE		3					
RT	10.87	PE		2.8	LT	11.84	FE		2.3	TOTALS			153	283					
LT	10.87	FE		2.1	LT	11.9	PE		2.2										
LT	10.94	FE		2.2	RT	11.9	PE		1.8										
LT	11.08	FE		2.3	RT	11.95	PRA	3.4											
RT	11.08	FE		2.3	LT	11.95	PE		4.1										
RT	11.19	PRA	5.3		RT	12.03	CE		4.9										
LT	11.19	PRA	4.7		RT	12.08	FE		2.2										
LT	11.25	FE		2.1	LT	12.08	FE		2.3										
RT	11.25	FE		2.2	LT	12.2	FE		2.3										
LT	11.31	PE		1.9	RT	12.2	FE		2.2										
LT	11.35	FE		2.3	RT	12.36	FE		2.3										
RT	11.35	FE		2.1	LT	12.36	PE		3.2										
RT	11.44	FE		2.3	RT	12.5	CE		6										
RT	11.55	PE		3.2	LT	12.59	PE		2.2										
LT	11.57	PRA	2.7		RT	12.59	FE		2.2										

FE=FIELD ENTRANCE PRA - PUBLIC ROAD APPROACH  
PE=PRIVATE ENTRANCE MBT - MAILBOX TURNOUT  
CE=COMMERCIAL ENTRANCE



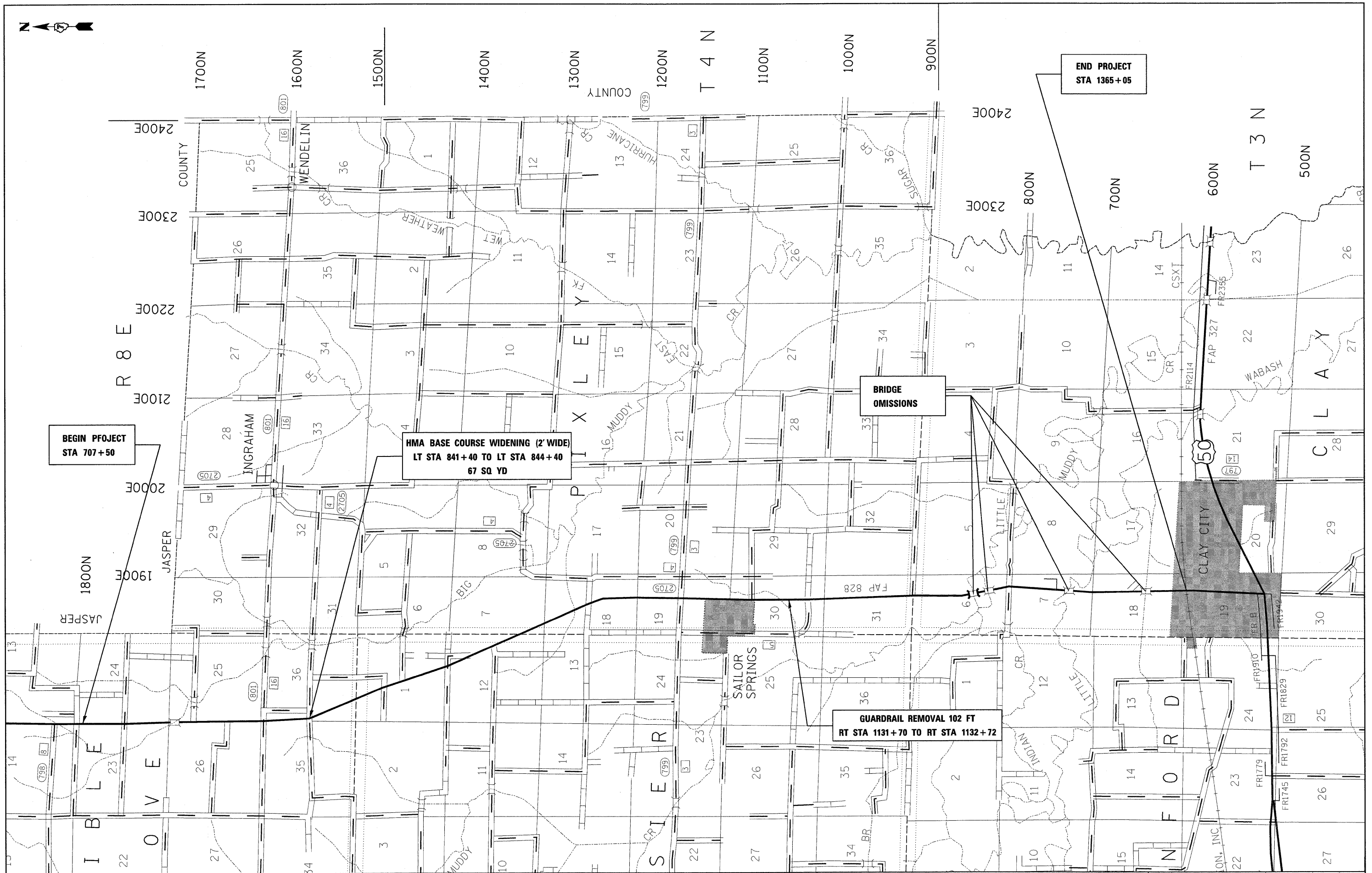

FILE NAME =  
 USER NAME = teasleyck  
 DESIGNED =  
 DRAWN =  
 CHECKED =  
 DATE =

DESIGNED =  
 DRAWN =  
 CHECKED =  
 DATE =

DESIGNED =  
 DRAWN =  
 CHECKED =  
 DATE =

**STATE OF ILLINOIS  
 DEPARTMENT OF TRANSPORTATION**

**LOCATION MAP**  
 SCALE: SHEET NO. OF SHEETS STA. TO STA.

F.A.P. RTE. 828	SECTION (106,107)RS-2	COUNTY Clay	TOTAL SHEETS 9	SHEET NO. 9
CONTRACT NO. 74371			ILLINOIS FED. AID PROJECT	