

COORDINATES SHOWN HEREON ARE BASED ON SURVEY CONTROL DATA AS PROVIDED BY THE ILLINOIS DEPARTMENT OF TRANSPORTATION.

PART OF THE NE 1/4 OF SECTION 23, T6N, R10W, OF THE 3RD PM, MADISON COUNTY, ILLINOIS

BEARINGS SHOWN HEREON ARE BASED ON SURVEY CONTROL DATA AS PROVIDED BY THE ILLINOIS DEPARTMENT OF TRANSPORTATION.

COORDINATE TABLE			
STATION	OFFSET	NORTH	EAST
20+047.297	10.112 m RT	255,025.0197	698,839.6142
20+047.842	81.237 m RT	255,024.3961	698,910.7377
20+048.145	120.765 m RT	255,024.0340	698,950.2657
20+087.927	10.119 m RT	255,065.6439	698,840.2940
20+088.473	79.852 m RT	255,065.0403	698,910.0271
20+098.105	79.524 m RT	255,074.6705	698,909.8987

COORDINATE TABLE (CONT)			
STATION	OFFSET	NORTH	EAST
20+098.414	119.229 m RT	255,074.3212	698,949.5626
20+128.557	10.125 m RT	255,106.2682	698,840.9129
20+128.599	15.240 m RT	255,106.2253	698,846.0894
20+129.116	78.468 m RT	255,105.6945	698,909.3164

FOUND BRASS PLUG NW COR. E 1/2, NE 1/4, SEC 23 PI STA 33+44.06 COUNTY HWY 12A SECTION 109 MPT R/W VOL. 7, PG 179

S 00° 57' 31" W (S 00° 00' 00" E) 119.984 m (393.65') (393.32')

20+128.458, 2.067 m LT (6.78') PR HUMBERT RD

R = 26,207.674 m (86,303.01') L = 5,848 m (19.19') CHORD = N 00° 57' 04" E 5,848 m (19.19')

SEE SHEET 30

S 89° 31' 08" E (N 90° 00' 00" E) 12.192 m (40.00')

20+104.827 & RAMP B = 0+581.508 PR HUMBERT RD

20+104.827 & RAMP B = 0+581.508 PR HUMBERT RD

20+104.827 & RAMP B = 0+581.508 PR HUMBERT RD

20+104.827 & RAMP B = 0+581.508 PR HUMBERT RD

20+104.827 & RAMP B = 0+581.508 PR HUMBERT RD

20+104.827 & RAMP B = 0+581.508 PR HUMBERT RD

20+104.827 & RAMP B = 0+581.508 PR HUMBERT RD

20+104.827 & RAMP B = 0+581.508 PR HUMBERT RD

20+104.827 & RAMP B = 0+581.508 PR HUMBERT RD

20+104.827 & RAMP B = 0+581.508 PR HUMBERT RD

20+104.827 & RAMP B = 0+581.508 PR HUMBERT RD

20+104.827 & RAMP B = 0+581.508 PR HUMBERT RD

20+104.827 & RAMP B = 0+581.508 PR HUMBERT RD

20+104.827 & RAMP B = 0+581.508 PR HUMBERT RD

20+104.827 & RAMP B = 0+581.508 PR HUMBERT RD

20+104.827 & RAMP B = 0+581.508 PR HUMBERT RD

20+104.827 & RAMP B = 0+581.508 PR HUMBERT RD

20+104.827 & RAMP B = 0+581.508 PR HUMBERT RD

20+104.827 & RAMP B = 0+581.508 PR HUMBERT RD

20+104.827 & RAMP B = 0+581.508 PR HUMBERT RD

20+104.827 & RAMP B = 0+581.508 PR HUMBERT RD

20+104.827 & RAMP B = 0+581.508 PR HUMBERT RD

20+104.827 & RAMP B = 0+581.508 PR HUMBERT RD

20+104.827 & RAMP B = 0+581.508 PR HUMBERT RD

20+104.827 & RAMP B = 0+581.508 PR HUMBERT RD

20+104.827 & RAMP B = 0+581.508 PR HUMBERT RD

20+104.827 & RAMP B = 0+581.508 PR HUMBERT RD

20+104.827 & RAMP B = 0+581.508 PR HUMBERT RD

20+104.827 & RAMP B = 0+581.508 PR HUMBERT RD

20+104.827 & RAMP B = 0+581.508 PR HUMBERT RD

20+104.827 & RAMP B = 0+581.508 PR HUMBERT RD

20+104.827 & RAMP B = 0+581.508 PR HUMBERT RD

20+104.827 & RAMP B = 0+581.508 PR HUMBERT RD

20+104.827 & RAMP B = 0+581.508 PR HUMBERT RD

20+104.827 & RAMP B = 0+581.508 PR HUMBERT RD

20+104.827 & RAMP B = 0+581.508 PR HUMBERT RD

20+104.827 & RAMP B = 0+581.508 PR HUMBERT RD

20+104.827 & RAMP B = 0+581.508 PR HUMBERT RD

20+104.827 & RAMP B = 0+581.508 PR HUMBERT RD

20+104.827 & RAMP B = 0+581.508 PR HUMBERT RD

20+104.827 & RAMP B = 0+581.508 PR HUMBERT RD

20+104.827 & RAMP B = 0+581.508 PR HUMBERT RD

20+104.827 & RAMP B = 0+581.508 PR HUMBERT RD

20+104.827 & RAMP B = 0+581.508 PR HUMBERT RD

20+104.827 & RAMP B = 0+581.508 PR HUMBERT RD

20+104.827 & RAMP B = 0+581.508 PR HUMBERT RD

20+104.827 & RAMP B = 0+581.508 PR HUMBERT RD

20+104.827 & RAMP B = 0+581.508 PR HUMBERT RD

20+104.827 & RAMP B = 0+581.508 PR HUMBERT RD

20+104.827 & RAMP B = 0+581.508 PR HUMBERT RD

20+104.827 & RAMP B = 0+581.508 PR HUMBERT RD

20+104.827 & RAMP B = 0+581.508 PR HUMBERT RD

20+104.827 & RAMP B = 0+581.508 PR HUMBERT RD

SEE SHEET 23

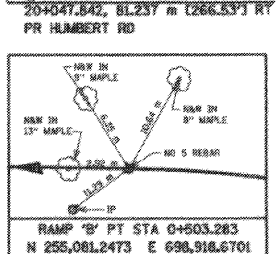
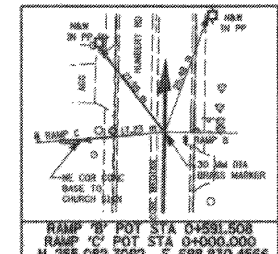
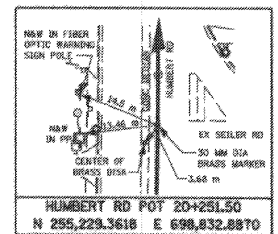

PARCEL NO.	OWNER	TOTAL HOLDING ACRES	FEE SIMPLE ACQUISITION			EASEMENTS		REMAINDER ACRES	PERMANENT TAX NUMBER	PROPERTY ACQUIRED BY				
			GROSS ACRES	PREVIOUSLY DEDICATED ACRES	NET ACRES	PE = PERMANENT ACRES	TE = TEMPORARY ACRES							
8239001	THE PEOPLE OF THE STATE OF ILLINOIS, DEPARTMENT OF TRANSPORTATION	0.6933	0.6933	30,200	N/A	N/A	0.6933	30,200	0.0000	N/A	N/A	N/A	24-1-01-23-02-201-004	
8239036	LEROY W. BRAKEMEYER AND MARIE BRAKEMEYER, IN JOINT TENANCY TITLE REPORT NO. MA-2636	1.1994	1.1994	52,248	N/A	N/A	1.1994	52,248	0.0000	N/A	N/A	N/A	24-1-01-23-02-201-005	

STATE OF ILLINOIS)

COUNTY OF ADAMS) SS

THIS IS TO CERTIFY THAT I, JOHN E. BASINGER AN ILLINOIS PROFESSIONAL LAND SURVEYOR, HAVE DIRECTED THE SURVEY AND DRAFTING OF THE PLAT OF HIGHWAYS SHOWN HEREON IN SECTION 23, TOWNSHIP 6 NORTH, RANGE 10 WEST, OF THE THIRD PRINCIPAL MERIDIAN, MADISON COUNTY, THAT THE SURVEY IS TRUE AND COMPLETE AS SHOWN TO THE BEST OF MY KNOWLEDGE AND BELIEF, THAT THE PLAT CORRECTLY REPRESENTS SAID SURVEY, THAT ALL MONUMENTS FOUND AND ESTABLISHED ARE OF PERMANENT QUALITY AND OCCUPY THE POSITIONS SHOWN THEREON AND THAT THE MONUMENTS ARE SUFFICIENT TO ENABLE THE SURVEY TO BE RETRACED. MADE FOR THE DEPARTMENT OF TRANSPORTATION, STATE OF ILLINOIS.

DATED 11-30-2005

JOHN E. BASINGER, PLS #2766

LICENSE EXPIRATION DATE: 11-30-2006

"THIS PROFESSIONAL SERVICE CONFORMS TO THE CURRENT ILLINOIS MINIMUM STANDARDS FOR A BOUNDARY SURVEY."

FIELD WORK COMPLETED: APRIL 2004



ILLINOIS DEPARTMENT OF TRANSPORTATION
PLAT OF HIGHWAYS
 FAP ROUTE 310 (IL 255)
 SECTION 60-15
 MADISON COUNTY
 JOB NO. R-98-039-92
 HUMBERT ROAD
 STATION 20+047.297 TO STATION 20+128.599

0 m 5 m 10 m 15 m
 SCALE 1:250 SHEET 29 OF 55

ILLINOIS DEPARTMENT OF TRANSPORTATION
 DIVISION OF HIGHWAYS/DISTRICT 5
 502 EASTPORT PLAZA DRIVE
 COLLINGSVILLE, ILLINOIS 62234-6199

KLINGNER & ASSOCIATES, P.C.

Engineers / Architects
616 North 24th Street (217) 223-3670
Quincy, Illinois 62301 FAX 223-3603
Internet Address: www.klingner.com
STATE OF ILLINOIS DESIGN FIRM # 1842738