

6/29/2007

DATE	
BY	
FINAL SURVEY	
NOTE BOOK	
TEMPLATE	
AREAS	
CHECKED	

DATE	
BY	
ORIGINAL SURVEY	
NOTE BOOK	
TEMPLATE	
AREAS	
CHECKED	

FAP RTE	SECTION	COUNTY	TOTAL SHEETS	SHEET NO.
	60-15, 60-15B	MADISON	474	286
STA.	TO STA.			
FED. ROAD DIST. NO.	ILLINOIS	FED. AID PROJECT	CONTRACT NO. 76323	

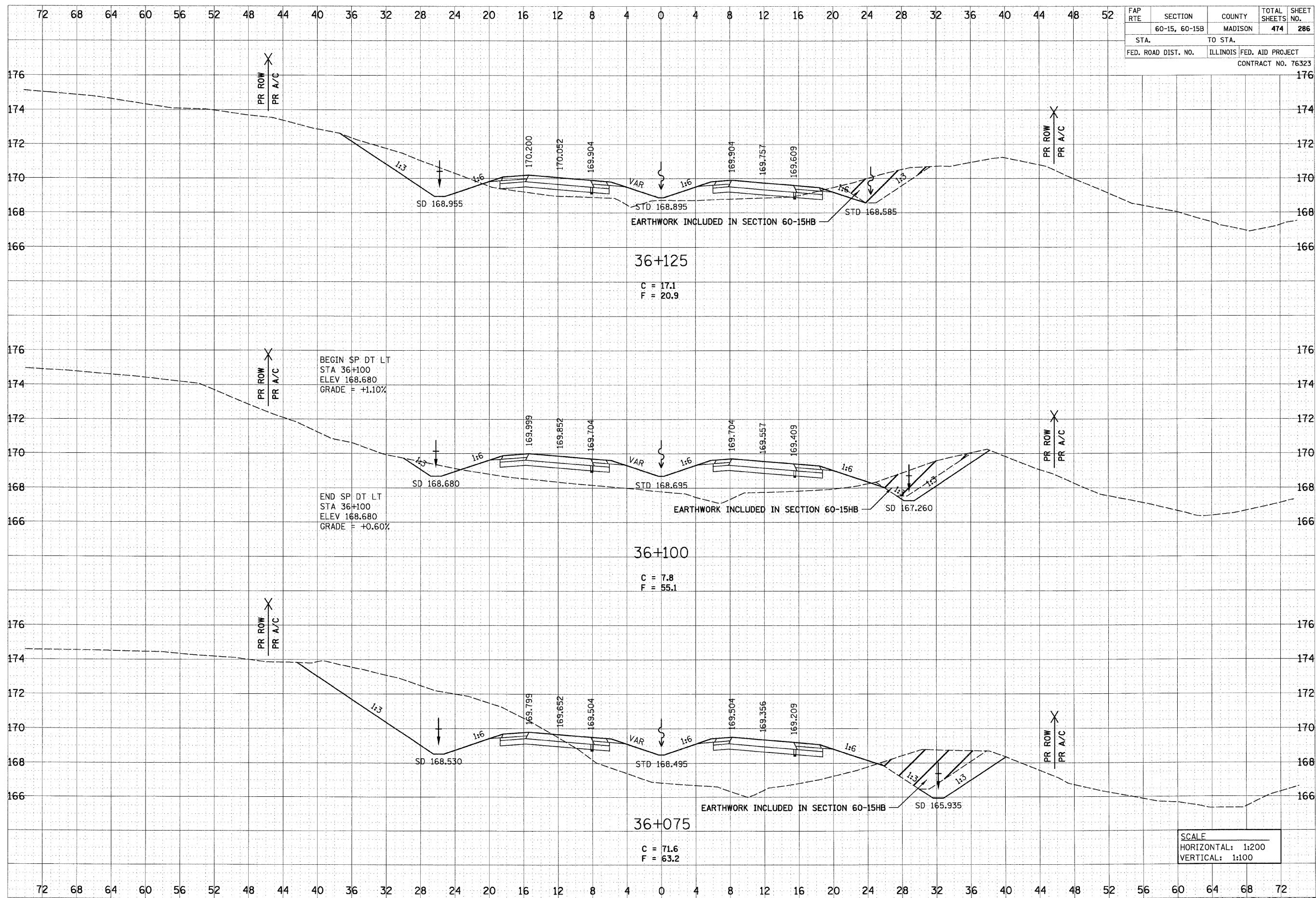

p:\0071.es\00024\main\line\crosssections\ss36\015.dgn