

6/29/2007

DATE	BY
SURVEYED	BY
TEMPERATURE	BY
NOTE BOOK	NO.
AREAS CHECKED	

DATE	BY
SURVEYED	BY
TEMPERATURE	BY
NOTE BOOK	NO.
AREAS CHECKED	

FAP RTE	SECTION	COUNTY	TOTAL SHEETS	SHEET NO.
	60-15, 60-15B	MADISON	474	302
STA.	TO STA.			
FED. ROAD DIST. NO.	ILLINOIS	FED. AID PROJECT		
CONTRACT NO. 76323				

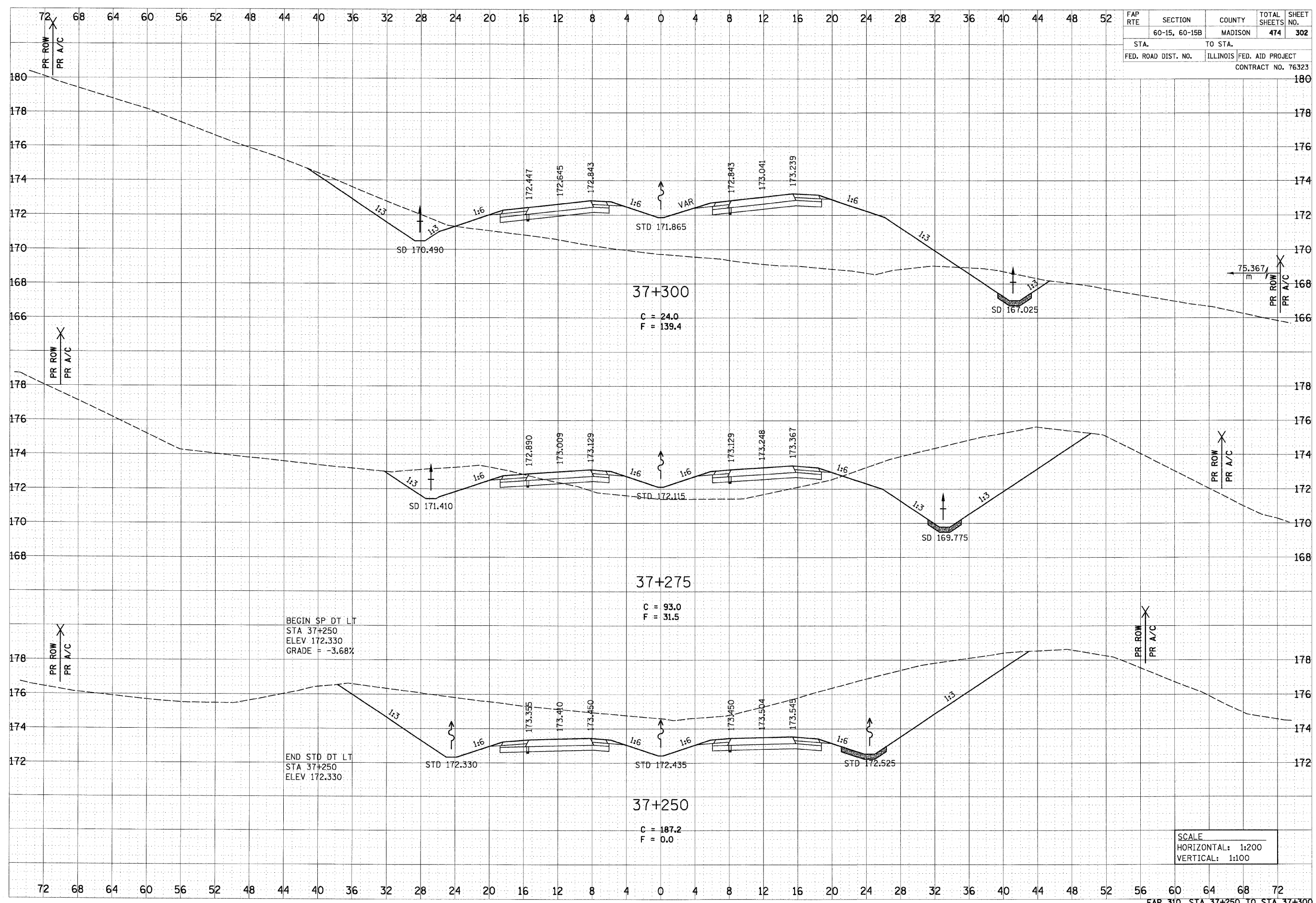

p:\001\1es\0024\dms\1\crosssections\asac015a.dgn