

6/29/2007

FINAL SURVEY	DATE
SURVEYED	BY
NOTE BOOK	NO.
TEMPERATURE	
AREAS CHECKED	

ORIGINAL SURVEY	DATE
SURVEYED	BY
NOTE BOOK	NO.
TEMPERATURE	
AREAS CHECKED	

FAP RTE	SECTION	COUNTY	TOTAL SHEETS	SHEET NO.
	60-15, 60-15B	MADISON	474	303
STA.	TO STA.			
FED. ROAD DIST. NO.	ILLINOIS FED. AID PROJECT			
CONTRACT NO. 76323				

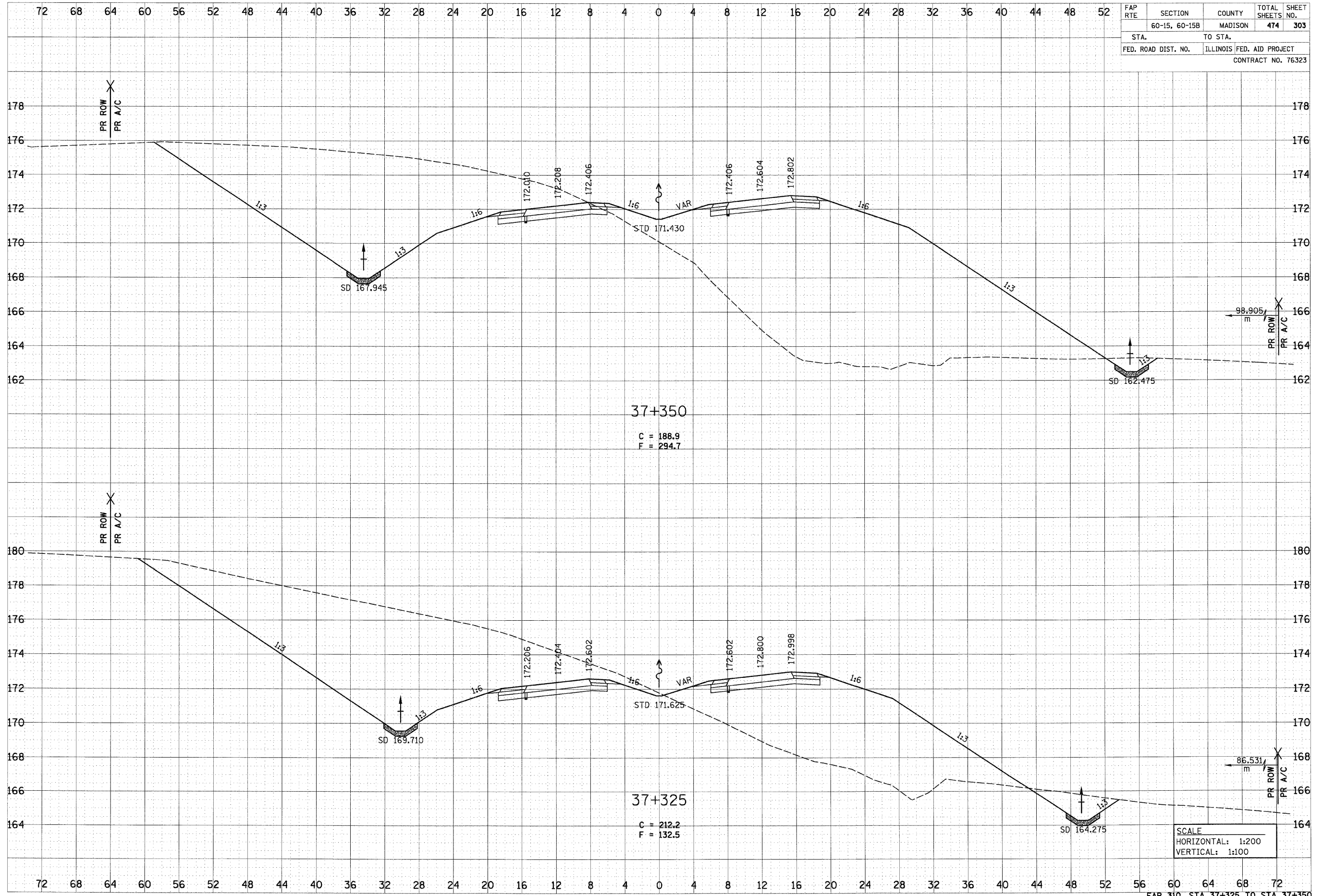

37+350
 C = 188.9
 F = 294.7

37+325
 C = 212.2
 F = 132.5

SCALE
 HORIZONTAL: 1:200
 VERTICAL: 1:100

p:\0811es\08224\dmr\line\crosssections\vesec015a.dgn