

6/29/2007

DATE	BY
SURVEYED	BY
NOTE BOOK	NO.
AREAS CHECKED	

DATE	BY
SURVEYED	BY
NOTE BOOK	NO.
AREAS CHECKED	

FAP RTE	SECTION	COUNTY	TOTAL SHEETS	SHEET NO.
	60-15, 60-15B	MADISON	474	314
STA.	TO STA.			
FED. ROAD DIST. NO.	ILLINOIS FED. AID PROJECT			
CONTRACT NO. 76323				

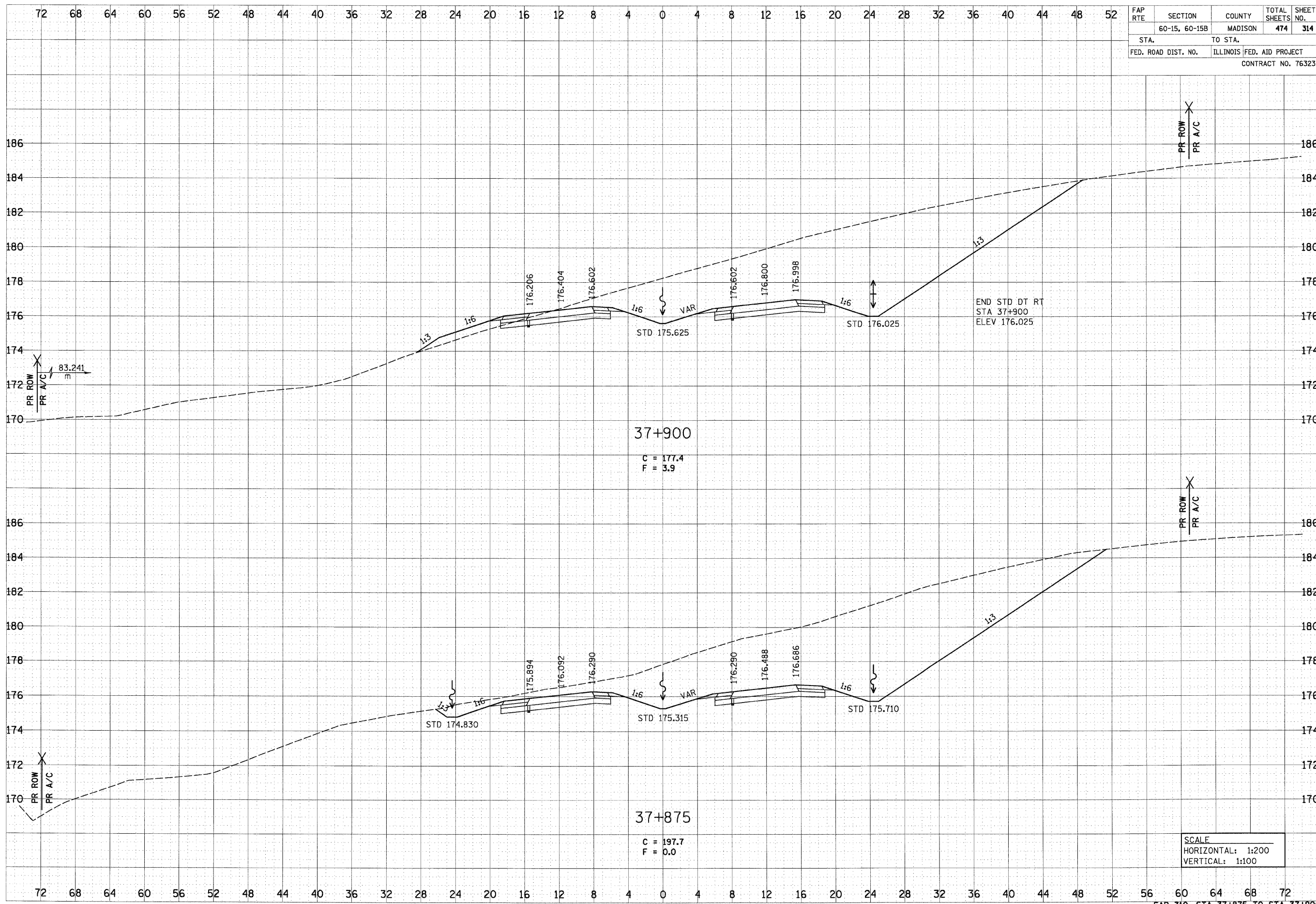

pr:\001\1es\00024\dnas\line\crosssections\wsec015a.dgn