

6/29/2007

DATE	
BY	
SURVEYED	
NOTE BOOK	
AREAS	
AREAS CHECKED	
NO.	

DATE	
BY	
ORIGINAL SURVEY	
NOTE BOOK	
AREAS	
AREAS CHECKED	
NO.	

FAP RTE	SECTION	COUNTY	TOTAL SHEETS	SHEET NO.
	60-15, 60-15B	MADISON	474	326
STA.	TO STA.			
FED. ROAD DIST. NO.	ILLINOIS	FED. AID PROJECT		
CONTRACT NO. 76323				

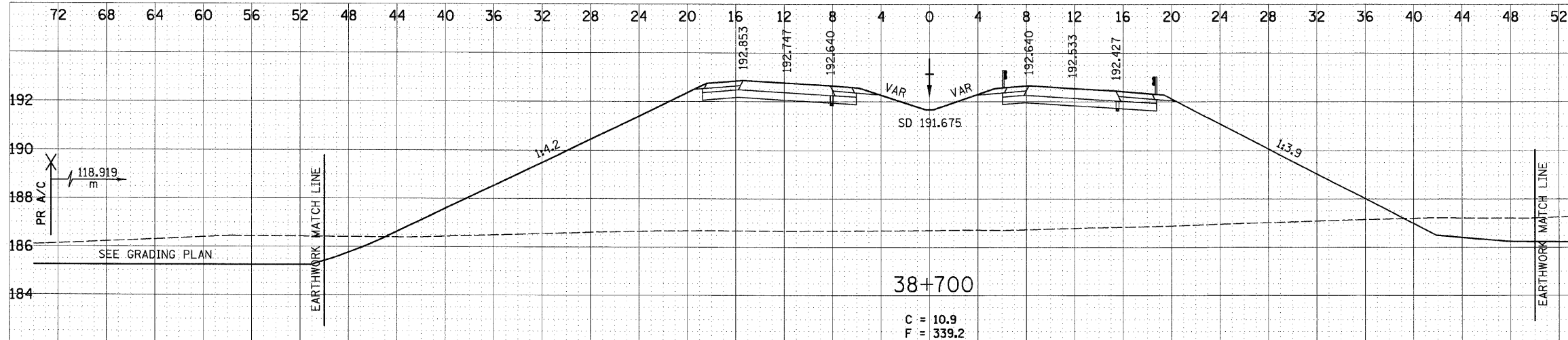

38+700
 C = 10.9
 F = 339.2

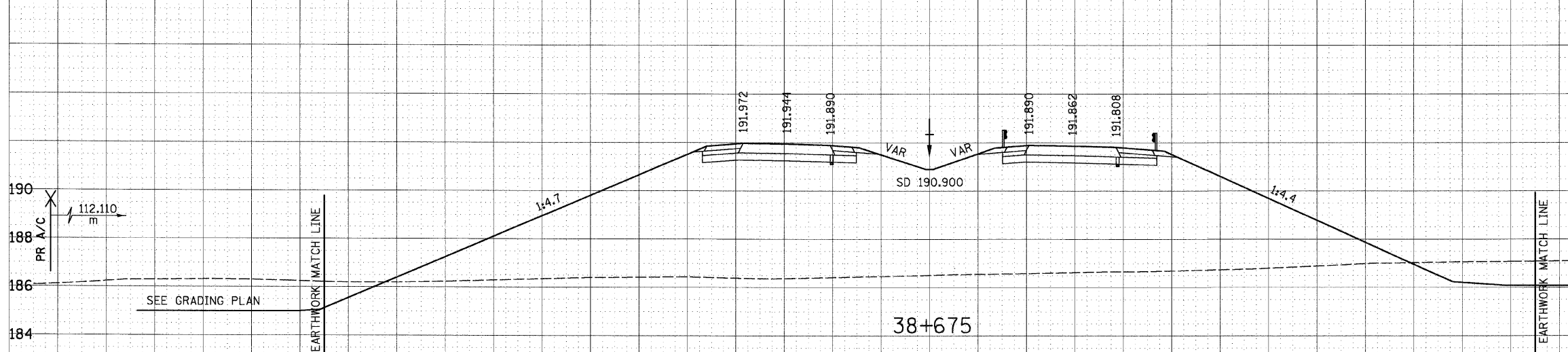

38+675
 C = 10.6
 F = 307.6

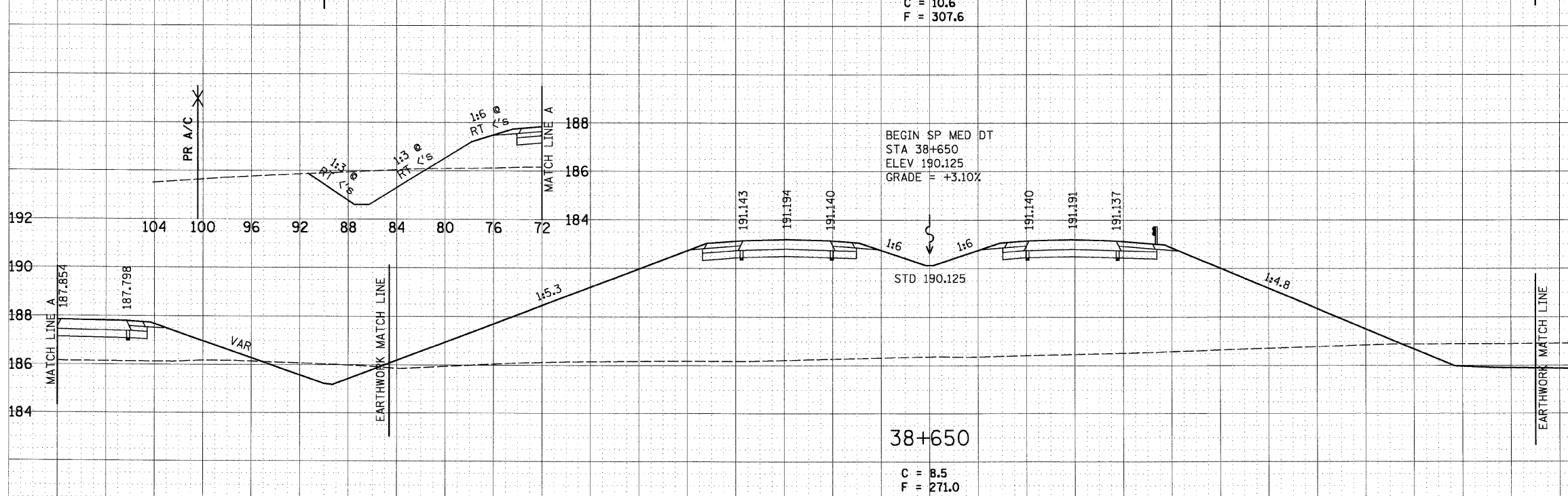

38+650
 C = 8.5
 F = 271.0

SCALE
 HORIZONTAL: 1:200
 VERTICAL: 1:100