

5/29/2007

DATE	BY
SURVEYED	
NOTED	
AREAS CHECKED	
NO.	

DATE	BY
SURVEYED	
NOTED	
AREAS CHECKED	
NO.	

FAP RTE	SECTION	COUNTY	TOTAL SHEETS	SHEET NO.
	60-15, 60-15B	MADISON	474	335
STA.	TO STA.			
FED. ROAD DIST. NO.	ILLINOIS FED. AID PROJECT			
CONTRACT NO. 76323				

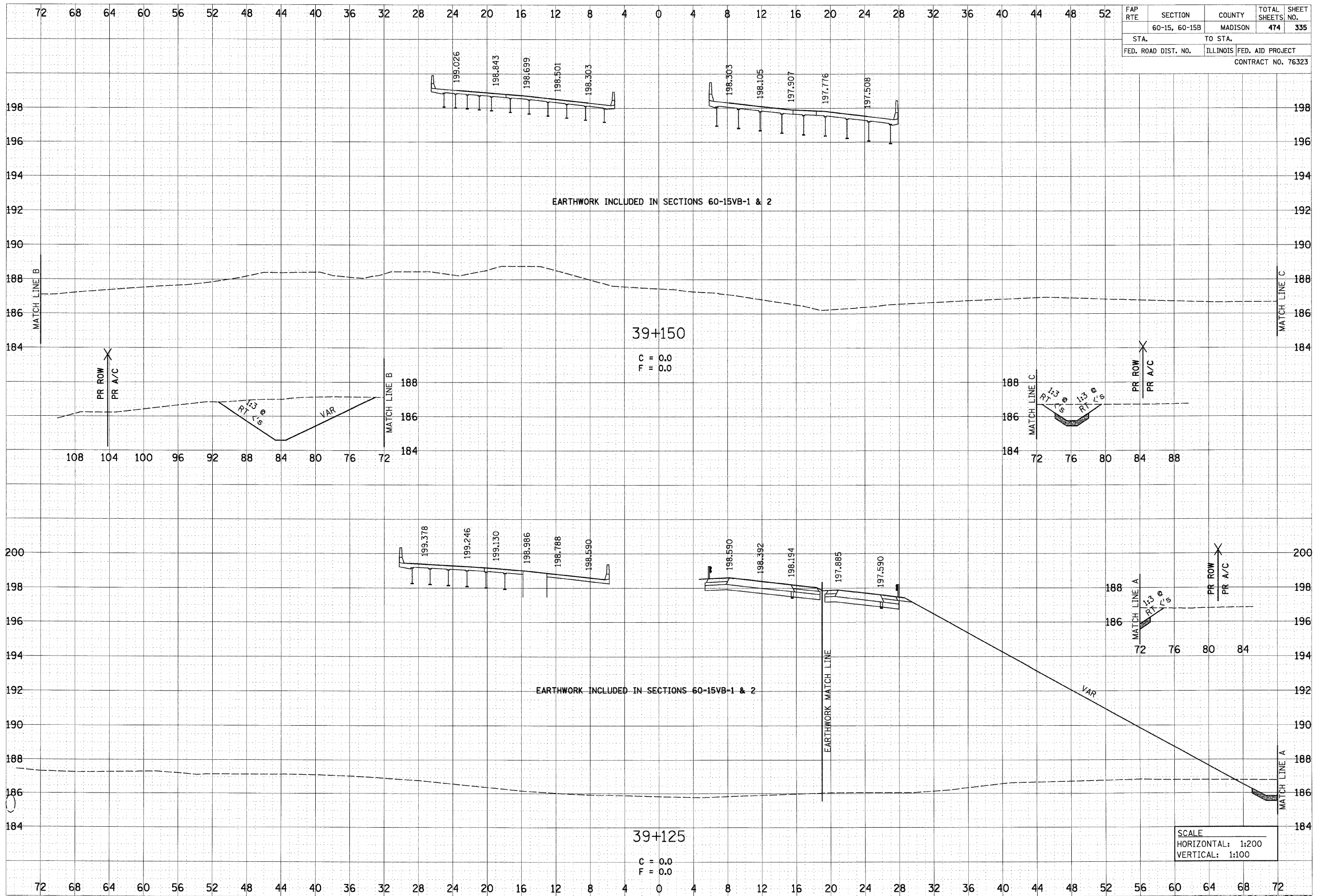

SCALE  
 HORIZONTAL: 1:200  
 VERTICAL: 1:100

FAP 310, STA 39+125 TO STA 39+150

p:\00711es\00024\main\line\crosssections\wsec015a.dgn