

6/29/2007

DATE	
BY	
SURVEYED	
TRIP NO.	
TIME	
NOTE BOOK	
AREAS CHECKED	
NO.	

DATE	
BY	
SURVEYED	
TRIP NO.	
TIME	
NOTE BOOK	
AREAS CHECKED	
NO.	

FAP RTE	SECTION	COUNTY	TOTAL SHEETS	SHEET NO.
	60-15, 60-15B	MADISON	474	340
STA.		TO STA.		
FED. ROAD DIST. NO.		ILLINOIS	FED. AID PROJECT	
CONTRACT NO. 76323				

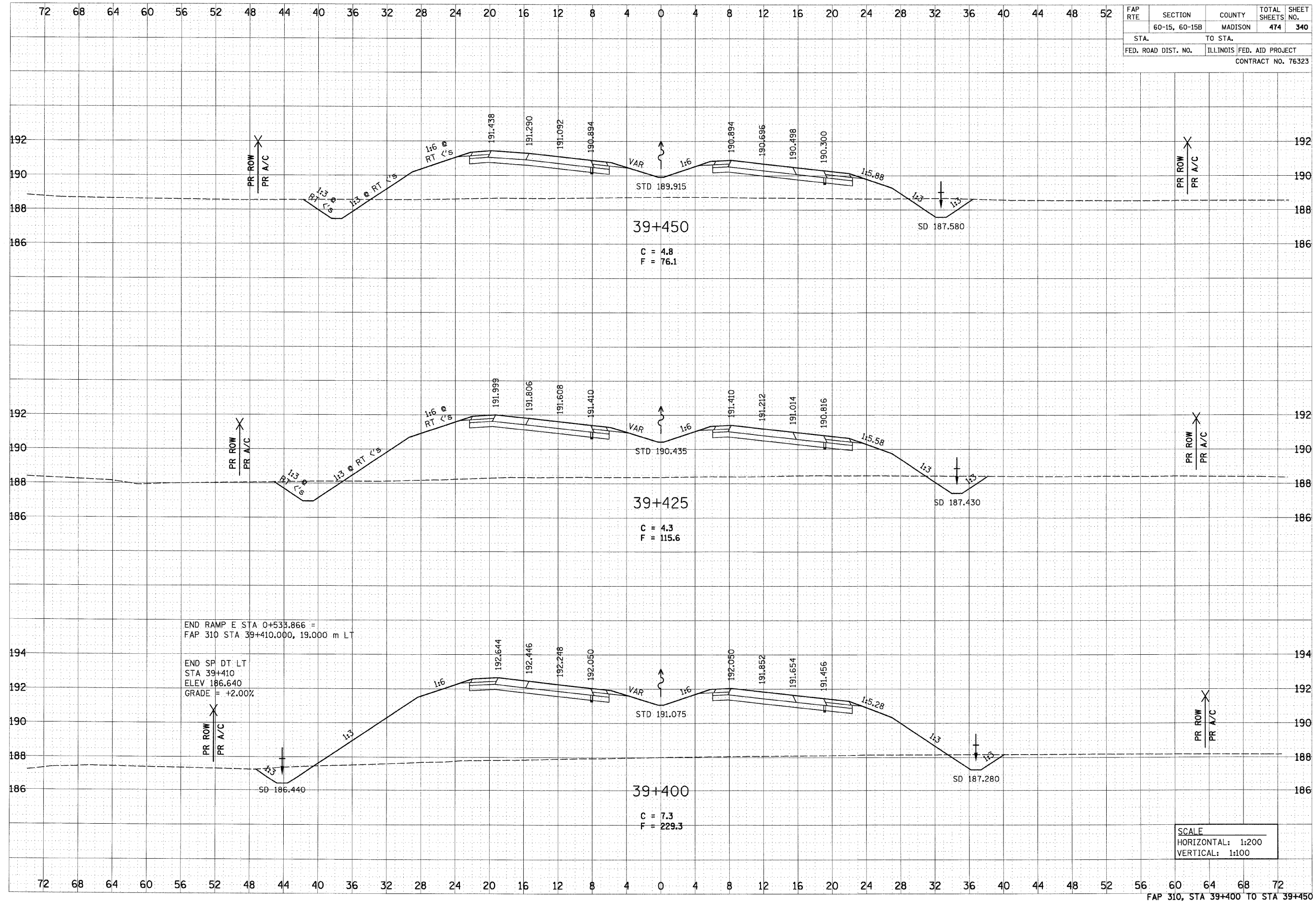

END RAMP E STA 0+533.866 =  
 FAP 310 STA 39+410.000, 19.000 m LT

END SP DT LT  
 STA 39+410  
 ELEV 186.640  
 GRADE = +2.00%

SCALE  
 HORIZONTAL: 1:200  
 VERTICAL: 1:100

p:\02911es\02924\main1.mxd\crosssections\vesec015a.dgn