

6/29/2007

FINAL SURVEY	DATE
SURVEYED	BY
NOTE BOOK	NO.
TEMPLATE	AREAS CHECKED
AREAS	
CHECKED	

ORIGINAL SURVEY	DATE
SURVEYED	BY
NOTE BOOK	NO.
TEMPLATE	AREAS CHECKED
AREAS	
CHECKED	

FAP RTE	SECTION	COUNTY	TOTAL SHEETS	SHEET NO.
	60-15, 60-15B	MADISON	474	360
STA.	TO STA.			
FED. ROAD DIST. NO.	ILLINOIS	FED. AID PROJECT	CONTRACT NO. 76323	

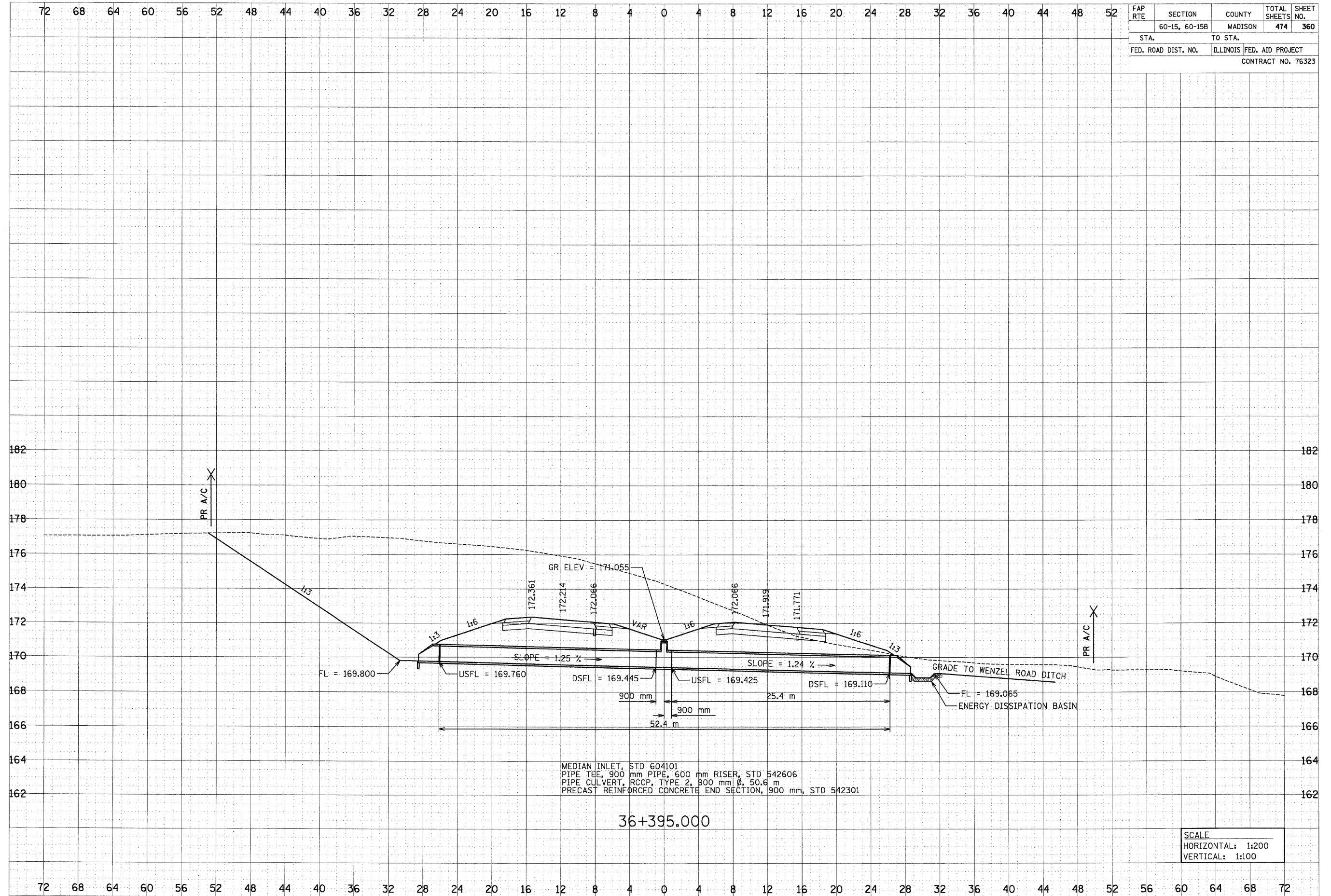

MEDIAN INLET, STD 604101
 PIPE TEE, 900 mm PIPE, 600 mm RISER, STD 542606
 PIPE CULVERT, RCCP, TYPE 2, 900 mm Ø, 50.6 m
 PRECAST REINFORCED CONCRETE END SECTION, 900 mm, STD 542301

SCALE
 HORIZONTAL: 1:200
 VERTICAL: 1:100