

6/29/2007

DATE	BY
SURVEYED	BY
NOTE BOOK	NO.
AREAS CHECKED	

DATE	BY
SURVEYED	BY
NOTE BOOK	NO.
AREAS CHECKED	

FAP RTE	SECTION	COUNTY	TOTAL SHEETS	SHEET NO.
	60-15, 60-15B	MADISON	474	364
STA.	TO STA.			
FED. ROAD DIST. NO.	ILLINOIS	FED. AID PROJECT		
CONTRACT NO. 76323				

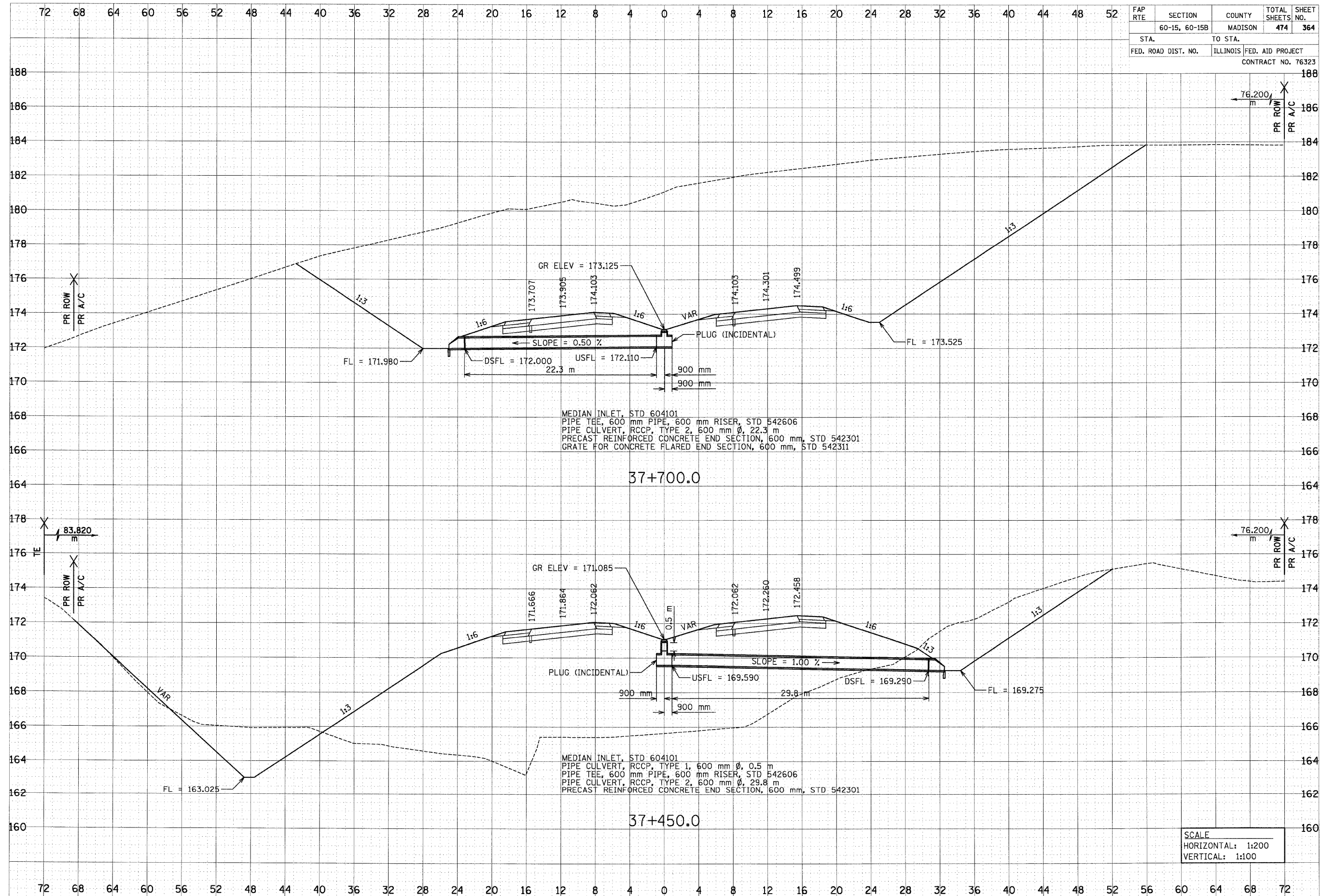

MEDIAN INLET, STD 604101
 PIPE TEE, 600 mm PIPE, 600 mm RISER, STD 542606
 PIPE CULVERT, RCCP, TYPE 2, 600 mm Ø, 22.3 m
 PRECAST REINFORCED CONCRETE END SECTION, 600 mm, STD 542301
 GRATE FOR CONCRETE FLARED END SECTION, 600 mm, STD 542311

MEDIAN INLET, STD 604101
 PIPE CULVERT, RCCP, TYPE 1, 600 mm Ø, 0.5 m
 PIPE TEE, 600 mm PIPE, 600 mm RISER, STD 542606
 PIPE CULVERT, RCCP, TYPE 2, 600 mm Ø, 29.8 m
 PRECAST REINFORCED CONCRETE END SECTION, 600 mm, STD 542301

SCALE
 HORIZONTAL: 1:200
 VERTICAL: 1:100