

6/29/2007

p:\007\105\00024\drain\line\crosssections\cilver-ts.dgn

FINAL SURVEY	SURVEYED	DATE
NOTE BOOK	TEMP. DATE	
NO.	AREAS CHECKED	
	AREAS CHECKED	

ORIGINAL SURVEY	SURVEYED	DATE
NOTE BOOK	TEMP. DATE	
NO.	AREAS CHECKED	
	AREAS CHECKED	

FAP RTE	SECTION	COUNTY	TOTAL SHEETS	SHEET NO.
	60-15, 60-15B	MADISON	474	367
STA.	TO STA.			
FED. ROAD DIST. NO.	ILLINOIS	FED. AID PROJECT		
CONTRACT NO. 76323				

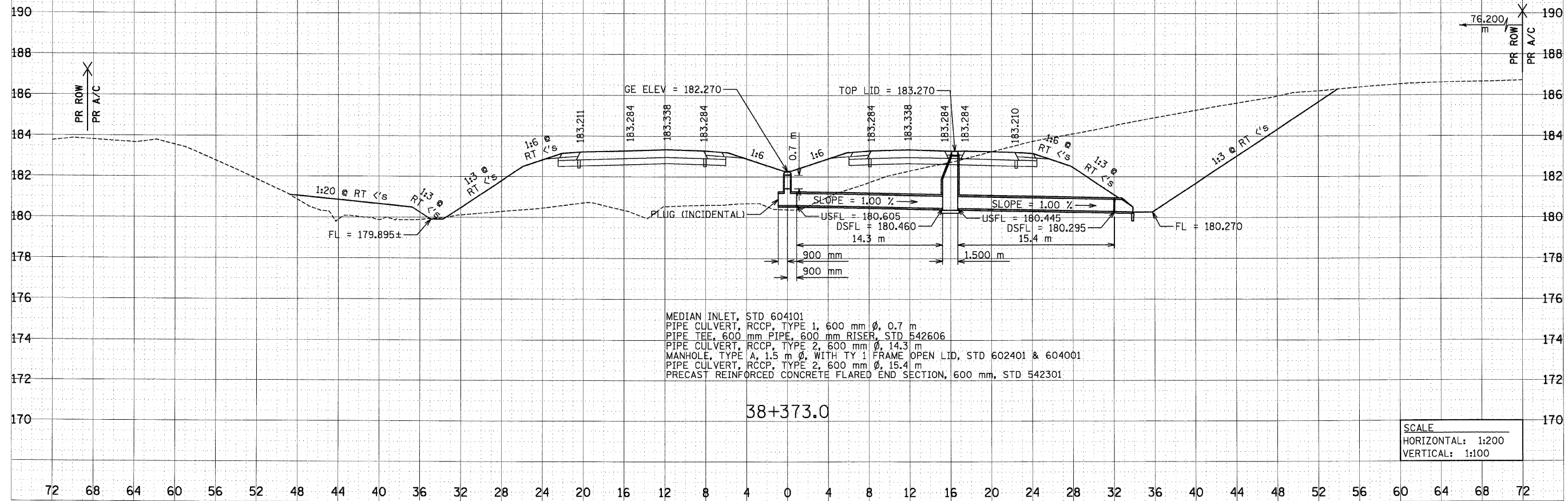

MEDIAN INLET, STD 604101  
 PIPE CULVERT, RCCP, TYPE 1, 600 mm  $\phi$ , 0.7 m  
 PIPE TEE, 600 mm PIPE, 600 mm RISER, STD 542606  
 PIPE CULVERT, RCCP, TYPE 2, 600 mm  $\phi$ , 14.3 m  
 MANHOLE, TYPE A, 1.5 m  $\phi$ , WITH TY 1 FRAME OPEN LID, STD 602401 & 604001  
 PIPE CULVERT, RCCP, TYPE 2, 600 mm  $\phi$ , 15.4 m  
 PRECAST REINFORCED CONCRETE FLARED END SECTION, 600 mm, STD 542301

SCALE  
 HORIZONTAL: 1:200  
 VERTICAL: 1:100