

6/29/2007

DATE	BY
SURVEYED	BY
PLANNED	BY
FIELD	BY
NOTE BOOK	NO.
AREAS CHECKED	

DATE	BY
SURVEYED	BY
PLANNED	BY
FIELD	BY
NOTE BOOK	NO.
AREAS CHECKED	

FAP RTE	SECTION	COUNTY	TOTAL SHEETS	SHEET NO.
	60-15, 60-15B	MADISON	474	369
STA.	TO STA.			
FED. ROAD DIST. NO.	ILLINOIS	FED. AID PROJECT		
CONTRACT NO. 76323				

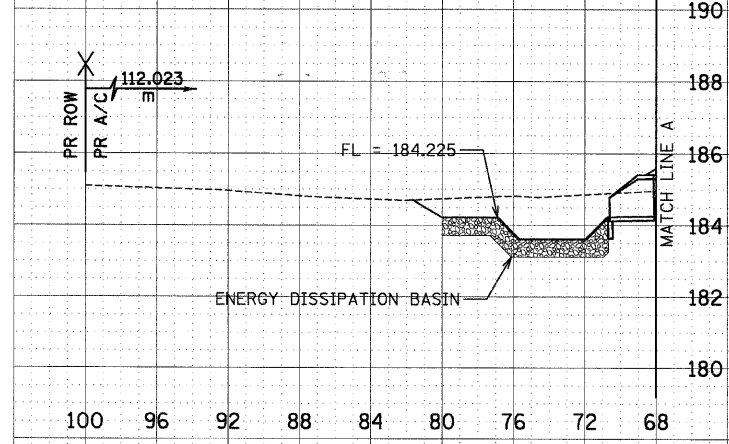
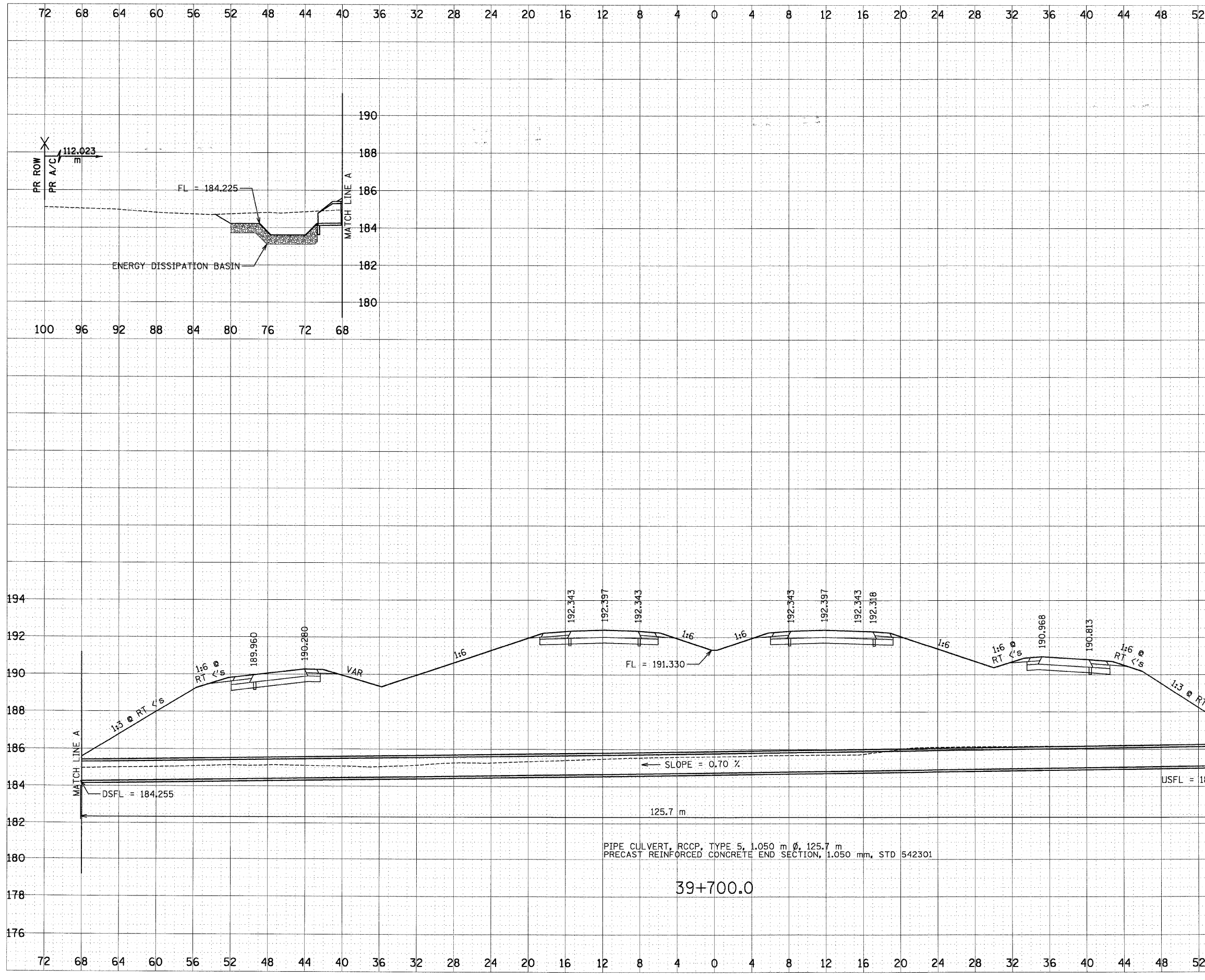

PIPE CULVERT, RCCP, TYPE 5, 1.050 m Ø, 125.7 m
 PRECAST REINFORCED CONCRETE END SECTION, 1.050 mm, STD 542301

39+700.0

SCALE
 HORIZONTAL: 1:200
 VERTICAL: 1:100