

6/29/2007

FINAL SURVEY	DATE
BLANKETED	BY
PLOTTED	
NOTE BOOK	
AREAS CHECKED	
NO.	

ORIGINAL SURVEY	DATE
TEMPORARY	BY
NOTE BOOK	
AREAS CHECKED	
NO.	

FAP RTE	SECTION	COUNTY	TOTAL SHEETS	SHEET NO.
	60-15, 60-15B	MADISON	474	375
STA.	TO STA.			
FED. ROAD DIST. NO.	ILLINOIS	FED. AID PROJECT		
CONTRACT NO. 76323				

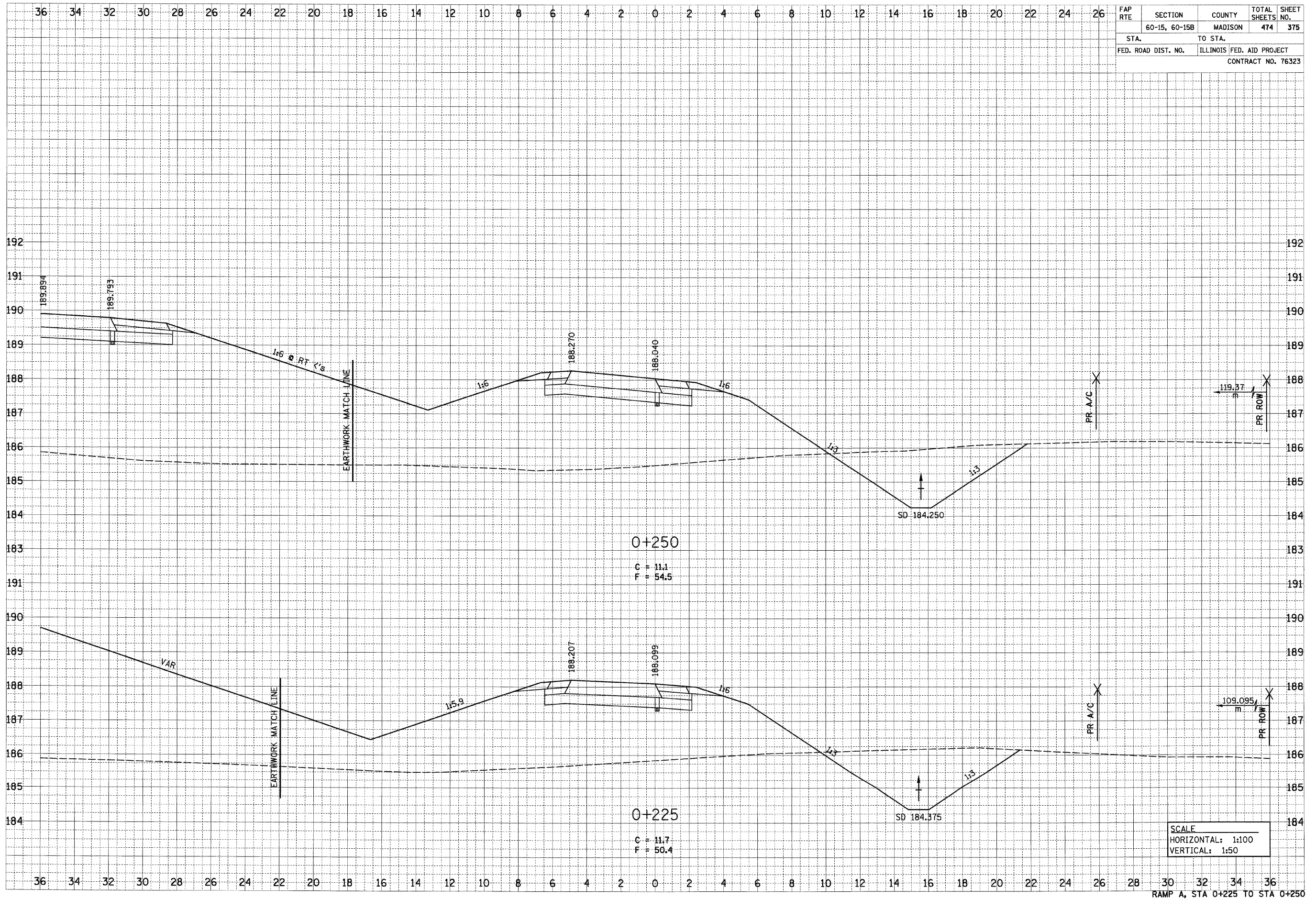

RAMP A, STA 0+225 TO STA 0+250

P:\029\1es\00024\dmr\line\crosssections\ra\temp.dgn