

6/29/2007

DATE	
BY	
FINAL SURVEY	
SURVEYED	
NOTE BOOK	
AREAS CHECKED	
NO.	

DATE	
BY	
ORIGINAL SURVEY	
SURVEYED	
NOTE BOOK	
AREAS CHECKED	
NO.	

FAP RTE	SECTION	COUNTY	TOTAL SHEETS	SHEET NO.
	60-15, 60-15B	MADISON	474	378
STA.	TO STA.			
FED. ROAD DIST. NO.	ILLINOIS FED. AID PROJECT			
CONTRACT NO. 76323				

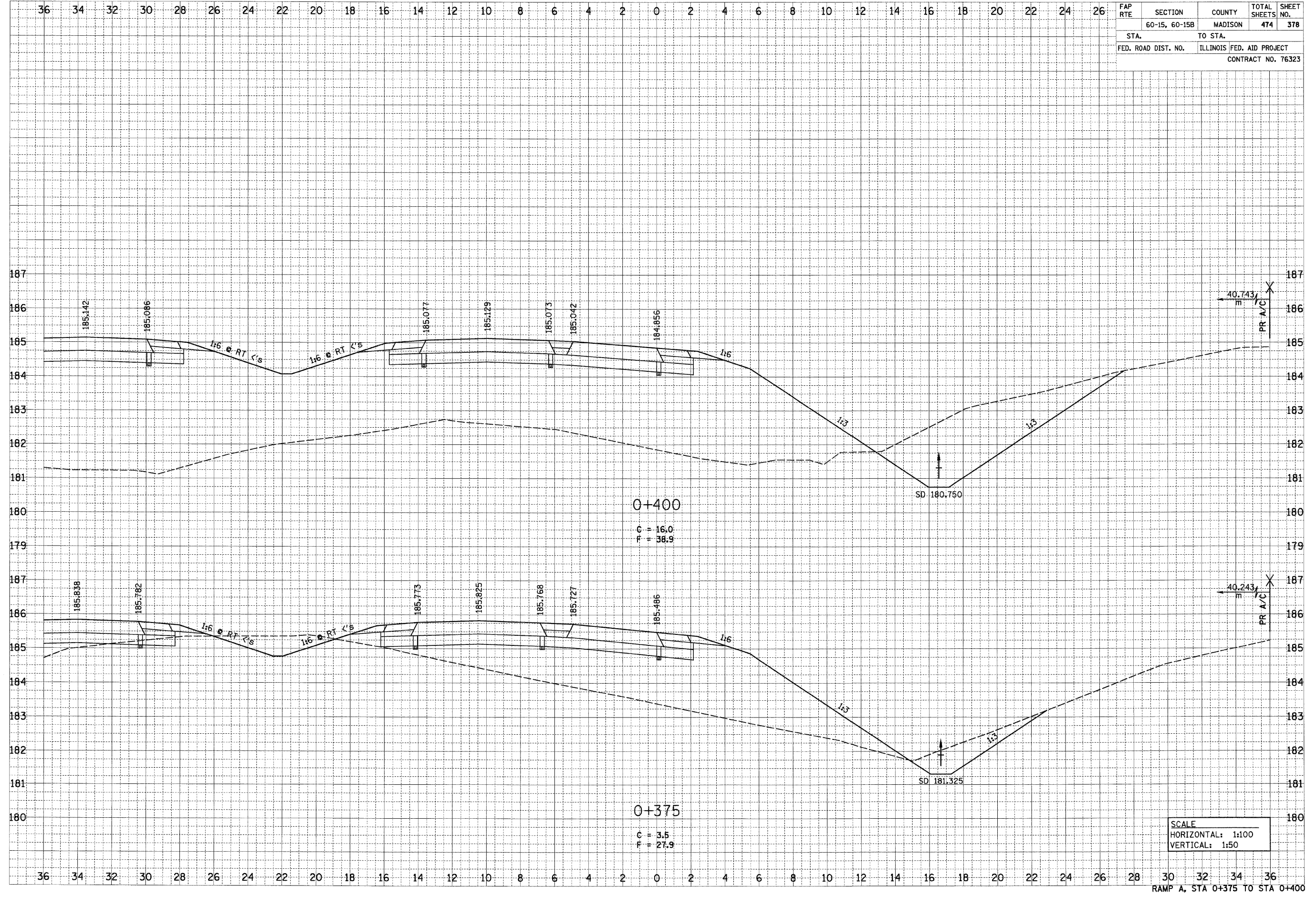

SCALE
 HORIZONTAL: 1:100
 VERTICAL: 1:50

RAMP A, STA 0+375 TO STA 0+400

p:\0071.es\08024\dmn\line\crosssection\ra\ra.rvt