

6/21/2007

FAP RTE	SECTION	COUNTY	TOTAL SHEETS	SHEET NO.
	60-15, 60-15B	MADISON	474	380
STA.	TO STA.			
FED. ROAD DIST. NO.	ILLINOIS	FED. AID PROJECT		
CONTRACT NO. 76323				

FINAL SURVEY	SURVEYED	DATE
NOTE BOOK	TEMP. DATE	
NO.	AREAS CHECKED	

ORIGINAL SURVEY	SURVEYED	DATE
NOTE BOOK	TEMP. DATE	
NO.	AREAS CHECKED	

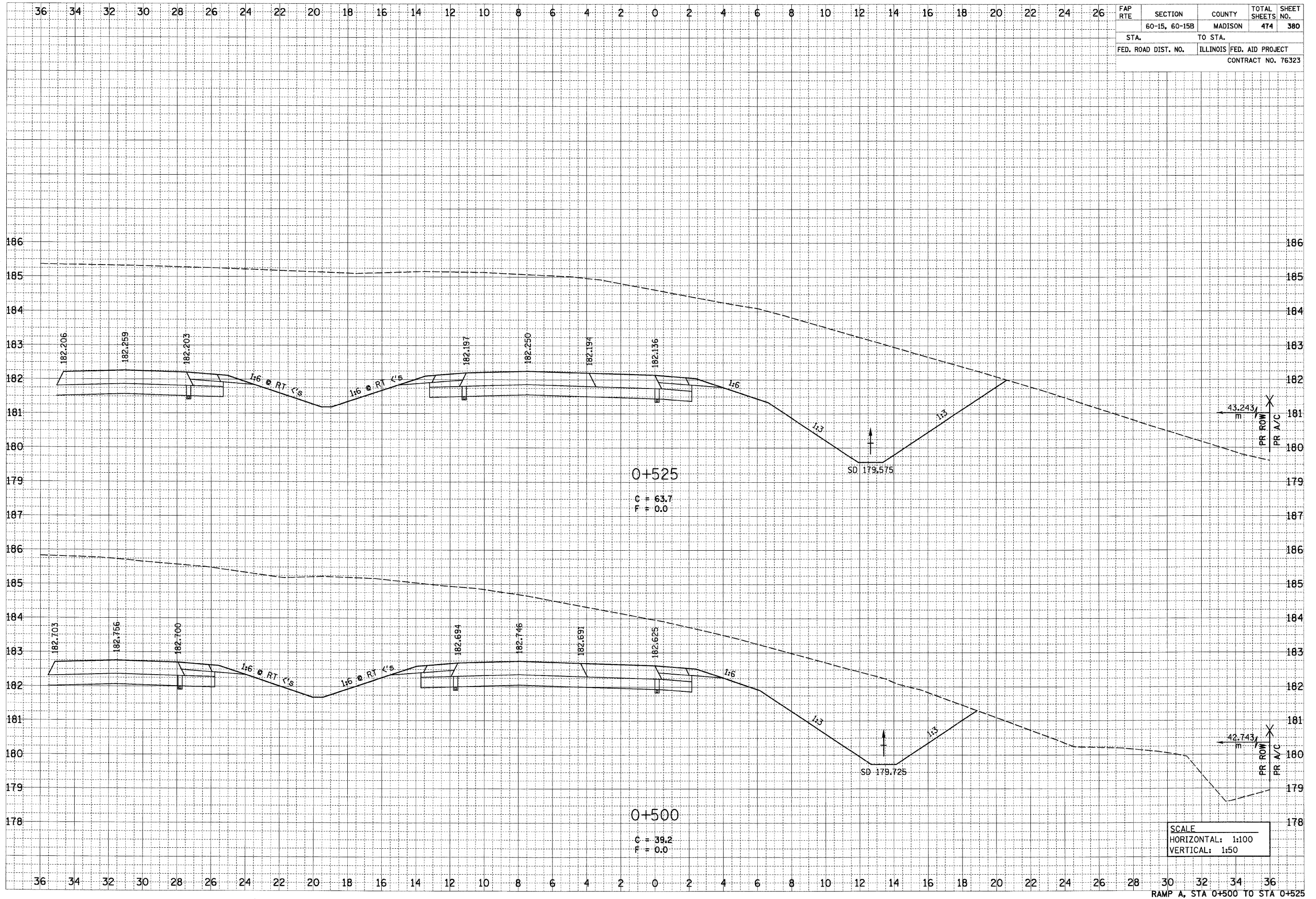

RAMP A, STA 0+500 TO STA 0+525

p:\2007\1es\20024\dmarm\line\crosssections\tempa.dgn