

6/25/2007

DATE	
BY	
SURVEYED	
NOTE BOOK	
AREAS CHECKED	
INC.	

DATE	
BY	
SURVEYED	
NOTE BOOK	
AREAS CHECKED	
INC.	

FAP RTE	SECTION	COUNTY	TOTAL SHEETS	SHEET NO.
	60-15, 60-15B	MADISON	474	381
STA.	TO STA.			
FED. ROAD DIST. NO.	ILLINOIS FED. AID PROJECT			
CONTRACT NO. 76323				

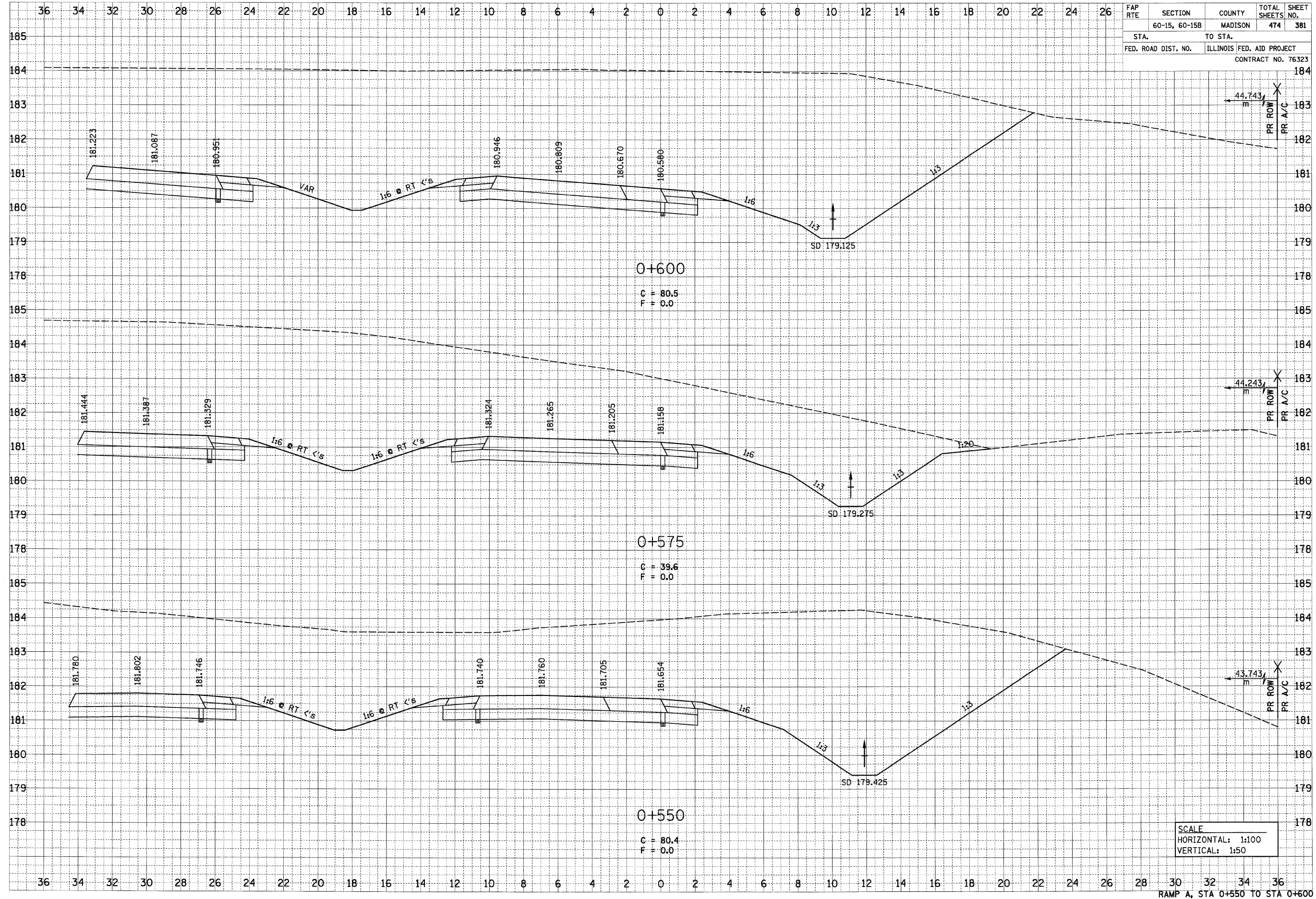

SCALE
 HORIZONTAL: 1:100
 VERTICAL: 1:50

RAMP A, STA 0+550 TO STA 0+600

pr\007\115a\0002A\115a.r115a\crosssections\115a.ramp.dgn