

6/29/2007

DATE	
BY	
FINAL SURVEY	
NOTED	
NOTE BOOK	
NO.	
AREAS CHECKED	

DATE	
BY	
ORIGINAL SURVEY	
NOTED	
NOTE BOOK	
NO.	
AREAS CHECKED	

FAP RTE	SECTION	COUNTY	TOTAL SHEETS	SHEET NO.
	60-15, 60-15B	MADISON	474	383
STA.	TO STA.			
FED. ROAD DIST. NO.	ILLINOIS FED. AID PROJECT			
CONTRACT NO. 76323				

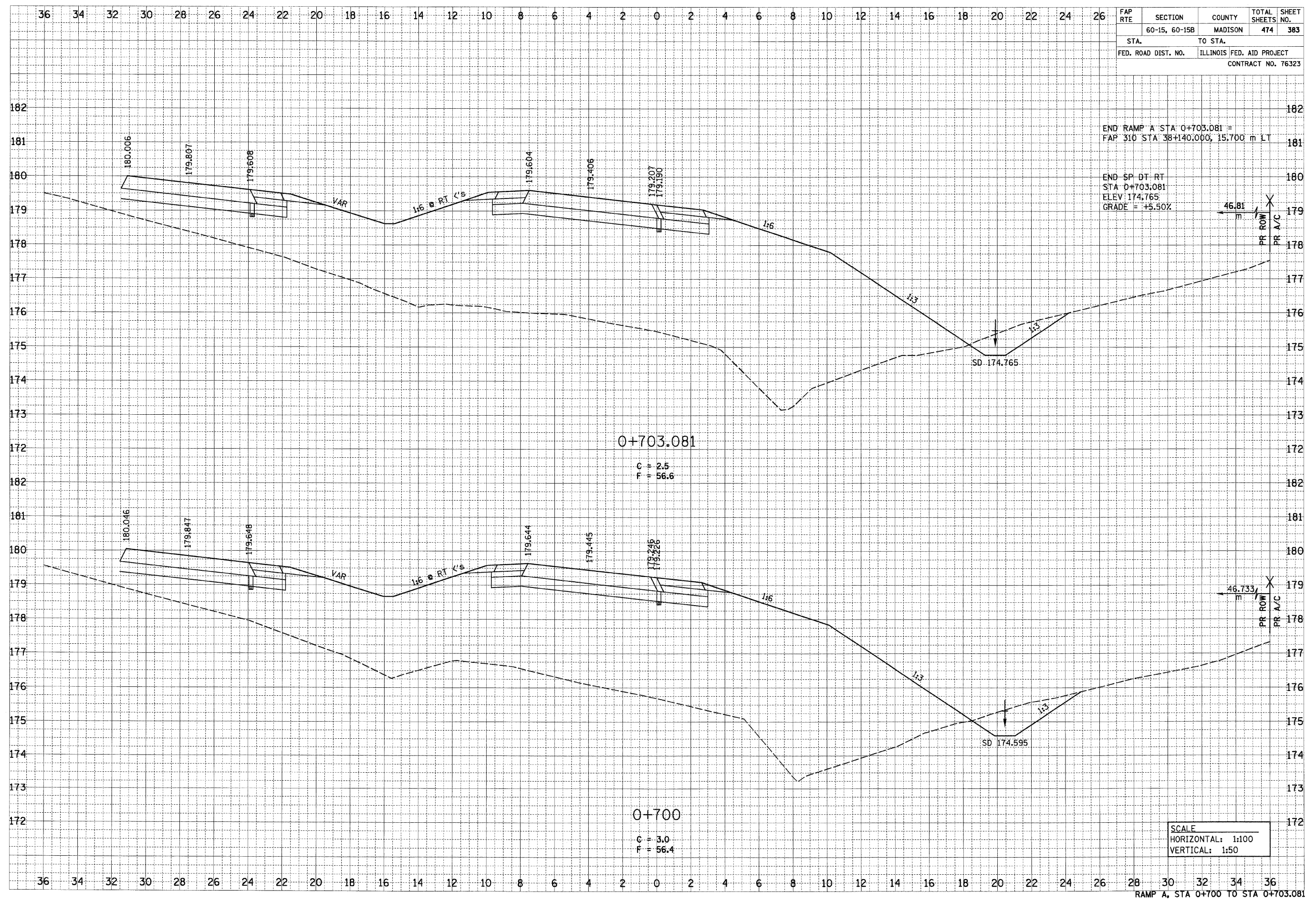

END RAMP A STA 0+703.081 =
FAP 310 STA 38+140.000, 15.700 m LT

END SP DT RT
STA 0+703.081
ELEV 174.765
GRADE = +5.50%

RAMP A, STA 0+700 TO STA 0+703.081

p:\2007\1es\02024\adme\line\crosssections\vramp.a.dgn