

6/29/2007

FINAL SURVEY	DATE
SURVEYED	BY
NOTE BOOK	
AREAS CHECKED	
NO.	

ORIGINAL SURVEY	DATE
SURVEYED	BY
NOTE BOOK	
AREAS CHECKED	
NO.	

FAP RTE	SECTION	COUNTY	TOTAL SHEETS	SHEET NO.
	60-15, 60-15B	MADISON	474	384
STA.	TO STA.			
FED. ROAD DIST. NO.	ILLINOIS FED. AID PROJECT			
CONTRACT NO. 76323				

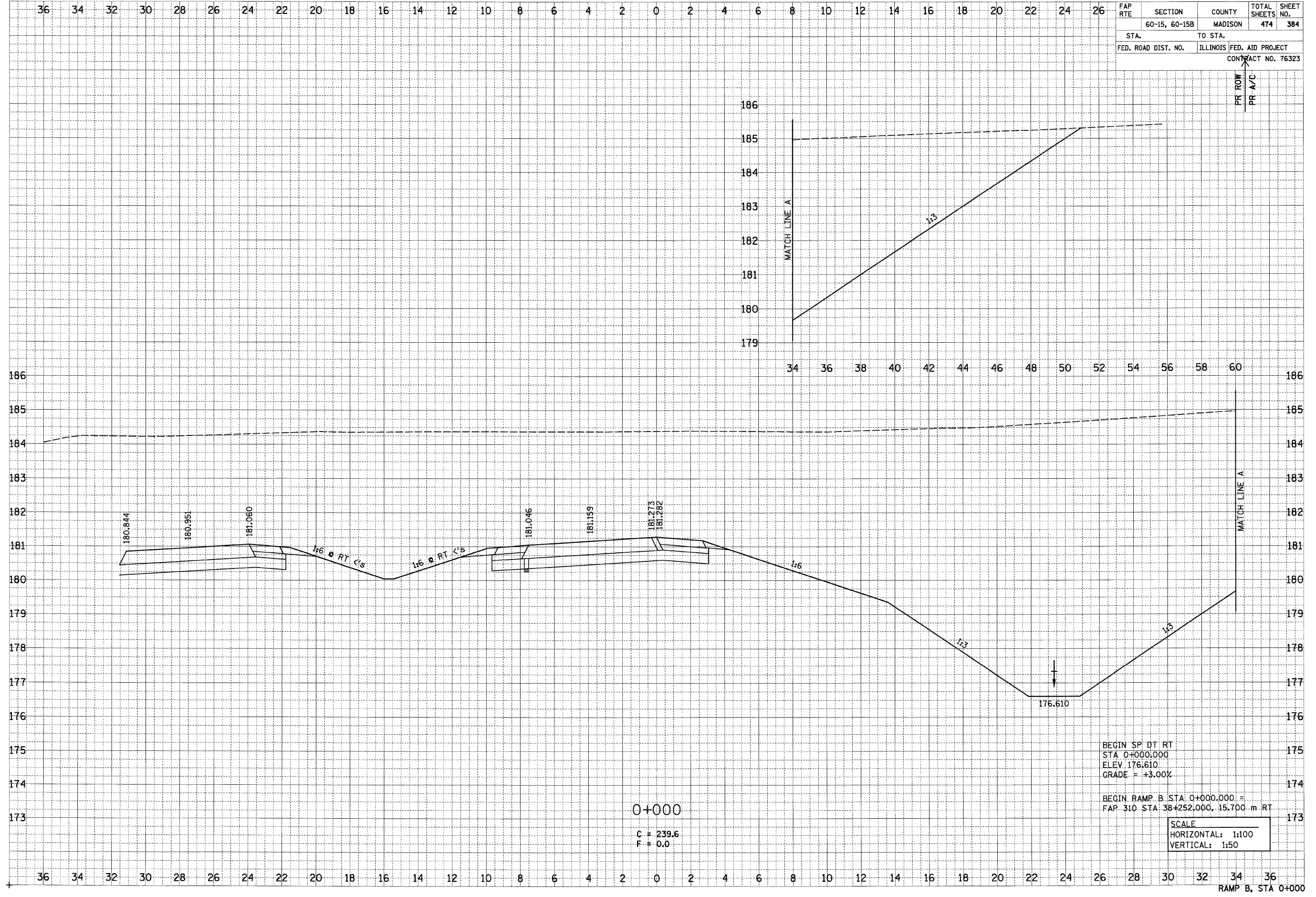

BEGIN SP: DT RT  
 STA 0+000.000  
 ELEV. 176.610  
 GRADE = +3.00%

BEGIN RAMP B. STA. 0+000.000 =  
 FAP 310 STA. 38+252.000, 15.700 m RT

SCALE  
 HORIZONTAL: 1:100  
 VERTICAL: 1:50

0+000

C = 239.6  
 F = 0.0

p:\061\les\060224\main\line\corrassections\tempb.dgn

RAMP B, STA 0+000