

6/29/2007

FINAL SURVEY	DATE
SURVEYED	BY
NOTE BOOK	
TEMPLATE	
AREAS	
CHECKED	
NO.	

ORIGINAL SURVEY	DATE
SURVEYED	BY
NOTE BOOK	
TEMPLATE	
AREAS	
CHECKED	
NO.	

FAP RTE	SECTION	COUNTY	TOTAL SHEETS	SHEET NO.
	60-15, 60-15B	MADISON	474	408
STA.	TO STA.			
FED. ROAD DIST. NO.	ILLINOIS FED. AID PROJECT		CONTRACT NO. 76323	

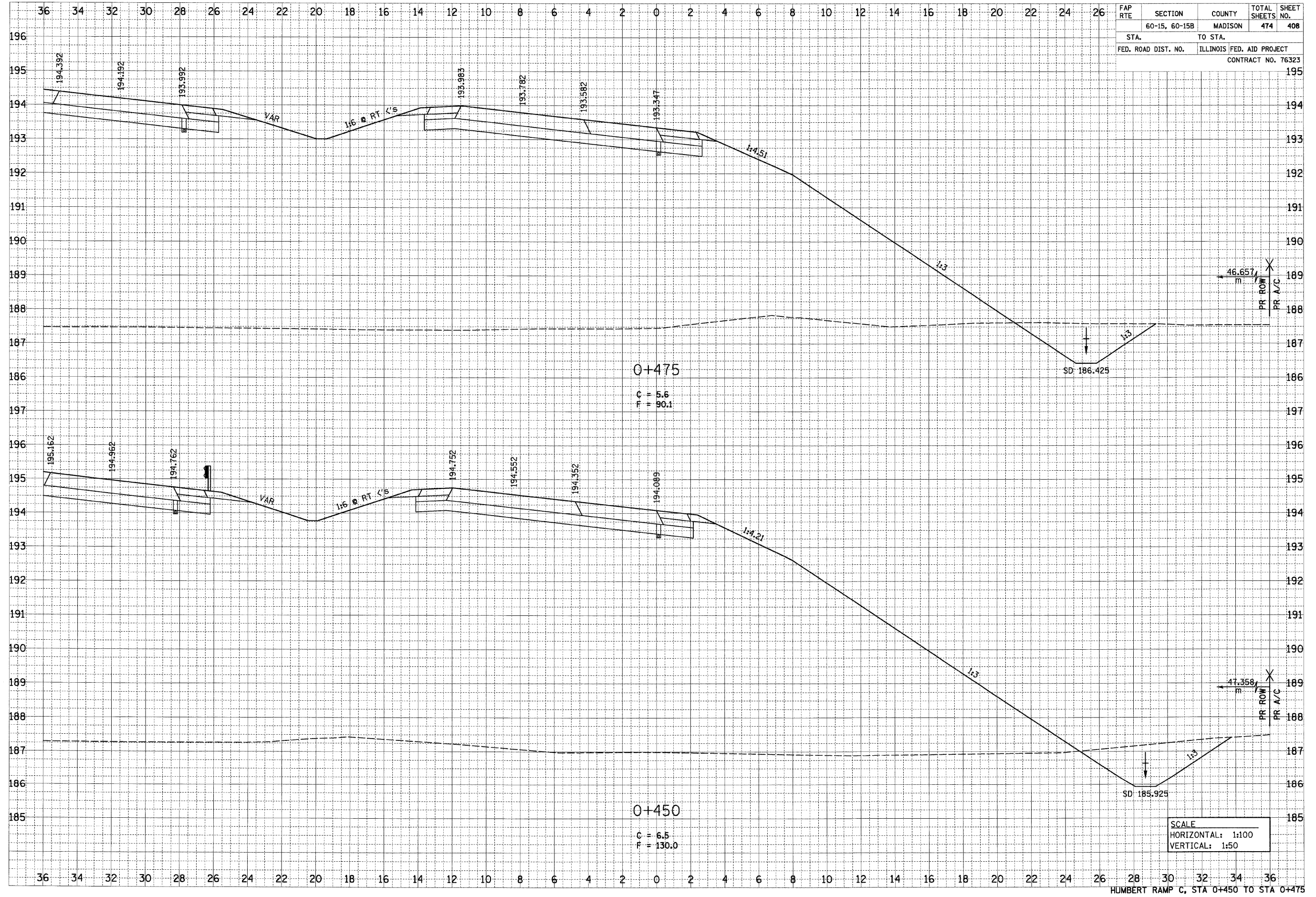

SCALE
 HORIZONTAL: 1:100
 VERTICAL: 1:50

HUMBERT RAMP C, STA 0+450 TO STA 0+475

p:\0011es\00024\drmain\jnc\crosssections\tempo.dgn