

6/29/2007

DATE	BY
SURVEYED	BY
NOTE BOOK	NO.
AREAS CHECKED	

DATE	BY
SURVEYED	BY
NOTE BOOK	NO.
AREAS CHECKED	

FAP RTE	SECTION	COUNTY	TOTAL SHEETS	SHEET NO.
	60-15, 60-15B	MADISON	474	425
STA.	TO STA.			
FED. ROAD DIST. NO.	ILLINOIS	FED. AID PROJECT		
CONTRACT NO. 76323				

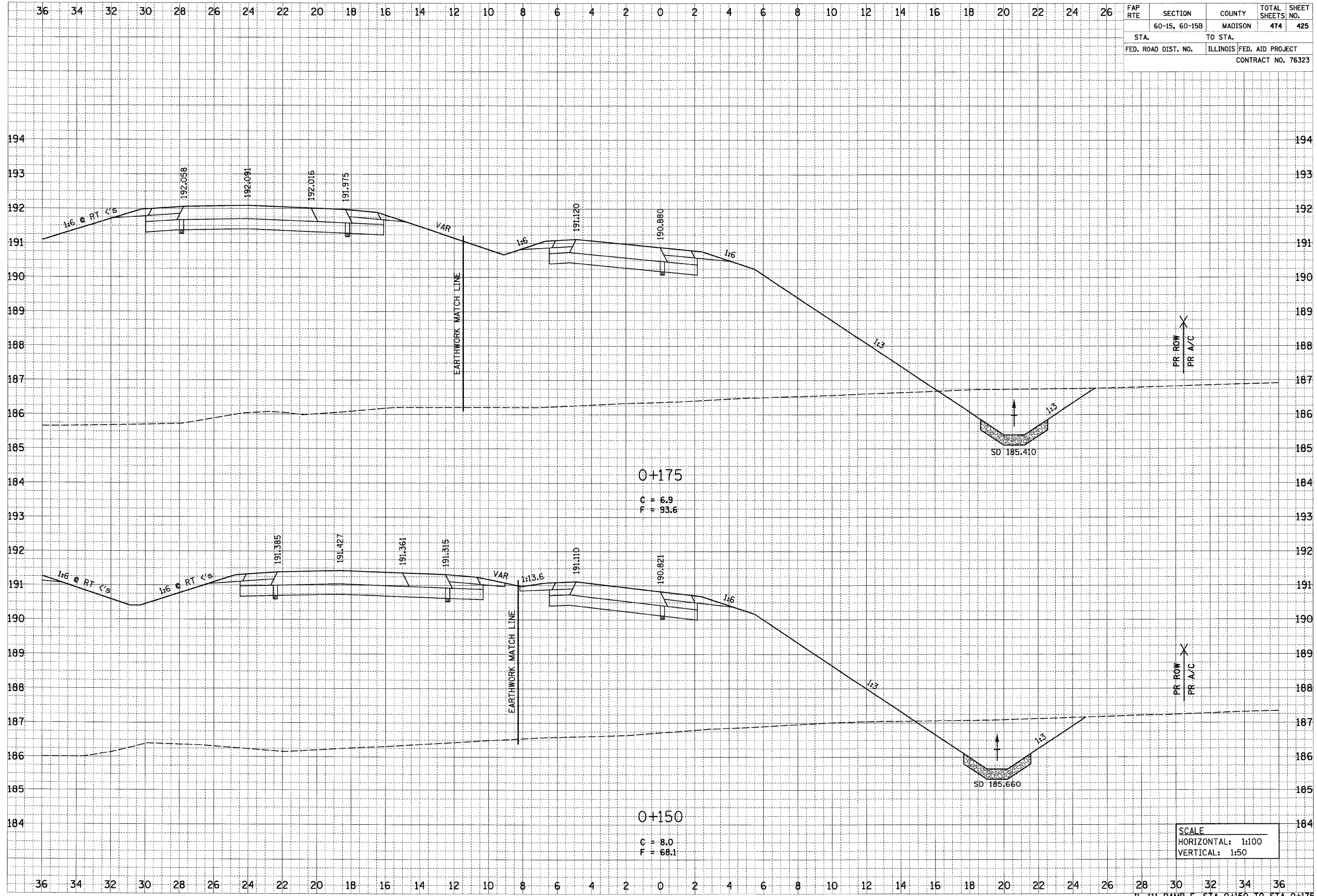

SCALE
 HORIZONTAL: 1:100
 VERTICAL: 1:50

p:\0071ies\00224\main\line\crosssections\temp.dgn