

6/29/2007

DATE	BY
SURVEYED	
TEMP. DATE	
NOTE BOOK	
AREAS	
CHECKED	

DATE	BY
SURVEYED	
TEMP. DATE	
NOTE BOOK	
AREAS	
CHECKED	

FAP RTE	SECTION	COUNTY	TOTAL SHEETS	SHEET NO.
	60-15, 60-15B	MADISON	474	431
STA.	TO STA.			
FED. ROAD DIST. NO.	ILLINOIS FED. AID PROJECT			
CONTRACT NO. 76323				

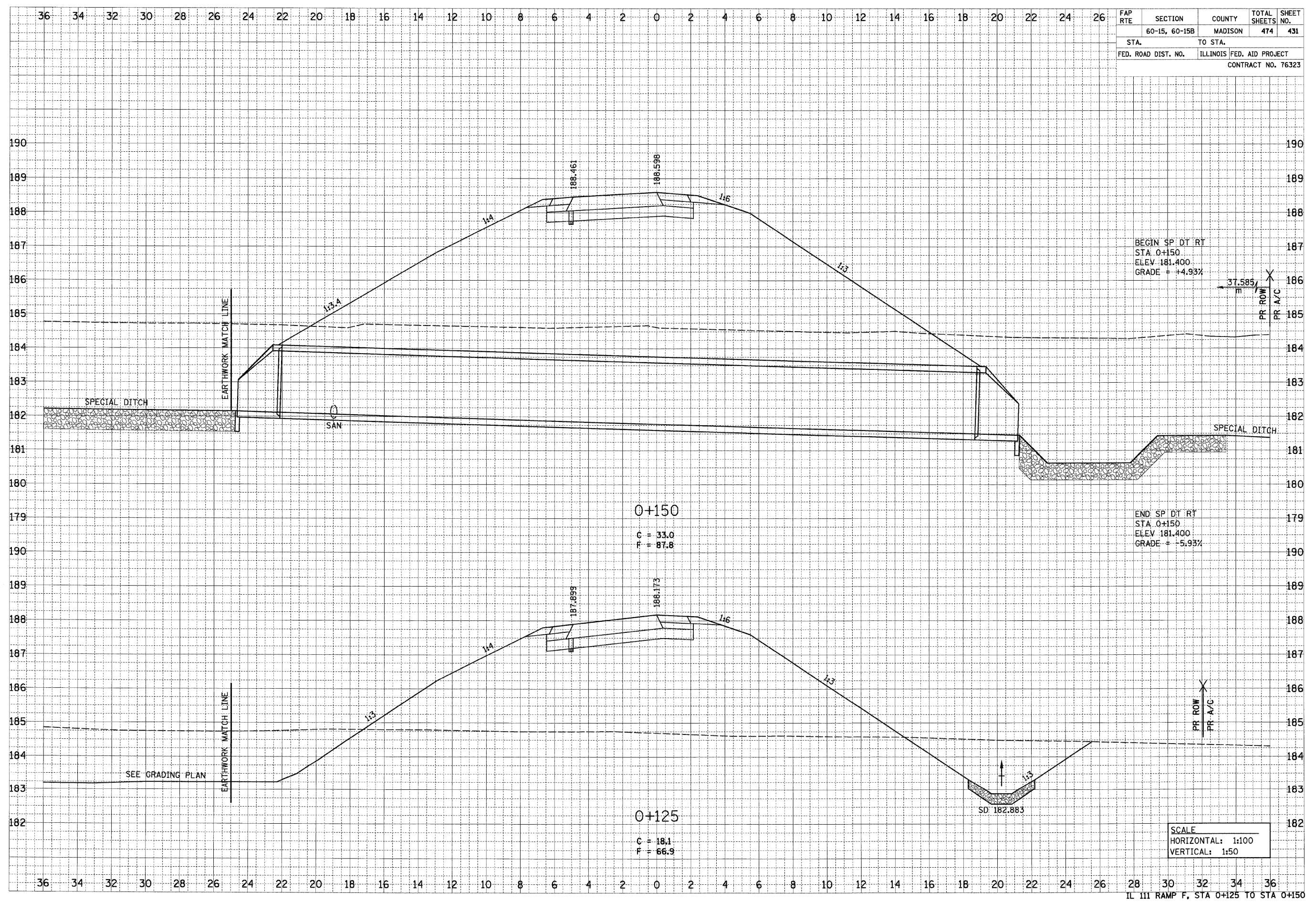

BEGIN SP. DT. RT
 STA. 0+150
 ELEV. 181.400
 GRADE = +4.93%

END SP. DT. RT
 STA. 0+150
 ELEV. 181.400
 GRADE = -5.93%

0+150
 C = 33.0
 F = 87.8

0+125
 C = 18.1
 F = 66.9

SCALE
 HORIZONTAL: 1:100
 VERTICAL: 1:50