

6/29/2007

DATE	BY
FINAL SURVEY	
NOTE BOOK	
AREAS	
NO.	

DATE	BY
ORIGINAL SURVEY	
NOTE BOOK	
AREAS	
NO.	

FAP RTE	SECTION	COUNTY	TOTAL SHEETS	SHEET NO.
	60-15, 60-15B	MADISON	474	434
STA.	TO STA.			
FED. ROAD DIST. NO.	ILLINOIS FED. AID PROJECT			
	CONTRACT NO. 76323			

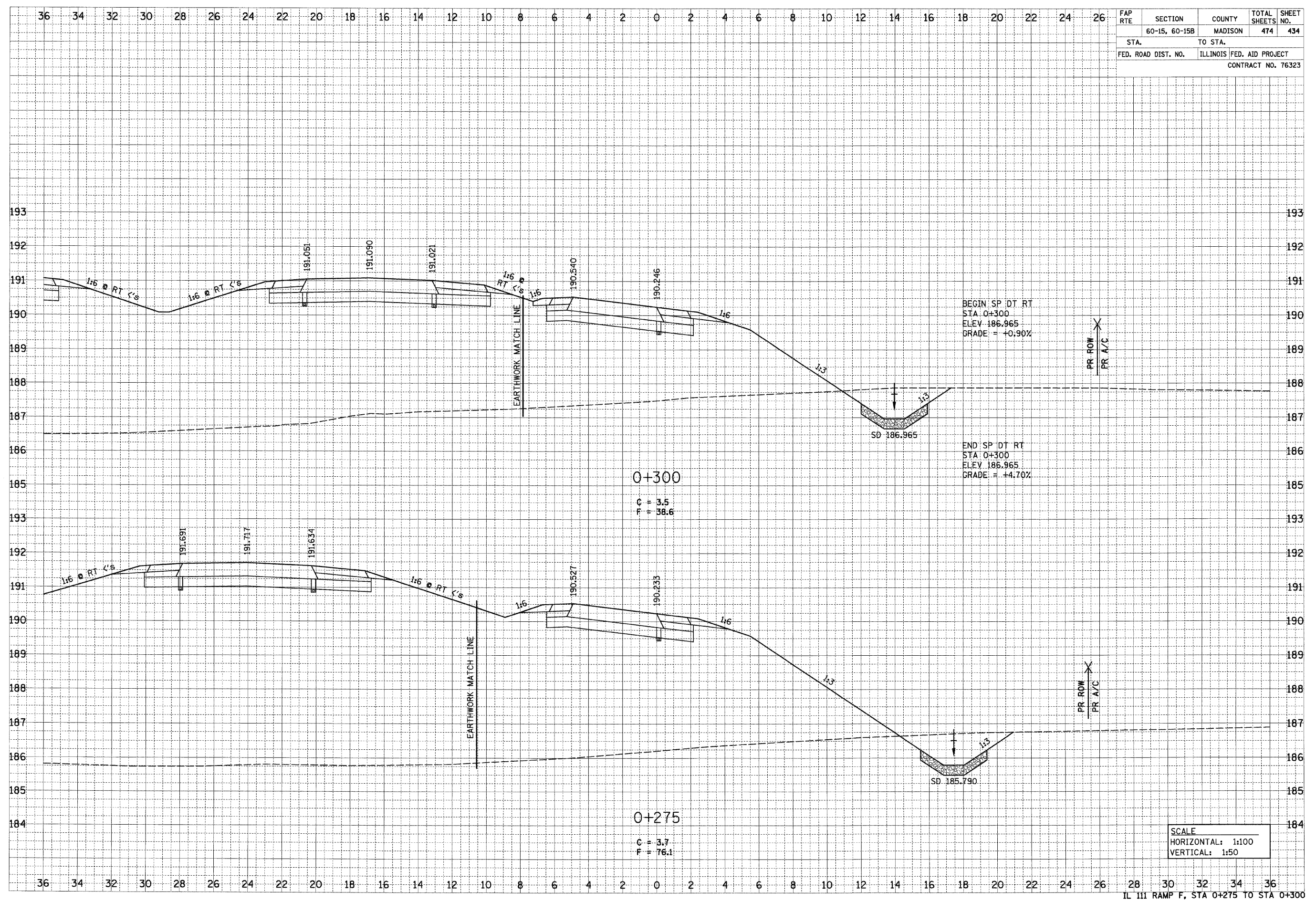

SCALE	
HORIZONTAL:	1:100
VERTICAL:	1:50

p:\0611es\08224\dm\Line\Crosssections\comp.f.dgn