

6/29/2007

p:\06711es\06024\main\line\crosssections\vramp.f.dgn

FINAL SURVEY NOTE BOOK NO.	DATE
BY	
REVIEWED	
DATE	
AREAS CHECKED	

ORIGINAL SURVEY NOTE BOOK NO.	DATE
BY	
REVIEWED	
DATE	
AREAS CHECKED	

FAP RTE	SECTION	COUNTY	TOTAL SHEETS	SHEET NO.
	60-15, 60-15B	MADISON	474	438
STA.	TO STA.			
FED. ROAD DIST. NO.	ILLINOIS	FED. AID PROJECT		
CONTRACT NO. 76323				

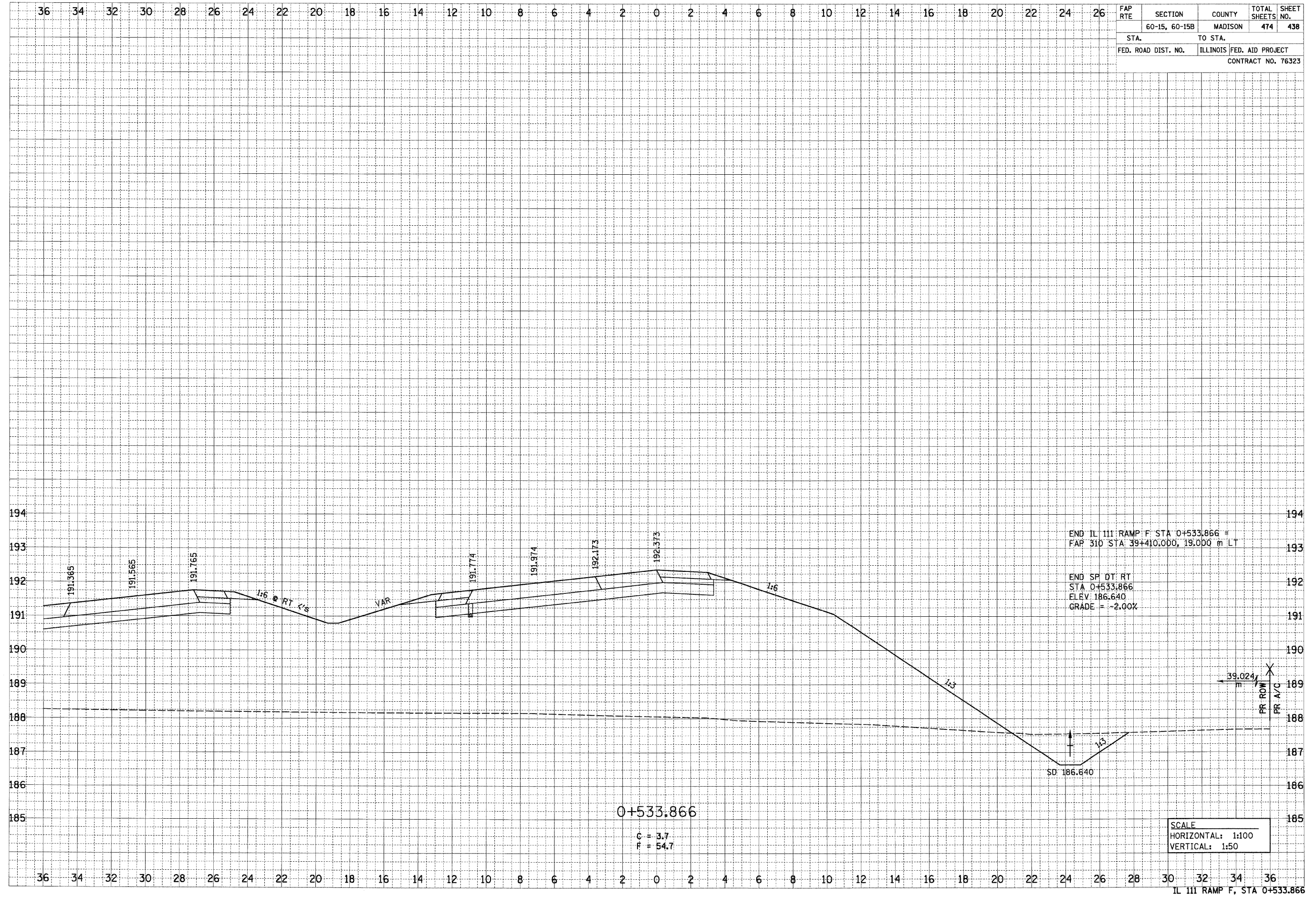

END IL III RAMP F STA 0+533.866 =  
 FAP 310 STA 39+410.000, 19.000 m LT

END SP DT RT  
 STA 0+533.866  
 ELEV 186.640  
 GRADE = -2.00%

SCALE  
 HORIZONTAL: 1:100  
 VERTICAL: 1:50

IL III RAMP F, STA 0+533.866