

6/29/2007

FAP RTE	SECTION	COUNTY	TOTAL SHEETS	SHEET NO.
	60-15, 60-15B	MADISON	474	459
STA.		TO STA.		
FED. ROAD DIST. NO.		ILLINOIS FED. AID PROJECT		
CONTRACT NO. 76323				

FINAL SURVEY	DATE
BY	
STARTED	
PLANNED	
NOTE BOOK	
AREAS	
CHECKED	

ORIGINAL SURVEY	DATE
BY	
STARTED	
PLANNED	
NOTE BOOK	
AREAS	
CHECKED	

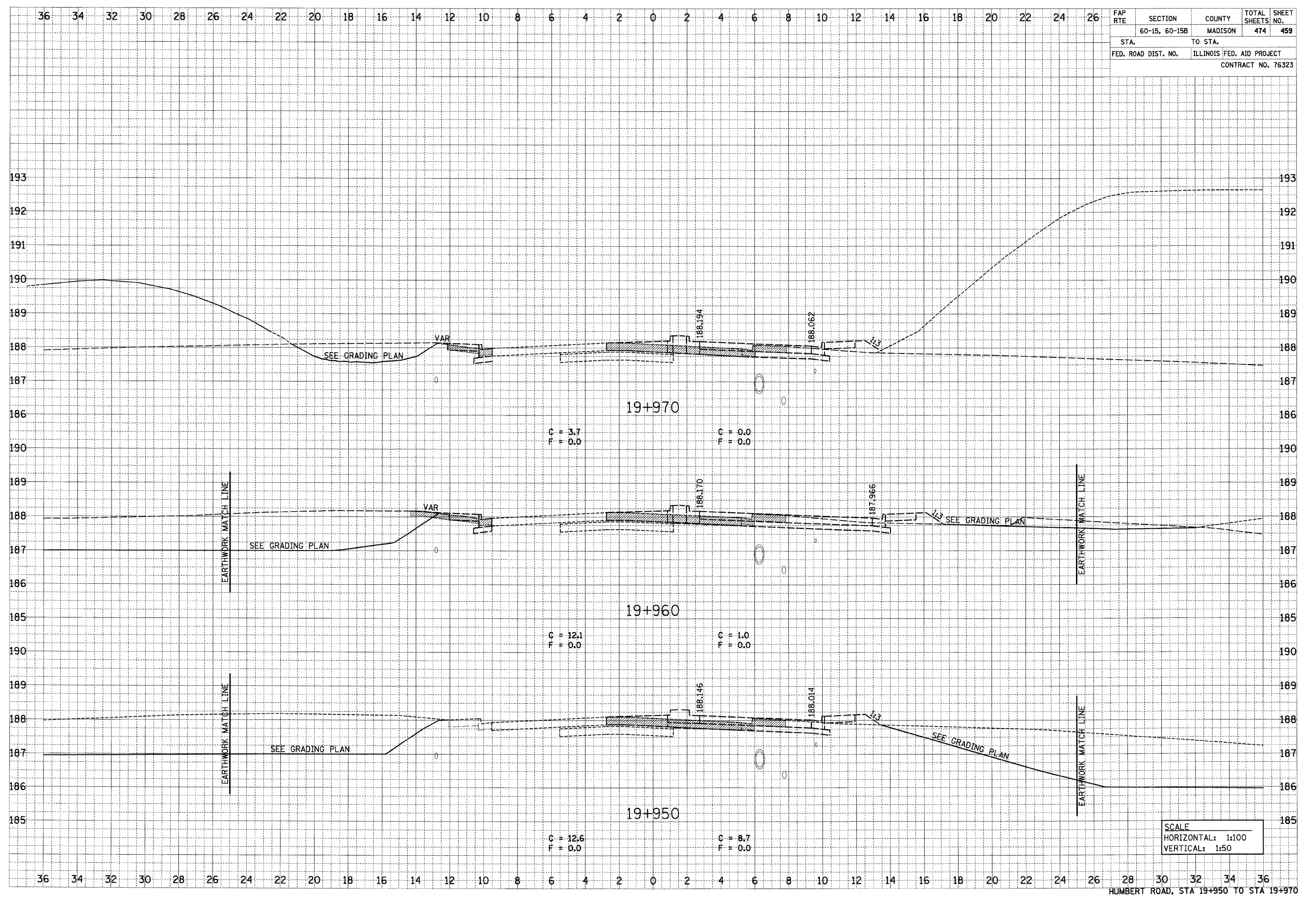

SCALE
 HORIZONTAL: 1:100
 VERTICAL: 1:50

p:\207\lisa\00024\dmr\line\crosssections\grading\humbert.dgn